

AUTOMATIC ELECTRIC GUN SERIES

AIR SPORT GUN



Emulational High-powered Nicety

INSTRUCTION MANUAL

说明书



• 在操作之前必须阅读这些说明书
Always read through this manual before operation.



警告 WARNING



18岁以上年龄才能使用
Only for 18 years of age or older

18岁以上年龄才能利用这支汽枪比赛使用
Operation of this air gun for competition use is restricted to users of 18 years of age or older.



注意受损伤
Injury caution

因为BB 弹能达到50-60米范围,不小心的射击将可能导致眼睛受损伤或其它伤害。
Since plastic BB bullets reach 50 to 60 meters, careless shooting may cause eye damage or other injuries.



注意熟读警告指示手册
Careful reading of Handling cautions and instruction manual

在操作之前要细心读熟警告手册和指示手册操作汽枪时必须认识好警告指示
Always read through this HANDLING CAUTION AND INSTRUCTION MANUAL carefully before operation. Operate the air gun with full recognition of warnings and cautions.

AUTOMATIC ELECTRIC GUN SERIES AIR SPORT GUN



BOTH ELEPHANT

Emulational High-powered Nicety

INSTRUCTION MANUAL 说明书

1 Component Names

(for details, see the name given for each component.)

各部件名称（以下为各部件名称）

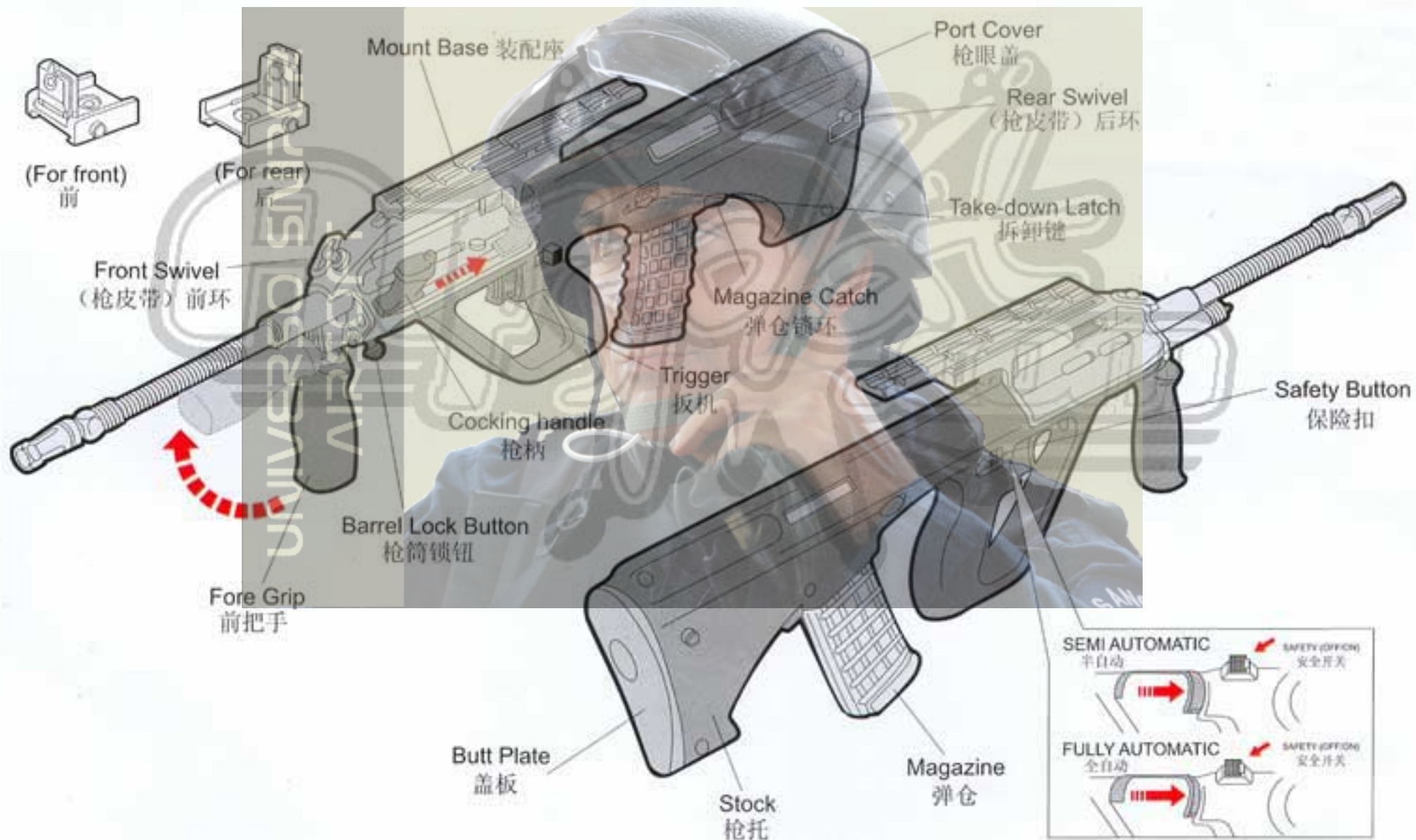

2 Setting the Battery (conduct operations hereafter after charging the battery.)

电池安装（电池充电后如下操作）

- 1 Remove the butt plate by pulling it towards you while pinching it inwards as shown.
如图所示，扳开盖板。

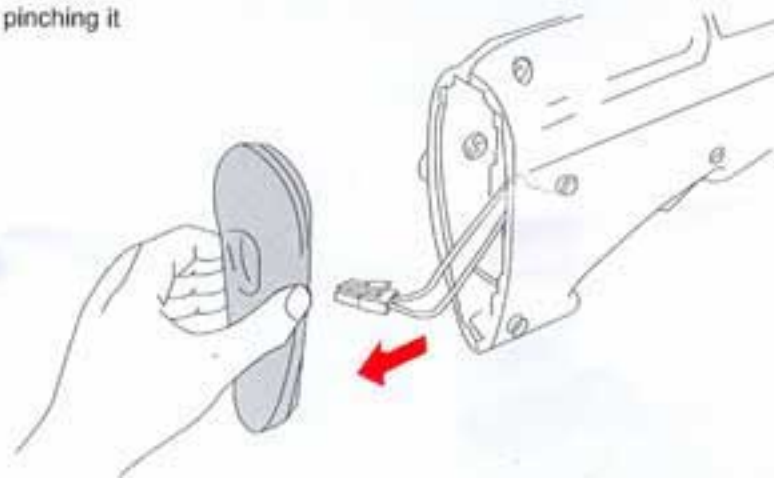
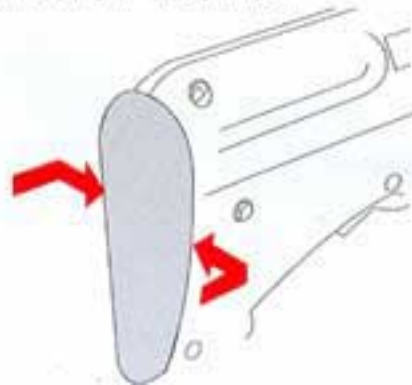

2 Connect the connector and place the battery inside the stock.
将连接器连接，把电池装进枪托。

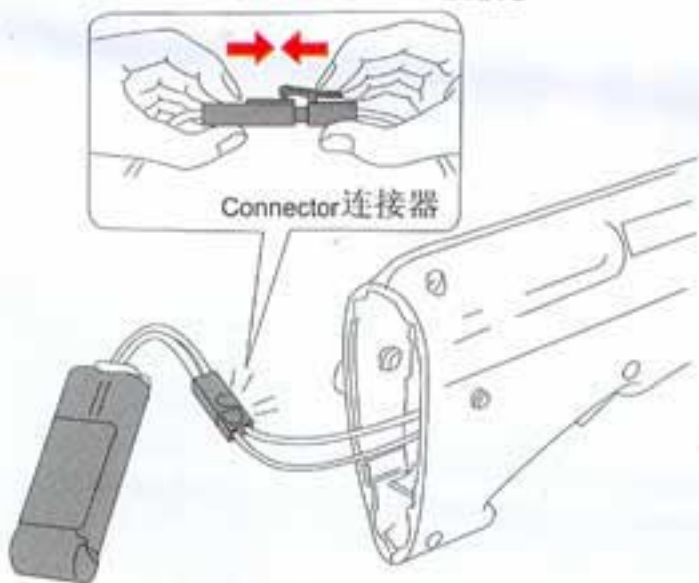

3 Firmly set the butt plate by pressing in the bottom. Top and side in this order.
装上底板并将其固定。顶部和侧面按以下顺序。

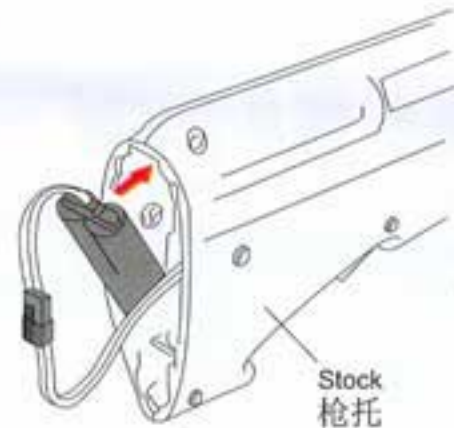

3 Setting the Open Sight 安装瞄准器

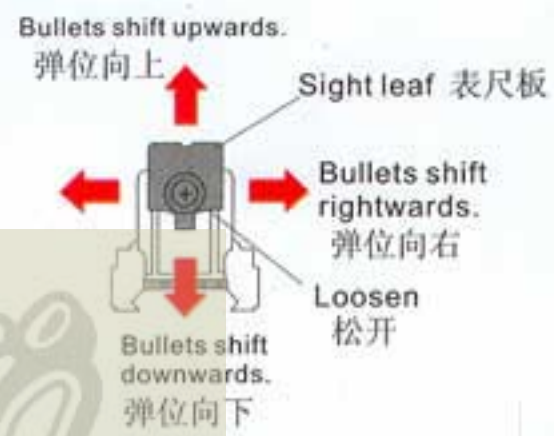
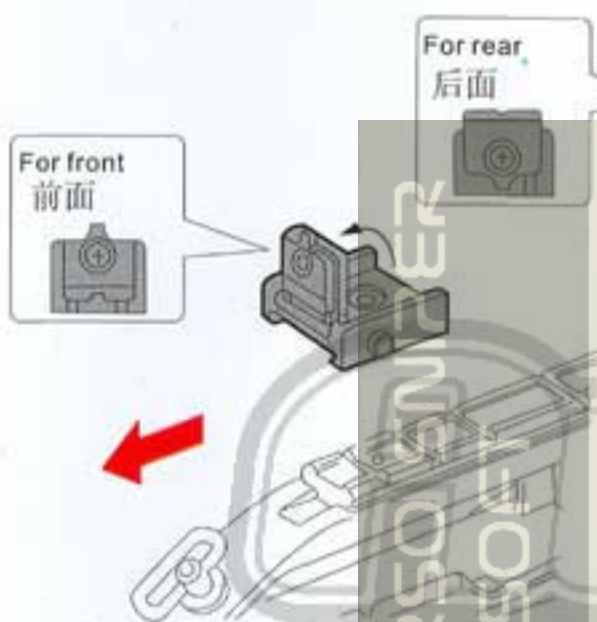

× Loosen the screws on the side of the open sight. Mount parts for the front and rear to the front and rear on mount base, respectively, and tighten the screws.
松开瞄准器侧的螺丝，将其前后分别装在装配座的前后，然后拧紧螺丝。

× After mounting, fire bullets to adjust deviation between hitting point and move the sight point. Loosen the screw and move the sight point. And tighten the screw to fix the leaf.
装配后发射子弹来调整发射点和瞄准点的偏差。松开螺丝，移动瞄准点，然后拧紧螺丝以固定表尺板。

4 Mounting the Scope 安装瞄准镜

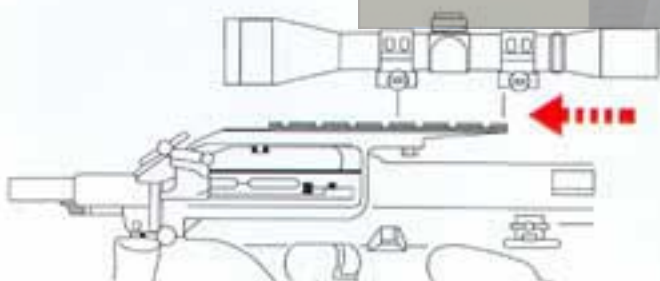

Protective cap
保护帽

Mount base width(20mm). Attach Marui genuine optional long/short scope 4x40-3x20 or dot sight. (Referring to page 4.)

装配座宽度(20mm)。附带可供选择的Marui长/短瞄准镜4X40-3X20或者点式瞄准器。(见第4页)

5 Setting the Magazine 安装弹仓



× Press the magazine catch to remove the magazine. (Support the magazine as it may drop.)
按压弹仓按钮，弹仓可退出。(这是用来支撑弹仓)

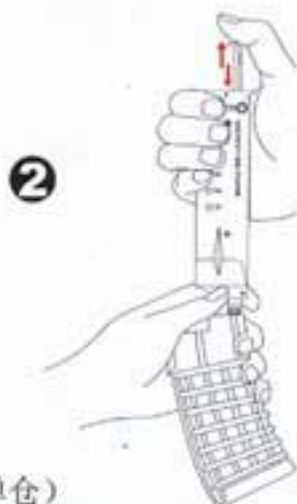

Packing into the BB plays
装入BB弹



× Make sure to set the magazine upwards and connect it firmly until a click sound is heard.
注意弹仓是向上的，请正确连接直到听到滴答声。