

# Echo 1 AK CPM AEG Owner's Manual

Cortesía de Universo Sniper Airsoft, [www.universosniperairsoft.com](http://www.universosniperairsoft.com)

## Echo 1 AK CPM AEG

Operation: Electric

Fire mode: Semi / Full Auto

Muzzle velocity: 375 fps w/ .

2g

Effective range: 180 feet

Hop Up: Adjustable

Weight: 6.25 lbs

Magazine capacity: 500rd

Length: 19.75 - 28.75

Battery: 8.4v AK Stick Type



## Echo 1 AK CPM AEG Name of Parts

THE NAME OF THE PARTS(For details,see the following pages.)

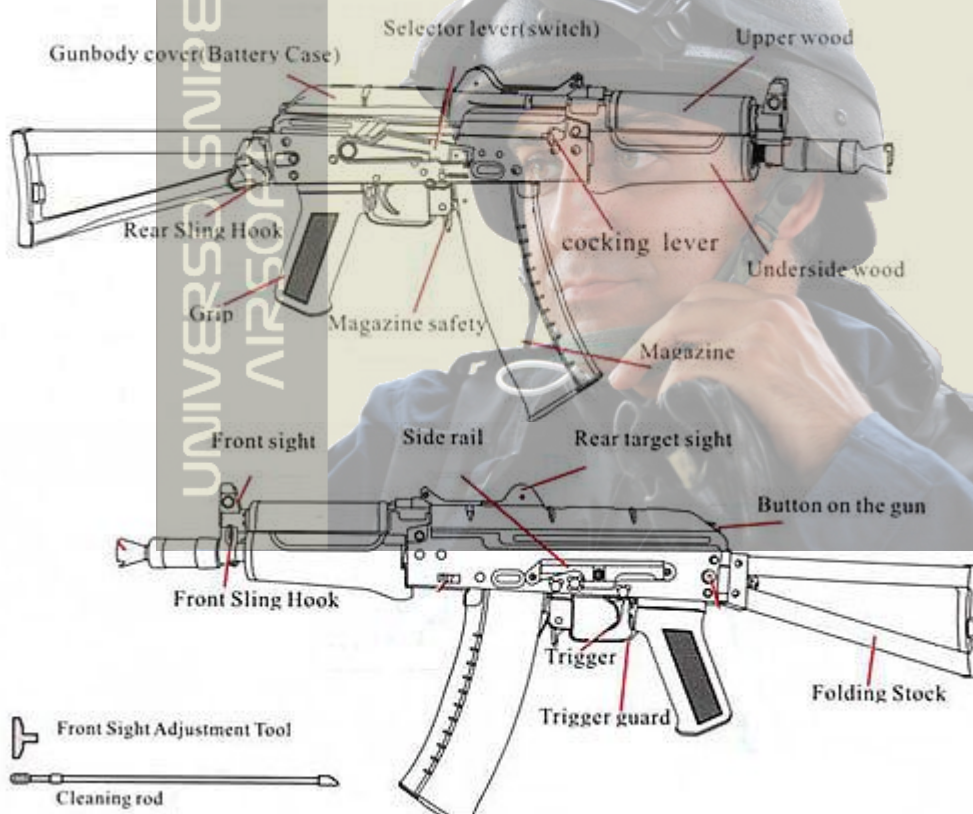

## Echo 1 AK CPM AEG Charging the Battery

Use the specified battery



● 8.4V Type Mini Battery



Exclusive Charge for Mini Battery

Use the specified battery for the gun. 8.4V, 1100mAh Hyper Command Mini Battery. Avoid use of non-standard or other brand name batteries. Otherwise, the originally designed functions will not be obtained.

**Warning: The SD and Mini Battery can not be used.**

Use the specified battery charger which is applicable to the above battery. The charger Exclusive Type as Speed Charger.

The battery's capacity power is increased with use of the Exclusive(battery) Discharger (Sold separately)

Use the correct battery and charge according to respective instruction manuals. We will not be held responsible for any accidents or damage caused by wrongful operation or usage of non-specified batteries.

[back to top](#)

## Echo 1 AK CPM AEG Selector Lever and Safety Setting

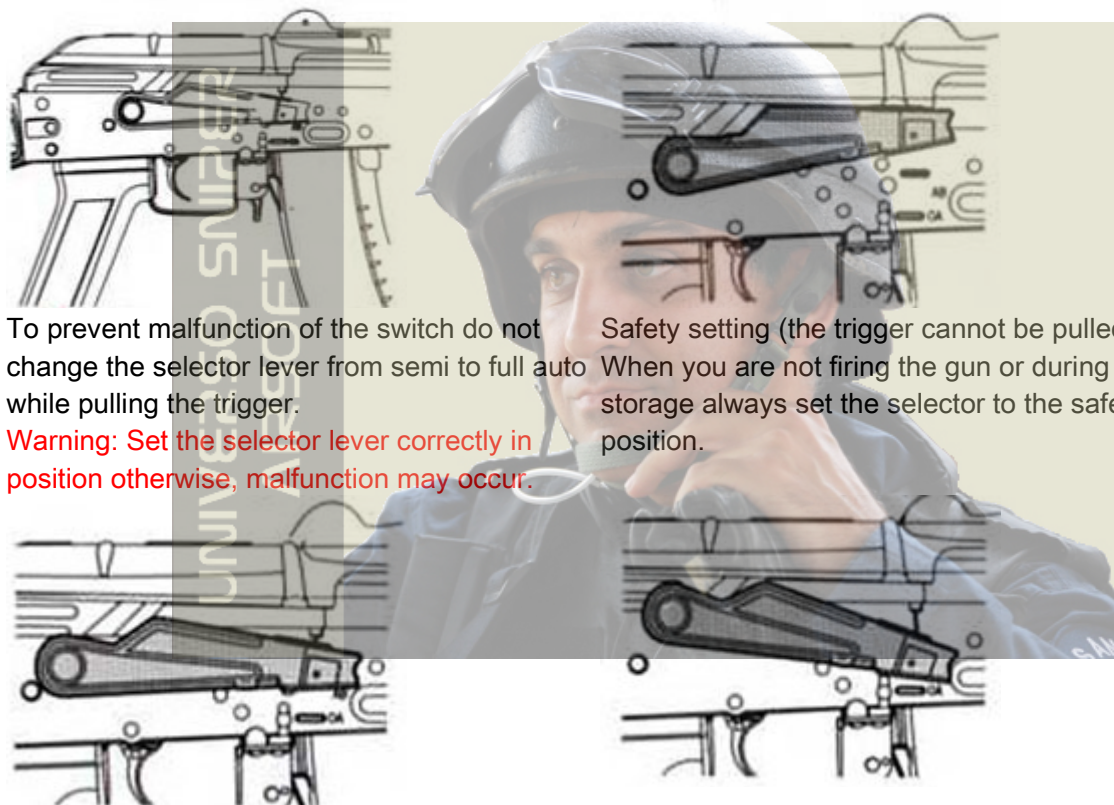

To prevent malfunction of the switch do not change the selector lever from semi to full auto while pulling the trigger.

**Warning: Set the selector lever correctly in position otherwise, malfunction may occur.**

Safety setting (the trigger cannot be pulled.) When you are not firing the gun or during storage always set the selector to the safe position.

Fully automatic (automatic firing)

The gun will fire automatically while the trigger remains pulled.

Semi automatic

The gun will fire one shot each time the trigger is pulled.

[back to top](#)

## Echo 1 AK CPM AEG Setting the Battery

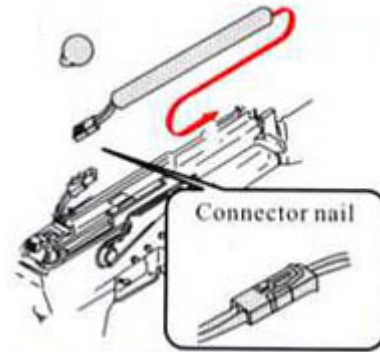
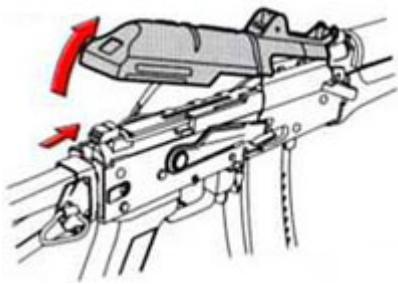

Press the upper cover catch button and upper cover pop-up automatically.

Connect the battery to the cord that is accessible from the hole under the rear sight. Press in the battery with its protrusion facing to the left.

**The protrusion must be on the left side.**

Reinstall the receiver top in the reverse order of removal procedure in step (1). Align the lead edge of receiver top to the groove under the rear of receiver top, aligning to the groove shown.

**When receiver top is set correctly, the catch button ejects out.**

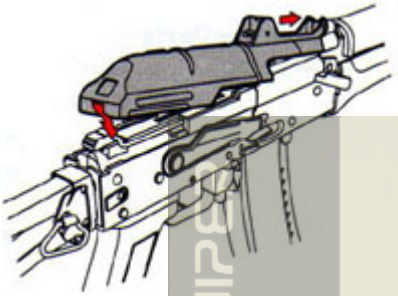

[back to top](#)

## Echo 1 AK CPM AEG Setting the Magazine

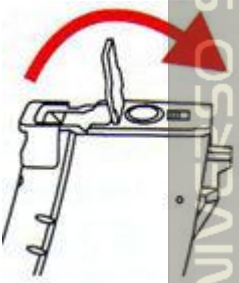

Open the cover of the magazine

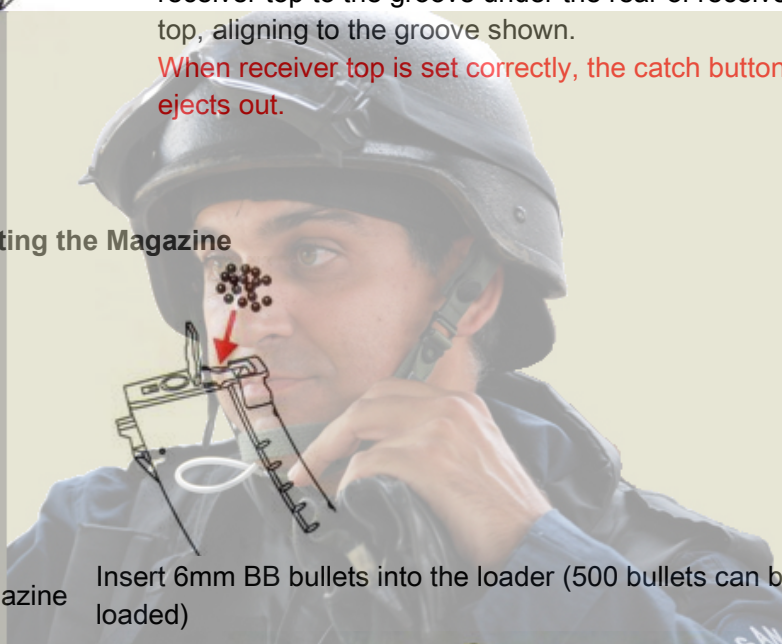

Insert 6mm BB bullets into the loader (500 bullets can be loaded)



Replace the magazine cover



Set the magazine upward. install the magazine as illustration.

1. First set the front.
2. Press to the rear.
3. Press the release lever towards the trigger to lock.





Move the gear with hand clockwise until it is fully wound, and the bullets will be sent up automatically. (It can send about 150 rounds automatically.)

The magazine is capable of Containing 500 BB bullets.



Slide the rib in the arrow direction to remove remaining BB bullets. (Be careful since BB bullets may jump out.)



Always use the BB bullets for the air gun. We shall not be held responsible for any damage or accidents arising from the use of bullets supplied by other manufacturers.

[back to top](#)

#### Echo 1 AK CPM AEG Moveable Parts

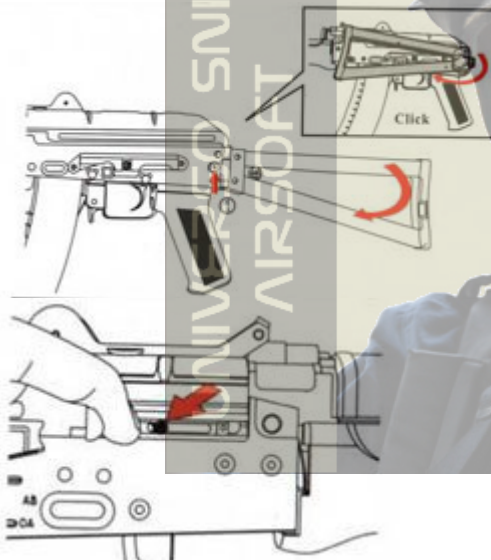

Variable hop-up adjustment lever

Caution: Be careful so that your skin and fingers do not get caught in the folding parts. Press the gun stock release button 1, move forward the gun stock.

#### Installation of the eliminate blaze implemen

1. While pressing the lock button.
2. The eliminate blaze implement is fixed by counterclockwise as in the case of real gun.

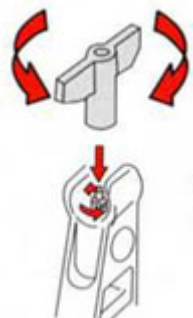

Insert the front sight adjustment tool in the

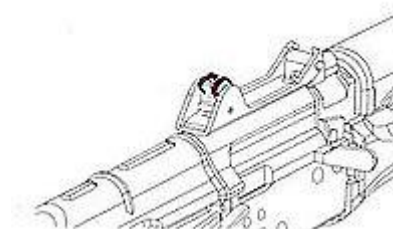

Rear Sight:

front sight and turn it for adjustment.  
Counterclockwise: lower sight point  
Clockwise: higher sight point

Be careful so as not to lose the adjustment tool.

Turn to front: short distance  
Turn to rear: Long distance

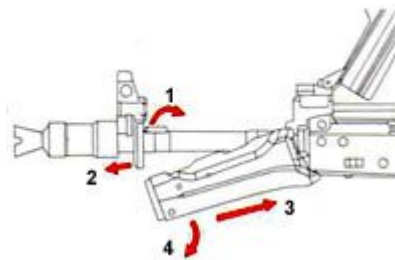
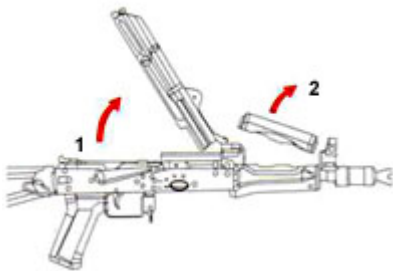

Setting the hand guard

Need to open the upper cover to take out the upper hand guard set. Put the upper hand guard set first to close the upper receiver

[back to top](#)

Pull the lower hand guard locking lever back, and push the fasten base ahead. Pull back the lower hand guard back and won to take off the lower hand guard.

### Echo 1 AK CPM AEG Firing

1 Set the selector lever to Semi or Full Auto.

2 Pull the trigger



Caution: A blank firing may occur at triggering after the magazin, this is the normal operation of the gun.

1. Set the selector lever to Semi or Full auto.
2. Pull the trigger.

### Caution on Motor and Battery After Operation

Charge the battery if the firing cycle becomes slow.

Give the air gun a rest for 5 to 10 minutes after firing about 500 rounds, in order to ensure long service lives of the motor and battery.

**When Bullets are Clogged** If bullets are clogged, remove them and apply a few drops of silicone oil in to the chamber from the magazine entrances shown or spray silicone oil for 0.5 or 1 sec, to obtain smooth continuous.

[back to top](#)

## Echo 1 AK CPM AEG After Operation

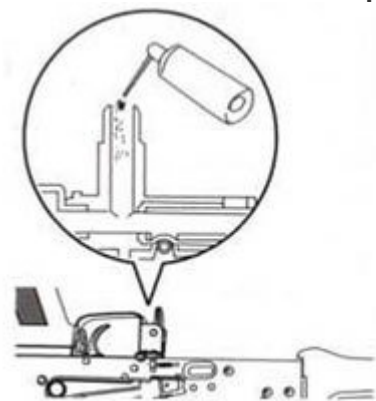

### After Operation

Remove the magazine and dry fire the gun in the semi auto mode directing the muzzle to a safe direction. (Otherwise the spring may be weakened.) Set the selector to the Safe position.

Bullets may remain in the chamber even if the magazine contains no bullets (or if the magazine is not connect) (Two or three bullets may drop from the magazine, this is the normal operator of the gun.)

Always disconnect the battery and attach the protective cap whenever you do not operate the air gun.

**Always attach the protective cap during storage**

### Caution

There are possible cases that no firing occurs after pulling the trigger in the semi-auto mode. In this case, do not pull the trigger furiously. Fire 5 to 6 shots in the full auto mode and then return to the semi auto operation.

Smell may be generated from motor for a while when a new air gun is operated. This is the normal operation of the gun.

The hopping up operation may be unstable for 200 to 300 rounds after using silicone oil, this is the normal operation of the gun.

[back to top](#)

### TROUBLE CLINIC (Troubleshooting)

Symptom	Cause	Action
No operation at all	Selector level is set to safety	Set the selector lever to Semi or Full Auto
	Battery is not charged.	Charge the battery.
	Battery connector is disconnected.	Connect the connector.
	The + and - or battery connector is reverse.	Connect the connector correctly (check the fuse)
	Fuse is blown out.	Replace the fuse.
Although motor is moving, no bullet jump out.	Expired motor life (50,000 to 60,000 rounds) or poor electrical connection.	Replace the motor (purchasing from your dealer or check and repair the contacts)
	BBs are clogged in the magazine.	Insert the charging rod into the magazine and move up and down a few times to remove clogged bullets.
	BBs are clogged in the chamber.	Remove clogged bullets using the cleaning rod.
Impossible full-auto operation (automatic firing)	Faulty gear	Purchase the replacement gear from your dealer and repair.
	Insufficient battery power	Charge the battery
	Faulty BBs feed of magazine	Repair clogging of the magazine.
Impossible semi-auto operation (single shot)	Poor electrical connection	Consult your dealer for overhaul maintenance or repair.
	Deviation in gear timing	Set to semi auto after firing 5 to 6 rounds in full auto.

**Never use BBs other than those supplied by us. Use of poor quality BB bullets will cause problems. Never disassemble or modify the gun.**

Symptom	Cause	Action
Impossible semi-auto operation (single shot)	Insufficient battery power	Charge the battery
Automatic firing cycles become long.	Insufficient battery power	Charge the battery
Shooting distance become shorter	Worn or damaged chamber packing (O-ring) Worn or damaged chamber packing. Deteriorated piston spring Faulty BBs (too small or too heavy) Shortage of damaged gear	Consult your dealer for overhaul maintenance or repair. Replace the chamber packing, piston assembly. Use genuine BBs. Drop a few drops of silicone oil from under the chamber.
Too loud operating noise	Gear problem caused by too many blank firing Gear problem caused by too many blank firing	Consult your dealer for overhaul maintenance, part replacement (gear, etc.) or repair.
Bullets being fallen out from barrel end	Worn or damaged chamber packing NO hop setting Faulty BBs (too small)	Turn the hop adjustment dial toward HOP Use genuine BBs.
Being wet by or dropped into water (rain)	Stop operation immediately, disconnect the battery, wipe off water from inside the main body and the battery, and, after complete dry, carry out trial firing. If no operation or malfunction is detected, consult your dealer or us for repair.	

[back to top](#)

### Echo 1 AK CPM AEG Variable Hop Up System

By producing a back-spin to the BB bullets, this system allows for straighter and longer distance shooting than normal air gun. Unlike the fixed type, the variable hop up system permits one-touch adjustments using the dial and lever, making it an ideal hop up system.

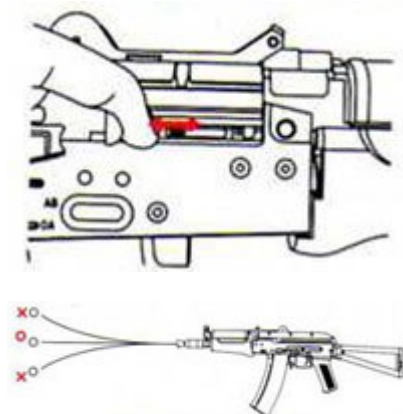

Adjustment Procedure (Adjust by carry out trial firing)

Gradually turn the adjustment dial towards Hop to give hop up to bullets. (The best setting is where bullets fly horizontally.)

Turning excessively adversely affects the trajectory. So stop turning the hop adjustment lever when bullets fly horizontally.

The best position is where the bullets fly horizontally, and the longest flying distance is obtained.

Too much hop-up (return the lever towards NORMAL)

Straight best position

Not enough hop-up (return the lever towards NORMAL)



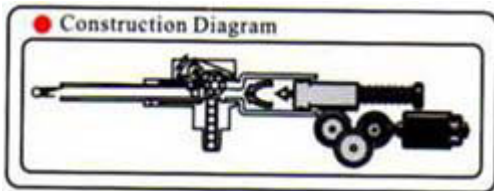

Operational Caution: Strictly observe the following caution)

Moving the lever too much towards HOP causes bullets to clog. Firing the gun with clogged bullets damages the piston and gears.

If bullet clogging occurs, immediately stop firing the gun, return the hop lever to the Normal positioning and remove clogged bullets using cleaning rod.

Make sure to return the hop adjustment lever to the Normal position when removing clogged bullets or cleaning. (Otherwise, the chamber packing is damaged.)

Never use used or dirty bullets. (Otherwise, the chamber becomes dirty, resulting in unstable hopping up.)

When about 10,000 rounds are fired, spray silicone oil into the chamber for 0.5 to 1 sec. (See 11 on page 8. The hopping up operation may be unstable for 200 to 300 rounds after spraying the silicone oil, this is the normal operation of the gun.)

We will not be held responsible for any damage or accidents arising from wrongful operation, disassembly and modification of the gun. Any costs for repair of such damage shall be paid by the user.

**Caution:** If the hop-up is adjusted excessively causing clogging of bullets, immediately stop operating the gun. Return the lever to Normal, fire to 2 or 3 shots and readjust. Since a precision tight barrel is used, use of dirty bullets or those with burrs causes clogging of bullets and possible fatal damage to the mechanical box and system.

**Warning:** Never hold the gun side ways the Bb bullets will curve right or left. This is due to the HOP-UP adjustment.

[back to top](#)

#### When Hopping Up is Improper

Symptom	Cause	Action
Bullets flying upwards.	Too much setting	Gradually return adjustment lever towards normal
Short flying distance of bullets (less hopping up effect)	Too much hop setting	Gradually return adjustment lever towards Normal.
	Hop packing contaminated by oil or dirt.	Fire bullets equivalent to 4 or 5 magazine or clean the chamber using cleaning rod
	Worn or damage hop packing	Purchase the replacement part at your dealer
Cannot adjust	Damaged adjustment lever or other parts	Purchase the replacement part at your dealer and replace it.
Frequent bullets clogging	Too much hop setting	Gradually return adjustment lever towards normal.
	Improper or too large sized BB bullets	Use the BB bullets for Electric Gun.
	Dirty hop packing	Clean using the cleaning rod or consult your dealer for repair.

[back to top](#)



## Echo 1 AK CPM AEG Maintenance

### 1. Fuse replacement procedure

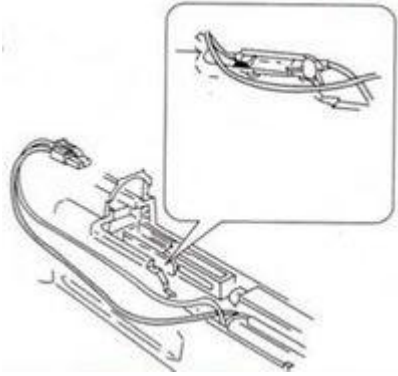

### 2. Removing Clogged Bullets (Set the Safety button to ON and remove the magazine beforehand.)

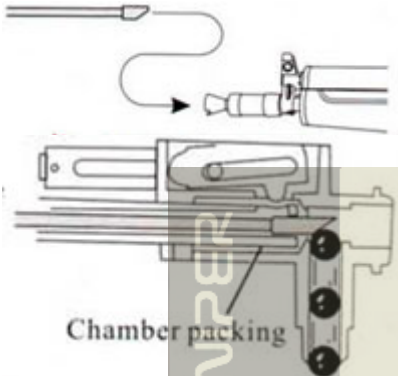

Insert the Cleaning rod into the bore.

Be careful so that the angled part of the Cleaning Rod faces down, and remove clogged bullets

**Caution:** The ornamental can not be used for cleaning the obstruct bullets.

Make sure to insert the cleaning rod **AFTER** returning the hop up lever to the Normal position. (Hop-OFF)

### 3. Maintenance when ball speed becomes low

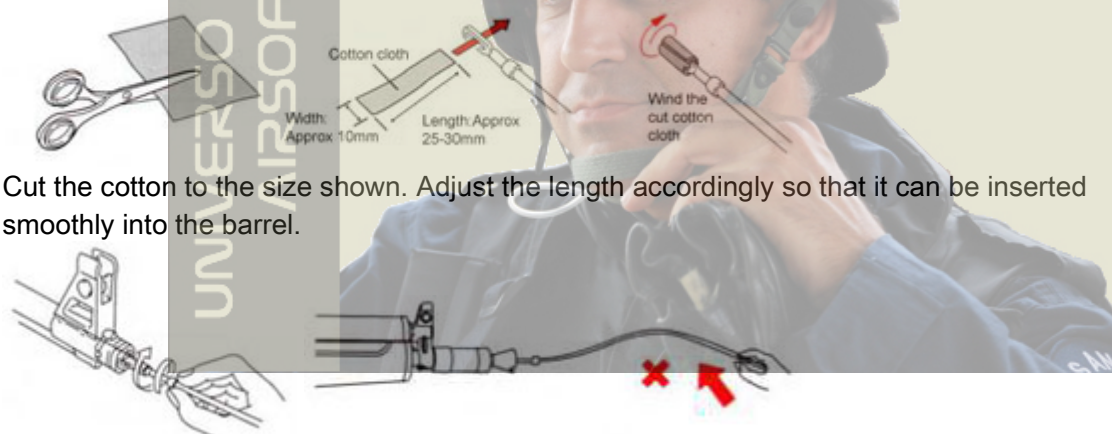

Cut the cotton to the size shown. Adjust the length accordingly so that it can be inserted smoothly into the barrel.

Hold at the leading end of the rod and insert the rod into the barrel while turning the rod.

**Caution:** Inserting the rod will be difficult if you hold rod at the end.



1. Apply a few drops of silicone from the bullet entrance, insert BB bullets into the magazine and fire bullets and fire bullets equivalent to 1 or 2 magazine.

2. To complete the cleaning, Use the cleaning rod (with cotton) as shown, to remove excess oil.

**Caution:** Since the chamber is a precision component, avoid use of used BB bullets.

Always carry out maintenance **AFTER** returning the hop up lever to the Normal position.

(Hop-OFF)

[back to top](#)

## Fine Adjustment of Gear Engagement



Remove the screw from the grip bottom.

M3 hexagon wrench

Insert M3 hexagon wrench into the screw hole adjust

**Caution:** Only when the motor noise becomes high after operations for a long period of time, conduct the fine adjustment as shown.

Hold the grip during adjustment. Otherwise, the main body will drop since the grip set screw is removed.

It is recommended to lock the adjustment screw by a screw locking agent or instantaneous adhesive after adjustment of the motor position is complete.

Normally, do not attempt to adjust.

Be careful not to overly tighten screw as it will damage the gun.

[back to top](#)

## Echo 1 AK CPM AEG Parts

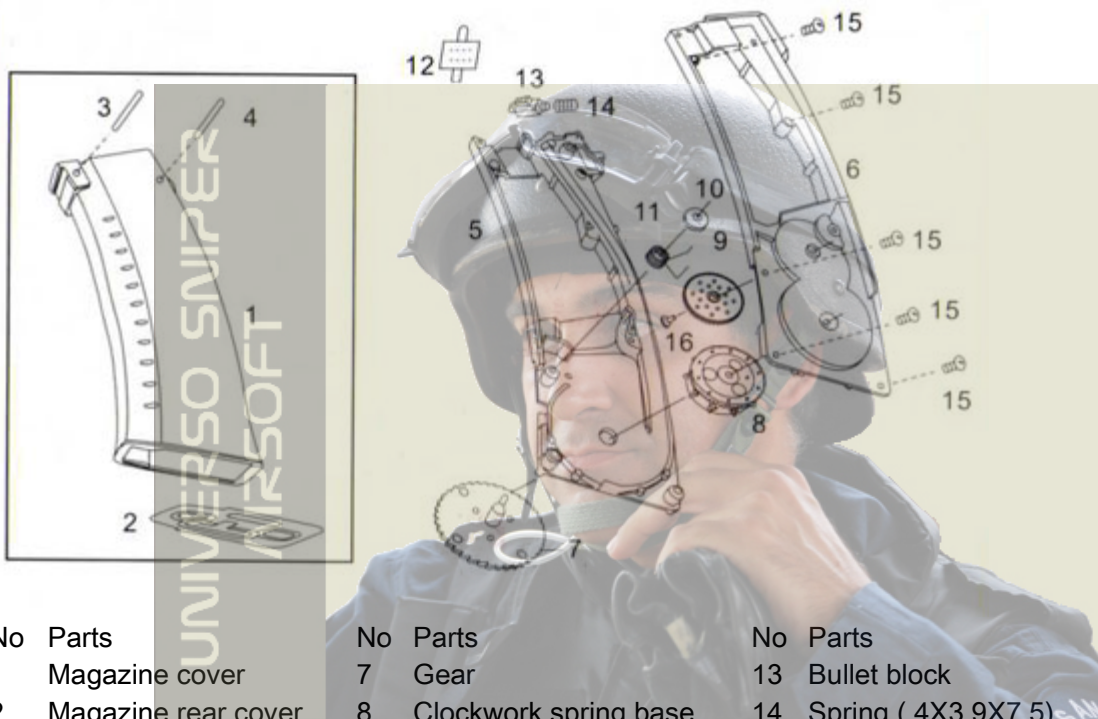

No	Parts	No	Parts	No	Parts
1	Magazine cover	7	Gear	13	Bullet block
2	Magazine rear cover	8	Clockwork spring base	14	Spring (.4X3.9X7.5)
3	Shaft 2X21.5	9	Driver	15	PAHO 2.6X10
4	Shaft 2X251.5	10	Gear	16	Ballistic transition nail
5	Right trajectory	11	Gear Spring		
6	Left trajectory	12	Magazine Cover		

[back to top](#)

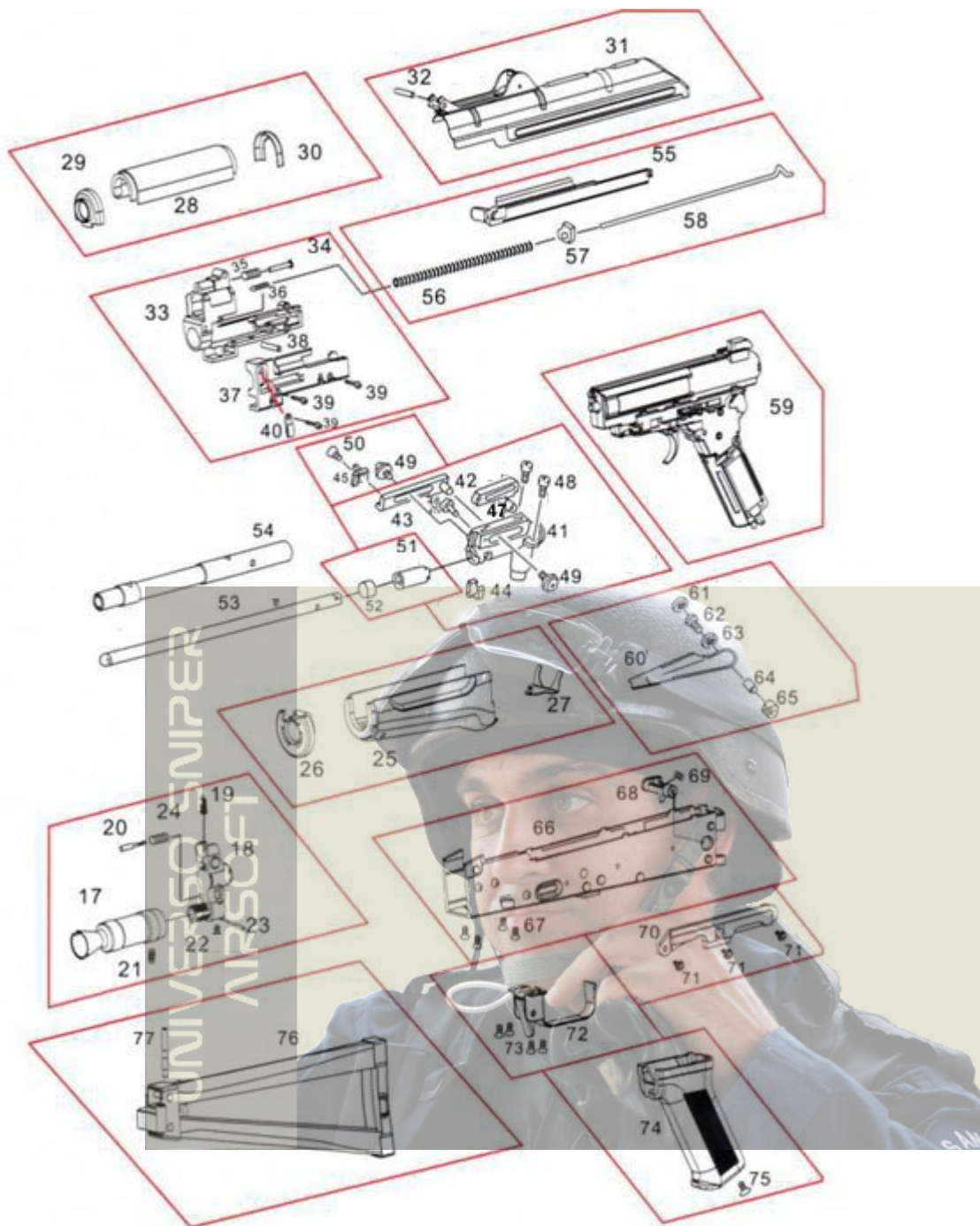

No	Parts	No	Parts	No	Parts
17	Silencer	38	4X24 Shaft	59	Main gear box
18	Front gun tip	39	M3X15 PMHO	60	Fire selector
19	Front sight	40	Gun Barrel Connect Link	61	Outer fire selector
20	Silencer fix stalk	41	HOP-UP	62	M4X10 TMHO
21	M3X6 Screw	42	Rubber selector	63	Fire selector ring
22	M3X4 KMHO	43	Selector	64	Fire selector copy barrel
23	2.5X10 Shaft	44	Gun Barrel Connect Link	65	Located slice
24	Spring (.4X4.1X16X127)	45	Block	66	Gun body
25	Down gun guard	46	Nail	67	M3X8 KMHO
26	Down gun guard front cap	47	HOP-UP cylinder Rubber	68	Gunstock lockpin
27	Down gun guard steel slice	48	2.3X8 PWAHO d=5	69	Lockpin Spring
28	Up gun guard	49	2X4 PWAHO d=5	70	Slide rail
29	Up gun guard front cap	50	2X4 KBHO	71	M3X6 TMHO Inner



- |                              |                           |                         |
|------------------------------|---------------------------|-------------------------|
| 30 Up gun guard cap          | 51 Hop-Up Rubber          | 72 Rigger loop          |
| 31 Gun body cover            | 52 Inner barrel sleeve    | 73 M3X8 PMHO            |
| 32 4X17 Sell to Nail         | 53 Inner barrel           | 74 Gun grip             |
| 33 Right HOP-UP seat         | 54 Inner barrel           | 75 M4X5 TMHO            |
| 34 4X27 the hat sell to nail | 55 Cocking Lever          | 76 Gunstock             |
| 35 Spring 1.1X6.7X266X18T    | 56 Spring (.45X139X54T)   | 77 Gunstock Joint shaft |
| 36 Spring .4X3.41X18X18T     | 57 Spring located slice   |                         |
| 37 Left HOP-UP Seat          | 58 Gun Body Cover release |                         |

[back to top](#)

### Echo 1 AK CPM AEG Warning

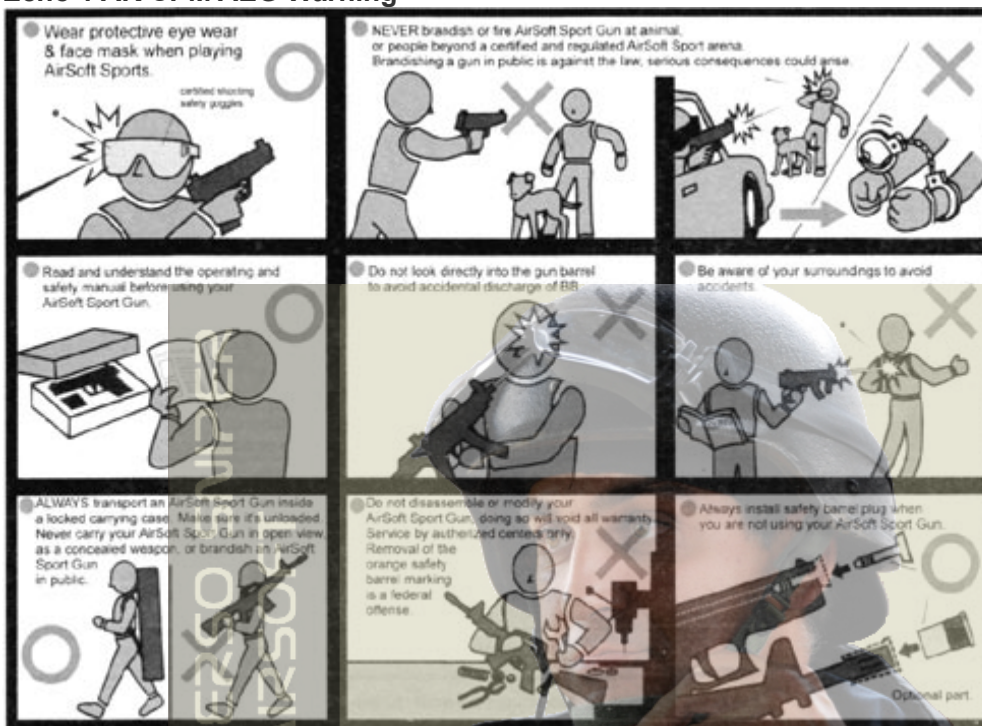

This product is an airsoft airgun, it is to be purchased by person(s) age eighteen (18) years or older. Adult / parental supervision is required when used by any person under age of eighteen.

Be responsible, check with your local law enforcement on airsoft airgun regulations.

Please read the operation manual and fully understand the safe handling of your airsoft airgun before use.

Pay special attention to your surrounding when using your airsoft airgun. Do not carry your airsoft airgun in public, in open view or concealed. Transport your airsoft airgun unloaded, in locked gun carrier / case. Do not brandish, point, or shoot at other people, animal, or private properties. Such actions may be preceived by others (including law enforcement officer) as a threat and prompt to react accordingly.

U.S. federal regulation requires the orange marking, do not remove, alter or impair marking.

All warranty void if markings(s) are tempered. This airsoft airgun is for safety & handling training purpose, movie and theatrical production application, regulated airsoft sport at participating playing field and shooting range. Ask your airsoft dealer for details.

Store your airsoft airgun unloaded, remove batteries, discharged of any gas or spring tension. In a safe and locked location; out of the reach of children.