

UNIVERSO SNIPER
AIRSOFT

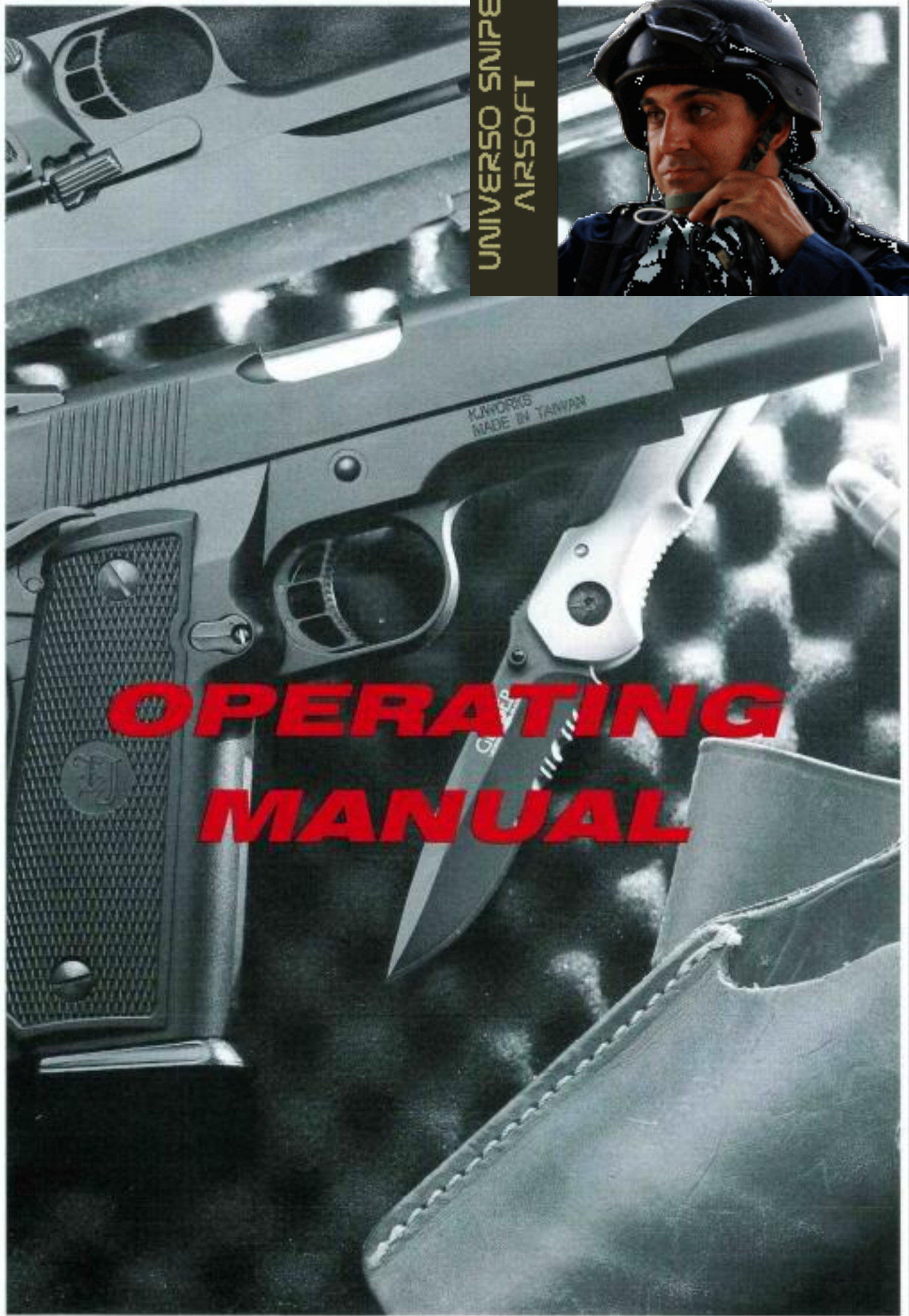

**OPERATING
MANUAL**



WARNING: BEFORE USAGE, THE INSTRUCTION
MUSE BE READ.



THANK YOU FOR PURCHASING. THE FOLLOWING ATTENTION POINTS AND INSTRUCTIONS
MUST BE READ. SHOOTING WITHOUT CAUTION OR USED IMPROPERLY, BLINDNESS OR
INJURIES COULD BE LEAD.



DO NOT POINT AT PEOPLE OR ANIMAL.



GUN AND GAS MUST BE PLACED IN AREA WHERE
TEMPERATURE IS OVER 40 °C



PLACE IN GUN CASE WHEN NOT IN USING OR TRANSPORTING



DO NOT USE GAS WHICH PRESSURE OVER 12 Kgs/cm²



UNAUTHORIZED RECONSTRUCTION OF AIR SOFT GUN TO STRENGTHEN FIRING FUNCTION IS STRICTLY PROHIBITED.



BE CAREFULL WHAT TARGET YOU SHOOT



EYE PROTECTION DEVICE MUST BE EQUIPPED



DO NOT LOAD ANYTHING BUT BB BULLETS.



DO NOT LOOK THROUGH THE BARREL



PLEASE SHOOT IN SAFE PLACE

NAME OF PARTS

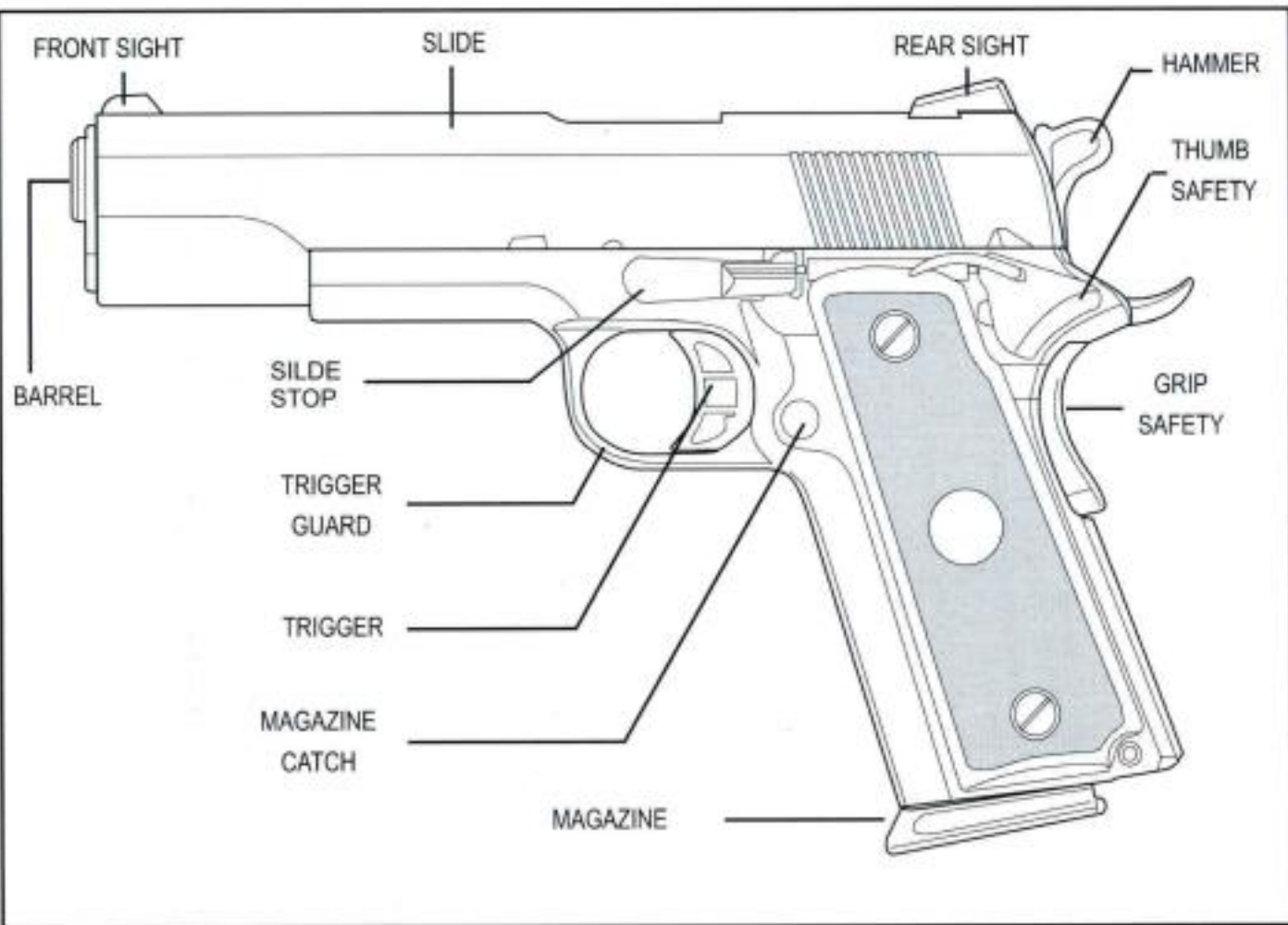

MAGAZINE

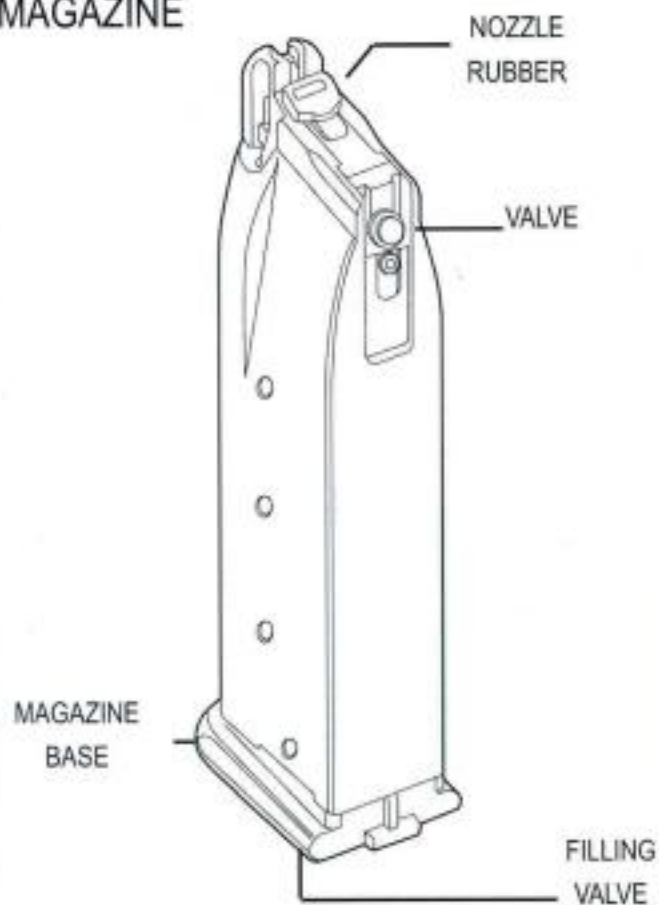

LOADER

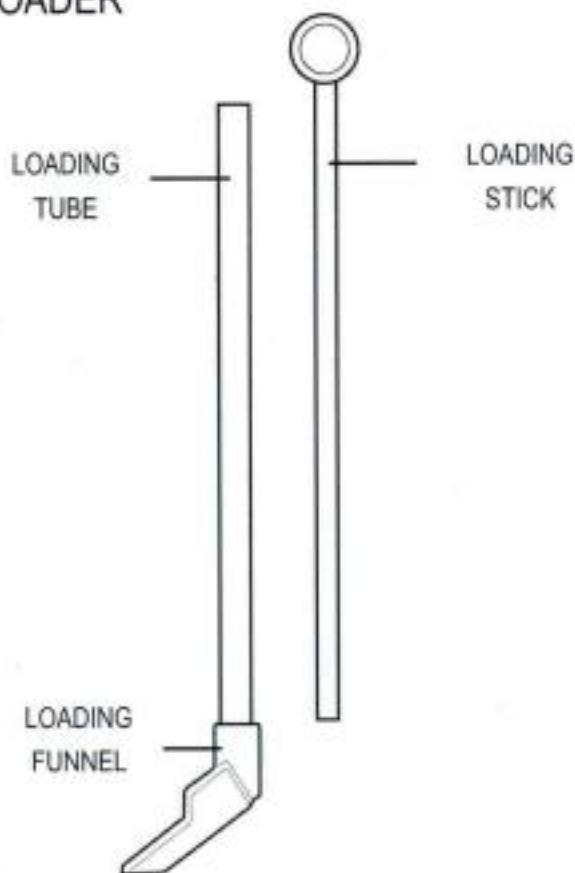

OPATION

1.REMOVE THE MAGAZINE



PRESS MAGAZINE CATCH AND REMOVE MAGAZINE

2.FILLING GAS

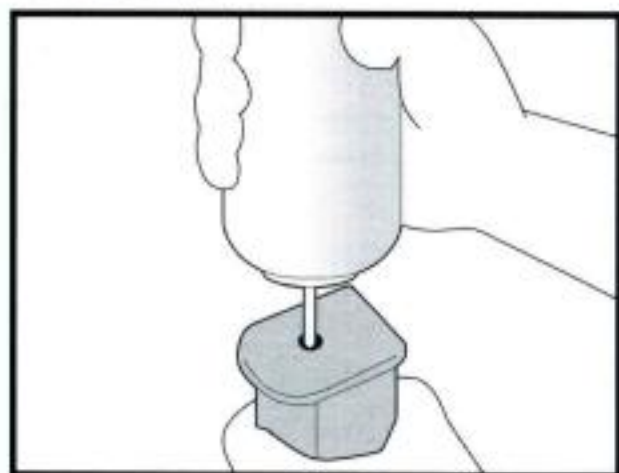

FILL THE GAS BOTTLE TO THE MAGAZINE IN VERTICAL DIRECTION.



NOTICE THE FILLING ANGLE

3.LOAD BB BULLETS

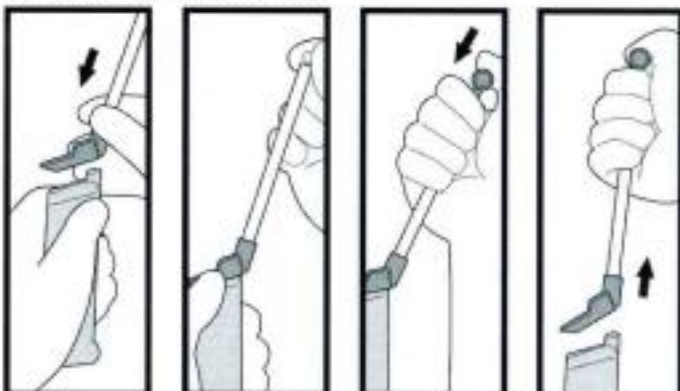

FOLLOW THE INSTRUCTION

4.INSERT MAGAZINE

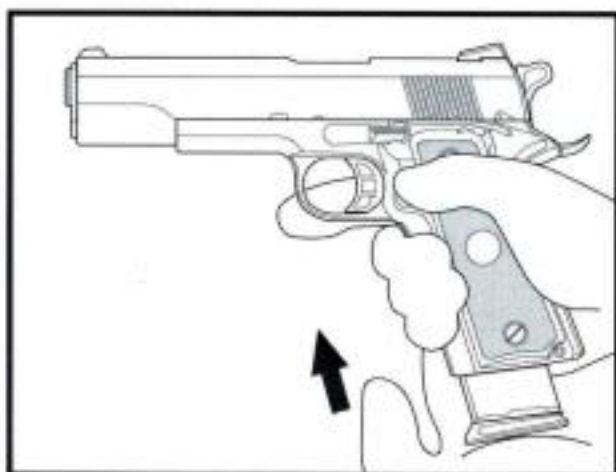

5.LOAD

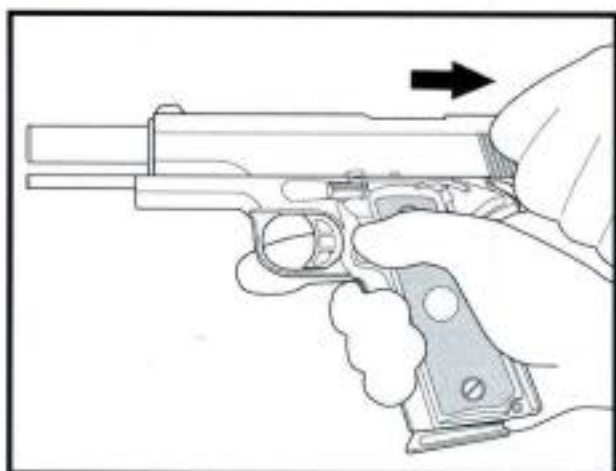

PULL THE SLIDE COMPLETELY TO THE REAR

6.SAFETY



THUMB SAFETY
UP=ON/SAFE



THUMB SAFETY
DOWN=OFF/FIRE

DISASSEMBLY

1.REMOVE THE MAGAZINE



PRESS MAGAZINE CATCH AND REMOVE MAGAZINE

2.REMOVE THE RECOIL SPRING AND RECOIL SPRING CAP

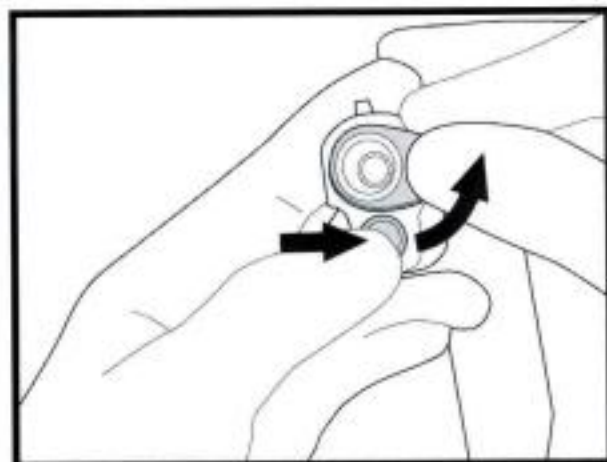

DEPRESS RECOIL SPRING CAP AND ROTATE BARREL BUSHING

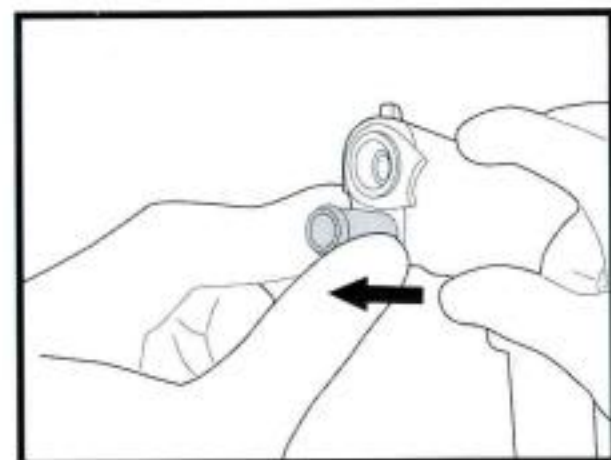

REMOVE RECOIL SPRING CAP



PRESS GRIP SAFETY=OFF/FIRE

7.FIRE

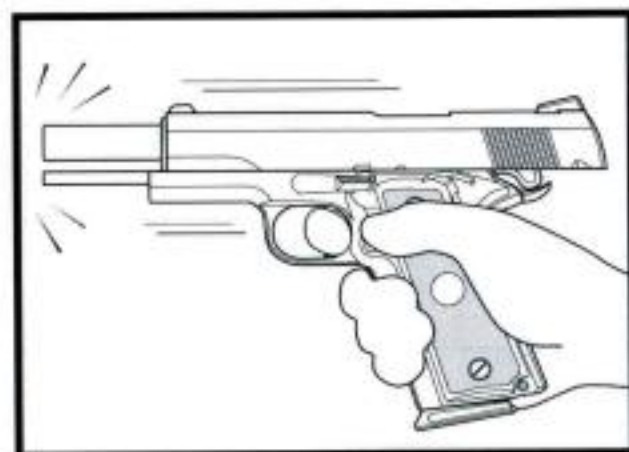

PULL THE TRIGGER



AFTER THE LAST SHOT IS FIRED, SLIDE WILL STOP IN THE REAR . CHECK THE CHAMBER AND MAKE SURE THE CHAMBER IS EMPTY.PRESS THE SLIDE STOP DOWN OUT OF ITS LOCKING NOTCH TO ALLOW THE SLIDE TO MOVE FORWARD.IF A LOADED MAGAZINE IS INSERTED AND THE SLIDE STOP IS PUSHED DOWN,THE SLIDE WILL LOAD A FRESH CARTRIDGE FROM THE MAGAZINE INTO THE CHAMBER, AND THE PISTOL IS READY TO FIRE.

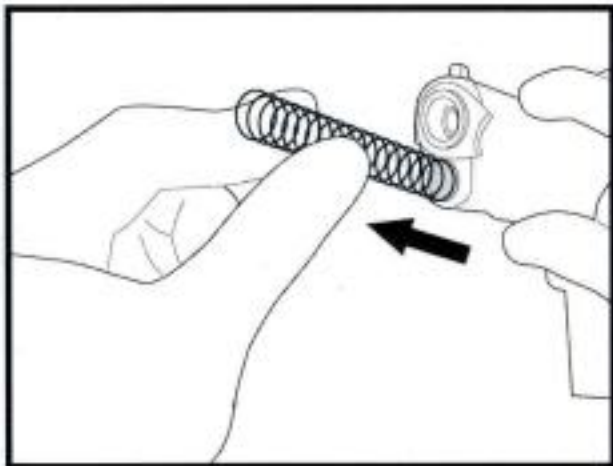

REMOVE RECOIL SPRING.

3.REMOVE THE SLIDE STOP

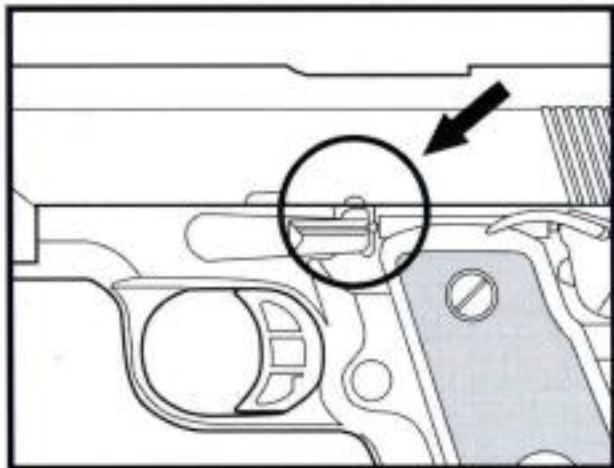

MOVE THE SLIDE REAR UNTIL THE TAKEDOWN NOTCH IS JUST ABOVE THE SLIDE STOP TAB.

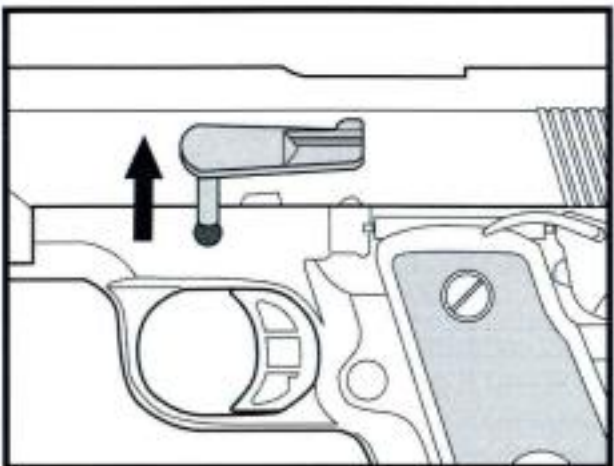

REMOVE THE SLIDE STOP BY PULLING IT STRAIGHT OUT.

4.REMOVE THE SLIDE

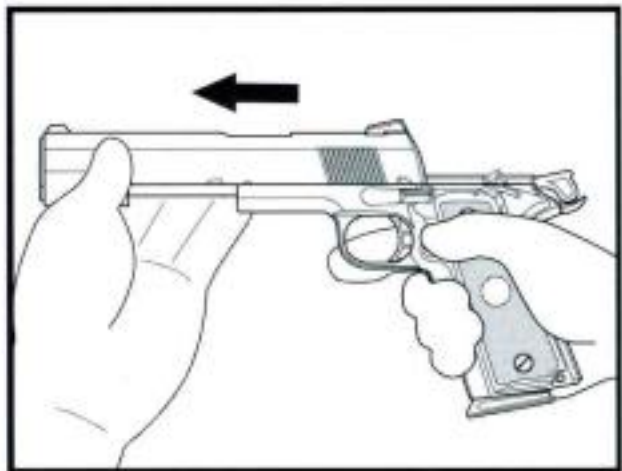

5.REMOVE THE BARREL

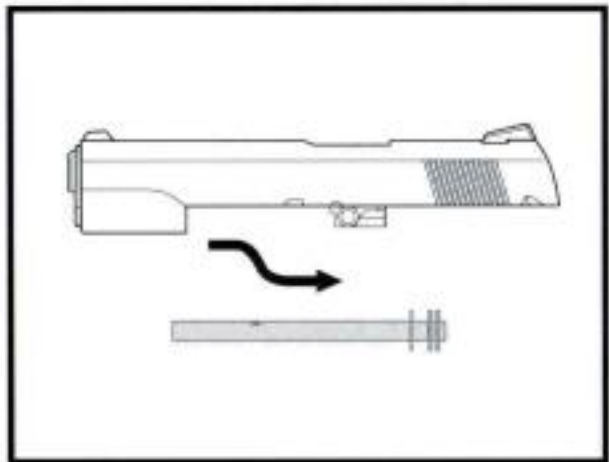

REMOVE THE RECOIL SPRING GUIDE.

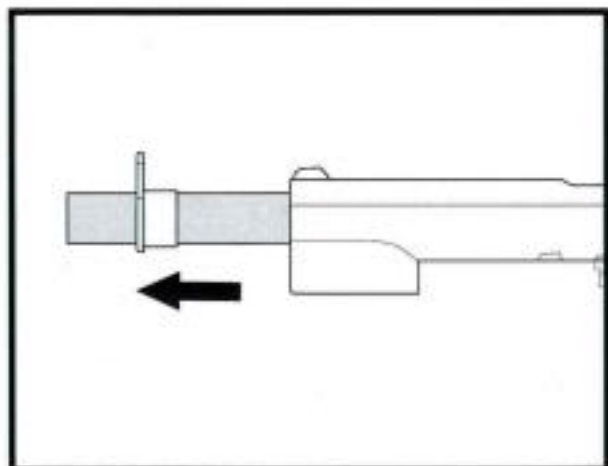

REMOVE THE BARREL BUSHING AND BARREL.

REASSEMBLY

REVERSE THE DISASSEMBLY ORDER

MAINTENANCE

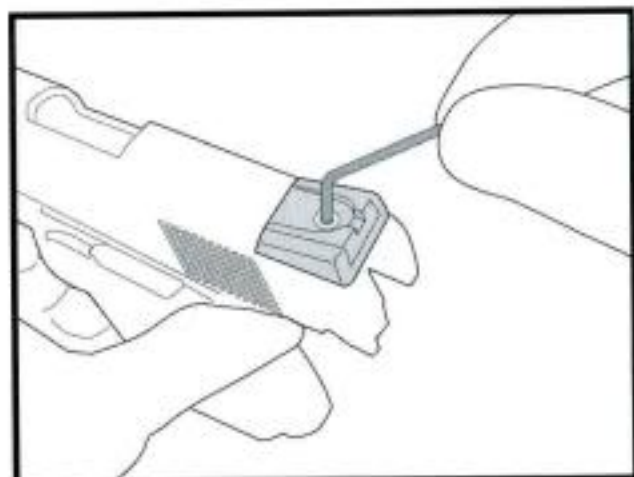

NOTICE THE SCREW. IF THE SCREW IS LOOSE,
SCREW IT TIGHT.

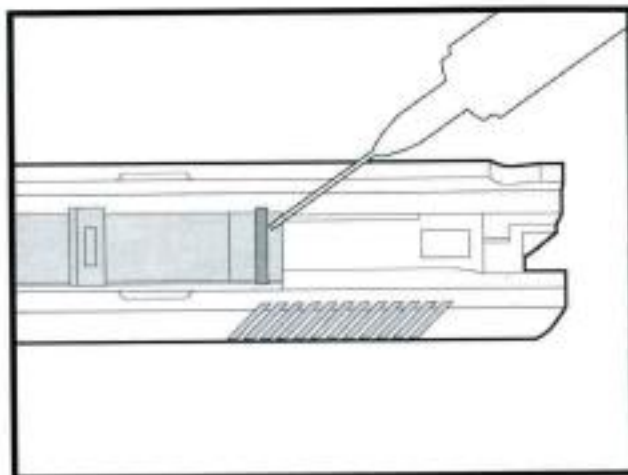

OIL THE O-RING.

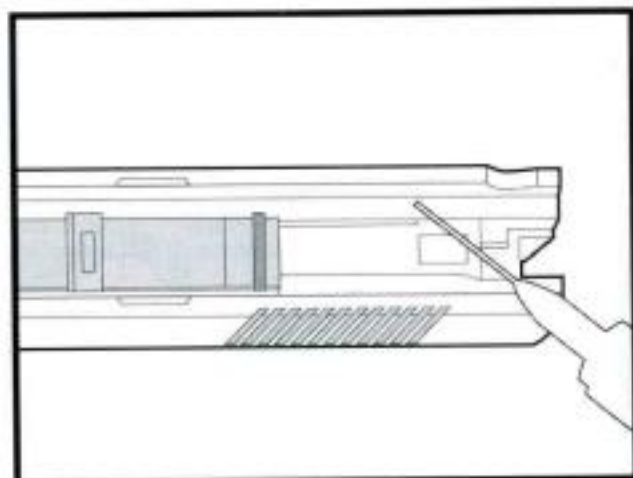

OIL THE GROOVE

NOTE

EXPLODED DRAWING 1

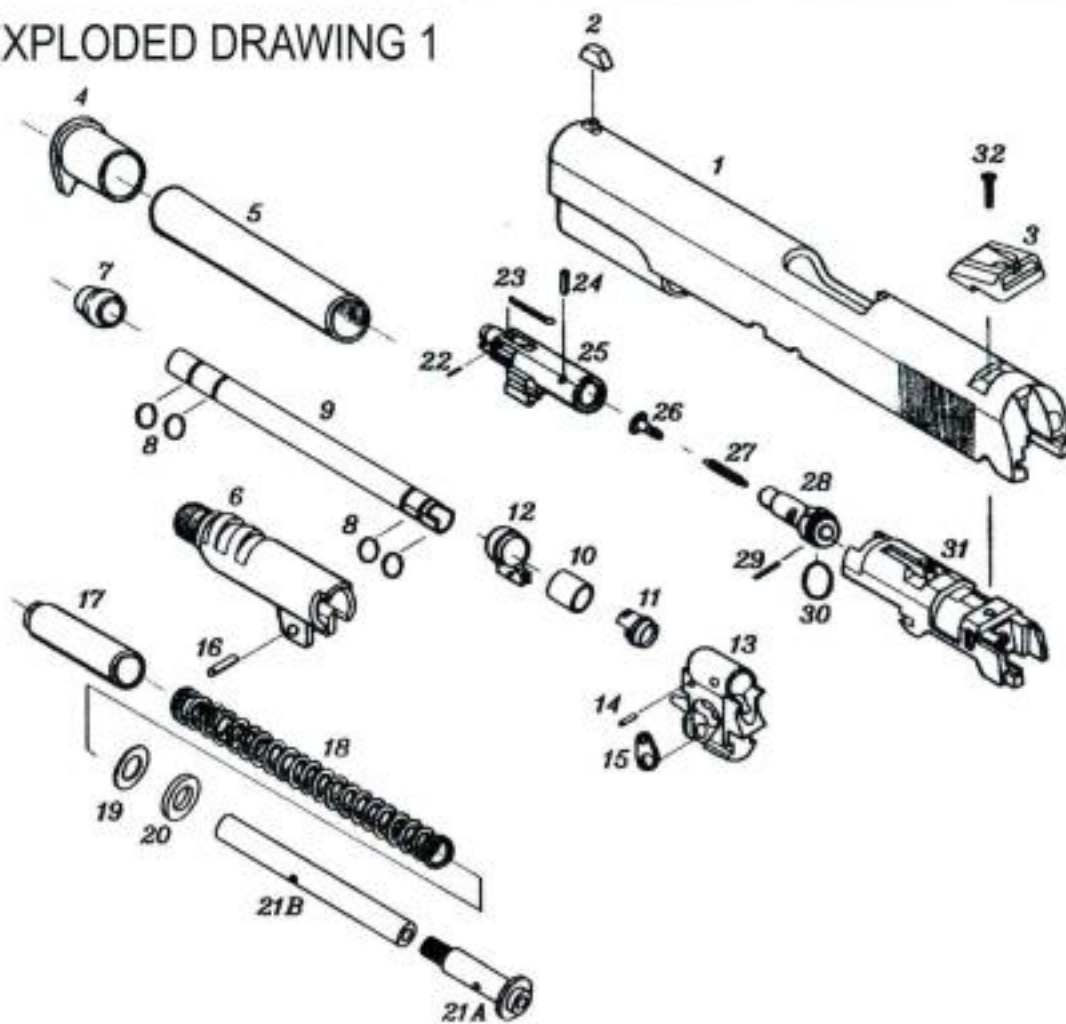

NO.	NAME	PRICE	NO.	NAME	PRICE
1	SLIDE	500	18	RECOIL SPRING	60
2	FRONT SIGHT	100	19	RECOIL SPRING WASHER	20
3	REAR SIGHT	100	20	RECOIL SPRING PAD	20
4	BARREL BUSHING	100	21A	RECOIL SPRING GUIDE A	120
5	OUTTER BARREL	300	21B	RECOIL SPRING GUIDE B	120
6	OUTTER CHAMBEER	150	22	VALVE SPRING FIXED PIN	10
7	INNER BARREL GUIDE	60	23	PISTON SPRING FIXED PIN	20
8	INNER BARREL O RING	10	24	PISTON SPRING	10
9	INNER BARREL	200	25	NOZZLE	200
10	RUBBER CHAMBER GUIDE	50	26	VALVE	40
11	RUBBER CHAMBER	60	27	VALVE SPRING	20
12	INNER BARREL FIXER	60	28	PISTON	100
13	INNER BARREL BASE	150	29	VALVE SPRING FIXED SPRING	10
14	INNER BARREL	10	30	PISTON O-RING	20
15	BARREL LINK	50	31	CYLINDER	300
16	OUTTER BARREL FIXED PIN	10	32	CYLINDER SCREW	20
17	RECOIL SPRING CAP	150			

EXPLODED DRAWING 2

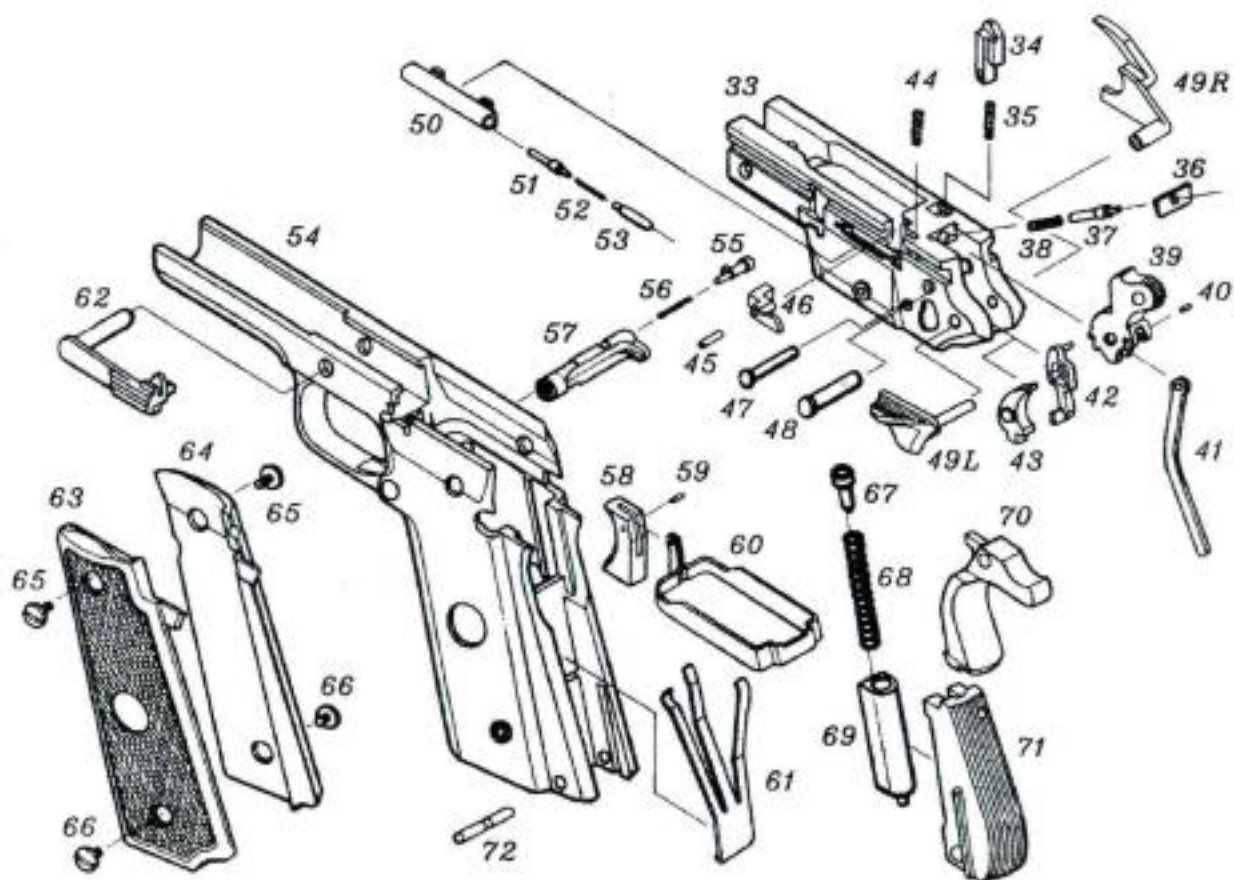

NO.	NAME	PRICE	NO.	NAME	PRICE
33	INNER FRAME	400	53	THUMB SAFETY PLUNGER	20
34	DISCONNECTOR A	50	54	FRAME	500
35	DISCONNECTOR SPRING	15	55	MAGAZINE CATCH LOCK	30
36	FIRING PIN STOP	20	56	MAGAZINE CATCH SPRING	10
37	FIRING PIN	50	57	MAGAZINE CATCH	100
38	FIRING PIN SPRING	15	58	TRIGGER	80
39	HAMMER	150	59	TRIGGER PIN	10
40	HAMMER STURT PIN	10	60	TRIGGER LINK	120
41	HAMMER STURT	50	61	SEAR SPRING	100
42	DISCONNECTOR B	50	62	SLIDE STOP	120
43	SEAR	50	63	LEFT GRIP	80
44	VALVE STOP SPRING	15	64	RIGHT GRIP	80
45	VALVE STOP PIN	30	65	GRIP SCREW(LONG)	25
46	VALVE STOP	50	66	GRIP SCREW(SHORT)	25
47	SEAR PIN	20	67	MAINSRING CAP	50
48	HAMMER PIN	30	68	MAINSRING	50
49L	THUMB SAFETY LEFT	120	69	INNERE MAINSRING HOUSING	70
49R	THUMB SAFETY RIGHT	120	70	GRIP SAFETY	150
50	SLIDE STOP PLUNGER TUBE	50	71	OUTTER MAINSRING HOUSING	150
51	SLIDE STOP PLUNGER	20	72	MAINSRING HOUSING PIN	30
52	PLUNGER SPRING	15			

EXPLODED DRAWING 3

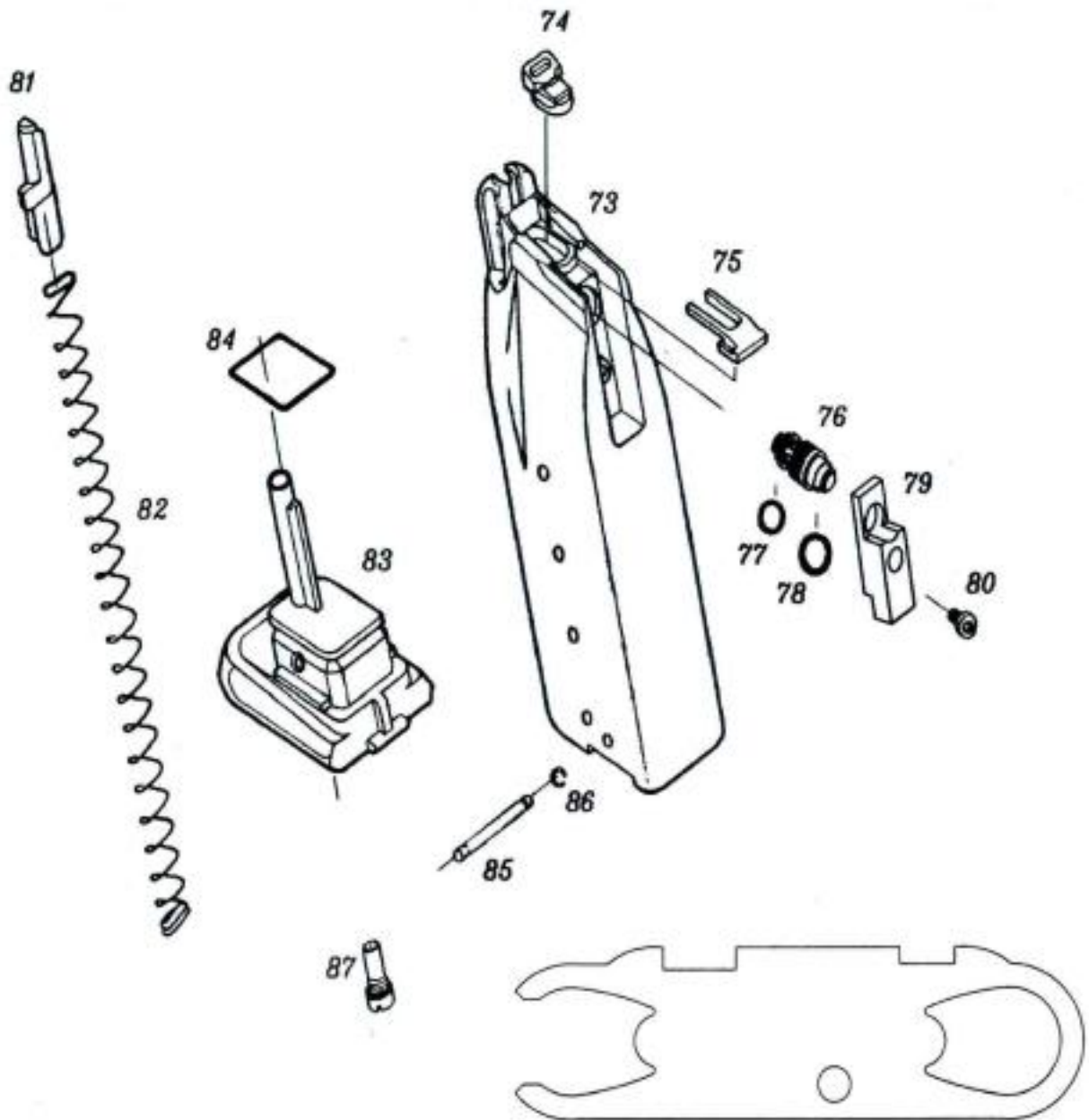

BARREL BUSHING WRENCH

NO.	NAME	PRICE	NO.	NAME	PRICE
73	MAGAZINE CASE	500	81	FOLLOWER	50
74	NOZZLE RUBER	80	82	FOLLOWER SPRING	70
75	NOZZLE RUBER FIXER	50	83	MAGAZINE BASE	160
76	VALVE	200	84	MAGAZINE BASE PACKING	40
77	VALVE O-RING A	10	85	MAGAZINE BASE PIN	160
78	VALVE O-RING B	10	86	MAGAZINE BASE PIN WASHER	10
79	VALVE FIXER	80	87	FILLING VALVE	50
80	VALVE FIXER SCREW	20		BARREL BUSHING WRENCH	100