

# M92FS OPERATION MANUAL

## SUPER BLOW BACK MODEL

**KWC®**

UNIVERSO SNIPER  
AIRSOFT



NO.KG-11HK SERIES  
FOR MORE THAN 14 YEARS OLD

**KWC®**

建瑋玩具工業股份有限公司  
KIEN WELL TOY INDUSTRIAL CO., LTD.

地址：台南市東門路3段308巷22號

TEL：(06)2691815-7

FAX：(06)2698364

E-MAIL：kwc@ms8.hinet.net

HOME PAGE：www.kwc.com.tw



# OPERATION MANUAL



## 1 PULL OUT THE MAGAZINE

PRESS THE MAGAZINE CATCH ON THE LEFT SIDE OF GRIP, THEN PULL OUT THE MAGAZINE •  
\* BE CAREFUL, THE MAGAZINE IS HEAVY, PLEASE DON'T LET IT DROP DOWN TO THE GROUND •

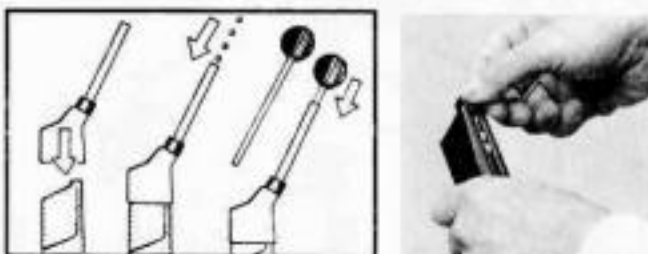

## 2 BB BULLET LOADING

PUT THE BULLET LOADER ON THE MAGAZINE, AND FEED LOADER WITH 15 PIECES BULLET, THEN PRESS THESE 15 PIECES BULLET TO THE MAGAZINE (IT IS POSSIBLE TO PRESS BULLET INTO THE MAGAZINE BY HAND ONE BY ONE • )

## 3 GAS CHARGING

USE KWC'S GAS BOMBE TO CHARGE GAS FROM THE VALVE ON THE BOTTOM OF MAGAZINE • (PUT MAGAZINE UP SIDE DOWN, THEN CHARGE GAS) WHEN THE GAS OVERFLOW, THE GAS TUNK IS FULL •

- \* PULL OUT THE MAGAZINE FOR CHARGING GAS AFTER FINISH IT, PLEASE PLACE THE MAGAZINE FOR A MOMENT TO LET THE GAS EVAPORATE COMPLETELY •
- \* IT IS POSSIBLE TO SHOOT 4 MAGAZINE BY ONCE CHANGING • PLEASE DON'T USE OTHER GAS THAN THE PECULIAR ONES • IT WILL HURT THE GUN •



## 4 MAGAZINE SETTING

PUT THE MAGAZINE BACK TO THE GUN FIRMLY, TILL IT SOUND "KYA"



SAFETY OFF :

## 5 SAFETY OPERATION

SWITCH THE SAFETY LEVER (ON THE REAR SIDE OF SLIDE) TO THE RED POINT DIRECTION, THEN THE SAFETY IS LOCKED • IT IS POSSIBLE TO LOCK THE SAFETY FROM TWO SIDE'S SAFETY LEVER • IT IS POSSIBLE TO PULL THE TRIGGER AFTER SAFETY LOCK, BUT THE HAMMER DOES NOT WORK •



SAFETY OFF :

SWITCH THE SAFETY LEVER BACK TO THE HORIZONTAL PLACE, THEN THE SAFETY IS RELEASE •  
\* SAFETY OPERATION IS STILL EFFECTIVE WHEN THE HAMMER IN WAITING SHOOT STATUS •





## 6 SEND BULLET TO THE CHAMBER

THE CHAMBER IS EMPTY WHEN THE MAGAZINE IS PUT BACK TO THE GUN. PULL THE SLIDE BACK AND RELEASE THEN 1ST BB BULLET WILL BE SENT TO THE CHAMBER, AND HAMMER WILL COCK UP IN WAITING SHOOT STATUS.

[NOTE]

DO NOT PULL THE TRIGGER, EXCEPT SHOOTING.

## 7 SHOOTING · BLOW-BACK



PULL THE TRIGGER IN WAITING SHOOT STATUS, THE BULLET WILL BE SHOT, AFTER THAT THE SLIDE WILL MOVE BACKWARD TO THE BOTTOM AND MOVE FORWARD TO THE ORIGINAL PLACE, THEN THE NEXT BULLET WILL BE SENT TO THE CHAMBER, AND THE HAMMER WILL COCK-UP IN THE SAME TIME. KEEP ON PULLING THE TRIGGER TILL THE BULLET ALL SHOOT OUT, THEN SLIDE WILL STOP AT THE BACK.

\* WHEN SHOOTING, THE SLIDE WILL MOVE BACK TO THE BOTTOM, PLEASE DO NOT PUT THE GUN CLOSE TO THE EYE FOR AIMING.



## 8 RELEASE HAMMER

THE HAMMER IS COCK UP IN WAITING SHOOT STATUS, PULL THE HAMMER BACK AND PULL THE TRIGGER IN THE SAME TIME, THEN RELEASE THE HAMMER BACK TO THE ORIGINAL PLACE SLOWLY.



## 9 BARREL SAFETY

IT IS POSSIBLE TO PRESS THE BARREL BACKWARD A SHORT DISTANCE AND RELEASE IT WHEN IN WAITING SHOOT STATUS. THIS IS BARREL SAFETY. IT IS POSSIBLE TO PULL TRIGGER AND RELEASE COCKED UP HAMMER WITHOUT SHOOT BULLET WHEN THE BARREL IS PRESSED BACKWARD.



## 10 DOUBLE ACTION SHOOTING

AFTER RELEASE COCKED UP HAMMER (THE BULLET HAS BEEN SENT TO THE CHAMBER), PULL THE TRIGGER, THEN THE HAMMER WILL COCK UP AGAIN AND DOUBLE ACTION SHOOTING WILL OCCUR.

[NOTE]

BE SURE THERE IS NOT BULLET IN THE CHAMBER, BEFORE PULL THE TRIGGER.



# ASSEMBLY · DIS-ASSEMBLY



## 11 HOLD OPEN

WHEN THE BULLETS IN THE MAGAZINE ARE ALL SHOT OUT, THE SLIDE WILL BE OPEN STOPPED AT THE BACK BY STOPPER, THE CHAMBER. PRESS THE STOPPER THEN SLIDE WILL MOVE FORWARD TO THE ORIGINAL POSITION. THE CHAMBER CLOSE. BE CAREFUL! TOO MANY TIMES' BLANK SHOOT WILL HURT SLIDE, PLEASE DO NOT DO BLANK SHOOT EXCEPT NECESSARY.



WHEN THE CHAMBER OPEN, PLEASE PULL OUT THE MAGAZINE, LOAD BULLETS, AND PUT IT BACK TO THE GUN, AFTER THAT PULL THE SLIDE BACK TO THE BOTTOM AND RELEASE IT THEN IT IS POSSIBLE TO KEEP ON SHOOTING.



PULL OUT THE MAGAZINE

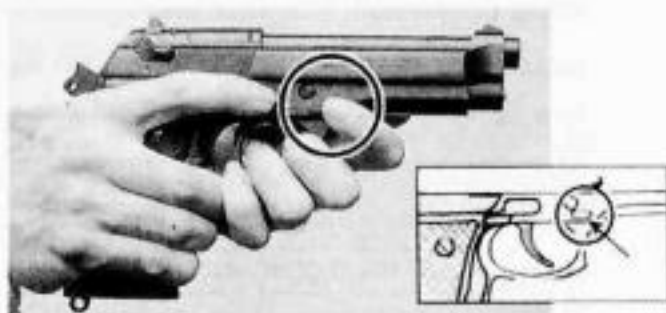

- PRESS THE DIS-ASSEMBLE BUTTON DOWN ON RIGHT-HAND SIDE OF BODY, THEN SWITCH DIS-ASSEMBLE LEVER 90° DOWN IN THE SAME



- PULL THE SLIDE FORWARD.

## [WARNING FOR GAS BOMBE]

- THE GAS OF "KWC" IS HFC134a, IT IS NO PROBLEM FOR OZONE.
- PLEASE DO NOT USE OTHER GAS THAN PECULIAR ONE.
- IF THE NOZZLE OF GAS BOMBE CAN NOT MATCH THE VALVE OF MAGAZINE, THE GAS WILL LEAK OUT WHEN CHARGING IT.

## [WARNING FOR BB BULLET]

- THE HITTING RATE IS BAD, WHEN USE OTHER BAD QUALITY BULLET.
- WHEN THE BULLET STOP IN THE BARREL, PLEASE USE COTTON ROD TO PUSH BULLET OUT.
- IF THE BULLET'S DIAMETER IS TOO SMALL, THE BULLET WILL STOP IN THE MAGAZINE

THE DIS-ASSEMBLY OF KWC/M92FS IS THE SAME AS REAL BERETTA M92FS, JUST PRESS THE DIS-ASSEMBLE BUTTON DOWN AND SWITCH DIS-ASSEMBLE LEVER THEN THE SLIDE AND BODY WILL SEPERATE

## DIS-ASSEMBLY OF SLIDE



PUSH THE RE-COIL SPRING GUIDER FORWARD AND KEEP IT BY HAND •



PULL OUT THE BARREL UNIT FROM SLIDE, THEN PULL OUT THE GUIDER AND SPRING •



## ROUGH DIS-ASSEMBLY

USUALLY, PLEASE, JUST DIS-ASSEMBLE THE GUN INTO 5 PARTS AS ABOVE FOR MAINTENANCE • WHEN TROUBLE OCCURRED, PLEASE DISCUSS WITH FACTORY OR SHOP FOR DETAIL DIS-ASSEMBLY •

## MAINTENANCE GUIDE

- \* MAINTENANCE FOR AFTER USE :  
THE PARTS ON REAR SIGHT AND SAFETY LEVER ARE COMING LOOSE AFTER SHOOTING • PLEASE USE HEXAGON WRENCH TO SCREW THEM TIGHTLY •
- \* HOW TO SPRAY KWC'S LUBE OIL  
KWC'S LUBE OIL IS A VERY GOOD PROTECTIVE OIL • ESPECIALLY FOR RUBBER PACKING, O RING, AND SO ON • IT IS A VERY GOOD LUBRICANT FOR MOVABLE PARTS •
- \* SPRAY POSITION OF LUBE OIL
  - ① VALVE AND PACKING OF MAGAZINE
  - ② MOVABLE PART BETWEEN SLIDE AND BODY
  - ③ THE AXLE OF TRIGGER AND HAMMER

## ASSEMBLY

ASSEMBLY STEPS AND DIS-ASSEMBLY STEPS ARE OPPOSITE AS BELOW :



- ① PUT THE RECOIL SPRING AND GUIDER INTO THE SLIDE
- ② PUT THE BARREL TO THE FIX POSITION
- ③ THE BOTTOM OF BARREL HAS TO MATCH WITH THE REAR TERMINAL OF GUIDER
- ④ THE DITCH OF SLIDE HAS TO MATCH WITH THE TRACK OF BODY, THEN INSERT THE SLIDE FROM FRONT SIDE •
- ⑤ PULL THE SLIDE BACKWARD TO THE HOLD OPEN POSITION, FIX THE SLIDE • (BE SURE, THE DIS-ASSEMBLE LEVER AT 90° POSITION)
- ⑥ SWITCH THE DIS-ASSEMBLE LEVER BACK TO HORIZONTAL POSITION
- ⑦ RELEASE THE SLIDE FORWARD TO ORIGINAL POSITION



# KWC/M92FS PARTS LIST

No.	PARTS NAME	PRICE	No.	PARTS NAME	PRICE	No.	PARTS NAME	PRICE
P01	BODY		F01	RECOIL SPRING GUIDE		S01	RECOIL SPRING	
P02	GRIP(LEFT)		F02	VALVE ROD		S02	TRIGGER SPRING	
P03	GRIP(RIGHT)		F04	HAMMER GUIDE		S03	FIRING PIN SPRING	
P04	LOADER		F05	TRIGGER PIN		S04	DIS-ASSEMBLY BUTTON SPRING	
P05	BARREL LOCK		F07	HAMMER BLOCK		S05	SLIDE STOPPER SPRING	
P06	OUTER BARREL		F08	SAFETY GUIDE		S06	TRIGGER BAR SPRING	
P07	LOADING NOZZLE		F09	SAFETY PLUNGER		S07	MAGAZINE CATCH SPRING	
P09	SLIDE		F10	MAIN SPRING HOUSING PIN		S08	SAFETY PLUNGER SPRING	
P10	LOADER ROD		F11	HAMMER PIN		S09	LOADING NOZZLE SPRING	
P26	FLOATING VALVE CATCH		F12	FIRING PIN CATCH PIN		S11	VALVE ROD SPRING	
			F13	FIRING PIN AXLE		S12	MAGAZINE SPRING	
Z01	MAGAZINE CATCH					S13	MAIN SPRING	
Z02	DIS-ASSEMBLY BUTTON		B01	INNER BARREL		S14	FIRING PIN CATCH SPRING	
Z03	DIS-ASSEMBLY LEVER		B02	MAGAZINE BASE PIPE		S15	HAMMER RELEASE LEVER SPRING	
Z04	MAIN SPRING HOUSING		B03	CHARGE VALVE		S16	GAS CONTROL SPRING	
Z05	GRIP LOOP		B04	VALVE SLIP				
Z06	MAGAZINE CASE		B05	TRIGGER SLIP		E01	VALVE	
Z07	MAGAZINE FOLLOWER		B06	CAP		E04	SAFETY LEVER LOCK SCREW	
Z08	MAGAZINE BASE		B07	HAMMER SLIP		E05	REAR SIGHT SCREW	
Z11	LOCKING BLOCK		B08	GRIP SCREW NUT		E06	MAGAZINE BASE PIN	
Z12	BARREL GUIDE		B09	LOADER PIPE		E07	SCREW	
Z13	VALVE GUIDE		B10	FIRING PIN SLIP		E08	LOCKING BLOCK PIN	
Z14	SLIDE STOPPER		B12	HAMMER ROLLER		E09	BARREL_LOCK PIN	
Z15	PISTON BASE		B13	GRIP SCREW		E10	SPRING PIN	
Z16	LOADING NOZZLE GUIDE		B14	HOP-UP RING		E11	LOADING NOZZLE PIN	
Z17	TRIGGER		B16	GAS CONTROL VALVE		E12	FLOATING VALVE GUIDE PIN	
Z18	SLIDE WEIGHT		B17	FLOATING VALVE GUIDE		E13	VALVE GUIDE SCREW	
Z19	SAFETY LEVER(LEFT)					E14	VALVE LOCK E RING	
Z20	SAFETY LEVER(RIGHT)		1R01	RUBBER CHAMBER				
Z21	REAR SIGHT		R02	GAS ROUTE PACKING		U1	JOINER	
Z22	HAMMER		R04	VALVE GUIDE PACKING		U2	HEXAGONAL WRENCH	
Z23	CHASSIS(LEFT)		R05	MAGAZINE PACKING		U3	MAGAZINE UNIT	
Z24	CHASSIS(RIGHT)		R06	LOADING NOZZLE PACKING		U4	LOADER UNIT	
Z25	FIRING PIN		R07	O RING		U5	LOADING NOZZLE UNIT	
Z27	TRIGGER BAR		R08	O RING		U6	VALVE GUIDE UNIT	
Z28	SAFETY RELEASE LEVER		R09	O RING				
Z29	HAMMER RELEASE LEVER		R10	O RING				
			R11	O RING				
			4R01	HOP-UP RUBBER CHAMBER				

# INSTRUCTION MANUAL

## KWC/M92FS BLOW-BACK MODEL WARNING

This product is specially developed for the users more than 14 years old. Please pay extra attention to the environment surrounds the playing field. We will not hold any responsibility for any accident or malfunction caused by the improper handling, illegal conversion, alteration and disassembling of the air soft gun. Please read through this operation manual carefully before using.

- (1) Do not point the gun point at any person, even though there is not pellet in the gun.
- (2) Do not pull the trigger, except shooting.
- (3) Do not load pellet, except shooting.
- (4) Be sure that there is not any human or animal in your shooting direction.
- (5) The gun should be placed at a higher place and keep it from the reach of children.
- (6) Do not aim at a object easy broken or place it behind the target.
- (7) Do not use other pellets than the peculiar ones.
- (8) Do not try to dis-assemble, interchange or modification of any parts of the gun.
- (9) Do not peep the muzzle at any time.
- (10) Must wear a safety goggles to protect eyes during a shooting.



INS. MANU



MODIFICATION



UNIVERSO SNIPER  
AIRSOFT

