



CHALLENGER

SUREFIRE
AM362

AVOID DIRECT EYE
EXPOSURE TO BEAM



IKS2021
PWAEX20 21W5EX



BE A GAME CHANGER

ICS AIRSOFT

2022
CATALOGUE

**BE A GAME
CHANGER**





ICS obtains ISO 9001
Quality Management System
Certification



CONTENTS

- 03 NEW ICS PRODUCTS
- 05 ABOUT ICS
- 09 ICS TECHNOLOGY
- 13 MASTER MODS
- 15 PISTOL

- 15_HI-CAPA
- 19_SAR9.II
- 23_BLE SERIES
 - VULTURE
 - XMK
 - BM9
 - PM2
 - XFG
 - XAE

49 GUN

- 49_HERA ARMS CQR
- 53_LIGHTWAY SERIES
 - PELEADOR.III
 - DAGGER
 - PELEADOR
- 67_CXP SERIES
 - MARS.II
 - ARK
 - MARS PDW9
 - MMR
 - YAK
 - UK1
 - HOG
 - 08/16
 - 15
- 95_CES-P
- 99_CES SERIES
- 101_CS4 SERIES
- 103_AAR SERIES
- 105_MAR SERIES
- 107_TOD SERIES
- 109_WORLD WAR II
- 113_L85 L86 SERIES
- 115_MGL SERIES

- 117 SPECIFICATIONS
- 121 ICON GUIDE

NEW
ICS
PRODUCT
PREVIEW



P59



P25



P69



P19



P15

WHAT'S NEXT?



BLE-ICP



CXP-TOMAHAWK



一芝軒

ICS
The Best Thing We Create
精益求精 永無止境



ABOUT ICS

The First AEG Manufacturer in Taiwan

None of us is not born to fight and eager to be the winner on battlefield wherever in real life or any game participated. To a warrior, a fine weapon is the key factor to earn the throne. However, to a great warrior, he who requires not just a delicate outline design matching his will but also well-built internal parts to enhance his power. ICS believes, and thus the true weapon is born.

The founder of ICS, Mr. Chu, with his enthusiasm, entered the realm of Airsoft in 1995 and became the first AEG manufacturer in Taiwan, 3rd large AEG company in the world which was specialized in designing and manufacturing airsoft replicas.

As a professional manufacturer in the market, "Innovation, Efficiency, and High Quality" is the core value of ICS. "Accept no, produce no, and sell no defective product." is the principle we insist since the start. By persistence of all full-hearted staffs and Airsofters, from running a small portion of the market, ICS now stands on a role of leading other airsoft companies in Taiwan to enter the global market. These are not just words, we practice our faith in all advanced-manufacturing process such as die-casting, plastic injection, steel stamping, and CNC milling... etc. which allows us be qualified with several international standards such as ISO 9001 Quality management system.

Aim to be, and keep to be a leader in the field of Airsoft, the key makes ICS standing firmly is having a mighty R&D team that comprised experts from different industries that drive innovation. With a clear direction of Integrating new technologies and Airsofters' experience, our design and product are able to hold huge difference than others. In the future, devote ourselves to develop new techs and acquire more patent or certification we will constantly in purpose to offer more modern and satisfying products to Airsofters.

As always, Innovation, Competition, and Satisfaction.

ICS, The Best Thing We Create. 



HIGH PRECISION CNC MACHINES



ICS PRECISION OEM / ODM SERVICE

To produce high-quality metal components and run detailed prototype tests such as receiver, handguard, fire-control mechanism, and gearbox, ICS has invested plenty in such as high precision CNC and Advanced 3D print machines. All the components are precisely crafted which are able to meet the high-quality standard even of military standard 7075 aluminium. This allows us to be capable of providing high-end OEM / OEM service.



SSS.III

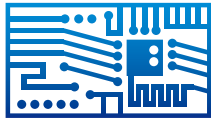

Self-diagnostic Shooting System



SMART TRIGGER

ICS does make trigger incredibly competent and smart. The smart-sensing unit is capable of distinguishing whether it is time for a short burst (3-round mode) or full throttle (full-auto mode) by your strength on trigger. More than that, with "Pre-cocking Mechanism" and "Short-stroked Trigger" are also equipped with the unit, ICS SSS.III Unit can work much faster than any other AEG trigger system which brings Airsofters a more instinct and rapid playing experience. As the new generation of the system has arrived, be ready to be the lightning on the field.



UNIQUE SPLIT GEARBOX DESIGN

The ICS uniquely-designed "Split Gearbox" benefits player by its separated structure of receiver part and gear part, which offers the capability of easy maintenance and upgrading plus the realistic experience on disassembling and reassembling.

BENEFITS COME ALONG WITH THE NEW ICS SSS E-TRIGGER



Pre-cocking Function

With the new "pre-cocking function", the firing speed and the precision of gear working hence increased.



Active E-Brake

It is featured with self-learning function by adjusting its power automatically to precisely position gears while operating.

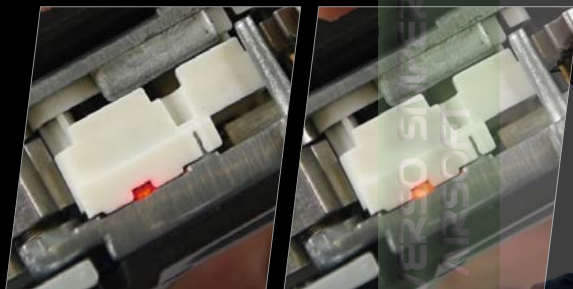

"First in Airsoft World!" Self-Diagnostic Shooting System

Troubleshooting is no longer troublesome. With ICS SSS.III unit, all the problem will be told by the colour of a small LED. Well, green means all green, definitely.

Red LED blinking:
Gears, motor related abnormality.

Orange LED blinking:
Trigger switch abnormality.
Orange LED glowing:
Fire selector assembly abnormality.



High Torque motor

With quality, made in Taiwan, EVO motor is equipped with a design to reduce heat accumulation and improve endurance by using high heat resistance magnet.



Low Voltage Detection & Self-Protection

When the battery is running low, the motor will vibrate itself 3 times to remind the player that power will soon be depleted.

After the last drip of the battery is ran out, the motor will vibrate once and stop working. Perfect moment to replace your battery with a fully-charged one.



Integrated Burst Mode (SSS.II)

This is it. Firing mode can be switched without pulling off your finger from the trigger. Pull, and hold, the trigger for 5 seconds then the 3-round burst mode is activated. And it is simple to reset to default, just by repeating the move above.

ICS EXCLUSIVE REALISTIC DESIGN



Flexibility - Split Gearbox & QD Spring & Spring Release

Simulating action like disassembly of real firearms is crucial part of realism. Without sacrificing any function, ICS designs "QD receivers", "split gearbox" with "QD spring guide" which allows maintenance, upgrading, and troubleshooting much more easily to achieve. In addition, the "spring-relaxing mechanism" can also be installed to avoid elasticity fatigue and velocity decrease simultaneously for the purpose of lengthening the lifetime of spring.



Integrity - EBB System, Battery Stock Tube & Floating H-UP

To get rid of many cons of traditional design, overturning the legacy by breaking the old frame, ICS have committed numerous improvements on the EBB system by analysing and reflecting the issues on the traditional one. After couple of years of continuing research, experiment, and hundred thousands more tests, we manage to create structure which disperse impact harmlessly when shooting by using the simplest design while preserving realistic feedback and being practical.

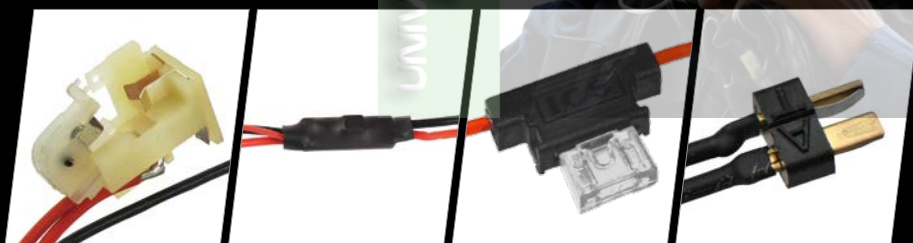

Capability - Low Resistances Switch Assembly & Mini Fuse & MOSFET

Electricity is just like blood to human, essential and vital. Keeping a powerful and steady output of current is a critical issue for a game-winning weapon. ICS has been focusing on this matter and constantly making improvements. Such as applying new conductive material, using new type of E-brake and T-din plug, replacing fuse box with the micro type, and installing a MOSFET. All these efforts create a low impedance working environment which occurs less heat and less loss on energy to achieve what we aim for.



Durability - Refined and Advanced Parts

Components like gears, piston, and all others that were built to move are doomed to break by time. Fear not, ICS has kept upgrading these parts by introducing new MIM process, practicing new design, and applying different material. As the life of parts prolonged, the performance of gears improved, these have become the last a player should worry about.

MASTER MODS

PERFECTING THE PERFECTED



MX-010

Master R-Hop Chamber Rubber
(FOR AEG)



MX-011

Master R-Hop Chamber Rubber
(FOR GBB)

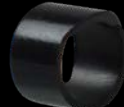

MX-012

Master R-Hop Contact Rubber



MX-013 (84mm) / 014 (97mm) / 015 (113mm) / 016 (229mm) /

017 (300mm) / 018 (370mm) / 019 (430mm) / 020 (510mm)

Master Inner Barrel FOR AEG/GBB



MX-006

Full Steel Teeth Reinforced
Upgrade Piston Parts FOR ICS EBB



MX-008

Full Steel Teeth Reinforced
Upgrade Piston Parts



MX-023

Master Hi-Capa TDC Hop
Chamber for TM Spec



MX-001

6061 Aluminum Reinforced
Upgrade Cylinder Head



MX-002

6061 Aluminum Reinforced
Upgrade Piston Head



MX-004A

M4 Metal Cross Air Nozzle



MX-005

Master Hop Tensioner Nub

MASTER HI-CAPA TDC HOP CHAMBER FOR TM SPEC



"TDC", "top-dead-center" is designed for spreading vertical bucking pressure evenly hence stabilises the trajectory and reduce uncertainty on your action. The key part to the purpose is a pressure ring. It is formed with powder steel which is able to form more precisely and provide much better stability.

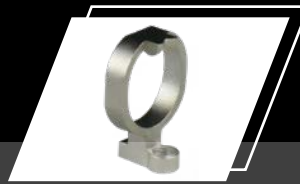

1.5mm hexagon wrench for Fine Tuning H-UP screw.

Mid frame stabilizing bump

MASTER MODS R-Hop System



TDC HOP UNIT TM COMPATIBLE



- Perfect TDC Top-Dead-Center force hop pressure.
- Compatible with Tokyo Marui spec Hi-Capa.
- R-HOP system and Electroless nickel-coated 6.04mm inner barrel increase your shooting accuracy and consistency with high durability and reliability.
- Redesigned structure to provide extra support to lower part of chamber.



ABOUT MASTER MODS

MASTER MODS was initiated by some professional designers and players from various sorts of industries with enthusiasm in Airsoft. They are here for only one vision and one purpose: "To build the perfect-upgrading parts for all of the airsoft players and gears in the world." With years of gaming experiences and unlimited creativity, the masters thus create the best parts. MASTER MODS and ICS have been collaborated for years to bring more surprising innovation and raise the standard of shooting to another level.

HI-CAPA CHALLENGER

CHALLENGE MORE

CHALLENGER

Hi-Capa CHALLENGER is a beast born to challenge. The fierce nature within is bred by top-tier crafting parts and experience-adopting design. While reflecting all the minor imperfections in many frontiers, the beast also learns from the great in present days. Once being unleashed, it will no doubt be the King in the field. We innovate, challenge, and surmount. (Compatible with Tokyo Marui's)

HI-CAPA CHALLENGER



**EFFICIENT
GAS
RELEASE**



**QUANTITATIVE
GAS INJECTION
VALVE**



**NEW
PRODUCT**

Specification

MODEL	
BLE-007-SB (Metal Slide)	
Length	220 mm
Inner Barrel	113 mm
Capacity	30 Rds
Weight	962 g
Caliber	6 mm



**NEW
PRODUCT**

Specification

MODEL	
BLE-007-PB (Plastic Slide)	
Length	220 mm
Inner Barrel	113 mm
Capacity	30 Rds
Weight	910 g
Caliber	6 mm

FEATURES

Metal Slide & Sport-style Slide

- The Metal Slide (SB) is made by aluminium alloy offers a solid and powerful recoil while shooting.
- The Sport-style Slide (PB) is formed with reinforced plastic which provides a agile and punctual blow-back cycling while reducing the weight at the same time.

RMR & DOC Sight Mount

Access to all sorts of combination is the pleasure we all desire. But just an addition is not enough, we integrate.

The Challenger-tailed sight mount is not only a platform above, but also a shape-integrated structure with the sling and hammer around.

No need for a exaggerated outer frame, with a simple, humble but solid plate, you can install your sight and have less impact from hammer.

3-Dot Luminous Sights

Aim-assisting dots are evolved by using Luminous paint.

While entering from a brighter place into a darker one with the glow, player will still be able to aim clearly.

14mm CCW Steel Adapter

Capable of accepting most of suppressors and extension tubes of the day.

Adjustable Trigger Stroke Mechanism

Able to adjust the length of trigger stroke according to player's need with a single allen key.

Magazine Well

Every second counts in a rapid competition. Winner is always the one who shoots first.

The design of the well assists player to align and load the mag under his instinct move.

Reinforced Magazine Base Plate

The magazine base plate is thickened to provide protection from any impact.

By using nylon fiber, it offers enlarged holding place without gaining too much weight.

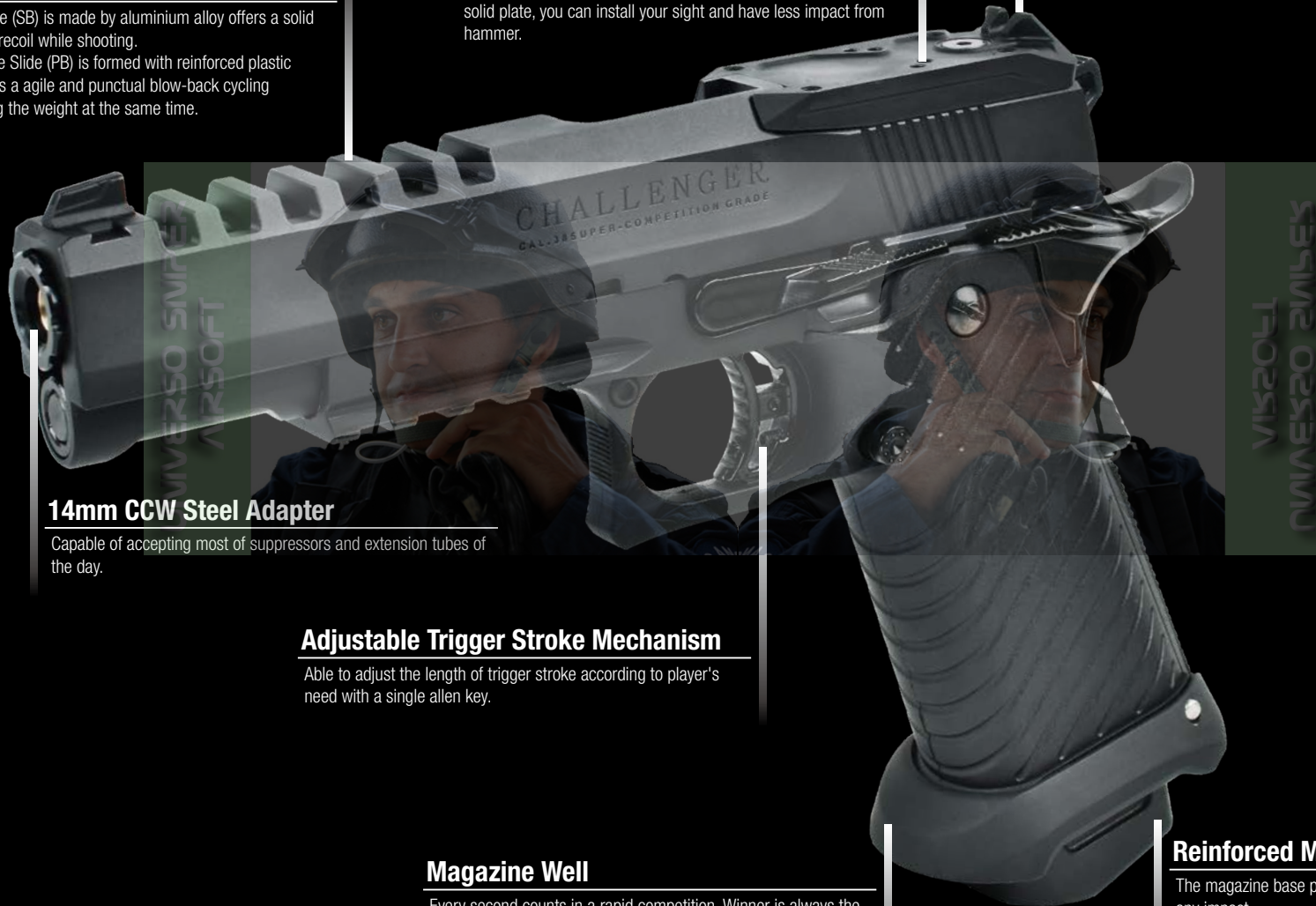

MASTER MODS R-Hop System

R-HOP system and Electroless nickel-coated 6.04mm inner barrel increase your shooting accuracy and consistency with high durability and reliability.



TDC Hop-Up Chamber

"TDC", "top-dead-center" is designed for spreading vertical bucking pressure evenly hence stabilises the trajectory and reduce uncertainty on your action.

The key part to the purpose is a pressure ring. It is formed with powder steel which is able to form more precisely and provide much better stability.



REVO.II Gas Management System

The brand new REVO.II system is designed with two major mechanisms:

one provides sufficient gas output from the magazine and the other offers effective gas injection hence increased capacity when charging.



Upgraded-Connecting Structure

Not like most of design in this part is just a plastic hole for screw, we fortify with a metal bushing creates a firmer and steadier connection which reduces vibration between frames.



Quick-Disassembling Clip

Recoil spring guide rod with reverse plug retention clip is equipped within allows player can dismantle more easily.



Pre-Upgraded Steel Parts

As we have pre-upgraded all the moving metal parts, part like fire control unit is now able to provide better-shooting experience and endure longer working time. The other like sear spring now contains more flexibility with more room for adjusting the touch of the trigger by using Japan SUS301 stainless steel.



H-UP set with Barrel Fixing

The H-UP set is added with a screw that fix the position of barrel provides a necessary stability when recoiling occurred.



Lightweight Aluminium Alloy Mid-Frame

With more-precision CNC machining, ICS was managed to build this One-Piece Rail mid-Frame which brings a great smoothness and let slide travels like no resistance.





SAR 9.11

SMART TACTICAL



SARSILMAZ®

The logo of SARSILMAZ® is registered trademarks of Sarsilmaz Silah San. A.Ş., Turkey - www.sarsilmaz.com - and is used for airsoft replicas under worldwide exclusive license.

SAR 9.11 is born to be a major force compare to its counterpart in real-firearms world. By fully-licensed by Sarsilmaz Firearm Corp., ICS was able to build SAR 9 based on its ergonomic design since few years ago. Now, after several times of learning, improving, and all the help from experienced users, SAR 9.11, now steps on the stage. With refreshed Gas-Blow-Back Mechanism, new REVO.11 valve on mag, and no need to say, better-skilled crafting process, just hold it firmly and running into the battlefield, it will lead you to victory.

SAR 9.11



**EFFICIENT
GAS
RELEASE**



**QUANTITATIVE
GAS INJECTION
VALVE**



**NEW
PRODUCT**

Specification

MODEL	
BLE-009-SB-2	
Length	195 mm
Inner Barrel	97 mm
Capacity	22 Rds
Weight	750 g
Caliber	6 mm

FEATURES

Weight-Reduced Slide

Even built of metal in order to assure the realistic experience, by using Aluminium Alloy as material, we achieved light weight on this part either.

And with 1:1 Scale Licenced Mark on the side, SAR 9.II is almost a duplicate from the real one.

3-Dot Luminous Sights

Aim-assisting dots are evolved by using Luminous paint.

While entering from a brighter place into a darker one with the glow, player will still be able to aim clearly.

M1913-Compatible Tactical Rail

Capable of installing all M1913 under-barrel accessories.

Customisable Grip

Holding it tight? Or being easy with your hand?

The grip of SAR 9.II offers you a flexibility of changing the pad which faces your palm.

14mm CCW Steel Adapter

Capable of accepting most of suppressors and extension tubes of the day.

Load-Status Indicator

It must be a rapid-changing moment when you hold a SAR 9.II.

Luckily, spare just no more than one second on your trigger: "See red, loaded. No red, empty."

You will be able to check and know the current status of your pistol.

Reversible Magazine Catch

The magazine release button can be rearranged to another side than default according to the shooter's preference.

Ø6.03 Inner Barrel

A universal spec 6.03mm precision barrel is easier for upgrading and maintenance.



Fixed Inner Barrel

The fixed structure locked the position of barrel provides a necessary stability when recoiling occurred.



Compatible Holster

Like the real one does, SAR 9.II is also fitted in 579 holster.



Low Resistance Design

The Brand new low resistance slide design integrates spring-powered hammer contact. Made less waste and smoother move on any action of the slide.



MHS (Modular Handgun System) Design Fire Control Unit

The one-piece unit brings not only a more stable and precise working structure for the pistol, but also allow itself simpler for maintenance.



REVO.II Gas Management System

The brand new REVO.II system is designed with two major mechanisms: one provides sufficient gas output from the magazine and the other offers effective gas injection hence increased capacity when charging.







Black Leopard Eye

ABOUT BLE

Pistol is a "must have" in all milsims or skirmishes, and you want to react like a leopard during the game. You do not only acquire sturdy figure, high mobility, and intelligence, but also maintain extremely high speed while running. Thus, ICS choose the icon of the leopard to represent the capability of the ICS pistols, and symbolize ICS ability to maintain leopard-like vitality, viability and competitiveness on those brutal battlefields and the fast-changing airsoft market.

BLE-VULTURE



What if I told you that the classic 1911 can evolve into a modernised shape without losing its retro style? BLE-VULTURE, a gentle look like always in men's memory and a touch of Matte Black Finish on surface, serves the idea well. Fear not, its heart was not stranded in the history but has come to our time. With advanced designs such as "fixed barrel", "adjustable short stroke trigger", "short-traveling slide stopper", and plus hardening all-steel fire control module using Japanese-made SUS stainless steel sear spring, all these refresh the legend one change from the old to the gold and offer player a unprecedented fast-shooting experience. (Compatible with Tokyo Marui's)

BLE-VULTURE



**EFFICIENT
GAS
RELEASE**



**QUANTITATIVE
GAS INJECTION
VALVE**



AK-71

Optional: Real Wooden Grip Plates

AV-09

Vulture Slide Stop Screw



**NEW
PRODUCT**

Specification

MODEL	
BLE-011-SB	
Length	195 mm
Inner Barrel	85 mm
Capacity	15 Rds
Weight	537 g
Caliber	6 mm



**NEW
PRODUCT**

Specification

MODEL	
BLE-011-TB	
Length	240 mm
Inner Barrel	115 mm
Capacity	15 Rds
Weight	558 g
Caliber	6 mm

FEATURES



M1913-Compatible Tactical Rail

Capable of installing all M1913 under-barrel accessories.

14mm CCW Steel Adapter

Capable of accepting most of suppressors and extension tubes of the day.

Ambidextrous Slide with Quick-Pulling Bump

This small addition of quick pull bumps (on both side) will increase contacting surface to your hand and provide user a solid pulling on slide.

Optic Sight

Made with Steel Fiber, integrated with optic two bars, the sight provides basic but clear aiming assistance in the dark time.

Slide-Traveling Limit Screw (Optional)

After installing the screw, the slide will travel less distance of 30% thus increase the shooting cycle and enhance trigger response.



Integrated Compensator

VULTURE (tactical ver.) comes with a tailored compensator. Not only the longer frame, it also has a longer inner barrel which increases the muzzle velocity and shooting accuracy.

Reversible Magazine Catch

The release button can be rearranged to another side than default according to the shooter's preference.

Ø6.03 Inner Barrel

A universal spec 6.03mm precision barrel is easier for upgrading and maintenance.



Fixed Inner Barrel

The fixed structure locked the position of barrel provides a necessary stability when recoiling occurred.



Pre-Upgraded Steel Parts

As we have pre-upgraded all the moving metal parts, part like fire control unit is now able to provide better-shooting experience and endure longer working time. The other like sear spring now contains more flexibility with more room for adjusting the touch of the trigger by using Japan SUS301 stainless steel.



REVO.II Gas Management System

The brand new REVO.II system is designed with two major mechanisms: one provides sufficient gas output from the magazine and the other offers effective gas injection hence increased capacity when charging.





BLE-XMK

MARK X

BLE-XMK, a.k.a. "MARK X", is the product of time and effort, is the combination of every innovative designs and advanced technologies to date. It might not bear the spotlight of those who has a classic face. But beneath its fair-looking surface, the great force exists.

BLE-XMK



**EFFICIENT
GAS
RELEASE**



**QUANTITATIVE
GAS INJECTION
VALVE**



Specification

MODEL	
BLE-010-CB	
Length	211 mm
Inner Barrel	115 mm
Capacity	17 Rds
Weight	720 g
Caliber	6 mm



Specification

MODEL	
BLE-010-SB	
Length	211 mm
Inner Barrel	115 mm
Capacity	23 Rds
Weight	778 g
Caliber	6 mm

FEATURES

14mm CCW Steel Adapter

Capable of accepting most of suppressors and extension tubes of the day.

Easy-Gripping Bumps

This small addition of bumps (on both side) will increase contacting surface to your hand and provide the users a solid pulling on slide.

3-Dot Luminous Sights

Aim-assisting dots are evolved by using Luminous paint. While entering from a brighter place into a darker one with the glow, player will still be able to aim clearly.

Fraction-Patterned Grip

The diamond-shape surface design increases the friction while holding.

Integrated Compensator

The XMK-specialised compensator reduces the wobbling of the inner barrel.



Ø6.03 Inner Barrel

A universal spec 6.03mm precision barrel is easier for upgrading and maintenance.



Compatible Holster

BLE-XMK fits with the Holster from Swiss Arms even with the compensator on it.



Additional Safety

The safety button lies beneath the rail which can ensure no accident happened during the non-gaming session.



REVO.II Gas Management System

The brand new REVO.II system is designed with two major mechanisms: one provides sufficient gas output from the magazine and the other offers effective gas injection hence increased capacity when charging.



BLE-BM9

MONSTERLIKE
DURABILITY
RELIABILITY



All those have gone with the time, only the classic remains. "M9", has been the standard small firearm in armies of several countries. BLM-BM9 is like a mirror image of it. Inherited not just its classical appearance, but also the performance and reliability.

BLE-BM9



**EFFICIENT
GAS
RELEASE**



**QUANTITATIVE
GAS INJECTION
VALVE**



Specification

Length	216 mm
Inner Barrel	115 mm
Capacity	20 Rds
Weight	1000 g
Caliber	6 mm

BLE-050-SB

FEATURES

High Quality Crafting

Metal parts, especially the major ones such as slide and frame, are all processed with precision, which perform a smooth and punctual operation.

3-Dot Luminous Sights

Aim-assisting dots are evolved by using Luminous paint. While entering from a brighter place into a darker one with the glow, player will still be able to aim clearly.

14mm CCW Steel Adapter

Capable of accepting most of suppressors and extension tubes of the day.

Customisable Grip Plate

The grip plate is detachable for player to decor the BM9 in their own favour.



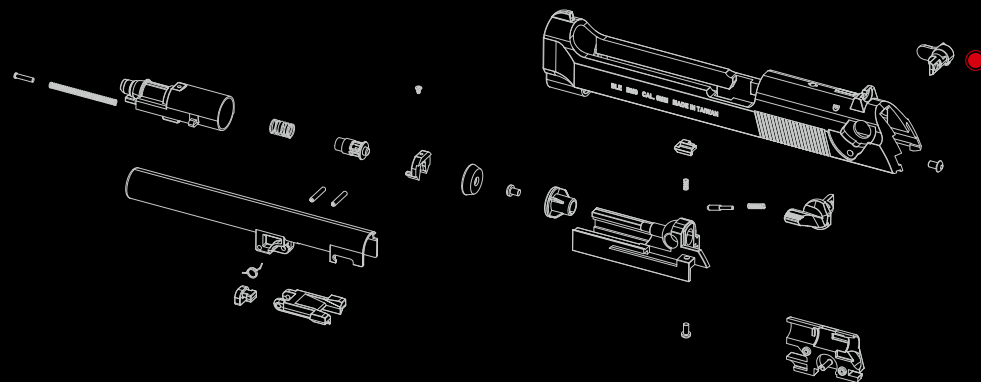

Two-Sided Safety Switch

Ambidextrous safety design allows player performs a quick switch either left-handed or right-handed.



Ø6.03 Inner Barrel

A universal spec 6.03mm precision barrel is easier for upgrading and maintenance.

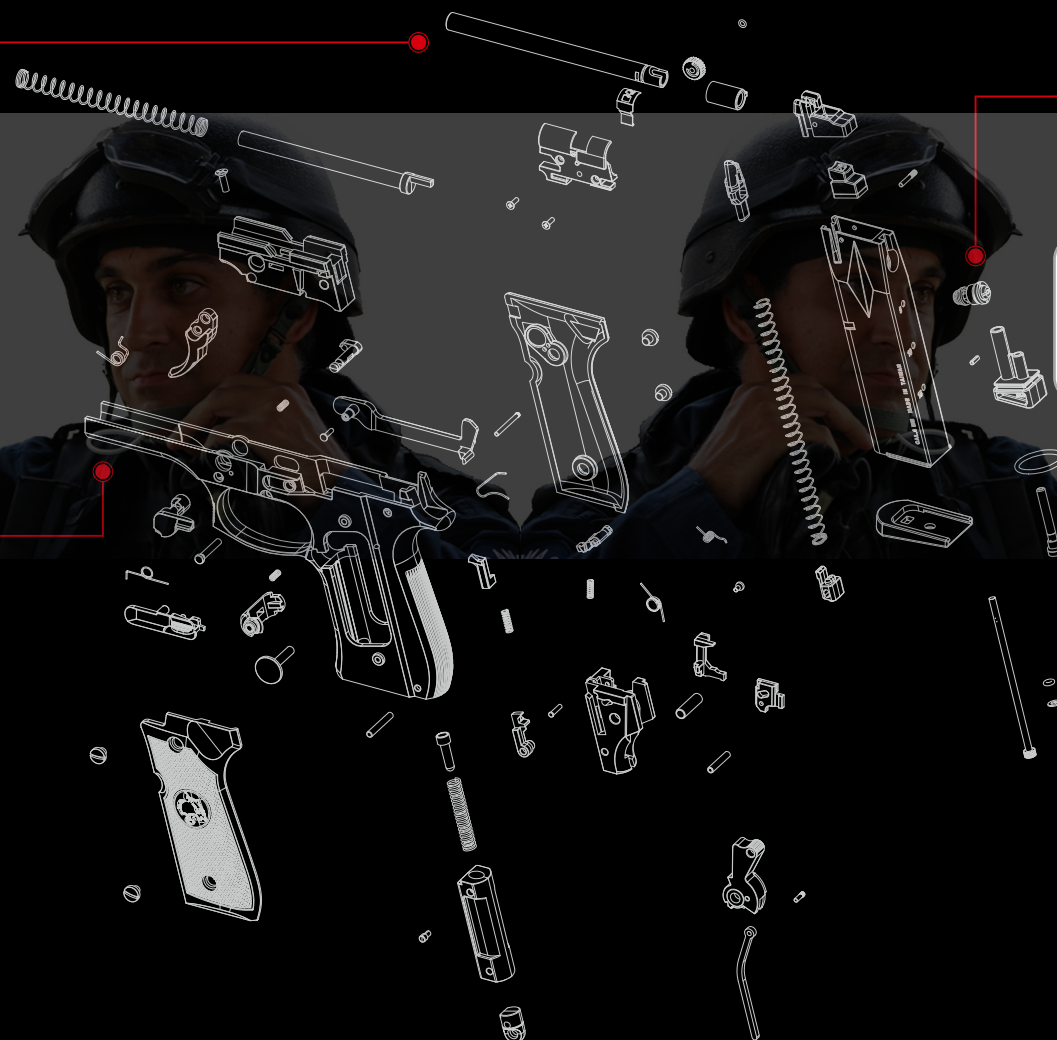

REVO.II Gas Management System

The brand new REVO.II system is designed with two major mechanisms: one provides sufficient gas output from the magazine and the other offers effective gas injection hence increased capacity when charging.



Compatible Holster

BLE-BM9 fits with all the M9 Holster of the day.



BLE-PM2

THE MUFFLED ONE



The shadow of the cold war, the deadly silence of the past. BLE-PM2 perfectly mirrors the simplicity design of Makarov Pistol without losing the precision within. The CO²-powered and NBB designs bring the features that turn its nature into realism and offer a totally different experience than usual. "Quiet but fatal."

BLE-PM2



**EFFICIENT
GAS
RELEASE**



**QUANTITATIVE
GAS INJECTION
VALVE**



AC-03
Shadow Extension Tube (100mm)



Specification

MODEL	
BLE-002-SB	
Length	265 mm
Inner Barrel	88.5 mm
Capacity	13 Rds
Weight	830 g
Caliber	6 mm

FEATURES

Shadow Extension Tube

CW 14mm thread or CCW 14mm thread are both available on its ends.

14mm CCW Steel Muzzle End

Able to adapt suppressor or extension tube.

Adjustable H-UP

Allows player to adjust the H-UP according to players' need with an Allen key.

CO² Safe-Releasing

"Press-To-Vent" hammer design offers a proper protection when charging new CO² with a press on the button.

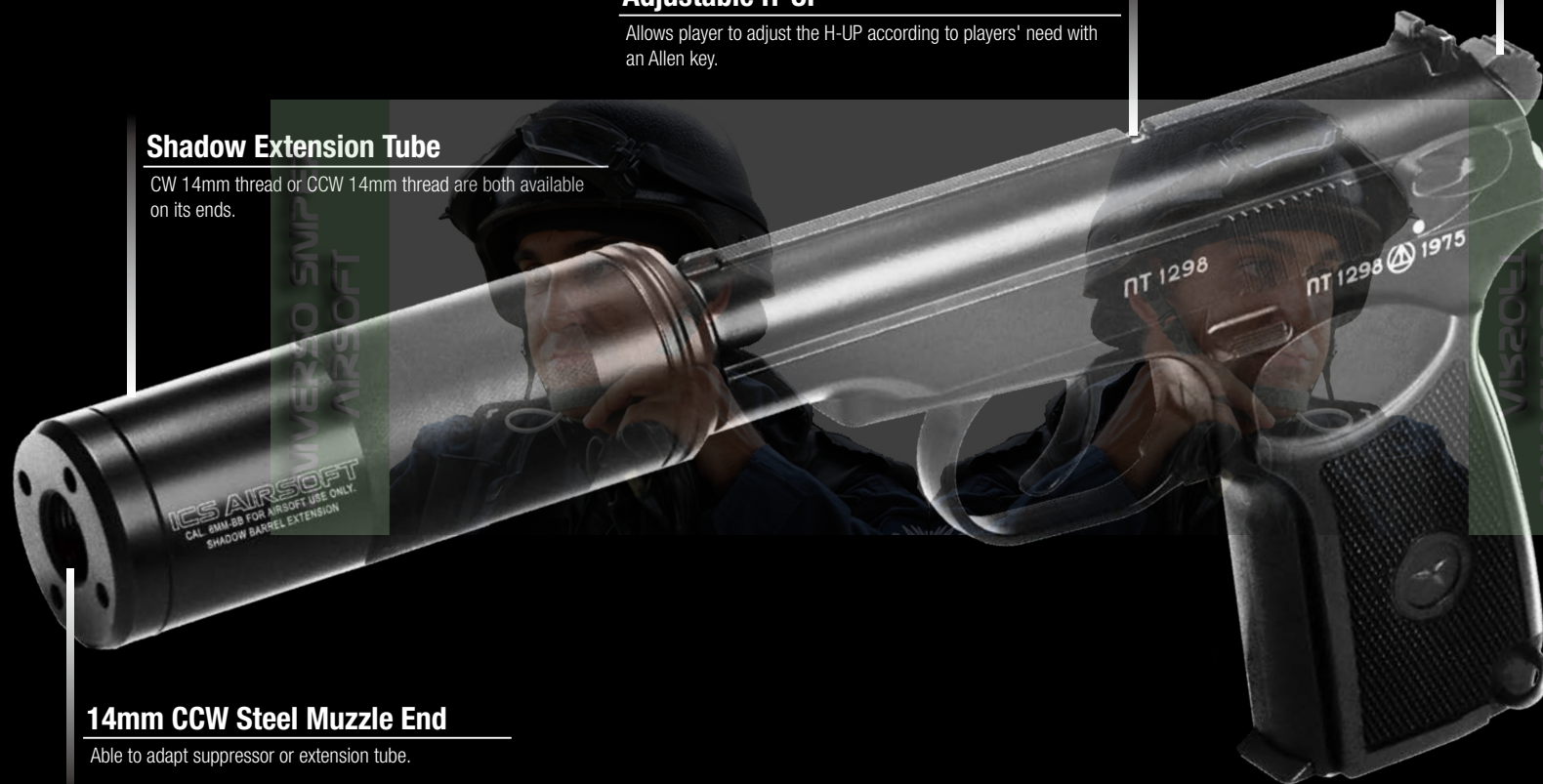

Ø6.03 Inner Barrel

A universal spec 6.03mm precision barrel is easier for upgrading and maintenance.



Safety Switch

Quick mode change with a red spot marking.



Non-Blow-Back System

For purposes of shooting in silence and keeping the frame intact while using CO₂ power, NBB system is thus born to fulfill them. With non-moving slide, reduce the possible waste on CO₂ and concentrate on projecting pellets.



Shadow Cup / Stabilizer

Designed for assisting airsofters to play in stealth style, Shadow Cup / Stabilizer can reduce the volume of shooting of your pistol.



Reinforced Steel Internal Parts

Original-designed pre-upgraded steel hammer and firing pin are able to endure the strong force for High-pressure CO₂ gas.

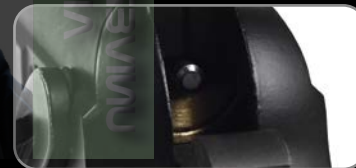



FORTIS

BLE-XFG

XTREME FLEXIBLE GUARDIAN



TAIWAN
EXCELLENCE
2019



BLE-XFG



**EFFICIENT
GAS
RELEASE**



**QUANTITATIVE
GAS INJECTION
VALVE**



BLE-005-SB



BLE-005-SH



BLE-005-ST



BLE-005-SD1



BLE-005-SD2

Specification

Length	184 mm
Inner Barrel	93 mm
Capacity	19 Rds
Weight	642 g
Caliber	6 mm

FEATURES

High Quality Crafting

Metal parts, especially the major ones such as slide and frame, are all processed with precision, which perform a smooth and punctual operation.

Slide Disassembling Button

Easy-to-access structure allows player to dismantle slide parts quickly.

3-Dot Luminous Sights

Aim-assisting dots are evolved by using Luminous paint. While entering from a brighter place into a darker one with the glow, player will still be able to aim clearly.

14mm CCW Steel Adapter

Capable of accepting most of suppressors and extension tubes of the day.

M1913-Compatible Tactical Rail

Capable of installing all M1913 under-barrel accessories.

Ambidextrous Magazine Release

The ambidextrous design is considerate for players of all needs.

Customisable Grip

Holding it tight? Or being easy with your hand? The grip of XFG offers you a flexibility of changing the pad that faced your palm.



Ø6.03 Inner Barrel

A universal spec 6.03mm precision barrel is easier for upgrading and maintenance.



Compatible Holster

BLE-XFG fits with all the USP fast-drawing Holster of the day.



Additional Safety

The safety button lies beneath the rail which can ensure no accident happened during the non-gaming session.



REVO.II Gas Management System

The brand new REVO.II system is designed with two major mechanisms: one provides sufficient gas output from the magazine and the other offers effective gas injection hence increased capacity when charging.

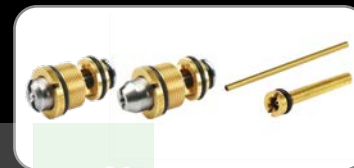

BLE-XAE
XTREME AMBI ENHANCED



TAIWAN
EXCELLENCE
2018

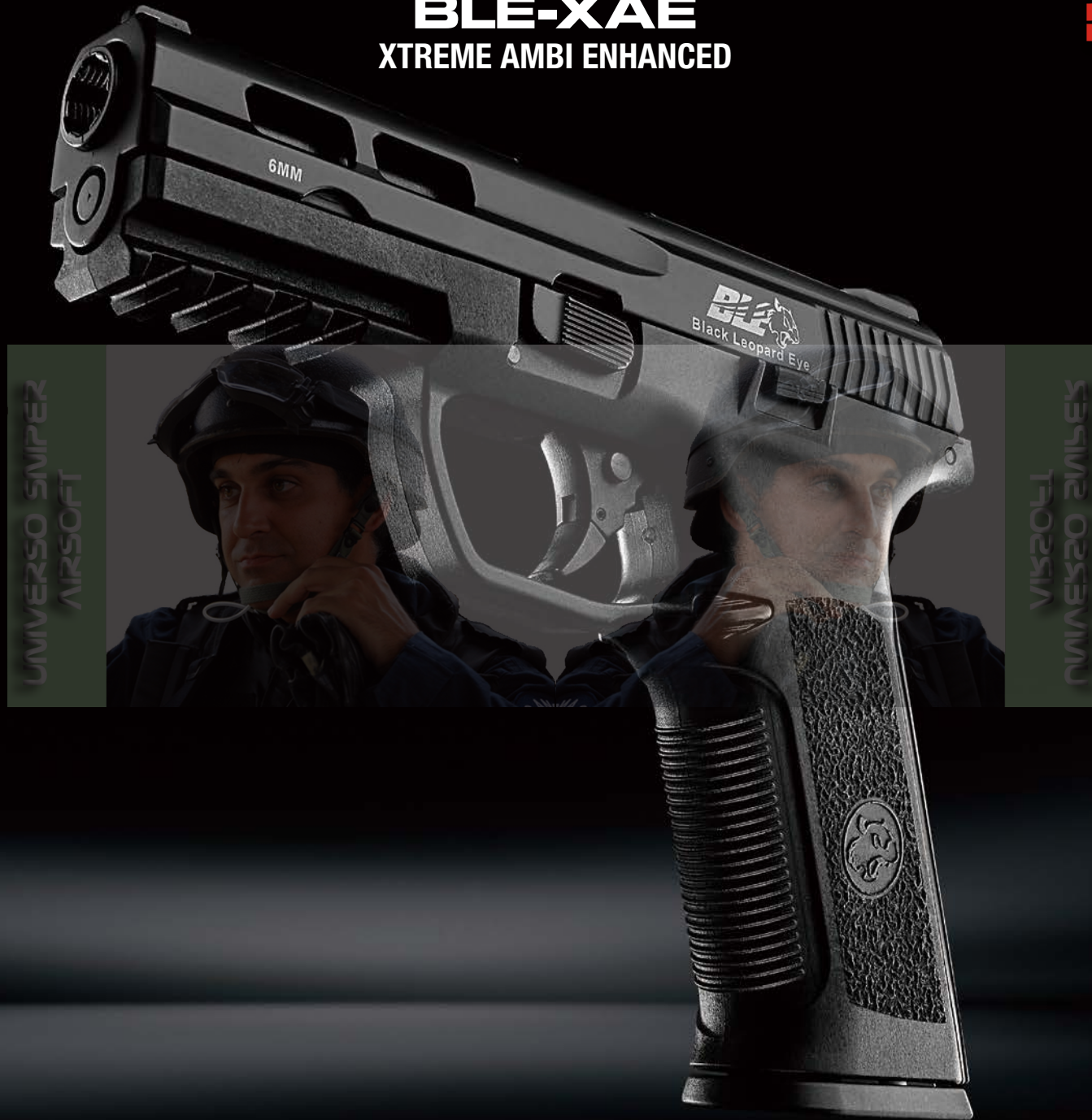

BLE-XAE



**EFFICIENT
GAS
RELEASE**



**QUANTITATIVE
GAS INJECTION
VALVE**



BLE-006-SB



BLE-006-ST



BLE-006-SD3



BLE-006-SD4

Specification

Length	184.5 mm
Inner Barrel	85.5 mm
Capacity	24 Rds
Weight	670 g
Caliber	6 mm

FEATURES

Slide Disassembling Button

Easy-to-access structure allows player to dismantle slide parts quickly.

3-Dot Luminous Sights

Aim-assisting dots are evolved by using Luminous paint. While entering from a brighter place into a darker one with the glow, player will still be able to aim clearly.

14mm CCW Steel Adapter

Capable of accepting most of suppressors and extension tubes of the day.

M1913-compatible Tactical Rail

Capable of installing all M1913 under-barrel accessories.

Two-sided Magazine Release

Ambidextrous catch release design allows player performs a quick release either left-handed or right-handed.

Customisable Grip

Holding it tight? Or being easy with your hand? The grip of XAE offers you a flexibility of changing the pad that faced your palm.



Ø6.03 Inner Barrel

A universal spec 6.03mm precision barrel is easier for upgrading and maintenance.



Trigger Lock

Assure the safety with quick and simple press from the left side of the trigger.



Compatible Holster

BLE-XAE fits with all the 579 Holster of the day.



REVO.II Gas Management System

The brand new REVO.II system is designed with two major mechanisms: one provides sufficient gas output from the magazine and the other offers effective gas injection hence increased capacity when charging.



HERA ARMS COR

THE FUTURE IS NEAR



War changes, so does the battlefield. It varies, from open ground to narrow alley in a city or the mix of many. How can we deal with all of them at once? HERA ARMS offers a perfect answer: CQR (Close Quarter Rifle) system. With the bold design on foregrip and stock, CQR system responds to rapid, short-range combat distinctly from the mainstream.

HERA ARMS, ActionSportGames and ICS forms a partnership to bring the great piece of works to the realm of Airsoft. Integrated with mainframe from ICS CXP series and all the unique features such as SSS E-trigger, pre-cocking mechanism, and split gearbox, the synergy on the fine gear will lead player to a brand new level of fast, instinct, and precise combat performance on the field.

HERA ARMS CQR

CQR FIXED

PROLINE



Specification

Length	706 mm
Inner Barrel	215 mm
Capacity	300 Rds
Weight	3190 g
Caliber	6 mm

IMD-390(S3)-1

FEATURES

HERA 7" RIS Handguard (Licensed)

Made with aluminium alloy by CNC hard anodizing process.

Split Gearbox

The ICS uniquely-designed Split Gearbox benefits players by separated structure of receiver part and gear part which offering capability of easy maintenance and upgrading. Also, you can disassemble and reassemble like real firearm.

HERA QCR Fixed Stock

By its integrated design that unified the grip and the stock, accuracy will be gained with its stability even in mid-range shooting. Also, with its well-carved shape, the player will be able to get in combat posture instinctively.

HERA CC Steel Flash Hider (Licensed)

Licensed CC steel flash hider.

Short-Stroke Trigger

Shorter distance trigger travels, faster firing rate you can get. With pre-cocking mechanism, all your moves are able to go like a straight line.

HERA QCR Foregrip (Licensed)

The unique design provides multiple ways whether to grip, hold, or any form you can get in your combat posture.

T-window Magazine

The innovative 300-round high-capacity magazine with ammo-monitoring window offers player with the maximum support on their firepower.



EBB System

To maximise the experience of realism, our improved EBB system can simulate the real firearm bolt moving by bolt-plate travels back and forth while firing.



Quick-disassembling Clip

Recoil spring guide rod with reverse plug retention clip is equipped within allows player can dismantle more easily.



Reinforced Internal Parts

Pre-upgraded parts such as high strength engineering plastic piston, metal H-UP unit, reinforced MIM pinion and bevel gears will be able to endure longer and tougher operation.



SSS.II E-trigger

Monitor and coordinate all movements and feedbacks of trigger then improves time by time.



Spring Relaxing

For the purpose of lowering depreciation and lengthening the usable life of spring, Spring Relaxing Mechanism is equipped and will activate in safety mode.



EVO I 3500RPM Motor

With quality, made in Taiwan, EVO motor is equipped with a design to reduce heat accumulation and improve endurance by using high heat resistance magnet.



UNIVERSO SNIPER
AIRSOFT



UNIVERSO SNIPER
AIRSOFT



ABOUT LIGHTWAY SERIES

Whatever the journey of a true warrior will be, it all starts simple. The Lightway Series carry a mission to pave the straight way and be the guiding light to an audience to become a participator. Developed from experiences and designs from some of the major series, ICS creates an entry-level AEG platform with all the necessary but advance elements. To who just step in, bearing burdens such as weight, maintenance, and investment is a stumbling rock. Yet, we have Lightway Series to get rid of them.

PELEADOR.III

LIGHT, THE WAY



ICS is officially authorized by MAGPUL to use M-LOK system, allowing our products equipped with latest technology and be the part of the future of airsoft industry.

PELEADOR.III

ERGO

SPORTLINE



ICS-445S3

NEW
PRODUCT

Specification

Length	770-844 mm
Inner Barrel	263 mm
Capacity	300 Rds
Weight	2381 g
Caliber	6 mm

FEATURES

Spring Relaxing

For the purpose of lowering depreciation and lengthening the usable life of spring, Spring Relaxing Mechanism is equipped and will activate in safety mode.

Split Gearbox

The ICS uniquely-designed Split Gearbox benefits players by separated structure of receiver part and gear part which offering capability of easy maintenance and upgrading. Also, you can disassemble and reassemble like real firearm.

CFS Sights

Reinforced-polymer-made CFS foldable sights has features such as lighter weight, sturdy durability. Its compact profile allow it can still coexist with any optic installed while folding, no need for dismounting.

Lightweight M-LOK Handguard

By our unique technique, fabricated with reinforced industrial nylon fiber, the handguard possesses a metallic-looking surface and seamless structure which present both modern design, fine quality, and lightweight.

Short-Stroke Trigger

Shorter distance trigger travels, faster firing rate you can get. With pre-cocking mechanism, all your moves are able to go like a straight line.

T-window Magazine

The innovative 300-round high-capacity magazine with ammo-monitoring window offers player with the maximum support on their firepower.



INTERGRATED T-DEAN



Premium Parts by MASTER MODS

The Peleador.III is equipped with Metal Cross Air Nozzle, Master Hop Tensioner Nub, Cylinder and Piston Heads, Full Steel Teeth Piston, and MIM Pinion and Bevel gears, which provides you a performance-grade reinforced internal, no need for further upgrades.



Quick-disassembling Clip

Recoil spring guide rod with reverse plug retention clip is equipped within allows player can dismantle more easily.



Tactical ERGO Stock

The New ICS Ergo Stock has a 4-stage adjustable design and widened space for battery, suitable for most of the aftermarket batteries, giving your weapon the possibility to perform with sufficient power and longer operating duration.



SSS.III E-trigger

Monitor and coordinate all movements and feedbacks of trigger then improves time by time.



Smart Trigger

This is it. Firing mode can be switched without off your finger from trigger. Pull, and hold, the trigger for 5 seconds and activate the 3-round burst mode. And it is simple to reset to default, just by repeating the move above.



EVO I 35000RPM Motor

With quality, made in Taiwan, EVO motor is equipped with a design to reduce heat accumulation and improve endurance by using high heat resistance magnet.



DAGGER



ICS is officially authorized by MAGPUL to use M-LOK system, allowing our products equipped with latest technology and be the part of the future of airsoft industry.

DAGGER

SPORTLINE



**NEW
PRODUCT**

Specification

Length	600-695 mm
Inner Barrel	186 mm
Capacity	300 Rds
Weight	2078 g
Caliber	6 mm

**NEW
PRODUCT**

Specification

Length	640-711 mm
Inner Barrel	186 mm
Capacity	300 Rds
Weight	2305 g
Caliber	6 mm



ICS-444

MTR



ICS-444S3

ERGO

FEATURES

Spring Relaxing

For the purpose of lowering depreciation and lengthening the usable life of spring, Spring Relaxing Mechanism is equipped and will activate in safety mode.

Split Gearbox

The ICS uniquely-designed Split Gearbox benefits players by separated structure of receiver part and gear part which offering capability of easy maintenance and upgrading. Also, you can disassemble and reassemble like real firearm.

CFS Sights

Reinforced-polymer-made CFS foldable sights has features such as lighter weight, sturdy durability. Its compact profile allow it can still coexist with any optic installed while folding, no need for dismounting.

Lightweight M-LOK Handguard

By our unique technique, fabricated with reinforced industrial nylon fiber, the handguard possesses a metallic-looking surface and seamless structure which present both modern design, fine quality, and lightweight.

Short-Stroke Trigger

Shorter distance trigger travels, faster firing rate you can get. With pre-cocking mechanism, all your moves are able to go like a straight line.

T-window Magazine

The innovative 300-round high-capacity magazine with ammo-monitoring window offers player with the maximum support on their firepower.

INTERGRATED T-DEAN



Premium Parts by MASTER MODS

The Dagger (SSS ver. as default) is equipped with Metal Cross Air Nozzle, Master Hop Tensioner Nub, Cylinder and Piston Heads, Full Steel Teeth Piston, and MIM Pinion and Bevel gears, which provides you a performance-grade reinforced internal, no need for further upgrades.



Quick-Disassembling Clip

Recoil spring guide rod with reverse plug retention clip is equipped within allows player can dismantle more easily.



Tactical ERGO Stock

The New ICS Ergo Stock has a 4-stage adjustable design and widened space for battery, suitable for most of the aftermarket batteries, giving your weapon the possibility to perform with sufficient power and longer operating duration.



SSS.III E-trigger

Monitor and coordinate all movements and feedbacks of trigger then improves time by time.



Smart Trigger

This is it. Firing mode can be switched without off your finger from trigger. Pull, and hold, the trigger for 5 seconds and activate the 3-round burst mode. And it is simple to reset to default, just by repeating the move above.



EVO I 35000RPM Motor

With quality, made in Taiwan, EVO motor is equipped with a design to reduce heat accumulation and improve endurance by using high heat resistance magnet.



PELEADOR

UNIVERSO SNIPER
AIRSOFT

UNIVERSO SNIPER
AIRSOFT

M
M-LOK

ICS is officially authorized by MAGPUL to use M-LOK system, allowing our products equipped with latest technology and be the part of the future of airsoft industry.

PELEADOR

MTR

SPORTLINE



ICS-445

NEW
PRODUCT

Specification

Length	717-794 mm
Inner Barrel	263 mm
Capacity	300 Rds
Weight	2106 g
Caliber	6 mm

FEATURES

Spring Relaxing

For the purpose of lowering depreciation and lengthening the usable life of spring, Spring Relaxing Mechanism is equipped and will activate in safety mode.

Split Gearbox

The ICS uniquely-designed Split Gearbox benefits players by separated structure of receiver part and gear part which offering capability of easy maintenance and upgrading. Also, you can disassemble and reassemble like real firearm.

CFS Sights

Reinforced-polymer-made CFS foldable sights has features such as lighter weight, sturdy durability. Its compact profile allow it can still coexist with any optic installed while folding, no need for dismounting.

Lightweight M-LOK Handguard

By our unique technique, fabricated with reinforced industrial nylon fiber, the handguard possesses a metallic-looking surface and seamless structure which present both modern design, fine quality, and lightweight.

T-window Magazine

The innovative 300-round high-capacity magazine with ammo-monitoring window offers player with the maximum support on their firepower.



INTERGRATED T-DEAN

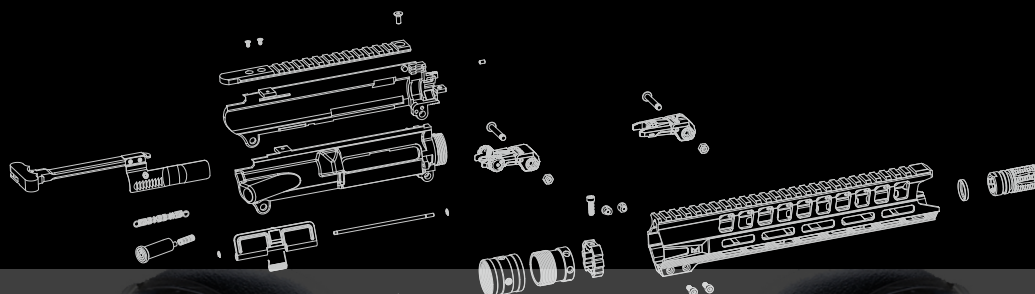
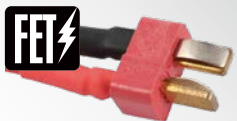

Quick-Disassembling Clip

Recoil spring guide rod with reverse plug retention clip is equipped within allows player can dismantle more easily.



Built-in MOSFET

Play safe and stay long on the field is the condition not allowed to be compromised. MOSFET has lower resistance that will let the system wastes less power and produce less heat during the operation.



EVO I 25000RPM Motor

With quality, made in Taiwan, EVO motor is equipped with a design to reduce heat accumulation and improve endurance by using high heat resistance magnet.







ICS CXP

ABOUT CXP SERIES

Many firearms have been created and applied on the battlefield. As the day changes, SALW (Small Arms and Lightway Weapons) has become the mainstream in the world. By widely includes sorts of weapon design with different style or purpose, ICS thus is able to create a fine piece of CXP Series with ergonomic design and the most realistic experience.



CXP-MARS.II

THE GENERATION OF NEW

Inherited the core value of MARS Series, the brand new MARS.II Series arrive with many revolutionary changes within. Multiple pre-upgraded parts, refined structure, the latest SSS.III E-Trigger System, and so on. With the new M-LOK rail system applied, all efforts just to offer a better platform for airsofters, where starts higher, flies further.*

M
M-LOK

ICS is officially authorized by MAGPUL to use M-LOK system, allowing our products equipped with latest technology and be the part of the future of airsoft industry.

CXP-MARS.II

PROLINE



**NEW
PRODUCT**

Specification

Length	690-761 mm
Inner Barrel	263 mm
Capacity	300 Rds
Weight	2900 g
Caliber	6 mm

**NEW
PRODUCT**

Specification

Length	872-946 mm
Inner Barrel	375 mm
Capacity	300 Rds
Weight	3020 g
Caliber	6 mm

**NEW
PRODUCT**

Specification

Length	997-1025 mm
Inner Barrel	458 mm
Capacity	300 Rds
Weight	3550 g
Caliber	6 mm



ICS-308(S3)

PDW



ICS-309(S3)

ERGO



ICS-310(S3)

UKSR

FEATURES

Spring Relaxing

For the purpose of lowering depreciation and lengthening the usable life of spring, Spring Relaxing Mechanism is equipped and will activate in safety mode.

Split Gearbox

The ICS uniquely-designed Split Gearbox benefits players by separated structure of receiver part and gear part which offering capability of easy maintenance and upgrading. Also, you can disassemble and reassemble like real firearm.

CNC-Machined All-Metal Receiver

Every core frame of MARS.II is well-machined with CNC process which gives an aggressive look and geometrical surfaces.

CFS Sights

Reinforced-polymer-made CFS foldable sights has features such as lighter weight, sturdy durability. Its compact profile allow it can still coexist with any optic installed while folding, no need for dismounting.

Ergonomic Vertical Pistol Grip

The newly-designed "20°-Vertical" Pistol Grip has a compact looking, though. With right-angle shape, the comfort and control of gripping increase. Also The QD Button Cap allows the player to perform motor maintenance more easily.

Short-Stroke Trigger

Shorter distance trigger travels, faster firing rate you can get. With pre-cocking mechanism, all your moves are able to go like a straight line.

T-window Magazine

The innovative 300-round high-capacity magazine with ammo-monitoring window offers player with the maximum support on their firepower.

Aluminium M-LOK Handguard

Made with hard anodized aluminium alloy, the handguard possesses a perfect surface and solid structure which present both modern design, fine quality, and lightweight.

INTERGRATED T-DEAN



EBB System

The ICS EBB (Electric Blow Back) system brings the most realistic experience to a real firearm without sacrificing the durability and the shooting performance.



Premium Parts by MASTER MODS

The MARS.II (SSS ver. as default) is equipped with Metal Cross Air Nozzle, Master Hop Tensioner Nub, Cylinder and Piston Heads, Full Steel Teeth Piston, and MIM Pinion and Bevel gears, which provides you a performance-grade reinforced internal, no need for further upgrades.



Quick-Disassembling Clip

Recoil spring guide rod with reverse plug retention clip is equipped within allows player can dismantle more easily.



Tactical ERGO Stock

The New ICS Ergo Stock has a 4-stage adjustable design and widened space for battery, suitable for most of the aftermarket batteries, giving your weapon the possibility to perform with sufficient power and longer operating duration.

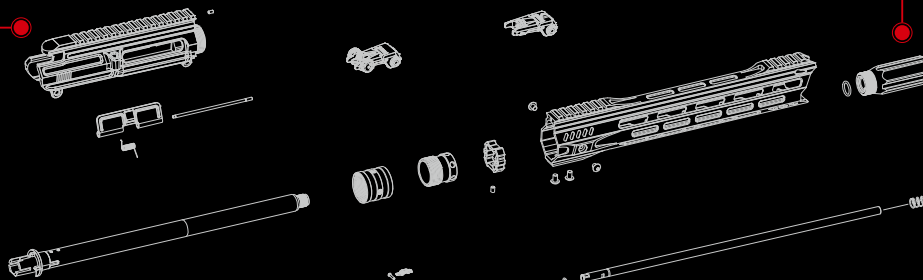

Realistic Muzzle Brake

This is not just a decor makes the gear looks real, this is a part to the perfection. The muzzle brake provides not only appearance but also adapt the sound amplifier muzzle.



SSS.III E-trigger

Monitor and coordinate all movements and feedbacks of trigger then improves time by time.



Smart Trigger

The smart sensing unit is able to distinguish whether it is time for the motor performing a short dash or full throttle in full-auto mode by recording your strength on trigger pulling and length of the time, a precise power output.



EVO I 35000RPM Motor

With quality, made in Taiwan, EVO motor is equipped with a design to reduce heat accumulation and improve endurance by using high heat resistance magnet.



CXP-ARK

FUSION OF THE LEGENDS



Long survived and lived the legend has in jungle, in desert, or in snowfield. One may tell its durability and classic look but know not the beast desires more. The chance appeared when a nova star in rifle with advanced design for combat arrived, two into one, unprecedented fusion. Not the Frankstein people are afraid of, ICS integrated the best parts of both and adding more magical technologies. A well-modernised combat rifle with nostalgic shape, ARK has come to extend the legend.

M
M-LOK

ICS is officially authorized by MAGPUL to use M-LOK system, allowing our products equipped with latest technology and be the part of the future of airsoft industry.

CXP-ARK



◀ MK-94
Optional: MAR Tactical Mid-cap
Magazine-BK
(50/30 Rounds)



◀ MK-940D
Optional: MAR Tactical Mid-cap
Magazine-OD
(50/30 Rounds)

Specification

Length	638-884 mm
Inner Barrel	375 mm
Capacity	540 Rds
Weight	3365 g
Caliber	6 mm

FEATURES

SF1 Quick Response Stock

Specifically designed for the needs of quick engagement. It is capable to be fully stretched then adjust to a proper length by the adjusting lever; the cheek pad can also be adjusted to create the best comfort while aiming.

Firing Mode Selector

The newly-designed selector allows not just simply choose between the modes, it also can lock the charging handle when adjusting H-UP.

Spring Relaxing

For the purpose of lowering depreciation and lengthening the usable life of spring, Spring Relaxing Mechanism is equipped. Open the upper receiver cover then push the firing mode selector to the very top.

Classic Sight

The final touch of a ARK is simple but critical. The original-designed front sight makes the ARK whole.

Ergo-Tech Textured Grip

Made of industrial-grade nylon fiber, the ARK ergo-tech tactical grip is designed with unique ergonomics and anti-slip texture to increases the grip friction which achieves both solid and comfortable at the same time.

Short-Stroke Trigger

Shorter distance trigger travels, faster firing rate you can get. With pre-cocking mechanism, all your moves are able to go like a straight line.

T-Window Magazine

The innovative 520-round high-capacity magazine with ammo-monitoring window offers player with the maximum support on their firepower. Optional 50/30-round magazine is also available for military simulation of real firearms.

Lightweight M-LOK Handguard

By our unique technique, fabricated with reinforced industrial nylon fiber, the handguard possesses a metallic-looking surface and seamless structure which present both modern design, fine quality, and lightweight.

INTERGRATED T-DEAN



Quick-Disassembling Clip

Recoil spring guide rod with reverse plug retention clip is equipped within allows player can dismantle more easily.



Built-in MOSFET

Play safe and stay long on the field is the condition not allowed to be compromised. MOSFET has lower resistance that will let the system wastes less power and produce less heat during the operation.



Premium Parts by MASTER MODS

The ARK (SSS ver. as default) is equipped with Metal Cross Air Nozzle, Master Hop Tensioner Nub, Cylinder and Piston Heads, Full Steel Teeth Piston, and MIM Pinion and Bevel gears, which provides you a performance-grade reinforced internal, no need for further upgrades.



SSS.III E-trigger

Monitor and coordinate all movements and feedbacks of trigger then improves time by time.



Smart Trigger

The smart sensing unit is able to distinguish whether it is time for the motor performing a short dash or full throttle in full-auto mode by recording your strength on trigger pulling and length of the time, a precise power output.



EVO I 35000RPM Motor

With quality, made in Taiwan, EVO motor is equipped with a design to reduce heat accumulation and improve endurance by using high heat resistance magnet.



CXP-MARS PDW9

SMALLER ROUND BIGGER PUNCH



UNIVERSO SNIPER
AIRSOFT

UNIVERSO SNIPER
AIRSOFT

The PDW9 is the latest member in the CXP-MARS family. Young though it is, driven by several technologies inherited from the family, the power within is much more one can never imagine. With its compact shape, PDW9 allows player to unleash the agility at maximum and be the one who turns the game.



ICS is officially authorized by MAGPUL to use M-LOK system, allowing our products equipped with latest technology and be the part of the future of airsoft industry.

CXP-MARS PDW9



ICS-420(S3)

IMG-420(S3)-1

Specification

Length	619-690 mm
Inner Barrel	160 mm
Capacity	340 Rds
Weight	2692 g
Caliber	6 mm



MA-476
Optional: PDW9 Mid-Cap Magazine
(120 Rounds)

FEATURES

Split Gearbox

The ICS uniquely-designed Split Gearbox benefits players by separated structure of receiver part and gear part which offering capability of easy maintenance and upgrading. Also, you can disassemble and reassemble like real firearm.

Spring Relaxing

For the purpose of lowering depreciation and lengthening the usable life of spring, Spring Relaxing Mechanism is equipped. Open the upper receiver cover then push the firing mode selector to the very top.

Realistic Ejection Port

The port offers not only the real look but also a rear-lockable bolt plate for easy H-UP adjustment.

CFS Sights

Reinforced-polymer-made CFS foldable sights has features such as lighter weight, sturdy durability. Its compact profile allow it can still coexist with any optic installed while folding, no need for dismounting.

PDW Stock

The PDW stock is made of top industrial polymer and built with a metal adapter to ensure the structure being solid. It features not only lightweight, durability, but also Adjustable 3-position Fast Draw Deployment Mechanism. Enlarged room for battery in the stock tube, available for 3-cell Li-Po battery.

Ergonomic Vertical Pistol Grip

The newly-designed "20°-Vertical" Pistol Grip has a compact looking, though. With right-angle shape, the comfort and control of gripping increase. Also The QD Button Cap allows the player to perform motor maintenance more easily.

Short-Stroke Trigger

Shorter distance trigger travels, faster firing rate you can get. With pre-cocking mechanism, all your moves are able to go like a straight line.

Aluminium M-LOK Handguard

Made with hard anodized aluminium alloy, the handguard possesses a perfect surface and solid structure which present both modern design, fine quality, and lightweight.

Pistol Caliber Style Magazine

330-round high-capacity magazine in pistol caliber style.
120-round mid-capacity magazine with translucent housing and internal mock-up bullet design is available as option.

EBB System

The ICS EBB (Electric Blow Back) system brings the most realistic experience to a real firearm without sacrificing the durability and the shooting performance.



Premium Parts by MASTER MODS

The MARS.II (SSS ver. as default) is equipped with Metal Cross Air Nozzle, Master Hop Tensioner Nub, Cylinder and Piston Heads, Full Steel Teeth Piston, and MIM Pinion and Bevel gears, which provides you a performance-grade reinforced internal, no need for further upgrades.



Quick-Disassembling Clip

Recoil spring guide rod with reverse plug retention clip is equipped within allows player can dismantle more easily.



Drum Magazine Adaptor (Optional)

The MARS PDW9 is able to work with ICS electric drum magazine, just install this adaptor.



SSS.III E-trigger

Monitor and coordinate all movements and feedbacks of trigger then improves time by time.



EVO I 35000RPM Motor

With quality, made in Taiwan, EVO motor is equipped with a design to reduce heat accumulation and improve endurance by using high heat resistance magnet.



A soldier in full combat gear, including a helmet with a night vision mount and a "BLIND" tag, is aiming a black Magpul CXP-MMR rifle. The soldier is wearing a tan jacket with a "FUCK CALM Die in Battle And Go To Valhalla" patch and a "007" tag. The rifle has a "CAUTION SNIPER RIFLE" warning. The background is a rocky, desert-like environment.

CXP-MMR



ICS are officially authorized by Magpul to use M-LOK standard, allowing us to make more reliable products for the future airsoft industry.

CXP-MMR

PROLINE



Specification

Length	975-1005 mm
Inner Barrel	458 mm
Capacity	300 Rds
Weight	3393 g
Caliber	6 mm

ICS-400

UKSR

Specification

Length	835-930 mm
Inner Barrel	375 mm
Capacity	300 Rds
Weight	2886 g
Caliber	6 mm

ICS-401

MTR SI

CXP-YAK



CXP-YAK

PROLINE



ICS-410
IMT-410-1

MTR SI

Specification

Length	733-825 mm
Inner Barrel	263 mm
Capacity	300 Rds
Weight	3067 g
Caliber	6 mm



ICS-411
IMT-411-1

MTR SI

Specification

Length	835-930 mm
Inner Barrel	375 mm
Capacity	300 Rds
Weight	3145 g
Caliber	6 mm



ICS-412
IMT-412-1

UKSR

Specification

Length	947-977 mm
Inner Barrel	420 mm
Capacity	300 Rds
Weight	3617 g
Caliber	6 mm



ICS-413
IMT-413-1

MTR SI

Specification

Length	743-838 mm
Inner Barrel	263 mm
Capacity	300 Rds
Weight	3145 g
Caliber	6 mm

CXP-APE



CXP-APE



Specification

Length	716-784 mm
Inner Barrel	263 mm
Capacity	300 Rds
Weight	2900 g
Caliber	6 mm



Specification

Length	827-895 mm
Inner Barrel	375 mm
Capacity	300 Rds
Weight	3000 g
Caliber	6 mm





TAIWAN
EXCELLENCE
2017

CXP-UKI



CXP-UKI

MTR

PROLINE



Specification

Length	617-693 mm
Inner Barrel	186 mm
Capacity	300 Rds
Weight	2840 g
Caliber	6 mm



ICS-262

IMT-262-1

Specification

Length	700-795 mm
Inner Barrel	263 mm
Capacity	300 Rds
Weight	2700 g
Caliber	6 mm



ICS-264

IMT-264-1

Specification

Length	811-906 mm
Inner Barrel	375 mm
Capacity	300 Rds
Weight	2920 g
Caliber	6 mm



ICS-265

IMT-265-1

CXP-HOG

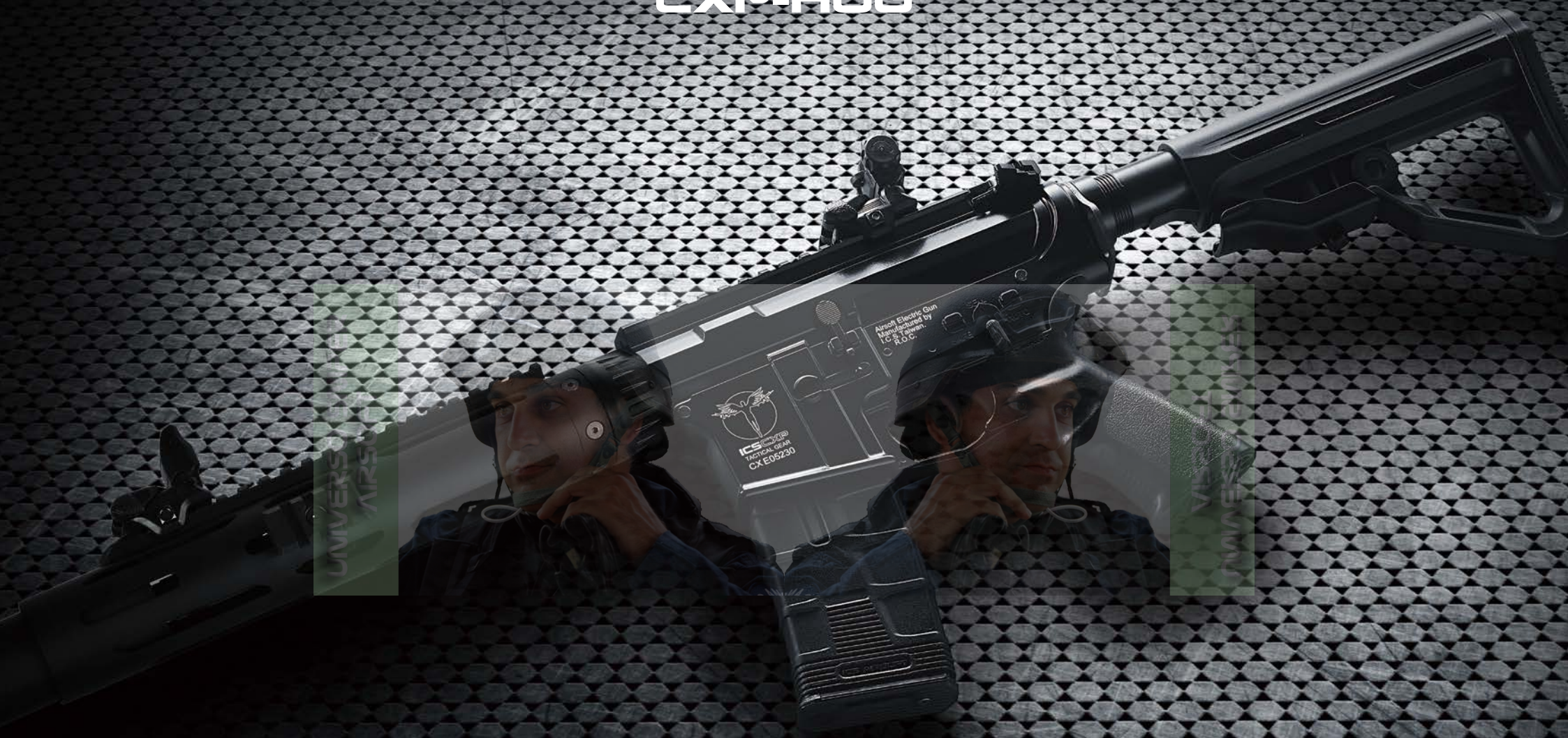

CXP-HOG

PROLINE



Specification

Length	800-880 mm
Inner Barrel	375 mm
Capacity	300 Rds
Weight	2860 g
Caliber	6 mm

ICS-380

MTR

Specification

Length	895-925 mm
Inner Barrel	375 mm
Capacity	300 Rds
Weight	3300 g
Caliber	6 mm

ICS-275

UKSR

CXP-08 / 16



CXP-08

QRS

SPORTLINE



Specification

Length	595-695 mm
Inner Barrel	200 mm
Capacity	300 Rds
Weight	2150 g
Caliber	6 mm

ICS-160

CXP-16

CRANE

PROLINE



Specification

Length	885-980 mm
Inner Barrel	303 mm
Capacity	300 Rds
Weight	3300 g
Caliber	6 mm

ICS-238

CXP-15



UNIVERSO SNIPER
AIRSOFT

UNIVERSO SNIPER
AIRSOFT

CXP-15

SPORTLINE



Specification

Length	472 mm
Inner Barrel	200 mm
Capacity	300 Rds
Weight	1600 g
Caliber	6 mm



ICS-172

PSL

Specification

Length	642-732 mm
Inner Barrel	200 mm
Capacity	300 Rds
Weight	1800 g
Caliber	6 mm



ICS-170

RETRACTABLE

CES-P

LEGEND NEVER DIES

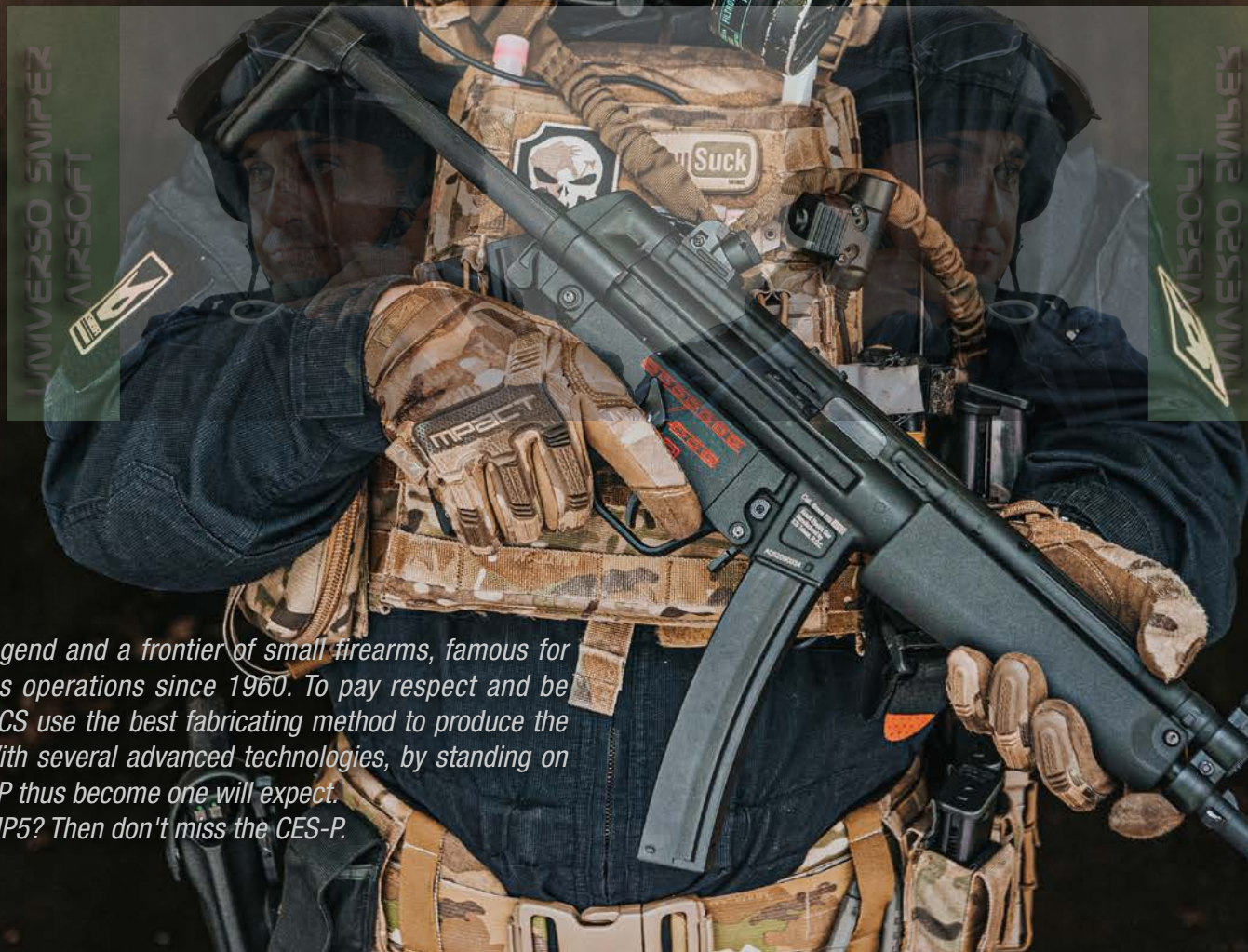

MP5 has been known as a legend and a frontier of small firearms, famous for participating many dangerous operations since 1960. To pay respect and be able to mirror its greatness, ICS use the best fabricating method to produce the strongest steel as material. With several advanced technologies, by standing on the shoulder of the giant, CES-P thus become one will expect. Looking for the most realistic MP5? Then don't miss the CES-P.

CES-P

PROLINE



Specification

Length	490-760 mm
Inner Barrel	230 mm
Capacity	230 Rds
Weight	2800 g
Caliber	6 mm

ICS-212S3

SFS

Specification

Length	500-650 mm
Inner Barrel	230 mm
Capacity	230 Rds
Weight	2600 g
Caliber	6 mm

ICS-211S3

RETRACTABLE

FEATURES

MRS Tactical Handguard (SFS ver.)

Even with such shortened length, the rail can carry essential support from the gadget you install.

SFS Stock

The unique-designed SFS stock is one of the enhancement ICS offers. Solid-shaped but foldable with a 4-stage extendable structure, and a rapid adjustable cheek rest.

Retractable Stock

The stock rods are made by SPCC steel which is able to survive after intensively times of operations. The stock butt plate use the exactly the same engineering method of the real one.

Split Gearbox

The ICS uniquely-designed Split Gearbox benefits players by separated structure of receiver part and gear part which offering capability of easy maintenance and upgrading. Also, you can disassemble and reassemble like real firearm.

Short-Stroke Trigger

Shorter distance trigger travels, faster firing rate you can get. With pre-cocking mechanism, all your moves are able to go like a straight line.

SPCC Weld Processed Stamping Steel

By using the same material, with our skilled fabricating process, CES-P has the good quality such as durability and solid structure just like the real one.



Quick-disassembling Clip

Recoil spring guide rod with reverse plug retention clip is equipped within allows player can dismantle more easily.



Receivers with Power-Safe Design

Along with the separable structure of gearbox, the upper and lower receivers will be completely separated and no any connection. This assures player being able to open the gearbox and maintain the parts within safely without removing the battery.



SSS.II E-trigger

Monitor and coordinate all movements and feedbacks of trigger then improves time by time.



Spring Relaxing

For the purpose of lowering depreciation and lengthening the usable life of spring, Spring Relaxing Mechanism is equipped. Open the upper receiver cover then push the firing mode selector to the very top.



EVO I 35000RPM Motor

With quality, made in Taiwan, EVO motor is equipped with a design to reduce heat accumulation and improve endurance by using high heat resistance magnet.



CES



UNIVERSO SNIPER
AIRSOFT

UNIVERSO SNIPER
AIRSOFT

PROLINE



ICS-01

FIXED

Specification

Length	780 mm
Inner Barrel	230 mm
Capacity	230 Rds
Weight	2240 g
Caliber	6 mm



ICS-02

RETRACTABLE

Specification

Length	600-741 mm
Inner Barrel	230 mm
Capacity	230 Rds
Weight	2300 g
Caliber	6 mm



ICS-03

FIXED

Specification

Length	680 mm
Inner Barrel	230 mm
Capacity	230 Rds
Weight	2300 g
Caliber	6 mm



ICS-04

RETRACTABLE

Specification

Length	500-640 mm
Inner Barrel	230 mm
Capacity	230 Rds
Weight	2000 g
Caliber	6 mm

CS4



PROLINE



Specification

Length	778-873 mm
Inner Barrel	375 mm
Capacity	450 Rds
Weight	3000 g
Caliber	6 mm



ICS-20

RETRACTABLE

Specification

Length	730-815 mm
Inner Barrel	263 mm
Capacity	450 Rds
Weight	3250 g
Caliber	6 mm



ICS-321

CRANE

Specification

Length	778-873 mm
Inner Barrel	375 mm
Capacity	450 Rds
Weight	2950 g
Caliber	6 mm



ICS-323

MTR

AAR



SFS

SPORTLINE



Specification

Length	515-795 mm
Inner Barrel	263 mm
Capacity	300 Rds
Weight	2550 g
Caliber	6 mm

ICS-233

Specification

Length	515-795 mm
Inner Barrel	263 mm
Capacity	300 Rds
Weight	2550 g
Caliber	6 mm

ICS-235



MAR



PROLINE



ICS-31

FIXED

Specification

Length	965mm
Inner Barrel	458mm
Capacity	550 Rds
Weight	3000 g
Caliber	6 mm



ICS-34

FOLDING

Specification

Length	510-745mm
Inner Barrel	263mm
Capacity	550 Rds
Weight	2700 g
Caliber	6 mm



ICS-35

FOLDING

Specification

Length	714-964mm
Inner Barrel	458mm
Capacity	550 Rds
Weight	3000 g
Caliber	6 mm



ICS-36

FIXED

Specification

Length	960mm
Inner Barrel	458mm
Capacity	550 Rds
Weight	3314 g
Caliber	6 mm

TOD

UNIVERSO
AIRSOFT

UNIVERSO
AIRSOFT

FOLDING

PROLINE



Specification

Length	750-980 mm
Inner Barrel	515 mm
Capacity	400 Rds
Weight	3500 g
Caliber	6 mm



Specification

Length	750-980 mm
Inner Barrel	515 mm
Capacity	400 Rds
Weight	3000 g
Caliber	6 mm



MI GARAND



UNIVERSO SUPER
AIRSOFT

UNIVERSO SUPER
AIRSOFT

MI GARAND

PROLINE



Specification

Length	1100 mm
Inner Barrel	610 mm
Capacity	25 Rds
Weight	3600 g
Caliber	8 mm



ICS-201L

Specification

Length	1100 mm
Inner Barrel	610 mm
Capacity	42 Rds
Weight	3600 g
Caliber	6 mm



ICS-202

M3 GREASER



UNIVERSITY MICROFILMS

UNIVERSITY MICROFILMS

M3 GREASER

PROLINE



ICS-200

Specification

Length	587-763 mm
Inner Barrel	230 mm
Capacity	430 Rds
Weight	2045 g
Caliber	6 mm

L85



UNIVERSO SIMPER
AIRSOFT

UNIVERSO SIMPER
AIRSOFT

L85

PROLINE



Specification

Length	740 mm
Inner Barrel	420 mm
Capacity	450 Rds
Weight	3090 g
Caliber	6 mm

Specification

Length	787 mm
Inner Barrel	480 mm
Capacity	450 Rds
Weight	3652 g
Caliber	6 mm

Specification

Length	913 mm
Inner Barrel	610 mm
Capacity	450 Rds
Weight	4411 g
Caliber	6 mm



ICS-87



ICS-85



ICS-86



MGL



MILKOR



Milkor, (PTY) Ltd., South Africa, and the milkor logo are registered trademarks of Milkor (PTY) Ltd., South Africa - www.milkor.com - and are used for airsoft replicas under license from ActionSportGames A/S, Denmark - www.actionsportgames.com.

MGL



Specification

Length/Retractable	630-725 mm
Capacity	Depends on grenade
Weight	2200 g

Specification

Length/Retractable	675-780 mm
Capacity	Depends on grenade
Weight	2200 g

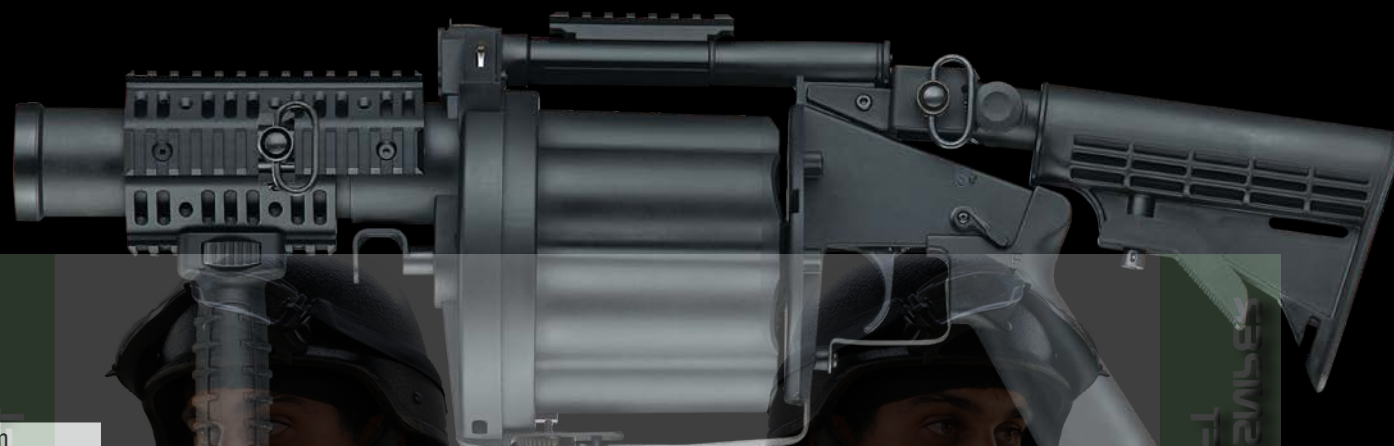

ICS-190

RETRACTABLE



ICS-191

CRANE

SPECIFICATIONS

Series	Item	Model	Type	Receiver Material	Length (mm)	Weight (g)	Inner Barrel Length (mm)	Inner Barrel Bore Diameter (mm)	Gearbox Version	Stock Type	Magazine Capacity (rounds)
HERA ARMS CQR	ICS-390	HERA Arms CQR (BK)	EBB	Metal	706	3,190	215	6.04	ICS Split EBB Gearbox 8mm Bushing	Fixed Stock	300
	IMD-390-1	HERA Arms CQR (TwoTone)	EBB	Metal	706	3,190	215	6.04	ICS Split EBB Gearbox 8mm Bushing	Fixed Stock	300
HERA ARMS CQR SSS	ICS-390S3	HERA Arms CQR S3 (BK)	EBB	Metal	706	3,190	215	6.04	ICS Split EBB Gearbox 8mm Bushing	Fixed Stock	300
	IMD-390S3-1	HERA Arms CQR S3 (TwoTone)	EBB	Metal	706	3,190	215	6.04	ICS Split EBB Gearbox 8mm Bushing	Fixed Stock	300
LIGHTWAY PELEADOR / III	ICS-445	Lightway-Peleador (BK)	AEG	Nylon Fiber	717-794	2333	263	6.04	ICS CS4 Split Gearbox 8mm Bushing	MTR Stock	300
	ICS-445S3	Lightway-Peleador.III (BK)	AEG	Nylon Fiber	770-844	2381	263	6.04	ICS CS4 Split Gearbox 8mm Bushing	ERGO Stock	300
LIGHTWAY DAGGER	ICS-444	Lightway-Dagger (BK)	AEG	Nylon Fiber	600-695	2078	186	6.04	ICS CS4 Split Gearbox 8mm Bushing	MTR Stock	300
	ICS-444S3	Lightway-Dagger S3 (BK)	AEG	Nylon Fiber	640-711	2305	186	6.04	ICS CS4 Split Gearbox 8mm Bushing	ERGO Stock	300
CXP-MARS.II	ICS-308	CXP-MARS.II Komodo Junior (BK)	EBB	Metal	690-761	2900	263	6.04	ICS Split EBB Gearbox 8mm Bushing	PDW Stock	300
	ICS-309	CXP-MARS.II Komodo Carbine (BK)	EBB	Metal	872-946	3020	375	6.04	ICS Split EBB Gearbox 8mm Bushing	ERGO Stock	300
	ICS-310	CXP-MARS.II Komodo DMR (BK)	EBB	Metal	997-1025	3550	458	6.04	ICS Split EBB Gearbox 8mm Bushing	UKSR Stock	300
CXP-MARS.II SSS	ICS-308S3	CXP-MARS.II Komodo Junior S3 (BK)	EBB	Metal	690-761	2900	263	6.04	ICS Split EBB Gearbox 8mm Bushing	PDW Stock	300
	ICS-309S3	CXP-MARS.II Komodo Carbine S3 (BK)	EBB	Metal	872-946	3020	375	6.04	ICS Split EBB Gearbox 8mm Bushing	ERGO Stock	300
	ICS-310S3	CXP-MARS.II Komodo DMR S3 (BK)	EBB	Metal	997-1025	3550	458	6.04	ICS Split EBB Gearbox 8mm Bushing	UKSR Stock	300
CXP-ARK	ICS-131	CXP-ARK (BK)	AEG	Metal	638-884	3365	375	6.04	ICS Ver.3 Gearbox 8mm Bushing	SF1 Stock	540
	IMD-131-1	CXP-ARK (Two Tone)	AEG	Metal	638-884	3365	375	6.04	ICS Ver.3 Gearbox 8mm Bushing	SF1 Stock	540
CXP-ARK SSS	ICS-131S3	CXP-ARK S3	AEG	Metal	638-884	3365	375	6.04	ICS Ver.3 Gearbox 8mm Bushing	SF1 Stock	540
	IMD-131S3-1	CXP-ARK S3 (Two Tone)	AEG	Metal	638-884	3365	375	6.04	ICS Ver.3 Gearbox 8mm Bushing	SF1 Stock	540
CXP-MARS PDW9	ICS-420	CXP-MARS PDW9 (BK)	EBB	Metal	619-690	2692	160	6.04	ICS Split EBB Gearbox 8mm Bushing	PDW Stock	340
	IMG-420-1	CXP-MARS PDW9 (Urban Grey)	EBB	Metal	619-690	2692	160	6.04	ICS Split EBB Gearbox 8mm Bushing	PDW Stock	340
CXP-MARS PDW9 SSS	ICS-420S3	CXP-MARS PDW9 S3 (BK)	EBB	Metal	619-690	2692	160	6.04	ICS Split EBB Gearbox 8mm Bushing	PDW Stock	340
	IMG-420S3-1	CXP-MARS PDW9 S3 (Urban Grey)	EBB	Metal	619-690	2692	160	6.04	ICS Split EBB Gearbox 8mm Bushing	PDW Stock	340
CXP-MMR	ICS-400	CXP-MMR DMR (BK)	EBB	Metal	975-1,005	3,393	458	6.04	ICS Split EBB Gearbox 8mm Bushing	UKSR Stock	300
	ICS-401	CXP-MMR Carbine (BK)	EBB	Metal	835-930	2,886	375	6.04	ICS Split EBB Gearbox 8mm Bushing	S1 Stock	300
CXP-YAK	ICS-410	CXP-YAK SBR (BK)	EBB	Metal	733-825	3,067	263	6.04	ICS Split EBB Gearbox 8mm Bushing	S1 Stock	300
	IMT-410-1	CXP-YAK SBR (TAN)	EBB	Metal	733-825	3,067	263	6.04	ICS Split EBB Gearbox 8mm Bushing	S1 Stock	300
	ICS-411	CXP-YAK Carbine (BK)	EBB	Metal	835-930	3,145	375	6.04	ICS Split EBB Gearbox 8mm Bushing	S1 Stock	300
	IMT-411-1	CXP-YAK Carbine (TAN)	EBB	Metal	835-930	3,145	375	6.04	ICS Split EBB Gearbox 8mm Bushing	S1 Stock	300
	ICS-412	CXP-YAK DMR (BK)	EBB	Metal	947-977	3,617	420	6.04	ICS Split EBB Gearbox 8mm Bushing	UKSR Stock	300
	IMT-412-1	CXP-YAK DMR (TAN)	EBB	Metal	947-977	3,617	420	6.04	ICS Split EBB Gearbox 8mm Bushing	UKSR Stock	300
	ICS-413	CXP-YAK CQB (BK)	EBB	Metal	743-838	3,145	263	6.04	ICS Split EBB Gearbox 8mm Bushing	S1 Stock	300
	IMT-413-1	CXP-YAK CQB (TAN)	EBB	Metal	743-838	3,145	263	6.04	ICS Split EBB Gearbox 8mm Bushing	S1 Stock	300
CXP-APE	ICS-230	CXP-APE (BK)	EBB	Metal	716-784	2,900	263	6.04	ICS Split EBB Gearbox 7mm Bushing	SF1 Stock	300
	IMD-230-1	CXP-APE (TAN)	EBB	Metal	716-784	2,900	263	6.04	ICS Split EBB Gearbox 7mm Bushing	SF1 Stock	300
	ICS-231	CXP-APE Rifle (BK)	EBB	Metal	827-895	3,000	375	6.04	ICS Split EBB Gearbox 7mm Bushing	SF1 Stock	300
	IMD-231-1	CXP-APE Rifle (TAN)	EBB	Metal	827-895	3,000	375	6.04	ICS Split EBB Gearbox 7mm Bushing	SF1 Stock	300

SPECIFICATIONS

Series	Item	Model	Type	Receiver Material	Length (mm)	Weight (g)	Inner Barrel Length (mm)	Inner Barrel Bore Diameter (mm)	Gearbox Version	Stock Type	Magazine Capacity (rounds)
CXP-UK1	ICS-262	CXP-UK1 Captain (BK)	EBB	Metal	617-693	2,840	186	6.04	ICS Split EBB Gearbox 7mm Bushing	MTR Stock	300
	IMT-262-1	CXP-UK1 Captain (TAN)	EBB	Metal	617-693	2,840	186	6.04	ICS Split EBB Gearbox 7mm Bushing	MTR Stock	300
	ICS-264	CXP-UK1 (Rear Wired) (BK)	EBB	Metal	700-795	2,700	263	6.04	ICS Split EBB Gearbox 7mm Bushing	MTR Stock	300
	IMT-264-1	CXP-UK1 (Rear Wired) (TAN)	EBB	Metal	700-795	2,700	263	6.04	ICS Split EBB Gearbox 7mm Bushing	MTR Stock	300
	ICS-265	CXP-UK1 Rifle (Rear Wired) (BK)	EBB	Metal	811-906	2,920	375	6.04	ICS Split EBB Gearbox 7mm Bushing	MTR Stock	300
	IMT-265-1	CXP-UK1 Rifle (Rear Wired) (TAN)	EBB	Metal	811-906	2,920	375	6.04	ICS Split EBB Gearbox 7mm Bushing	MTR Stock	300
CXP-HOG	ICS-275	CXP-HOG Tubular L	EBB	Metal	895-925	3,300	375	6.04	ICS Split EBB Gearbox 7mm Bushing	UKSR Stock	300
	ICS-380	CXP-HOG Tubular SD	EBB	Metal	800-880	2,860	375	6.04	ICS Split EBB Gearbox 7mm Bushing	MTR Stock	300
CXP-08	ICS-160	CXP-08 QRS Stock	AEG	Nylon Fiber	595-695	2,150	200	6.04	ICS CS4 Split Gearbox 7mm Bushing	QRS Stock	300
CXP-16	ICS-238	CXP-16 L Crane Stock	AEG	Metal	885-980	3,300	303	6.04	ICS CS4 Split Gearbox 7mm Bushing	Crane Stock	300
CXP-15	ICS-170	CXP-15 K	AEG	Nylon Fiber	642-732	1,800	200	6.04	ICS CS4 Split Gearbox 7mm Bushing	Retractable Stock	300
	ICS-172	CXP-15 K PSL	AEG	Nylon Fiber	472	1,600	200	6.04	ICS CS4 Split Gearbox 7mm Bushing	N/A	300
CES-P	ICS-211S3	CES-P A5 S3 Retractable Stock	AEG	Metal	500-650	2,600	230	6.04	ICS Ver. 2 Gearbox 8mm Bushing	Retractable Stock	230
	ICS-212S3	CES-P MS1 S3 SFS Stock	AEG	Metal	490-760	2,800	230	6.04	ICS Ver. 2 Gearbox 8mm Bushing	SFS Stock	230
CES	ICS-01	CES SD5	AEG	Metal	780	2,240	230	6.04	ICS Ver. 2 Gearbox 7mm Bushing	Fixed Stock	230
	ICS-02	CES SD6	AEG	Metal	600-741	2,300	230	6.04	ICS Ver. 2 Gearbox 7mm Bushing	Retractable Stock	230
	ICS-03	CES A4	AEG	Metal	680	2,300	230	6.04	ICS Ver. 2 Gearbox 7mm Bushing	Fixed Stock	230
	ICS-04	CES A5	AEG	Metal	500-640	2,000	230	6.04	ICS Ver. 2 Gearbox 7mm Bushing	Retractable Stock	230
CS4	ICS-20	CS4A1	AEG	Metal	778-873	3,000	375	6.04	ICS CS4 Split Gearbox 7mm Bushing	Retractable Stock	450
	ICS-321	CS4 RIS EBB	EBB	Metal	730-815	3,250	263	6.04	ICS Split EBB Gearbox 7mm Bushing	Crane Stock	450
	ICS-323	CS4A1 Tubular RAS S EBB	EBB	Metal	778-873	2,950	375	6.04	ICS Split EBB Gearbox 7mm Bushing	MTR Stock	450
AAR	ICS-233	AAR (BK)	AEG	Nylon Fiber	515-795	2,550	263	6.04	ICS Ver.3 Gearbox 7mm Bushing	SFS Stock	300
	ICS-235	AAR (TwoTone)	AEG	Nylon Fiber	515-795	2,550	263	6.04	ICS Ver.3 Gearbox 7mm Bushing	SFS Stock	300
MAR	ICS-31	MAR	AEG	Metal	965	3,000	458	6.04	ICS Ver.3 Gearbox 7mm Bushing	Fixed Stock	550
	ICS-34	MAR SU	AEG	Metal	510-745	2,700	263	6.04	ICS Ver.3 Gearbox 7mm Bushing	Folding Stock	550
	ICS-35	MAR M	AEG	Metal	714-964mm	3,000	458	6.04	ICS Ver.3 Gearbox 7mm Bushing	Folding Stock	550
	ICS-36	MAR (Wooden)	AEG	Metal	960	3,314	458	6.04	ICS Ver.3 Gearbox 7mm Bushing	Fixed Stock	550
TOD	ICS-91	TOD ARM	AEG	Metal	750-980	3,500	515	6.04	ICS Ver.3 Gearbox 7mm Bushing	Folding Stock	400
	ICS-92	TOD AR	AEG	Metal	750-980	3,000	515	6.04	ICS Ver.3 Gearbox 7mm Bushing	Folding Stock	400
WWII	ICS-200	M3 Greaser	AEG	Metal	587-763	2,045	230	6.04	ICS M3 Gearbox 8mm Bushing	Retractable Stock	430
	ICS-201L	M1 Garand 8mm Limited	AEG	Wood	1,100	3,600	610	8.04	ICS M1 Gearbox 8mm Bushing	Fixed Stock	25
	ICS-202	M1 Garand 6mm	AEG	Wood	1,100	3,600	610	6.04	ICS M1 Gearbox 8mm Bushing	Fixed Stock	42
L85/86	ICS-85	L85 A2 Assault Rifle	AEG	Metal	787	3,652	480	6.04	ICS L85 Gearbox 7mm Bushing	Fixed Stock	450
	ICS-86	L86 A2 LSW	AEG	Metal	913	4,411	610	6.04	ICS L85 Gearbox 7mm Bushing	Fixed Stock	450
	ICS-87	L85 A2 Carbine	AEG	Metal	740	3,090	420	6.04	ICS L85 Gearbox 7mm Bushing	Fixed Stock	450
MGL	ICS-190	MGL (BK)	Multiple Grenade Launcher	Nylon Fiber	630-725	2,200	N/A	N/A	N/A	Retractable Stock	Depends on grenade
	ICS-191	MGL (TAN)		Nylon Fiber	675-780	2,200	N/A	N/A	N/A	Crane Stock	

SPECIFICATIONS

Series	Item	Model	Type	Receiver Material	Slide Material	Length (mm)	Weight (g)	Inner Barrel Length (mm)	Inner Barrel Bore Diameter (mm)	Magazine Capacity (rounds)
Hi-Capa	BLE-007-SB	Hi-Capa CHALLENGER (BK)	GBB	Aluminum	Aluminum	220	910	113	6.04	30
	BLE-007-PB	Hi-Capa CHALLENGER (Plastic)	GBB	Aluminum	Plastic	220	770	113	6.04	30
SAR9.II	BLE-009-SB-2	SARSILMAZ SAR 9.II	GBB	Nylon Fiber	Aluminum	195	750	97	6.03	22
Vulutre	BLE-011-SB	Vulutre (BK)	GBB	Aluminum	Aluminum	195	537	85	6.03	15
	BLE-011-TB	Vulutre (Tactical)	GBB	Aluminum	Aluminum	240	558	115	6.03	15
XMK	BLE-010-CB	XMK (Compact)	GBB	Nylon Fiber	Aluminum	211	720	115	6.03	17
	BLE-010-SB	XMK (BK)	GBB	Nylon Fiber	Aluminum	211	778	115	6.03	23
BM9	BLE-050-SB	BM9 (BK)	GBB	Aluminum	Aluminum	216	1000	115	6.03	20
	BLE-050-ST	BM9 (TAN)	GBB	Aluminum	Aluminum	216	1000	115	6.03	20
PM2	BLE-002-SB	PM2 (BK)	CO ²	Zinc Alloy	N/A	265	830	88.5	6.03	13
XFG	BLE-005-SH	XFG (Hairline)	GBB	Nylon Fiber	Aluminum	184	642	93	6.03	19
	BLE-005-SB	XFG (BK)	GBB	Nylon Fiber	Aluminum	184	642	93	6.03	19
	BLE-005-ST	XFG (TAN)	GBB	Nylon Fiber	Aluminum	184	642	93	6.03	19
	BLE-005-SD1	XFG (Two Tone BKTN)	GBB	Nylon Fiber	Aluminum	184	642	93	6.03	19
	BLE-005-SD2	XFG (Two Tone TNBK)	GBB	Nylon Fiber	Aluminum	184	642	93	6.03	19
XAE	BLE-006-SB	XAE (BK)	GBB	Nylon Fiber	Aluminum	184.5	670	85.5	6.03	24
	BLE-006-ST	XAE (TAN)	GBB	Nylon Fiber	Aluminum	184.5	670	85.5	6.03	24
	BLE-006-SD3	XAE (Two Tone BKTN)	GBB	Nylon Fiber	Aluminum	184.5	670	85.5	6.03	24
	BLE-006-SD4	XAE (Two Tone TNBK)	GBB	Nylon Fiber	Aluminum	184.5	670	85.5	6.03	24

- The specifications listed above are for reference ONLY and may be subject to change base on any condition.
- Consumables and auxiliary goods such as battery, charger, or BB pellets are not included.
- For AEG above 360 FPS, it is available to use 11.1V Li-Po or 9.6V Ni-Mh batteries;
AEG below 350 FPS and using Turbo 2000, Turbo 3000, EVO 35000 motor is recommended to use only 7.4V Li-Po or 8.4V Ni-Mh batteries. (EVO 25000 Motor is NOT included)
- For SSS product, it is recommended to use 11.1V Li-Po or 7.4V Li-Po batteries Only.
- For GBB product, it is recommended to use 12KG Green Gas.
- Muzzle velocity is measured with 0.20g BB pellet and is adjusted to comply with market regulation /requirements for specific countries as shown below:
Below 106 m/s (350 FPS): Belgium, France, Netherlands, Portugal, Spain, UK
Below 100 m/s (328 FPS): Italy
Below 95 m/s (312 FPS): Japan
Below 45 m/s (148 FPS): Korea

FIND ICS



Global website:
<https://www.icsbb.com>



Youtube:
ICS AIRSOFT

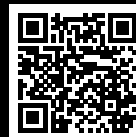

Instagram:
icsbbairsoft



Facebook (Global):
ICSBBAirsoft



Facebook (Taiwan):
ICSairsoft.tw



Facebook (Japan):
ICSairsoft.jp



Twitter (Global):
icsbbairsoft



Twitter (Japan):
ICSairsoft_JP



Weibo:
ICS_airsoftbb

ICS ONLINE STORE



オプションパーツや純正部品を購入することは可能
※登録していない部品をご購入希望の方はicsjapan@icsbb.com
にご連絡ください。

ICON GUIDE

	CO2 System		8 mm Bushing Box		40 mm Grenade		KEYMOD Handguard		Ambidextrous Fire Selector
	AEG System		7 mm Bushing Box		ICS Split Gearbox		M-LOK Handguard		Luminous Aiming Dot
	GBB System		Quick Detach Spring		ICS Ver.3 Gearbox		Nylon Fiber Receiver		Double Safety Function
	EBB System		L85 QD Spring Guide		ICS M3 Gearbox		Metal Receiver		Ambidextrous Magazine Catch
	MOSFET		6 mm BB Pellet		ICS M1 Gearbox		Wood Receiver		Ambidextrous Slide Catch
	Smart Trigger		8 mm BB Pellet		ICS L85 Gearbox		H-UP Adjustable		Tactical Rail
	SSS E-trigger		SSS.II E-trigger		SSS.III E-trigger		Short-stroke Trigger		V3 BOX QD Spring Guide
	R-HOP		NBB System						

REVO SERIES



PHOTO CREDIT & SPECIAL THANKS

cover	020 magazine
P19	WMASG.com
P23	Champion Clément(Isoft)
P49	Alpha Photography / Fehim Prosic
P53	Murmrmedia
P63	Murmrmedia
P73	Teddy Ameen(inzzen) Victor Karlund
P77	Champion Clément(Isoft)
P81	WMASG.com
P83	Björn Klockar
P93	Elvio Lupi
P95	WMASG.com
P99	Brendon Terry
P107	Asgc Airsoft Gun Center Natthaphum S Phokhin NSP Hobby Thailand
P113	Teddy Ameen(inzzen) Victor Karlund
P115	Teddy Ameen(inzzen) Victor Karlund
P122	WMASG.com

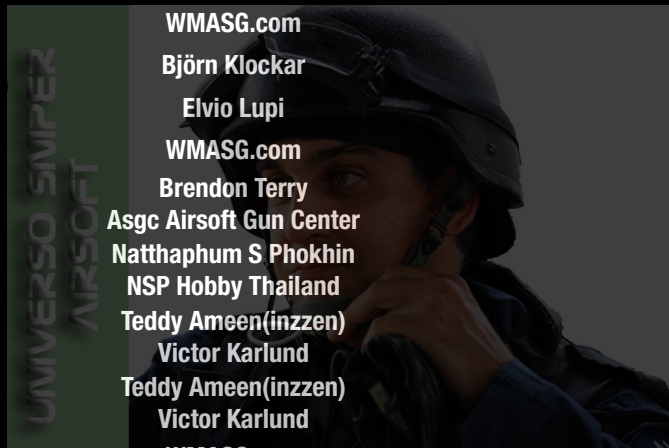



 **I CHIH SHIVAN ENTERPRISE CO., LTD**
WEB: www.icsbb.com / MAIL: info@icsbb.com / TEL: +886-4-25256461
No.67, Ln.79, Dongzhou Rd., Shengang Dist.,
Taichung City, 429, Taiwan