



www.acetk.com

2. Flame Mode Button: Click the button for once to switch to the next mode. There are 11 modes in total, and loops in the following sequence: RED > ORANGE > YELLOW > GREEN > BLUE > PINK > PURPLE > RGB > RAINBOW > DYNAMIC RAINBOW > Demo > Turn off

Mode	Function and LED status. (Yellow colored flame/beam is the default)	Remarks
RED/ ORANGE/ YELLOW/ GREEN/ BLUE/ PINK/ PURPLE	Red/ Orange/ Yellow/ Green/ Blue/ Pink/ Purple Beam and Flame The flame LED flashes the color of the mode switched to.	1. The switched colored flame effect comes with GBB and Gel Blaster shots. 2. With standard BBs on AEG, flame LED renders the flame with the switched color and emblaze the track into a beam. Note 1
RGB	RGB Beam / Flame The flame LED flashes R/G/B for once.	1. RGB Flame effect comes with GBB and Gel Blaster shots 2. With standard BBs on AEG, flame LED renders the flame with the RGB colors and emblaze the track into a RGB colored beam. Note 1
RAINBOW	Rainbow Beam / Flame The flame LED flashes white for twice.	1. The gas or the fog of Gel laster or GBB creates special optical mixing flame. 2. With standard BBs on AEG, flame LED renders the flame with the rainbow-colors and emblaze the BBs track into a rainbow-colored beam. Note 1
DYNAMIC RAINBOW	The flame LED flashes white for three times.	1. Bifrost changes the flame color for once in every 0.5 second during shooting. When the shooting is paused, the flame color settings stay at the last changed color until the next shot. 2. The track turns to be a dynamic rainbow-color beam when the BB is a standard white BB. Note 1
Demo	The flame LED flashes white for four times.	Each flame mode is activated for 5 shots and DYNAMIC RAINBOW mode is on for one round.
Turn off	Turn off flame functions. The power indicator flashes green for three times or keeps blinking.	Press the Flame mode button again and go back to RED flame mode. Note 2

Note 1: When tracer mode is on and using tracer BBs, the flame color will be blended by fluorescence.

Note 2: When both tracer and flame function are turned off, the power indicator flashes green fast to remind the user about the status.

### 3. Power Indicator

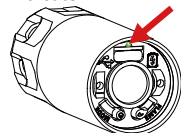

- Red: 0% ~ 30%
- Orange: 30% ~ 60%
- Green: 80% ~ 99%

### 4. RGB Flame LED



### Charging the Battery

1. Unscrew the muzzle cap and use Type C cable to recharge. Charge at least 3 hours for the first time to ensure best performance of the battery.

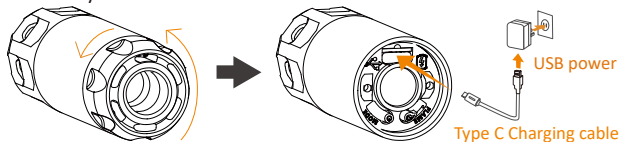

2. Indicator breaths during charging, and goes off when charging is completed. Breathing light reflects progress of charging:

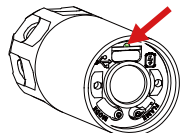

- Red: 0% ~ 30%
- Orange: 30% ~ 60%
- Green: 80% ~ 99%

3. Remove the charging cable and tighten the lid back by rotating clockwise, Bifrost turns on automatically.

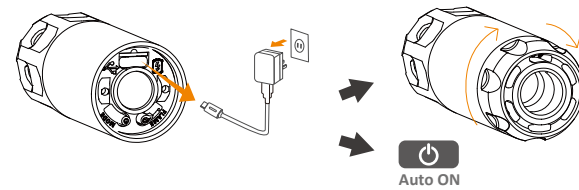

### Intelligent power control

1. Bifrost enter sleep mode while idle for over 5 minutes and awake by shaking.

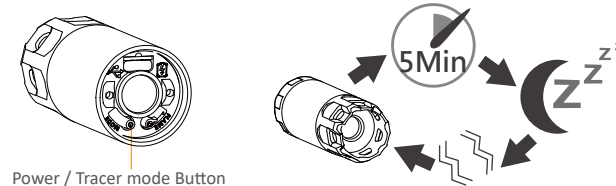

2. Low Battery Force Power off: the indicator LED flashes red, 3 flashes from the flame LED to indicate the battery level is too low and shutdown.

### Product illustration

- Make sure the barrel length after the screw thread is less than 10mm, or the barrel will cover the sensor of Blaster Module and cause malfunction, in this case, there is warning of 3 flame LED flash in every 2 seconds, and Bifrost will be forced shut down after 3 consecutive times of warning. (Figure 1)
- Use the Allen key to tighten the adaptor when attach Bifrost for airsoft gun with M11 CW barrel. (Figure 2)

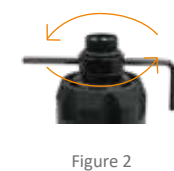
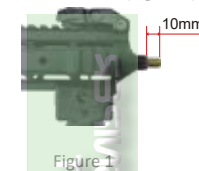

### Self-Test Mode

- Please recharge for at least 1 hour before doing self-test for Blaster Module. Self-Test cannot be activated when power is lower than 50%.
- In shutdown status, press power button for 6 seconds then release, the UV LED and Flame RGB flash LED will take turn flashing, Bifrost enters self-test mode, and indicates the result by the indicator.  
Normal: Indicator turns green.  
Fail: Indicator turns red.
- In the case indicator turns red, clean the inner tube and test again

### Specification

- ✘ Supports standard BBs, green tracer BBs and Gel BBs, does not supporting red tracer BB (White BBs works best.)
- ✘ Burst Speed: Up to 35PRS
- ✘ Battery: Li-Ion, charging time 2.5 hours
- ✘ Maximum shots with fully charged battery:

Mode	Light times
Tracer only	24000
Tracer with flame	12000
Flame only	12000

- ✘ LED power and battery indicator.
- ✘ Certificates: FCC CE ROHS
- ✘ Dimension: Diameter 30mm, length 81mm.
- ✘ Weight: 61g (excluding adaptor)

### Warranty

- Warranty: 12month from order date or 15 month from manufacture date.
- Warranty does not include damage from incorrect usage, external force, or liquid intruding inside the product
- Only the emblazing tube has water-resistance, any incorrect usage caused liquid intruding inside will be not covered by the warranty

\*All the specifications and contents in this manual are subject to change without notice.  
\*All the specifications and contents are only for reference, please make the object as the standard.

### Safety and Precautions

- To avoid the risk of high voltage circuit electrical shock, do not disassemble Blaster Module.
- Do not look into the gun barrel to avoid accidental discharge of BB gun which can lead to bodily harm or disability.
- Charge the battery at least every 2 months when the tracer is not used to avoid completely discharging the battery. Defect of completely discharging the battery is not covered by warranty.
- Only the BBs emblazing tube is waterproof.
- Supports standard BBs, green tracer BBs and Gel BBs, does not supporting red tracer BB (White BBs works best.)

### Contents



### Features

- Bifrost simulates muzzle flash, with Multi-color flame effect. The effect of flame depends on volume of gas or fog around the muzzle, more volume makes better effect.
- Bifrost provides colored BBs track function which can be achieved by standard BBs with the built-in RGB Flame LED.
- Two tracer modes available - Standard/Sniper.
- 11 different modes available for Multi-color flame function.
- Intelligent power control: Blaster Module power on by shaking, enter sleep mode while idle for over 5 minutes.
- Suitable for standard airsoft and gel BBs.

### Instructions

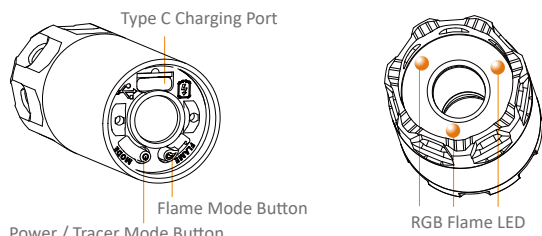

1. Power / Tracer Mode Button:
- Click the button for power-on / power-off
  - Long-press on power button while power on to adjust the Tracer modes.

Power Indicator	Functions (Default settings: Standard Tracer Mode) Automatically recall last settings.
Flash green for once	Standard Tracer Mode - each shot of tracer BBs gets emblazed
Flash green for twice	Sniper Tracer Mode - one tracer BB gets emblazed with every 3 shots. Flame function turns inactivated in this mode. Note 1
Flash green for three times or keep flashing	Turn off tracer function. Note 2

Note 1: Note 1: In Sniper Tracer Mode, the flame effect turns inactivated to avoid getting sniper exposed.

Note 2: When both tracer and flame function are turned off, the power indicator flashes green fast to remind the user about the status.