



Disclaimer

** With the continuous improvement of the product, Acetech reserves the right to make any technical and design changes to the product without prior, and the right of interpretation belongs to Acetech

* All the specifications and contents are only for reference only, the actual items shall depend on the product package you obtain



www.acetech.com

Safety and Precautions

1. To avoid the risk of high voltage circuit electrical shock, do not disassemble Blaster Module.
2. Do not look into the gun barrel to avoid accidental discharge of BB gun which can lead to any bodily harm or disability.
3. Charge the battery at least every 2 months when the tracer is not used to avoid completely discharging the battery. Defect of completely discharging the battery is not covered by warranty.
4. Supports green tracer BBs and gel BBs, DO NOT support red tracer BBs

Contents



Features

1. Blaster Module simulates muzzle flash, the effect of flame depends on volume of gas or water fog around the muzzle, with more volume, effect will be better.
2. Three modes available: Tracer with flame, Flame only, Tracer only.
3. Intelligent power control: Predator MKIII by shaking, enter sleep mode while idle for over 5 minutes.
4. Suitable for standard airsoft and gel blasters.

Blaster M Instructions

Charging the Battery

1. Rotate the lid counter clock wise to remove, use Micro USB cable to recharge. Charge at least 3 hours for the first time use to ensure best performance of the battery.

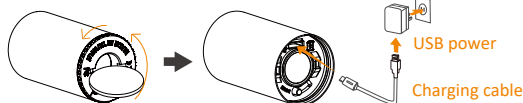

2. Indicator breaths during charging, and goes off when charging is completed. Breathing light reflects progress of charging:



3. Remove the charging cable and put the lid back by rotating clockwise, Blaster Module will turn on automatically. Insert Blaster Module into Predator MKIII and start using the tracer.

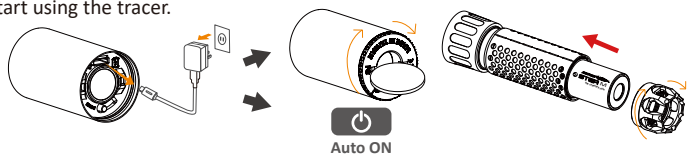

Power on and off

1. Power On: Click power button, a short Beep (1sec.) indicates the power is on, or just shake Blaster Module to wake it up from sleeping mode.

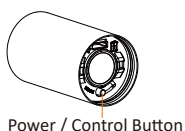

2. Power Off: Click power button, after three short Beeps, Blaster Module turns off, at this mode, shake and wake function will not be available.

3. Sleep Mode: Blaster Module enters sleep mode automatically when idle for over 5 minutes, and return to standby mode when there is vibration.

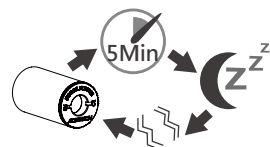

4. Low Battery Force Power off: the indicator LED flashes red, 3 flashes from the flame LED to indicate the battery level is too low and shutdown.

Installation

1. Blaster Module at a Glance

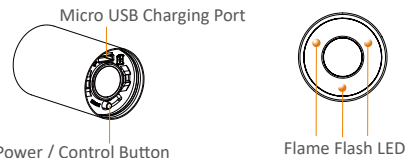

2. Make sure the installation direction of Blaster Module is correct inside the silencer, to ensure Blaster Module works properly.

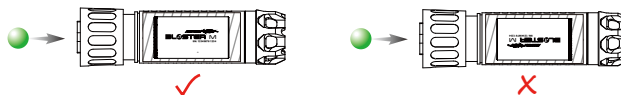

Self-Test Mode

1. Please recharge at least 1 Hour before doing self-test for Blaster Module.
2. From power off status, press power button for 6 seconds then release, the UV LED and Flame flash LED will take turn flashing, Blaster Module enters self-test mode, and indicates the result by the indicator.
Normal: Indicator turns green.
Fail: Indicator turns red.
3. In the case of self-test failure, please clean the inner tube and test again.

Mode Setting

1. Long press on control button while power on to enter mode setting.



Warning: Power button is micro-electric part, too much force pressing may cause damage to the button

LED Signal and Audio Signal

LED and Beeps	Symbol	Status
1 second beep, green light	●	Power On
Indicator LED in red and flame LED flashing 3 times	x 3	Low battery, enters sleep mode automatically
Red light flash, 5 short beeps		Battery 0%~30% charged
Orange breathing light		Battery 30%~60% charged
Green breathing light		Battery 80%~99% charged
LED turn off after Green breathing light		Charging complete
From power of, press power button for 6 seconds then release, Flame LED flashing 3 times	● x 3	Enters self-test mode
After self-test, green light, 1 second beep	1sec	Self-test success
After self-test, red light, 3 short beeps		Self-test fail

Specification

- ✗ Supports green tracer BBs and water BBs, do not support red tracer BBs.
- ✗ Burst Speed: Up to 35PRS
- ✗ Battery: Li-Ion, charging time 2.5 hours
- ✗ Maximum shots with fully charged battery:

Mode	Shots
Tracer only	24000
Tracer with flame	12000
Flame only	12000

- ✗ Power and battery indication by LED.
- ✗ Certificates: FCC CE ROHS
- ✗

	Diameter	length	Weight
Predator MKIII	42mm	139.3mm	255g
Blaster M	30mm	54mm	31g

Warranty

1. Warranty: 12month from order date or 15 month from manufacture date.
2. Warranty does not cover include damage from incorrect usage, external force, or liquid intruding inside the product
3. Only with lid tightened, Blaster is with IP64 rating, any incorrect usage caused liquid intruding inside will be not covered by the warranty.