

CZ P-09 Airsoft incl. case - 17657

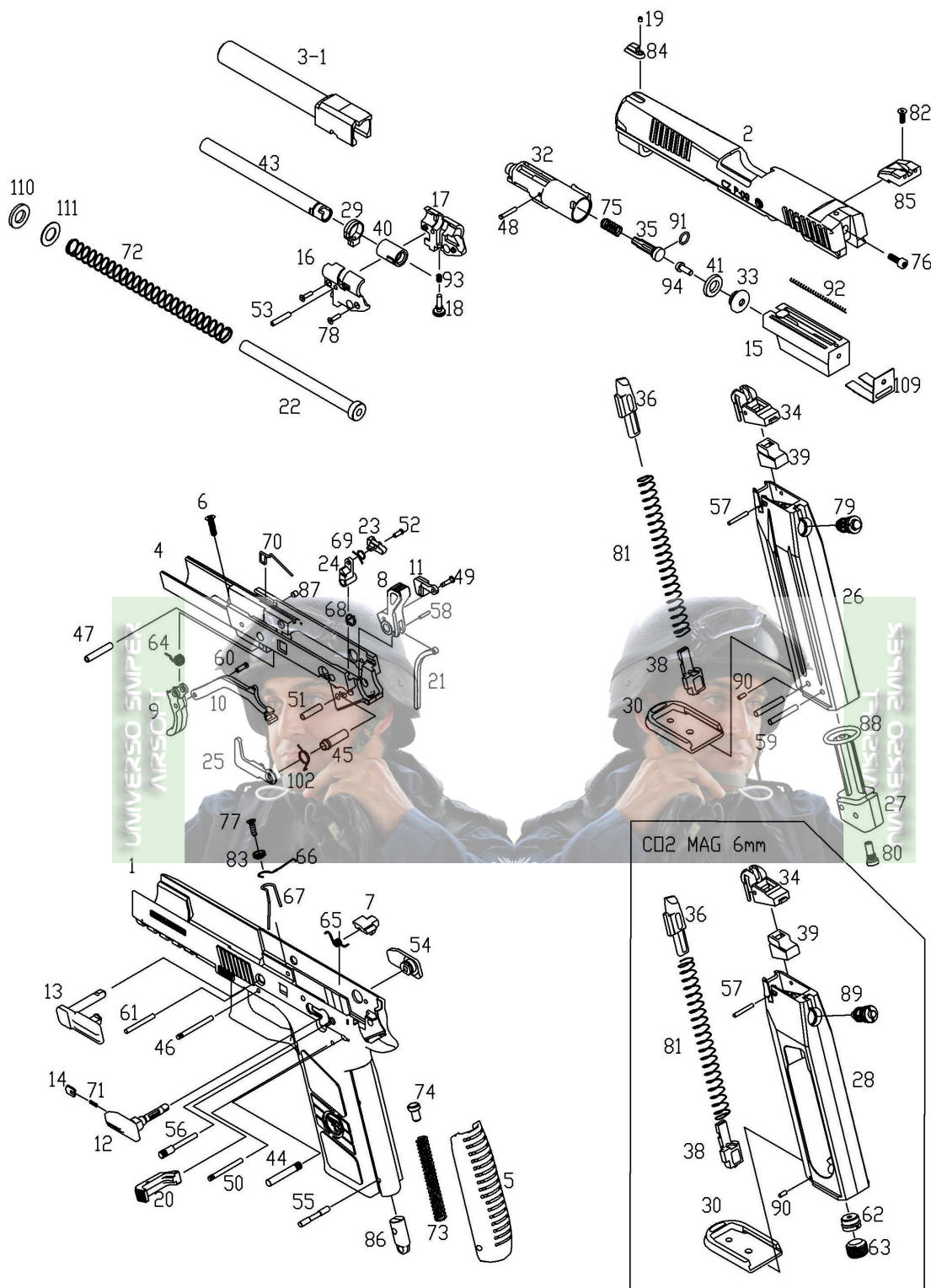

NO.	NAME	NO.	NAME
1	FRAME	54	SAFETY RIGHT
2	SLIDE	55	MAIN SP HOUSING PIN
3-1	OUT BARREL	56	SEAR PIN
4	INNER FRAME	57	MAG LIP PIN
5	BACK STRAP	58	MAIN SP STRUT PIN
6	INNER FRAME SCREW	59	MAG BOTTOM PIN
7	SEAR	60	TRIGGER BAR PIN
8	HAMMER	61	INNER FRAME PIN
9	TRIGGER	62	MAG STAB (CO2)
10	TRIGGER BAR	63	MAG BASE NUT (CO2)
11	DISCONNECTOR	64	TRIGGER SP
12	SAFETY LEFT	65	SEAR SP
13	SLIDE STOP	66	TRIGGER BAR SP
14	SAFETY DETENT PLUNGER	67	MAG CATCH SP
15	PISTON BLOCK	68	VALVE KNOCKER SP
16	BARREL CHAMBER (L)	69	VALVE LOCK SP
17	BARREL CHAMBER (R)	70	SLIDE STOP SP
18	TRAJECTORY ADJUST SCREW	71	SAFETY SP
19	FRONT SIGHT SCREW	72	RECOIL SP
20	MAGAZINE CATCH	73	MAIN SP
21	MAIN SP STRUT	74	MAIN SP CAP
22	RECOIL SP GUIDE	75	FLOATING VALVE
23	VALVE HAMMER	76	PISTON BLOCK SCREW
24	VALVE KNOCKER	77	MAG CATCH SP SCREW
25	VALVE LOCK PLATE	78	BARREL CHAMBER SCREW
26	MAG BODY (GAS)	79	EX VALVE
27	MAG BASE (GAS)	80	FILLING VALVE
28	MAG BODY (CO2)	81	FOLLOWER SP
29	TRAJECTORY ADJUST RING	82	REAR SIGHT SCREW
30	MAGAZINE BOTTOM	83	MAG CATCH SP WASHER
32	CYLINDER	84	FRONT SIGHT
33	PISTON	85	REAR SIGHT
34	MAG LIP	86	MAIN SP PLUG
35	FLOATING VALVE	87	SLIDE STOP SP SCREW
36	MAG FOLLOWER	88	MAG BOTTOM O-RING
38	MAG BOTTOM STOP (CO2)	89	CO2 EX VALVE
39	MAG GASKET	90	CO2 MAG BOTTOM STOP SCREW
40	RUBBER CHAMBER	91	FLOATING VALVE O-RING
41	PISTON RING	92	CYLINDER SP
43	INNER BARREL	93	TRAJECTORY ADJUST SCREW
44	HAMMER PIN	94	PISTON SCREW
45	HAMMER SLEEVE	102	VALVE LOCK SP
46	TRIGGER PIN	109	PISTON BLOCK PLATE
47	TRIGGER SLEEVE	110	RECOIL BUFFER
48	FLOATING VALVE PIN	111	RECOIL BUFFER WASHER
49	DISCONNECTOR PIN		
50	VALVE KNOCKER PIN		
51	VALVE KNOCKER SLEEVE		
52	VALVE HAMMER PIN		
53	BARREL LOCKING PIN		