

APS LTD
GUN SPECIALIST 1993

www.aps-concept.com

HANDLING & INSTRUCTION MANUAL (For All PR Model Use) ASR SERIES ELECTRIC BLOW BACK GUN



HOT UP SYSTEM

WARNING This gun is not intended for unsupervised use by any persons under the age of 18 years. Always read the instructions carefully before operation.

2 LAYOUT STRUCTURE

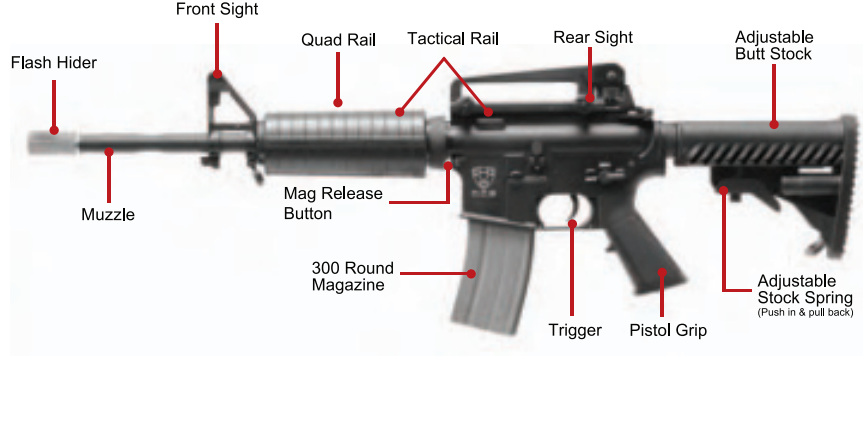

3 SPECIFICATION

	Barrel Caliber	Barrel Capacity	Pellet	Initial Pellet Speed
PR301	6.08mm	300	6mm BB	105-130m/s
PR302	6.08mm	300	6mm BB	
PR303	6.08mm	300	6mm BB	
PR304	6.08mm	300	6mm BB	
PR305	6.08mm	300	6mm BB	

17 TROUBLESHOOTING GUIDE

Status	Cause	Action
No operation at all	Fire selector is set to SAFE Battery is not charged Battery connector is disconnected or reversed Fuse is blown Floor motor electrical connection Expired motor life	Set the fire selector to semi or full-auto Fully charge the battery Reconnect the connector correctly Replace the fuse Check and repair the motor Replace a new motor
Although the motor is running, no BB's fire	Magazine is not fully placed into the receiver Bullets are clogged in Hop up system or barrel Faulty gear Levers may be broken	Load the magazine into receiver and turn the gear wheel. If it still doesn't work, contact customer service and ask for assistance. Use the cleaning rod to remove clogged BB's Please contact customer service and ask for assistance
Full-auto not functioning	Insufficient battery power Faulty BB's feed from magazine	Charge the battery Using the cleaning rod to remove clogged BB's
Semi-auto not functioning	Deviation in gear timing Insufficient battery power Faulty BB's feed from magazine	Fix 5-6 rounds in full auto then switch back to semi auto again Change the battery Use the cleaning rod to remove clogged BB's
BB's roll out from barrel	Faulty or poor quality of BB Hop up or barrel damaged Faulty or poor quality of BB	Please contact customer service and ask for assistance Use higher quality BB
Shooting distance greatly reduced	Hop-up or barrel damaged Piston or O-ring of BB Deteriorated piston spring Gear problem caused by excessive dry Faulty BB's	Please contact customer service and ask for assistance
Loud operation noise	Damaged Gears Problem caused by engagement between the motor and gears	Please contact customer service and ask for assistance Do not turn the engagement between the motor and gears by yourself, contact customer service and ask for assistance
Gun has been immersed by water	Stop Operation immediately and disconnect the battery. Wipe off any excess water from inside the body and from the battery. Allow it to completely dry. If there is no operation or signs of malfunction is asserted, please contact customer service and ask for assistance.	

16 FLIP UP SIGHT (FRONT)

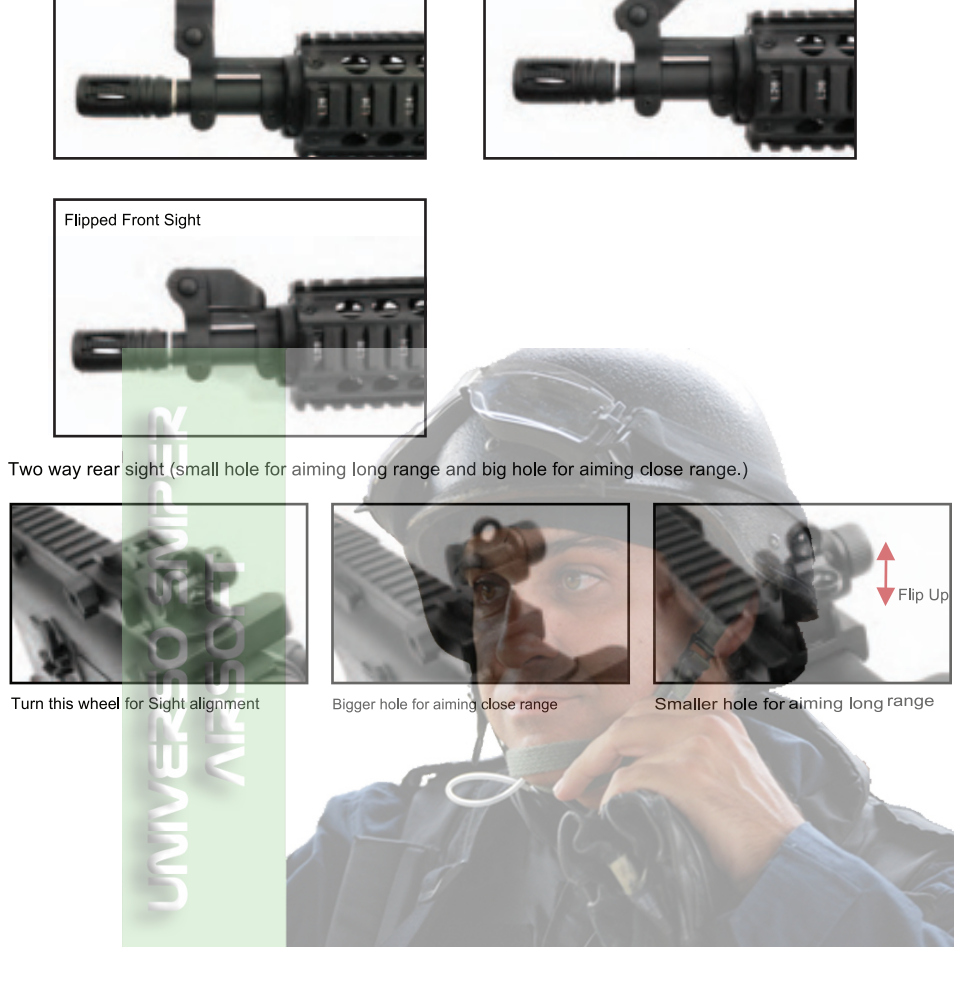

4 FIRING OPERATION

WARNING Keep the airsoft gun in the "SAFE" position until you are actually ready to shoot. Then turn the safety to the other two positions.

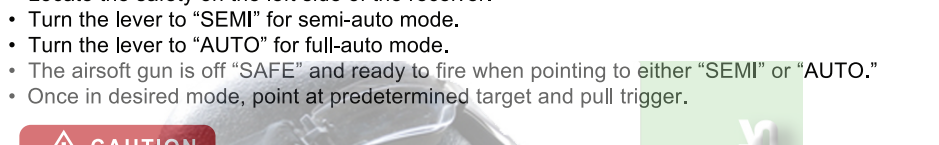

Selecting Firing Mode

- Locate the safety on the left side of the receiver.
- Turn the lever to "SEMI" for semi-auto mode.
- Turn the lever to "AUTO" for full-auto mode.
- The airsoft gun is off "SAFE" and ready to fire when pointing to either "SEMI" or "AUTO".
- Once in desired mode, point at predetermined target and pull trigger.

CAUTION

- Confirm your firing area is safe before firing.
- There are possibilities that no BB comes out after pulling the trigger. This may happen when new magazine is inserted. Switch to Full Auto and fire 5-10 rounds will solve this problem.
- Change the battery if the firing cycle becomes slow.
- Give the Airsoft Gun a rest of 5-10 minutes after firing 200 rounds in order to ensure long service life of the motor and battery.
- If bullets are clogged, stop firing and remove the clogged bullets immediately.
- Service up. Avoid Optimal silicon oil use only regular use.
- Hop up may be unstable for first 200-300 rounds after silicon oil is used. This is normal operation of the gun.

5 FUSE DEVICE

- Maximum voltage should be 15V and Amperes is 20A value. Fuse is required to protect against the motor not over heat.
- During installation, make sure the electrical conductor is insulated.
- Replacing the fuse device in a ventilated area and avoid direct contact with human body.
- If there is a bad connection between the pushbars, for example being in the shell, stop pressing the trigger and cut off the power immediately. Check the fuse and fix the gear box before using again to avoid damage of the electronic component.



6 INSTALL BATTERY

This airsoft gun will not function properly without a fully charged battery. Charge the battery 6 hours prior to initial use. Do not overcharge the battery. Unplug the battery charger when not in use.

WARNING Changes or modifications to this unit not expressly approved by the party responsible for compliance could void the user's authority to operate the equipment.

NOTE: This equipment has been tested and found to comply with the limits for a Class B digital device, pursuant to Part 15 of the FCC Rules. These limits are designed to provide reasonable protection against harmful interference in a residential installation. This equipment generates, uses and can radiate radio frequency energy and, if not installed and used in accordance with the instructions, may cause harmful interference to radio communications. However, there is no guarantee that interference will not occur in a particular installation. If this equipment does cause harmful interference to radio or television reception, which can be determined by turning the equipment off and on, the user is encouraged to try to correct the interference by one or more of the following measures:

- Reorient or relocate the receiving antenna.
- Increase the separation between the equipment and receiver.
- Connect the equipment into an outlet on a circuit different from that to which the receiver is connected.
- Consult the dealer or an experienced radio/TV technician for help.

CAUTION Use caution when handling and using the battery or charger to prevent the risk of electric shock.

To prolong battery life and maintain the best shooting performance rest the gun for 10 minutes after shooting. For optimum performance completely use up the battery before recharging. **DO NOT OVERCHARGE THE BATTERY. UNPLUG THE BATTERY CHARGER WHEN NOT IN USE.**



Loading the Battery

- Make sure the airsoft gun is in "SAFE" (see section 8), UNLOADED, and pointed in a SAFE DIRECTION.
- Slide the delta ring back and remove the bottom of the quad rail.
- Insert the battery in the quad rail as shown and connect the battery to the gun.
- Make sure the connector in the space around the barrel.
- Place the front end of the quad rail back into position, being sure to hold the battery in place.
- Slide the delta ring back and lock the delta ring into position.

14 RHINO SIGHT

Two way rear sight (small hole for aiming long range and big hole for aiming close range)

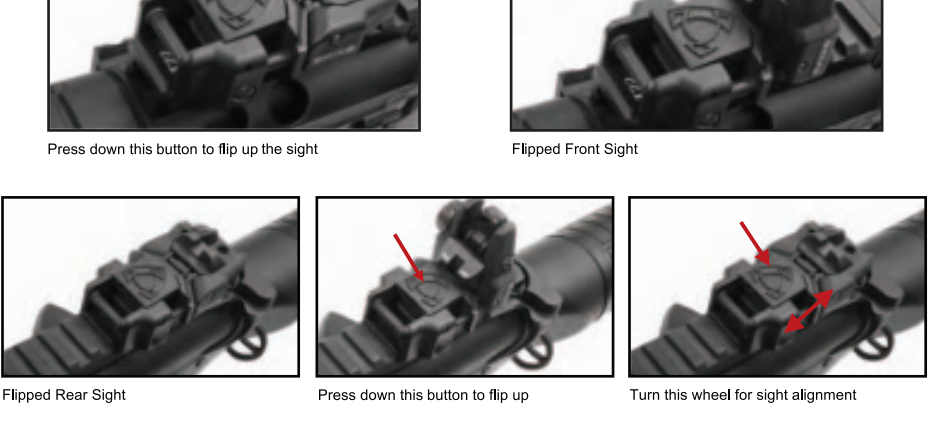

15 FLIP UP DINOSAURS SIGHT (FRONT)

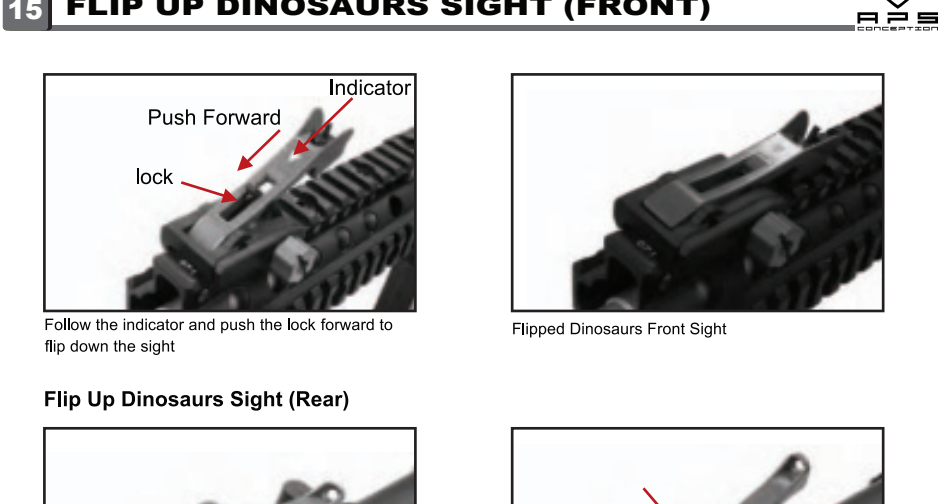

12 BASIC MAINTENANCE (REMOVING JAMS & BARREL CLEANING)

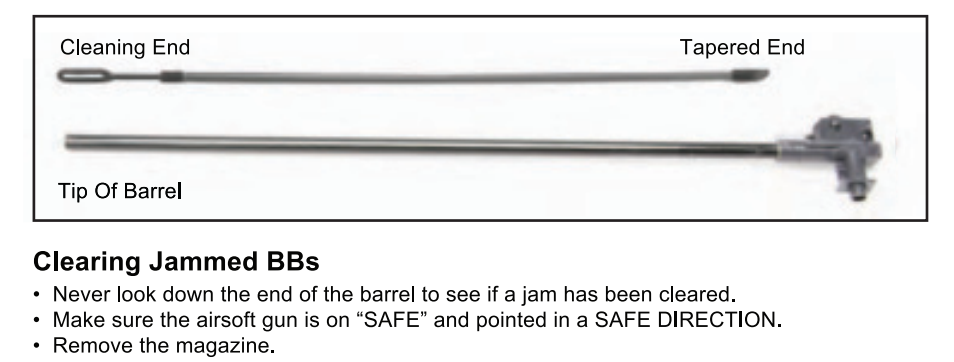

Cleaning Jammed BBs

- Never lock down the end of the barrel to see if a jam has been cleared.
- Make sure the airsoft gun is on "SAFE" and pointed in a SAFE DIRECTION.
- Remove the magazine.
- Make sure to return the hop-up wheel to the NORMAL position.
- Insert tapered end of the cleaning rod into the muzzle with the angle toward the breech (where the magazine connects).
- CAREFULLY and slowly apply increasing pressure until you push the BB out of the breech.
- Insert the magazine and test gun in a predetermined SAFE DIRECTION.

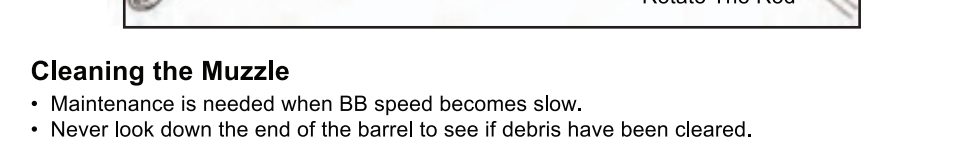

Cleaning the Muzzle

- Maintenance is needed when BB speed becomes slow.
- Never lock down the end of the barrel to see if debris has been cleared.
- Make sure the airsoft gun is on "SAFE" and pointed in a SAFE DIRECTION.
- Remove the magazine.
- Make sure to return the hop up wheel to the NORMAL position.
- Cut a strip of cotton cloth the width of the eyelet hole and rotate the cloth around the muzzle.
- Insert the cleaning side of the rod into the barrel of the gun while slowly twisting down the rod.

13 DISASSEMBLING THE GUN

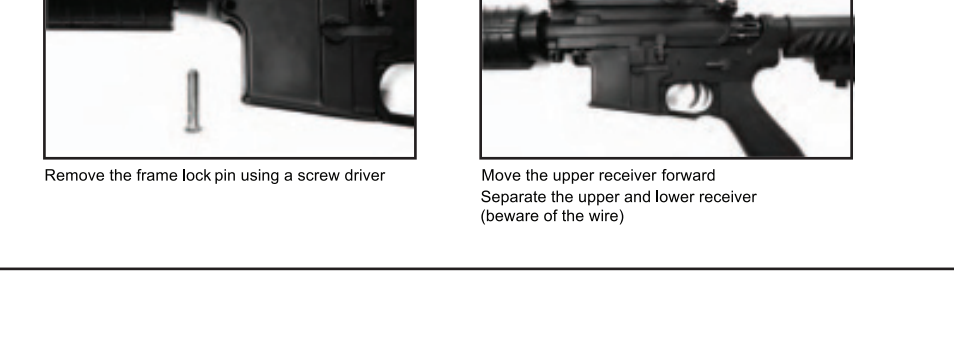

7 IRON SIGHT ADJUSTMENT (REAR)

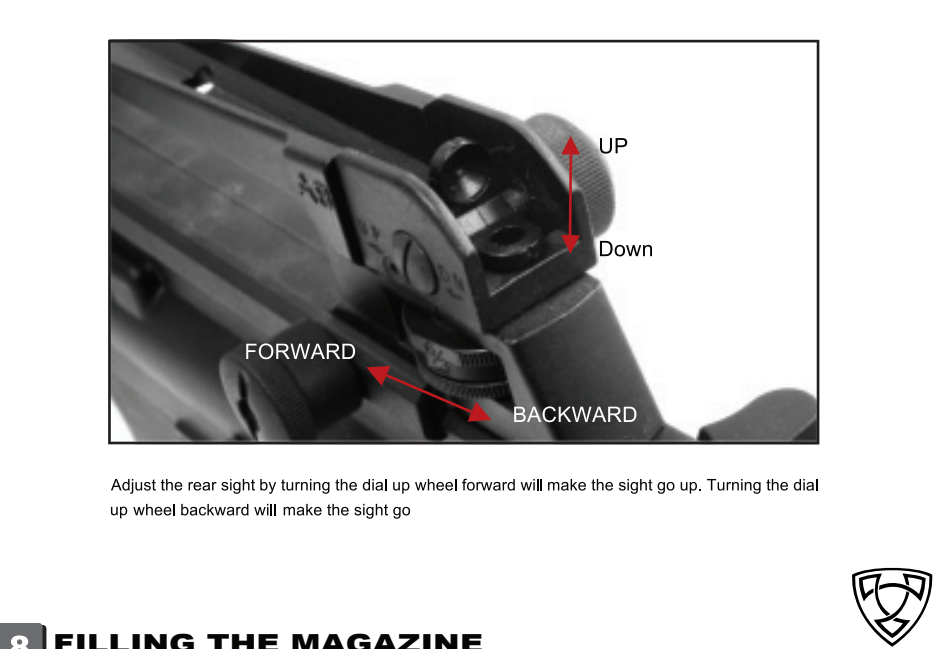

8 FILLING THE MAGAZINE

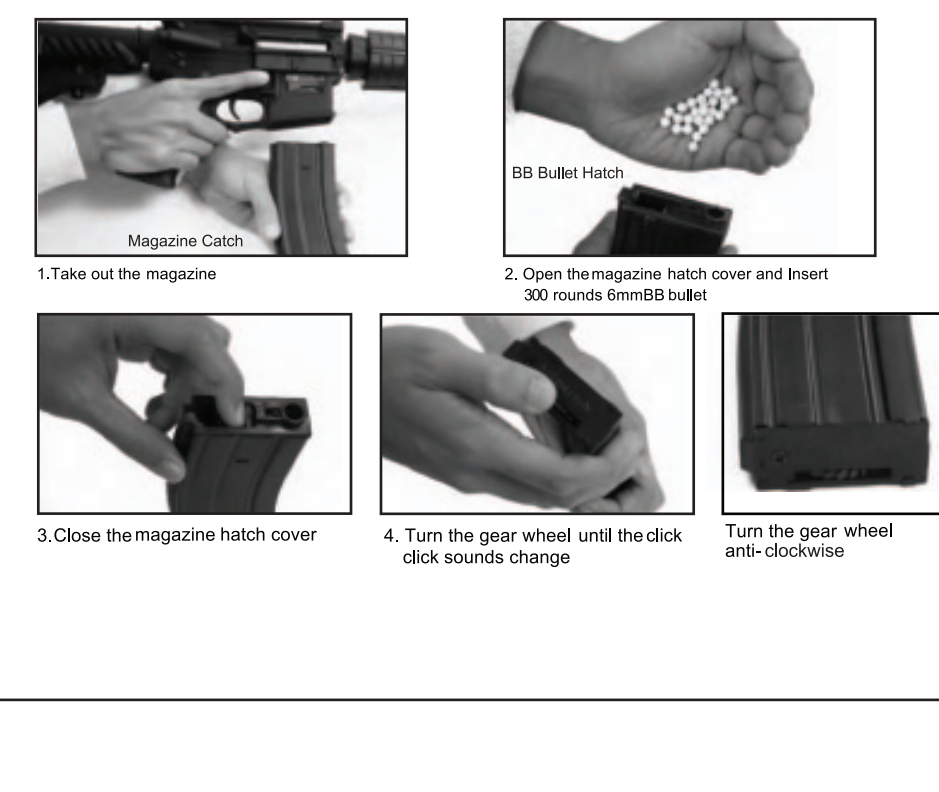

9 EXTEND THE BUTT STOCK



10 INSTALL BATTERY (CRANE STOCK)

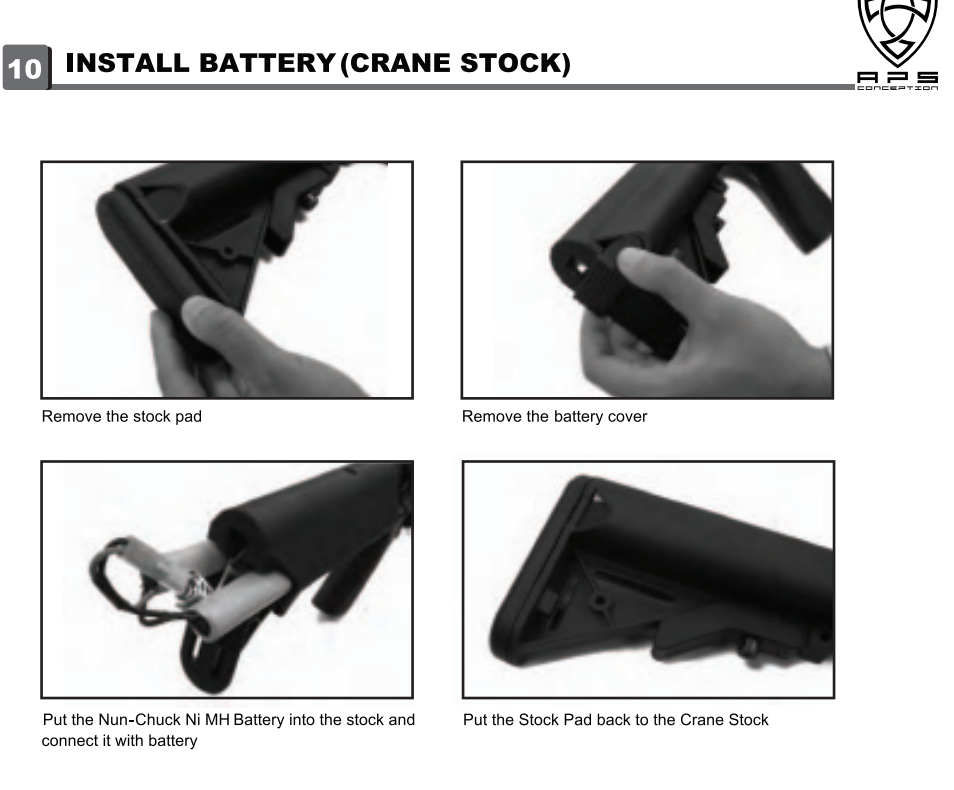

11 HOP UP ADJUSTMENTS

CAUTION

- The best position is where the BB's fly horizontally and the longest flying distance is obtained.
- Turning excessively adversely affects the trajectory. Stop turning the dial when BB's fly horizontally.
- Moving the lever to much towards HOP will cause bullets to clog. Firing the gun with clogged BB's will damage the piston and gears.
- If the hop-up is adjusted excessively and causing the BB's to clog, stop operating the gun immediately. Return the lever to NORMAL and remove the clogged BB's (see section 7).
- Black Ops™ will not be held responsible for any damages or accidents caused by incorrect operation, disassembly, or modification of the airsoft gun.

Using the Hop-Up Mode

- This airsoft gun is manufactured with an adjustable hop-up system.
- The purpose of this system is to change the spin on the BB as it leaves the muzzle, allowing you to adapt your shot for different distances.
- Pull out and hold the charging handle to open the ejection port cover.
- Turn the hop-up adjustment dial clockwise for more spin, counterclockwise for less spin.

