

CA[®]
CLASSIC ARMY

SLR105 A1

HANDLING CAUTIONS AND INSTRUCTION MANUAL

Arsenal

**HOP-UP
SYSTEM**

WARNING

- FOR AGE 18 OR ABOVE.
- PLEASE READ THE INSTRUCTIONS CAREFULLY BEFORE USE. MISUSE OR CARELESS USE MAY CAUSE SERIOUS INJURY.
- USER SHOULD OBEY TO THE LAWS REGARDING THE USAGE AND OWNERSHIP OF AIRSOFT ELECTRIC GUNS.
- FACIAL PROTECTION IS REQUIRED.

1 Outlook / Structure of SLR105 A1

Always set the selector switch to the safe position when you are not firing or during storage

SLR105 A1

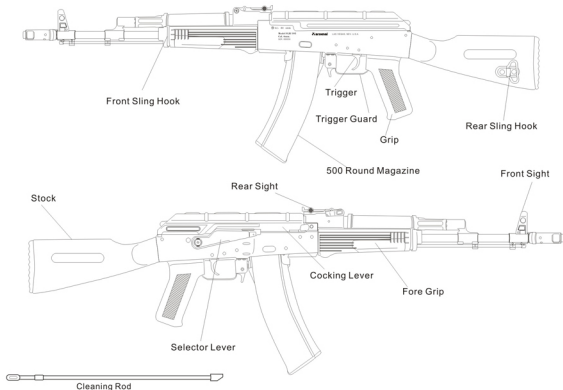

2 Specification

Data of Automatic Electric Gun

| | | |
|----------------------|-----------------|--|
| Name | SLR105 A1 |  |
| Weight | 2.684 kg | |
| Barrel Length | 463mm | |
| Barrel Caliber | 6.08mm | |
| Pellet Capacity | 500Rd | |
| Pellet | 6mmBB | |
| Initial Pellet Speed | 85 - 95 m/s | |
| Battery Type | Large Type 8.4v | |

3 Operation

1 How to insert battery

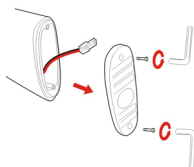

- 1 Remove the butt plate and pull out the connector. (Don't pull out the fuse box)



- 2 Insert the battery and connect the connectors.

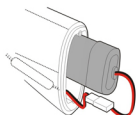

- 3 Press down the fuse box and insert connectors and cords between the fuse box and battery. Bend the cords in S shape.

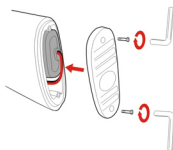

- 4 When the battery and cords are set in positions, reinstall the butt plate as shown.

2 Magazine Attachment / Detachment Procedure



There are BB pellets remain in the magazine hip and chamber. Please pay attention as BB pellets can't be discharged.

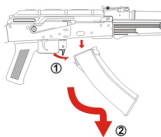

- 1 Press the magazine release lever to remove the magazine.

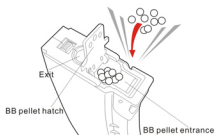

- 2 Open the top hatch and insert BB pellets. About 500 pellets may be loaded. (Avoid forcing BB pellets into the magazine.)



- 3 Close the hatch.



- 4 Hold the BB pellets entrance facing up and turn the gear at the bottom all the way until the click-click sounds change. (If only a small number of BB pellets are inserted, the gear merely makes blank turning.)



- 5 Check the BB pellets are lifted up to the exit, and then connect the magazine to the gun.



- 6 Always set the magazine upward. Align the groove shown by an arrow and press the rear of the magazine.

3 How to use safety lock

1 Safety Lock

2 Full Auto

3 Semi Auto

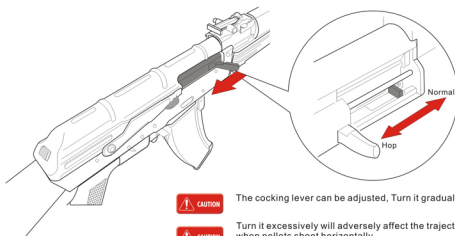
4 Hop up system adjustment

The cocking lever can be adjusted, Turn it gradually towards the hop.



Turn it excessively will adversely affect the trajectory. Stop turning it when pellets shoot horizontally.

5 Sight adjustment

Front Sight :

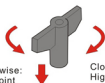
 Counterclockwise:
Lower sight point

 Clockwise:
Higher sight point

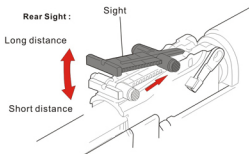

Insert the front sight adjustment tool in the front sight and turn it for adjustment.



Rear Sight :

Long distance

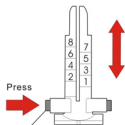
Short distance



Press

 Elevation (Up/Down)
adjustment button

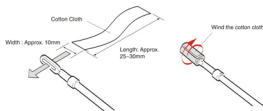
⑥ How to use a cleaning rod

Cut a cotton cloth to the size as shown above and insert one end into the hole in the rod.
(Adjust the length of cloth for smooth entry into the barrel.)

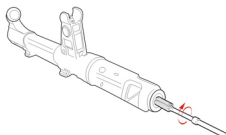

Hold the tip of the rod and insert it with turning motion.



CAUTION: Always begin the maintenance by returning the hop up adjustment lever to **NORMAL**.



CAUTION: The chamber is a precision component.
Never use any used BB pellets.

* The hop-up performance may become unstable for 60 to 70 pellets after maintenance.



CAUTION: Inserting the rod will be difficult if you hold the rod at the end.

- Spray silicone oil for 0.5 to 1 sec in the pellet entrance, then fire 40 to 50 pellets to make the magazine stable.
- Clean the oil from the chamber using the cleaning rod (with cotton) to complete the maintenance.

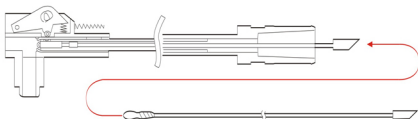

CAUTION: Always begin the maintenance by returning the hop up adjustment lever to **Normal**.

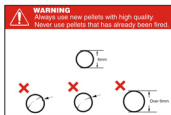
4 **WARNING**

In no event shall Classic Army or any of our partners be liable for any direct or indirect, special, incidental, or consequential damages in connection with the use of our products.

5 For complete product information, dealer locations and technical support, please visit the website of Classic Army Sole Distributors.

Italy, San Marino Republic, Città del Vaticano, Spain (includes Andorra and Gibraltar) Portugal and Switzerland

Co. Name: VI.SE.LE Italiana s.r.l.
 Add.: Via Walter Tobagi n.13, 20090 - Vimodrone (Milan), Italy
 Tel: (39) 02 274 09455
 Fax: (39) 02 274 09455
 Email: visele@classicarmyitalia.com
 Website: <http://www.classicarmyitalia.com/>

Denmark, Sweden, Norway & Finland, France, Germany, Austria, United Kingdom, Poland, Baltic countries, Belgium, Luxembourg, the Czech Republic and Slovakia

Co. Name: ActionSportGames A/S
 Add.: No.: Bakkegaardsvej 304, DK-3050 Humlebaek, Denmark
 Tel: (45) 89 28 18 88
 Fax: (45) 49 19 31 60
 Email: sales@softgun.dk
 Website: <http://www.actionsportgames.com/>

The United States of America

Co. Name: Spartan Imports, Inc.
 Email: info@spartanimports.com
 Website: <http://www.spartanimports.com/>

Taiwan

Co. Name: F-Link Int'l Enterprise Co. Ltd.
 Add.: No. 283, Jo Through 2nd Road, Sun Min Dist, Kaohsiung, Taiwan, R.O.C.
 Tel: (886) 7 323 0988
 Fax: (886) 7 323 4055
 Email: kssa.kssa@msa.hinet.net
 Website: <http://www.soloman.com.tw/>

6 Exploded Diagram

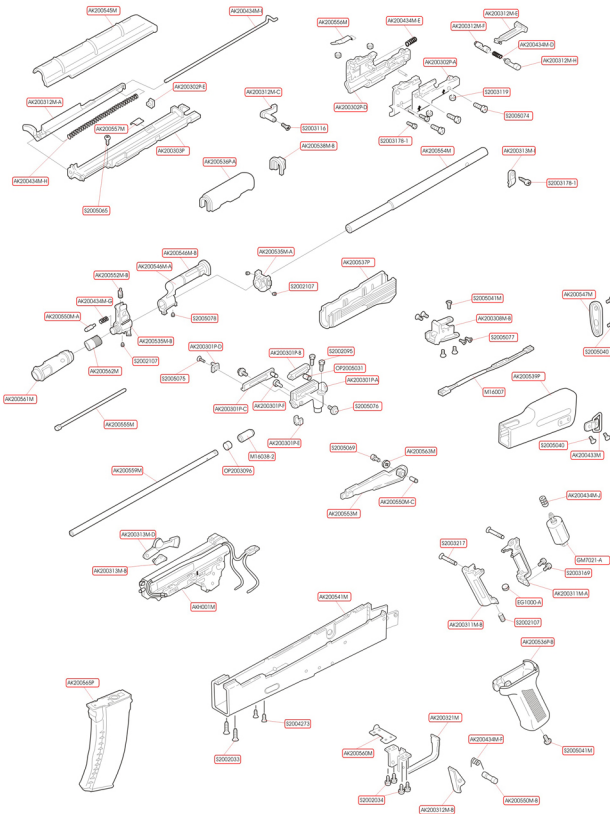



Website: www.classicarmy.com

E-mail: info@classicarmy.com



ARSENAL and the ARSENAL logo are registered trademarks of ARSENAL inc. U.S.A., Used under exclusive worldwide license for Air Soft Gun by ASG A/S, Denmark, www.actionsportgames.com