

INSTRUCTION MANUAL

FFR AEG SYSTEM 7"/9"/12"



WWW.GUAY2.COM
G&G ARMAMENT
AIRSOFT GUNS & ACCESSORIES



CAUTION

- This product is suggested for 18 year-old users or older.
- Wear goggles while shooting.
- Incorrect use may cause injury or death.
- Never point at humans and animals with the airsoft guns.
- Read the whole manual before using the replica.
- Buyers and users should comply with the laws and rules defined by the local authority.

FIRING MODE & SAFETY



Safety On
The gun will not fire



Semi Auto
Single shot



Full Auto
Automatic firing

CHARGING BATTERY



1. Charge up the battery.
2. Charging will be completed after 3 hours.



Pull out the butt plate from the upper part.



Take out the battery stop.



Connects the battery until connector clicks into place.



Insert the battery into stock.



Reinstall the battery cover and butt plate.

CAUTION

1. Use high quality battery with the CE approval to avoid any unnecessary damage on the product.
2. Use either 8.4V or 9.6V battery only, battery with voltage too high or too low might damage the product.
3. Remove the battery from the product when it is not in use.
4. Do not wet nor incinerate the battery, nor to deform the terminal.

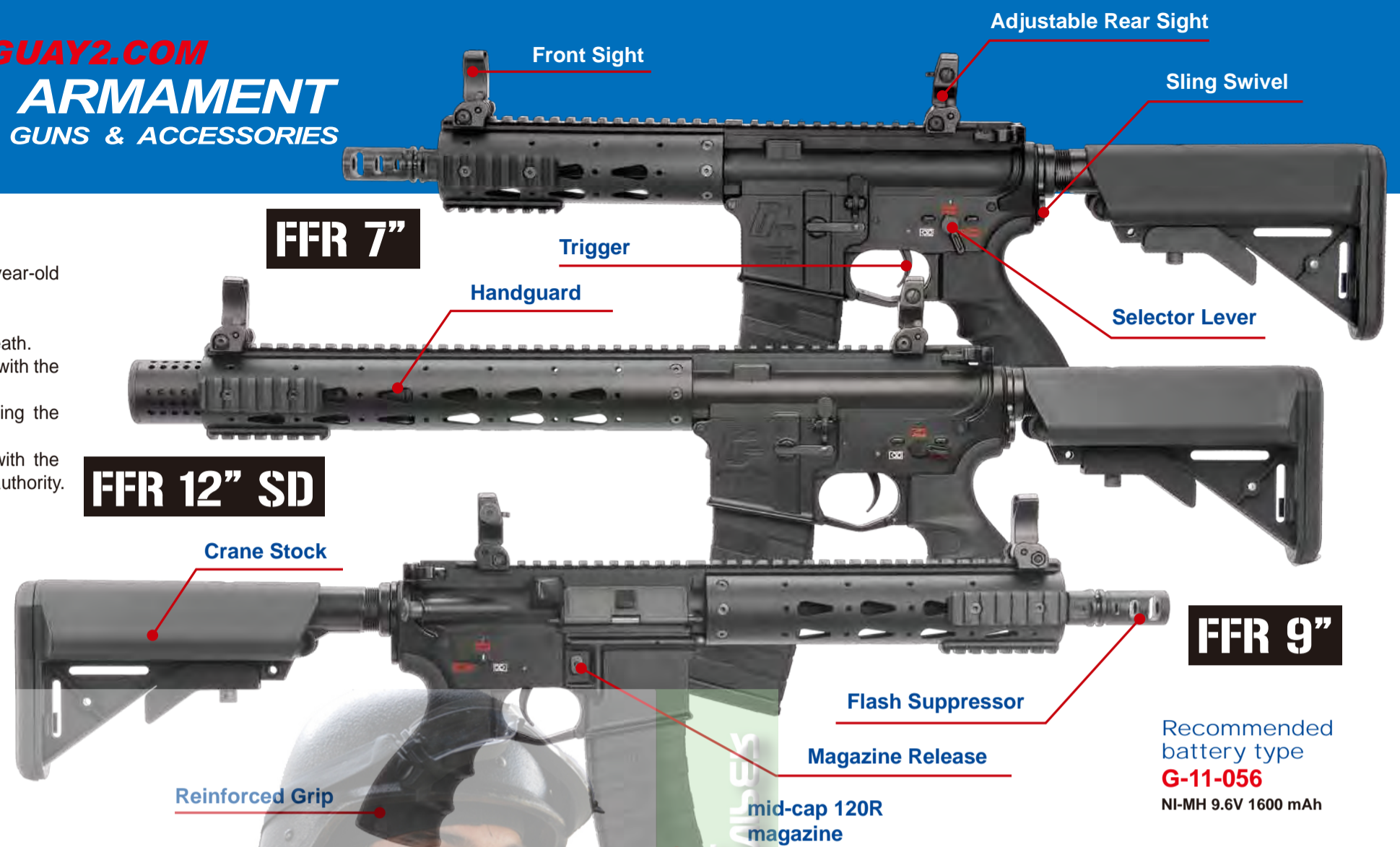

FFR 9"

Recommended battery type
G-11-056
NI-MH 9.6V 1600 mAh

LOADING MAGAZINE



CAUTION
It is strongly recommended the use of G&G BB pellets only. Using low quality BB pellets will shorten product life span and void product warranty.



1. Open the trap door on the top of the BB loader.
2. Load G&G 5.95mm BB pellets into the Magazine style BB Loader.
3. Connect magazine style loader with the 120R Magazine.
4. Slide the retainer to release the injection lever.
5. Press the injection lever to load BBs into the magazine. Continue loading until the magazine is full. Load G&G 5.95mm BB pellets into the magazine.



Close the cover plate then turn the gear until the sound changes.



Insert the magazine until you heard a click sound.

HOP-UP ADJUSTMENT

CAUTION

Do not catch your fingers in the dummy bolt. Never hold the gun sideways as the BB pellets will curve right or left.

❌ **Too much Hop-up.**
(Turn the adjustment lever toward **Normal** to correct the upward trajectory.)

❌ **Not enough Hop-up.**
(Turn the adjustment lever toward **Hop** to correct downward trajectory.)

Best Position.

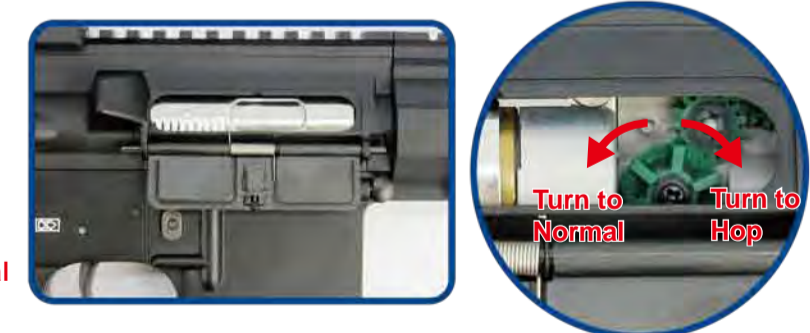

FFR 7"/9"/12" INSTRUCTION MANUAL



MAINTENANCE



Remove the magazine.



Return the hop up dial to normal position and insert the cleaning rod from the lead edge of the inner barrel.



Be aware to have the rod facing down and reaching to the end, and remove clogged pellets.

TROUBLE SHOOTING



Adjust screw when the gear noise becomes shrilly.

The screw at bottom of the grip. Please use the screwdriver to adjust.



No operation

Check the wire set contact with motor.



No operation

Check the battery and connector.

RETRACTABLE STOCK



Press the stock release lever to unlock.



Adjust the position (6 positions).

Charging Handle



Ambidextrous Charging Handle



Hold down the button to Pull the Charging Handle.

FRONT SIGHT ADJUSTMENT



Hold down the button to fold the rear sight and Front sight.



Turn the screw counterclockwise to take off the screw and remove the sight.

PARTS LIST

- FFR 01 Sling Swivel
- FFR 02 Rear Sight
- FFR 03 Flip-up Front Sight
- FFR 04 Charging Handle Set
- FFR 05 Upper Receiver Set
- FFR 06 Stock Set
- FFR 07 Lower Receiver Set
- FFR 08 Hop Up Set For FFR 7"
- FFR 09 Rail System Set For FFR 7"
- FFR 10 SuppressorHop Up Set For FFR 7"
- FFR 11 Outer Barrel Set For FFR7"
- FFR 12 Mock Flash Suppressor For FFR12" SD
- FFR 13 Rail System Set For FFR 12" SD
- FFR 14 SuppressorHop Up Set For FFR 9"
- FFR 15 Hop Up Set For FFR 9"
- FFR 16 Hop Up Set For FFR 12" SD
- FFR 17 SuppressorHop Up Set For FFR 12"SD
- FFR 18 Outer Barrel Set For FFR 9"
- FFR 19 Rail System Set For FFR 9"
- FFR 20 Outer Barrel Set For FFR 12"SD
- FFR 21 Gear Box Set
- FFR 22 Buffer Tube Set
- FFR 23 Wire
- FFR 24 Motor set
- FFR 25 Grip
- FFR 26 Magazine

▶ You may purchase all of the groups' parts from G&G support Dep.

▶ E-Mail: support@guay2.com

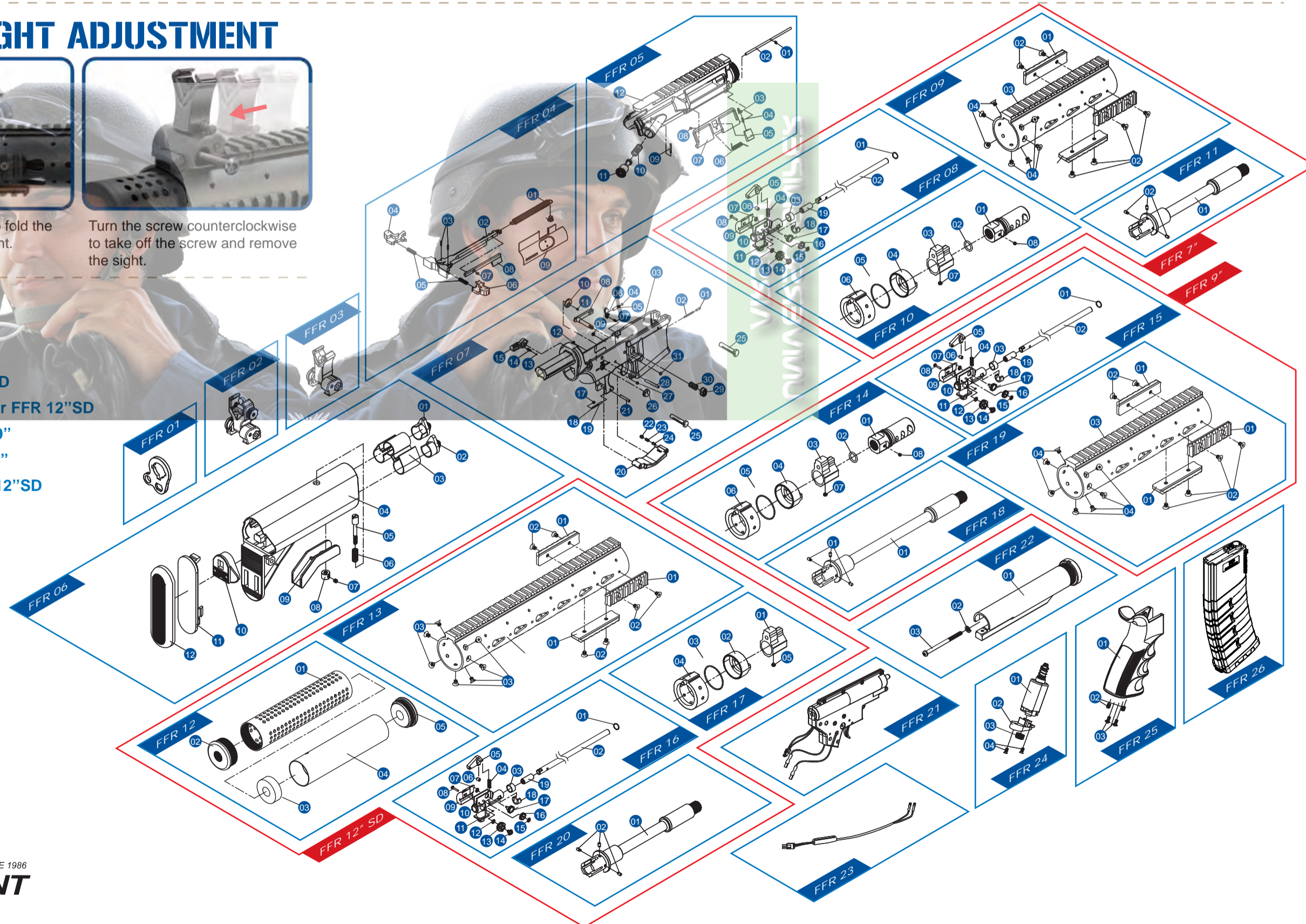

Sales Dept. | sales@guay2.com , b2b@guay2.com
 Technical Support Dept. | support@guay2.com
 PR Dept. | pr@guay2.com

Chang Hua Headquarter | Tel : +886-4-798-9000 Fax : +886-4-798-9900
 No.999, Zhonghua Rd. Shengang Township, Changhua County 50955, Taiwan (R.O.C.)

Taipei | Tel : +886-2-2692-2000 Fax : +886-2-2692-4000
 11F-3., No.27, Lane 169, Kangning St. Shijr City, Taipei County 22180, Taiwan (R.O.C.)



G&G SINCE 1986
ARMAMENT
 WWW.GUAY2.COM