

GC1-46 AEG SYSTEM INSTRUCTION MANUAL

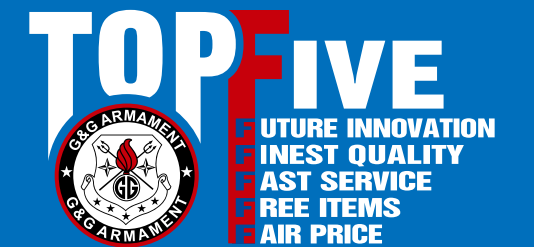

MAINTENANCE



Remove the magazine.

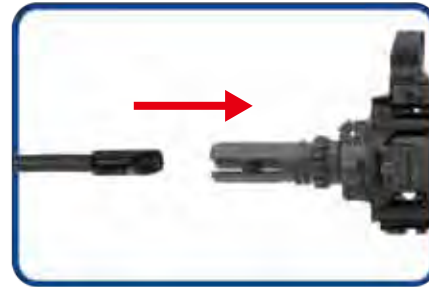

Return the hop up dial to normal position and insert the cleaning rod from the lead edge of the inner barrel.



Be aware to have the rod facing down and reaching to the end, and remove clogged pellets.

REAR SIGHT ADJUSTMENT



Loosen the rear sight fixing screw and turn the adjusting screw with a screwdriver.



Windage Adjustment (left / right adjustment)



Turn for adjustment. Use the small hole for precision shooting.



RETRACTABLE STOCK



Press the stock release lever to unlock.



Adjust the position (6 position).

FRONT SIGHT ADJUSTMENT



Unscrew the screw to disassemble the front sight.



Remove front sight.

PARTS LIST

- GC1-46 01 Short rail Set
- GC1-46 02 Gear box set
- GC1-46 03 Charging handle set
- GC1-46 04 Rear sight base set
- GC1-46 05 Sling Swivel
- GC1-46 06 Wire
- GC1-46 07 Q.D. sling swivel
- GC1-46 08 Flash suppressor set
- GC1-46 09 Outer barrel set
- GC1-46 10 Stock set

- GC1-46 11 Front sight set
- GC1-46 12 Rail system set
- GC1-46 13 Buffer tube set.
- GC1-46 14 Lower receiver set
- GC1-46 15 Upper receiver set
- GC1-46 16 Hi-cap 450R magazine
- GC1-46 17 Grip
- GC1-46 18 Adjustment tool
- GC1-46 19 Motor set
- GC1-46 20 Motor cap
- GC1-46 21 Hop Up Set

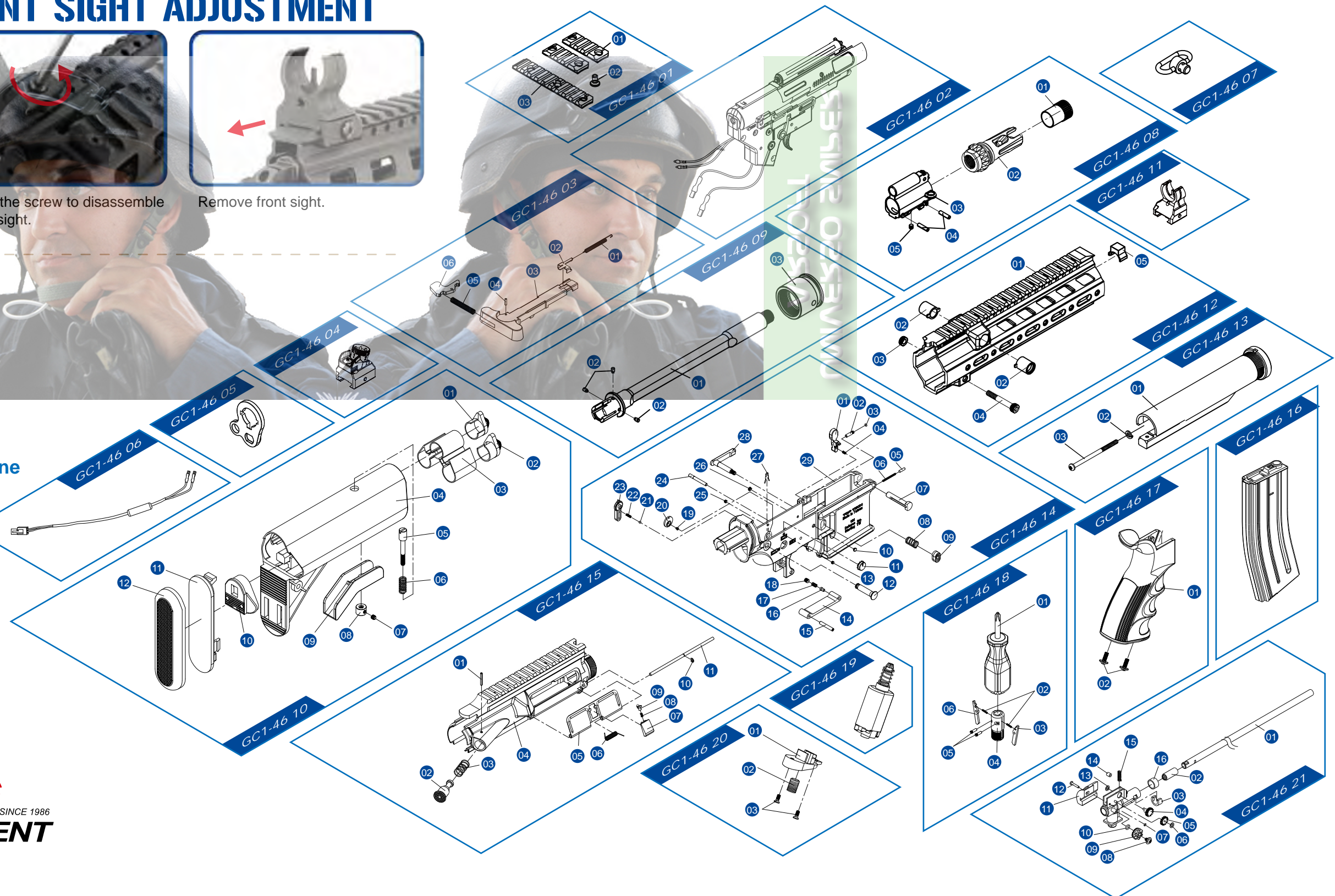

Sales Dept. | sales@guay2.com , b2b@guay2.com
 Technology Support Dept. | support@guay2.com
 PR Dept. | pr@guay2.com

Chang Hua Headquarter | Tel : +886-4-798-9000 Fax : +886-4-798-9900
 No.999, Zhonghua Rd. Shengang Township, Changhua County 50955, Taiwan (R.O.C.)

Taipei | Tel : +886-2-2692-2000 Fax : +886-2-2692-4000
 11F-3., No.27, Lane 169, Kangning St. Shijr City, Taipei County 22180, Taiwan (R.O.C.)

▶ You may purchase all of the groups' parts from G&G support Dep.
 ▶ E-Mail: support@guay2com



G&G SINCE 1986
ARMAMENT
 WWW.GUAY2.COM