

INSTRUCTION MANUAL

GG1-46 AEG SYSTEM



WWW.GUAY2.COM
G&G ARMAMENT
AIRSOFT GUNS & ACCESSORIES



CAUTION

- This product is suggested for users 18 years or older.
- Wear goggles while shooting.
- Incorrect use may cause injury or death.
- Never point at humans and animals with the airsoft guns.
- Read the whole manual before using.
- Buyers and users should obey the laws and rules of the local authority.



FIRING MODE & SAFETY



Safety On
The gun will not fire



Semi Auto
Single shot

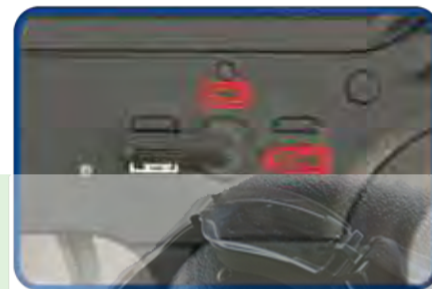

Full Auto
Automatic firing

CHARGING BATTERY



1. Charge up the battery.
2. Charging will be completed after 3 hours.



Pull out the butt plate from upper part.



Take out the battery stop.



Connects the battery until connector clicks into place.



Insert the battery into stock.



Reinstall the battery cover and butt plate.



Recommended battery type
G-11-056
NI-MH 9.6V 1600 mAh

CAUTION

1. Use high quality battery with the CE approval to avoid any unnecessary damage on the product.
2. Use either 8.4V or 9.6V battery only, battery with voltage too high or too low might damage the product.
3. Remove the battery from the product when it is not in use.
4. Do not wet nor incinerate the battery, nor to deform the terminal.

LOADING MAGAZINE



1. Open the top plate of magazine.
2. Load G&G 5.95mm BB pellets into the magazine until chamber is full.
3. Insert the magazine until it clicks.
4. Turn the winding wheel on the bottom of the magazine to tighten the spring. This will allow the BBs to feed through the top of the magazine.

CAUTION

It is strongly recommended to use G&G BB pellets only. Using low quality BB pellets will damage the product and void warranty.

HOP-UP ADJUSTMENT

CAUTION

Do not catch your fingers in the dummy bolt. Never hold the gun sideways as the BB pellets will curve right or left.

❌ **Too much Hop-up.**
(Turn the adjust lever toward **Normal** to correct the upward trajectory.)

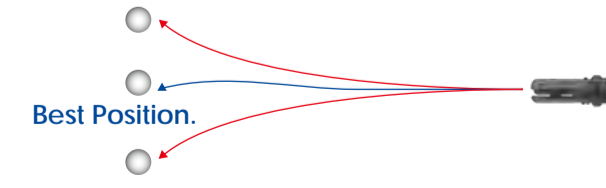

❌ **Not enough Hop-up.**
(Turn the adjust lever toward **Hop** to correct downward trajectory.)

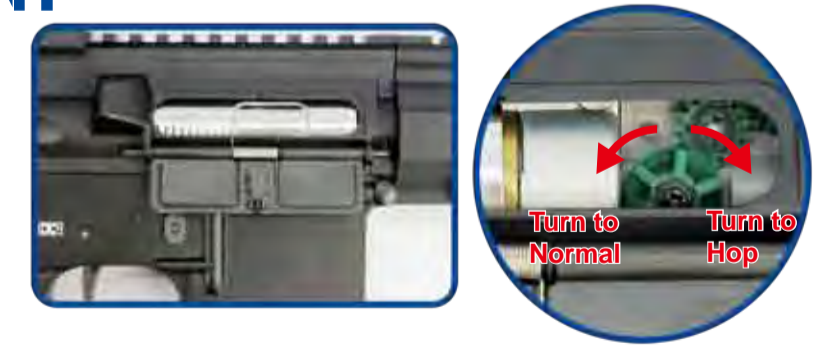

GC1-46 AEG SYSTEM INSTRUCTION MANUAL



MAINTENANCE



Remove the magazine.

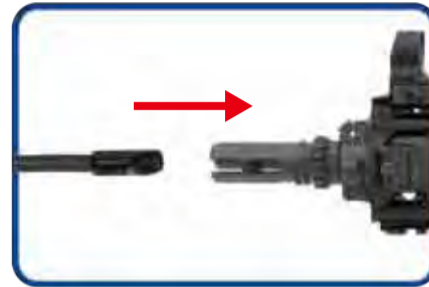

Return the hop up dial to normal position and insert the cleaning rod from the lead edge of the inner barrel.



Be aware to have the rod facing down and reaching to the end, and remove clogged pellets.

REAR SIGHT ADJUSTMENT



Loosen the rear sight fixing screw and turn the adjusting screw with a screwdriver.



Windage Adjustment (left / right adjustment)



Turn for adjustment. Use the small hole for precision shooting.



RETRACTABLE STOCK



Press the stock release lever to unlock.



Adjust the position (6 position).

FRONT SIGHT ADJUSTMENT



Unscrew the screw to disassemble the front sight.



Remove front sight.

PARTS LIST

- GC1-46 01 Short rail Set
- GC1-46 02 Gear box set
- GC1-46 03 Charging handle set
- GC1-46 04 Rear sight base set
- GC1-46 05 Sling Swivel
- GC1-46 06 Wire
- GC1-46 07 Q.D. sling swivel
- GC1-46 08 Flash suppressor set
- GC1-46 09 Outer barrel set
- GC1-46 10 Stock set

- GC1-46 11 Front sight set
- GC1-46 12 Rail system set
- GC1-46 13 Buffer tube set.
- GC1-46 14 Lower receiver set
- GC1-46 15 Upper receiver set
- GC1-46 16 Hi-cap 450R magazine
- GC1-46 17 Grip
- GC1-46 18 Adjustment tool
- GC1-46 19 Motor set
- GC1-46 20 Motor cap
- GC1-46 21 Hop Up Set

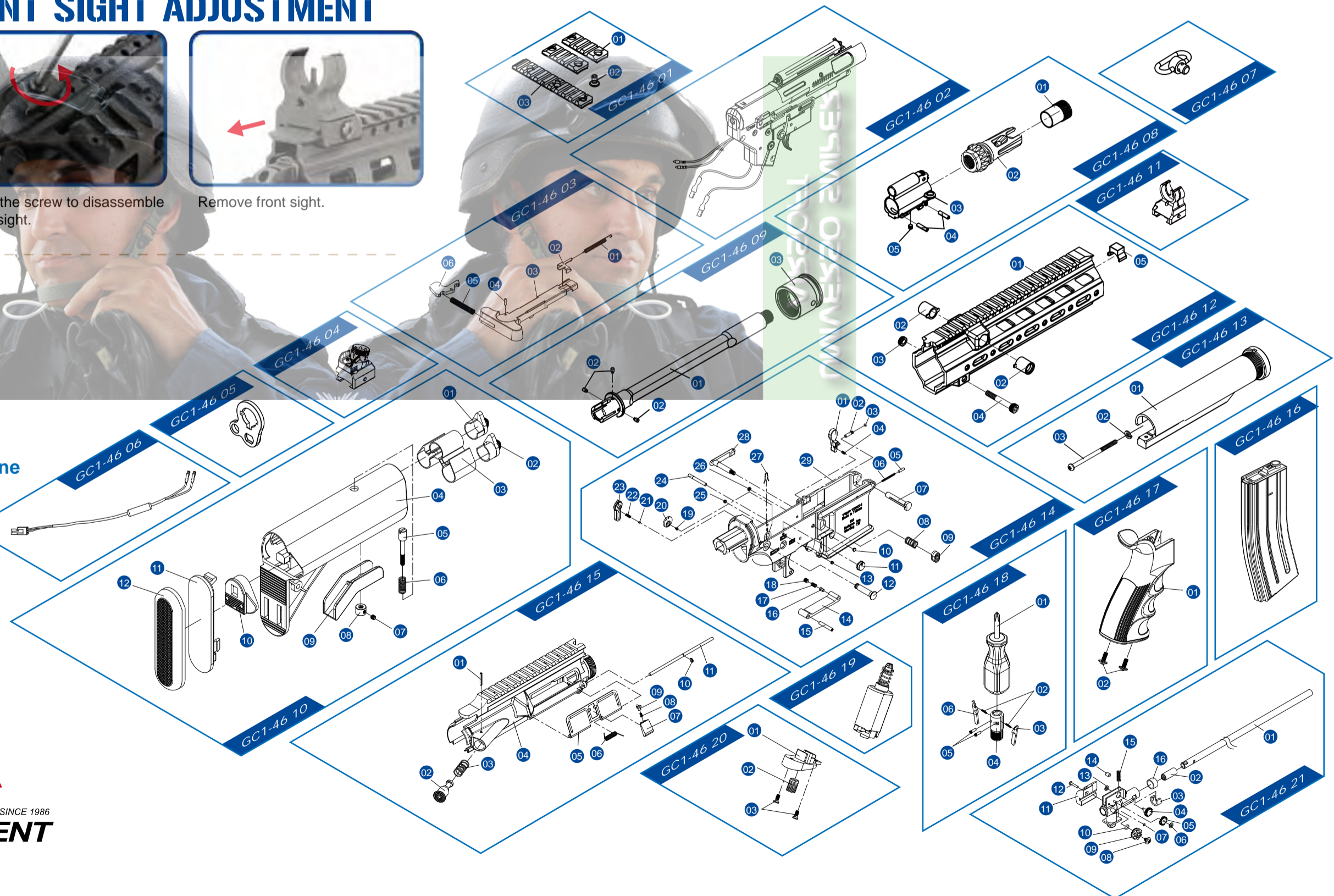

Sales Dept. | sales@guay2.com , b2b@guay2.com
 Technology Support Dept. | support@guay2.com
 PR Dept. | pr@guay2.com

Chang Hua Headquarter | Tel : +886-4-798-9000 Fax : +886-4-798-9900
 No.999, Zhonghua Rd. Shengang Township, Changhua County 50955, Taiwan (R.O.C.)

Taipei | Tel : +886-2-2692-2000 Fax : +886-2-2692-4000
 11F-3., No.27, Lane 169, Kangning St. Shijr City, Taipei County 22180, Taiwan (R.O.C.)

▶ You may purchase all of the groups' parts from G&G support Dep.
 ▶ E-Mail: support@guay2com



G&G SINCE 1986
ARMAMENT
 WWW.GUAY2.COM