

INSTRUCTION MANUAL

GR4 100Y

TOP FIVE

G&G ARMAMENT

**UTURE INNOVATION
FINEST QUALITY
FAST SERVICE
FREE ITEMS
FAIR PRICE**



SPECIAL SHOOTING
Used for precision firing.



COMMON SHOOTING
Used for full automatic firing.



WINDAGE KNOB (left / right adjustment)
ELEVATION KNOB (up / down adjustment)

REAR SIGHT ADJUSTMENT

CAUTION
Keep the selector on Safe mode until you are actually ready to shoot.

RETRACTABLE STOCK

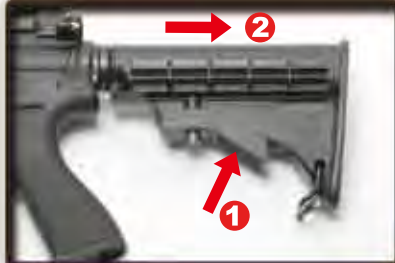

Press the stock release lever to unlock.



Adjust the position (6 position).

WINDAGE ADJUSTMENT KNOB



Detachable rear sight.



Turn the knobs counterclockwise to disassemble the rear sight.



Take off the rear sight to install other accessories.

MAINTENANCE



Remove the magazine.

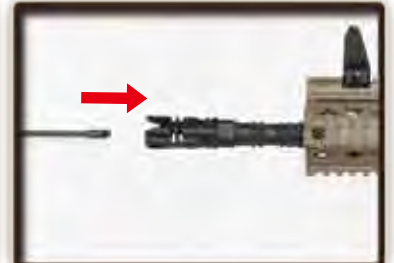

Return the hop up dial to normal position and insert the cleaning rod from the lead edge of the inner barrel.

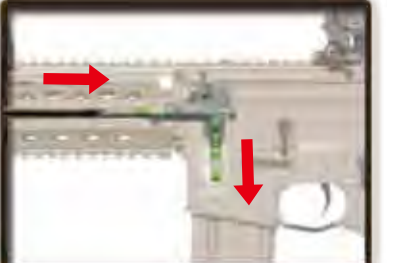

Be aware to have the rod facing down and reaching to the end, and remove clogged pellets.

OPTIONAL PARTS



G-12-006
CD13-TRT30GD Red-Dot Scope



G-03-105
SCAR BIPOD GRIP

FOLDING THE STOCK

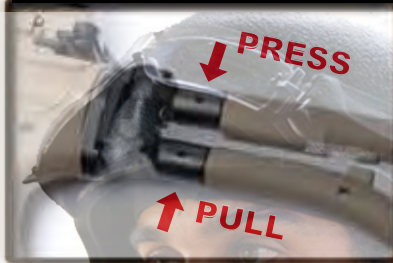

Press and Pull the stock to unlock.



Folding the stock.



Turn the folding stock to be locked.

TROUBLE SHOOTING



The screw at bottom of the grip. Please use the screwdriver to adjust.



Check the wire set contact with motor.



Check the battery and connector.

PARTS LIST

GR4 100Y-01	Flash suppressor set	GR4 100Y-18	Lower receiver set
GR4 100Y-02	Rail system set	GR4 100Y-19	Trigger guard set
GR4 100Y-03	Rear sight base set	GR4 100Y-20	Selector plate
GR4 100Y-04	Rear sight set	GR4 100Y-21	Rear frame lock pin set
GR4 100Y-05	Hop-up set	GR4 100Y-22	Grip
GR4 100Y-06	Upper receiver rail set	GR4 100Y-23	Motor set
GR4 100Y-07	Inner barrel	GR4 100Y-24	Grip bottom set
GR4 100Y-08	Upper receiver set	GR4 100Y-25	Extended stock set
GR4 100Y-09	Charging handle set	GR4 100Y-26	Gear box set
GR4 100Y-10	Port cover set	GR4 100Y-27	Barrel base set
GR4 100Y-11	Front frame lock pin set	GR4 100Y-28	Blow back pneumatic piston
GR4 100Y-12	Bolt catch set	GR4 100Y-29	Charging plate
GR4 100Y-13	Selector lever set	GR4 100Y-30	Charging upper cover
GR4 100Y-14	Magazine catch set	GR4 100Y-31	Switch plate
GR4 100Y-15	Stock washer	GR4 100Y-32	Folding stock set
GR4 100Y-16	Enhanced rod set	GR4 100Y-33	Front sight set
GR4 100Y-17	Hi-cap 450R magazine	GR4 100Y-34	Folding stock base set

MANUFACTURED BY G&G ARMAMENT

TAIWAN

Sales Dept. | sales@guay2.com , b2b@guay2.com
Technology Support Dept. | support@guay2.com
PR Dept. | pr@guay2.com

Chang Hua Headquarter
Tel : +886-4-798-9000 Fax : +886-4-798-9900
No.999, Zhonghua Rd. Shengang Township,
Changhua County 50955, Taiwan (R.O.C.)

Taipei
Tel : +886-2-2692-2000 Fax : +886-2-2692-4000
11F-3., No.27, Lane 169, Kangning St. Shijr City,
Taipei County 22180, Taiwan (R.O.C.)

U.S.A.

E-mail | sales101@guay2.com

Los Angeles
Tel : +1-626-581-0101
Fax : +1-626-581-1011
1122 Coiner Court,
City of Industry,
CA 91748 (U.S.A.)

Dealer

G2-201401-08-英

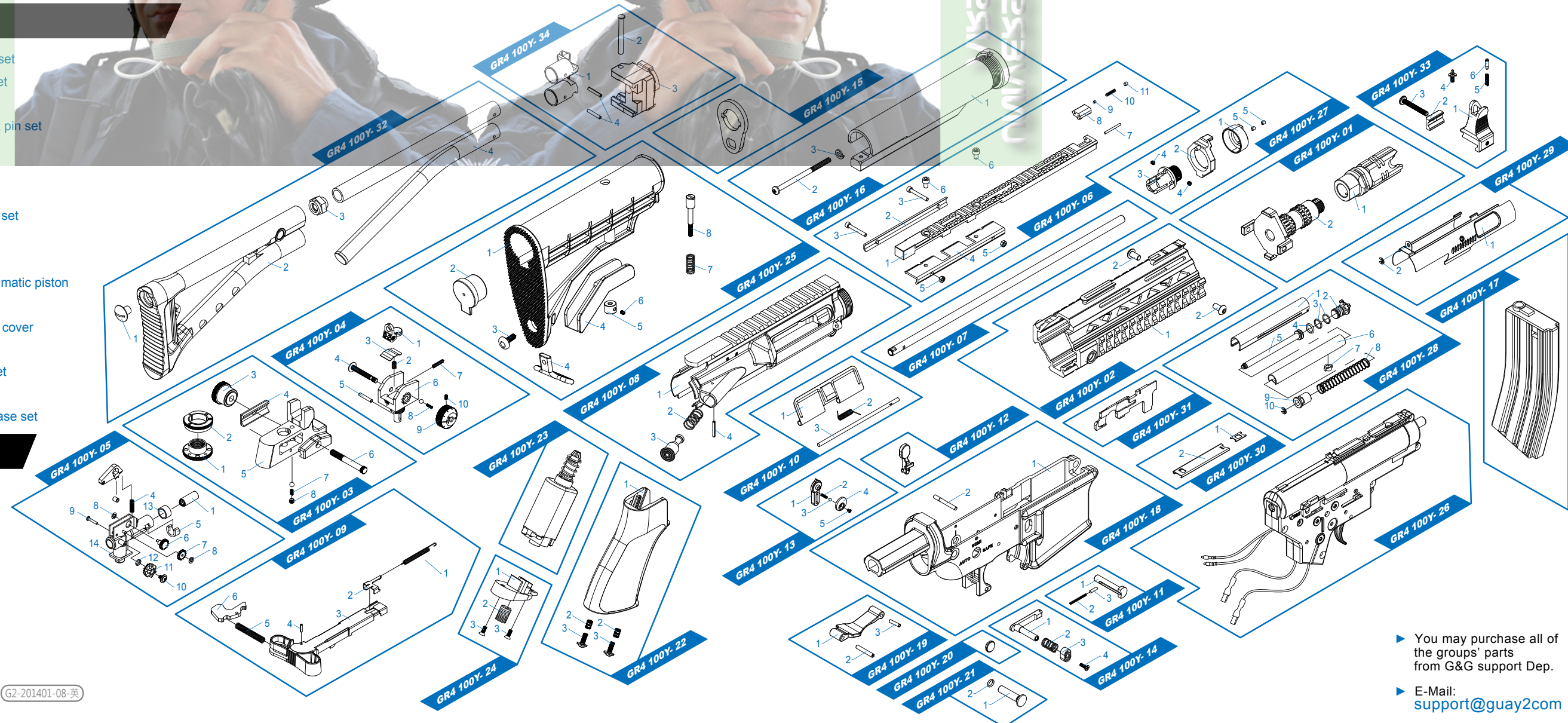

▶ You may purchase all of the groups' parts from G&G support Dep.
▶ E-Mail: support@guay2.com