

1 各部名稱 component names

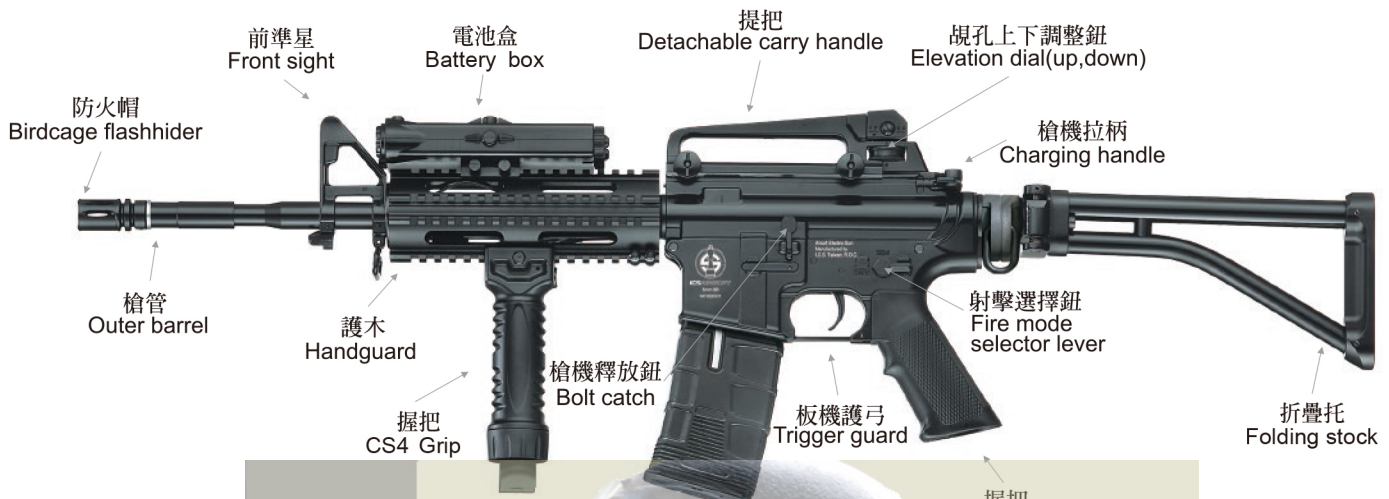

■ ICS-25 R.A.S. Proline

■ ICS-27 Proline

■ ICS-140 Sportline

彈匣 Magazine

握把 Pistol grip

■ ICS-145 Sportline

■ ICS-40 Sportline

2 H-UP彈道調整 H-UP adjustment

將槍機拉柄往後拉，防塵蓋即可打開。
Pull the charging handle backward to open the ejection cover for H-UP adjustment.

H-UP調整：
子彈過於上飄，請調整撥盤向上旋轉。
子彈過於下墜，請調整撥盤向下旋轉。
BB 彈呈現一直線的彈道才是正確射法。

H-UP Adjustment:
When the BB pellet rises up, rotate the dial counter-clockwise to lower trajectory down. When the BB pellet falls down, rotate the dial clockwise to raise the trajectory up. Make sure the trajectory of BB pellet to be straight.

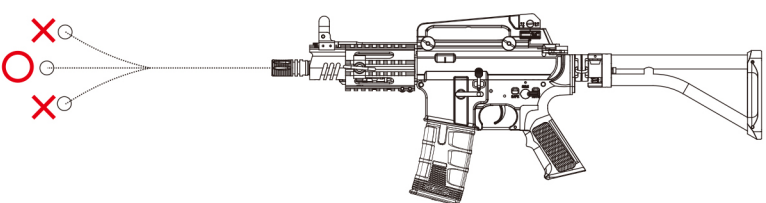
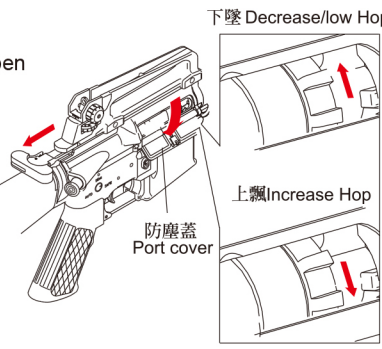

3 電池盒調整方法 Battery box adjustment

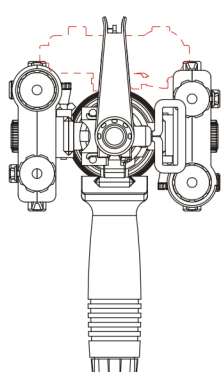

電池盒可依個人喜好裝載於R.I.S.上方、左方或右方(如上圖)
The battery box can be loaded to the top, left, right as shown.

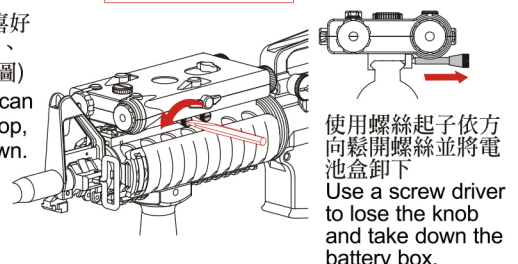
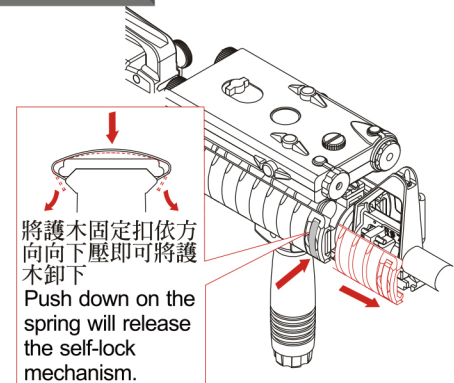

4

裝電池方法 Battery fitting method

Compact Battery 電池盒

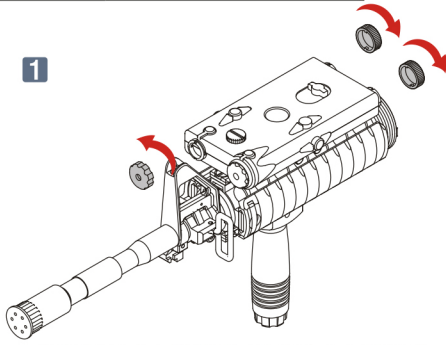

1

將旋鈕依方向鬆開即可將電池盒上蓋打開
After removing caps as shown, lightly pull up and back on the lid.

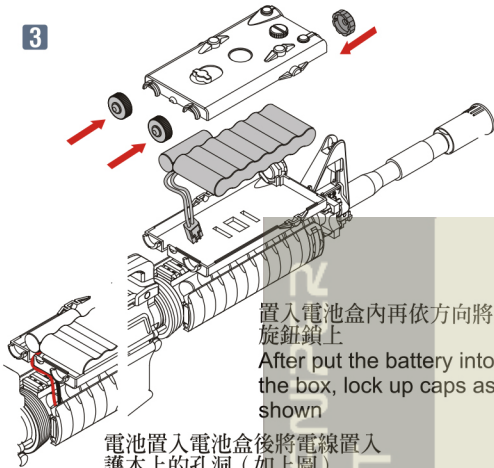

3

電池置入電池盒後將電線置入護木上的孔洞(如上圖)
Put the battery wire through the hole and put the battery into the case.

置入電池盒內再依方向將旋鈕鎖上
After put the battery into the box, lock up caps as shown

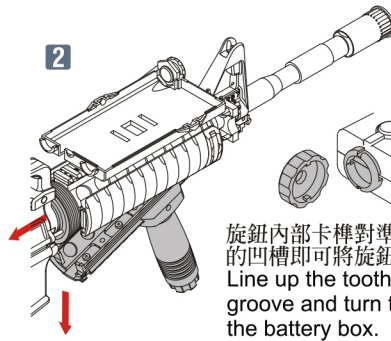

2

旋鈕內部卡榫對準電池盒上的凹槽即可將旋鈕鎖上
Line up the tooth and the groove and turn to lock the battery box.

將護木固定環向後拉並卸下護木
Put back the delta ring and remove R.I.S.

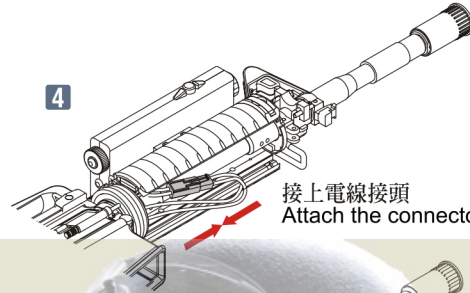

4

接上電線接頭
Attach the connector

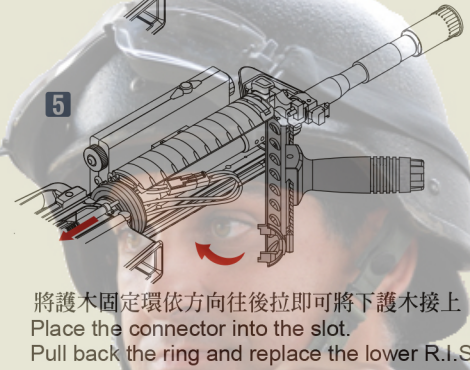

5

將護木固定環依方向往後拉即可將下護木接上
Place the connector into the slot.
Pull back the ring and replace the lower R.I.S.

Compact handguard 護木安裝方式

1

固定環
Delta ring

1.Pull
2.

依方向先將固定環往後拉再拆下護木
1.Pull back the delta ring.
2.Take down the hand guard.

2

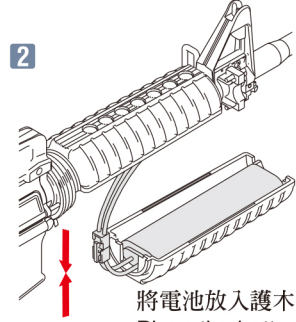

將電池放入護木內再接上電線。
Place the battery inside the hand guard and connect the connectors.

3

1.Pull
2.Press
3.Push

依順序壓下固定環再將護木接上。
Pull back the delta ring and insert the hand guard back to place.

5

可動部的說明 Movable parts

5-1

馬達間隙調整

Fine adjustment of gear engagement

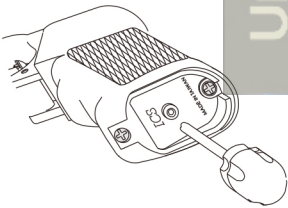

用六角板手調整馬達間隙螺絲(出廠時已調整好)
Adjust the gap between the motor and the gear by an allen key (Original factory setting is for 9.6v battery)

5-2

Folding stock adjustments

折疊托調整

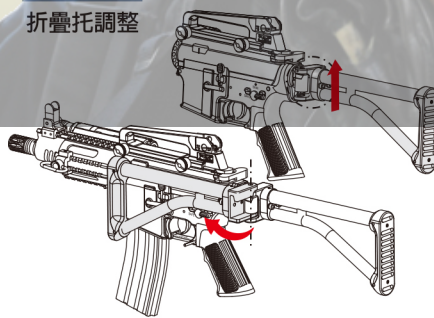

將後托座微提後即可折疊
Pull up the stock set than fold the stock

5-3

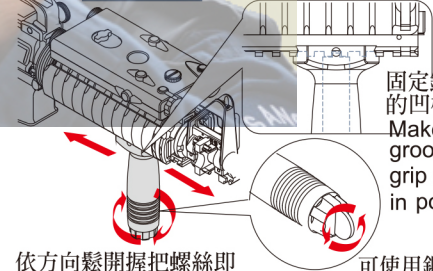

依方向鬆開握把螺絲即可調整戰術握把的位置
Loose the joint dial to adjust the fore grip to personal preference.

固定銷對準軌道條上的凹槽再將握把鎖緊
Make sure the grooves on the fore grip are properly in position.

可使用銅板或手將握把螺絲鬆開
Use a coin or hand to lose the knob.

5-4

可作動作 Movable parts

1 槍機拉柄 Charging handle
拉柄拉動可打開防塵蓋
Pull the charging handle to open the port cover

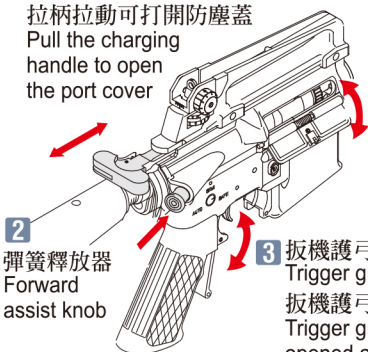

2 彈簧釋放器
Forward assist knob

3 扳機護弓
Trigger guard
扳機護弓可開或關
Trigger guard can be opened and closed

5-5

止逆轉釋放鈕(彈簧釋放器)

Forward assist knob

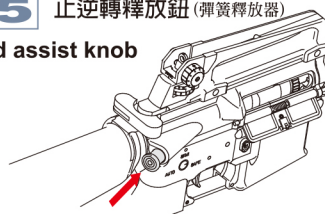

1 槍枝使用完畢轉至單發狀態下發射 2~3 下後再按止逆轉釋放鈕, 可將活塞彈簧回覆至原處。
2 槍身做分解時, 必須先釋放活塞彈簧, 才可做分解動作。

1. After playing, fire 2-3 in single position, then Push the forward assist knob to release the spring tension before storage.
2. Push the forward assist knob before you assemble the gear box.

5-6

The correct position of No.3 gear before reassembling

槍身結合 3 號齒正確位置圖

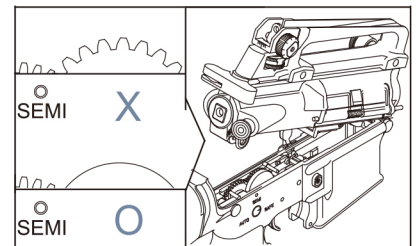

3 號齒在槍身結合時, 必須轉到正確位置, 才可將上槍身蓋下。Make sure No.3 gear is turned to the correct position before you reassemble the receiver/gearbox.

6 精確射擊調整動作 Ironsight adjustment

單連發選擇方式 Selector lever setting

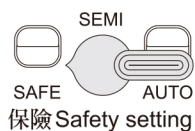

單發 Semi automatic

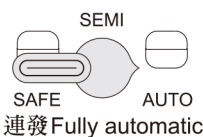

準星高度調整 Front sight adjustment

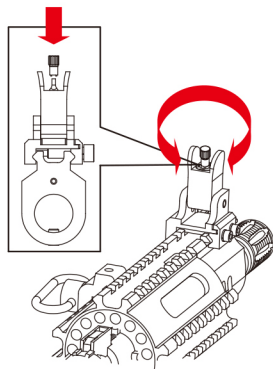

將準星調整桿壓入定位轉動即可調整高低
Turn clockwise to raise B.B. hitting point.
Turn counter clockwise to lower B.B. hitting point.

7 彈匣使用方式 Magazine attachment

7-1 load BBs 裝BB彈方式

將彈匣上蓋依箭頭方向推開再倒入B.B.彈
Open the cover to load BBs. Please use ICS 6mm caliber BBs for optimum Performance.



建議使用ICS 6mm BB彈
Suggest to ICS 6mm BBs

依箭頭方向旋緊彈匣底下旋鈕，即可將 B.B. 彈順利送出。

To charge BB feed spring, please wind magazine.

7-2 彈匣上下方式

Magazine loading and unloading

按下彈匣卡榫即可將彈匣裝入或拆下
Press the magazine release lever to load or unload the magazine.

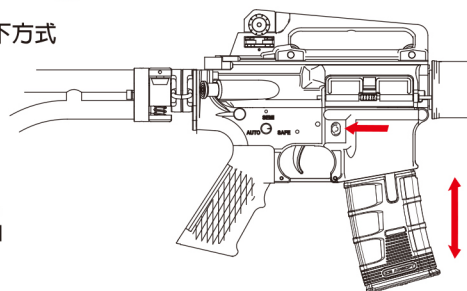

覘孔左右調整 Rear sight left-right adjustment

Right Left

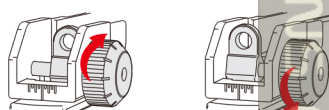

依旋鈕方向旋轉即可將覘孔組左右調整
Turn clockwise to aim right, turn counter clockwise to aim left.

覘孔高度調整 Rear sight up-down adjustment

Forward Backward

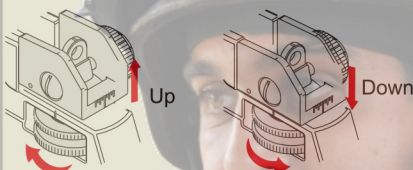

將調整鈕往前轉即可升高覘孔組，將調整鈕往後轉即可降低覘孔組。
Turn the dial forward to raise the hitting point. Turn the dial backward to lower the hitting point.

精密射擊調整 Rear sight precision targeting adjustment

Forward Backward



近距將覘孔往前推
Common/close-range low-light shooting. Push forward to engage battle sight.

遠距將覘孔往後推
Precision daylight shooting. Push backward to engage peep hole.

8 齒輪箱拆解 Disassemble Gear-box

8-1 Remove the upper Gearbox 上槍身拆卸

注意 CAUTION ※重新組裝時，必須依反向動作組合
Reassembly is the reverse of disassemblys procedures.

1 使用起子依方向將槍身結合銷推出即可打開上槍身
To open upper receiver, use a screwdriver to push out frame lock pins.

2 拆下活塞組
Take the piston out.

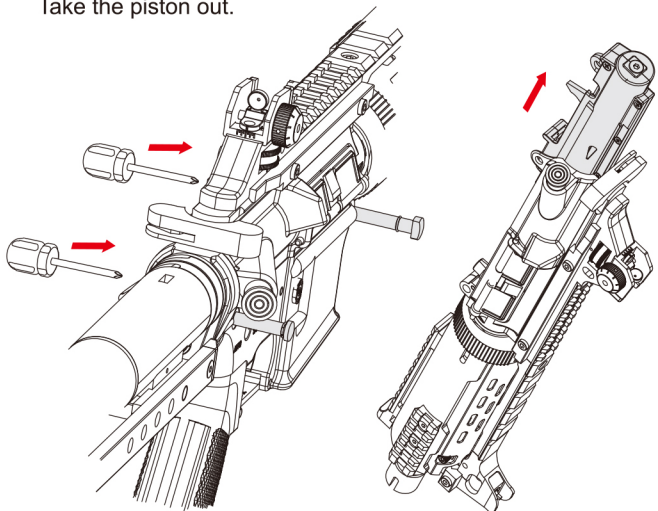

8-2 Remove the lower Gearbox 下槍身拆卸

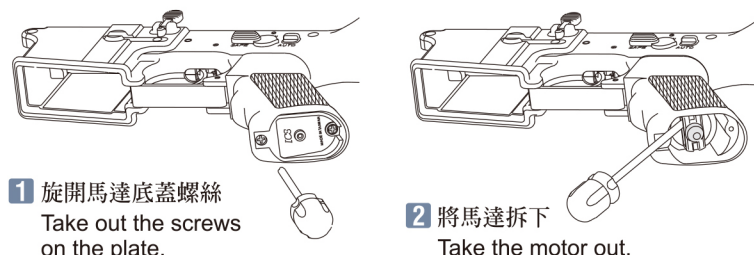

1 旋開馬達底蓋螺絲
Take out the screws on the plate.

2 將馬達拆下
Take the motor out.

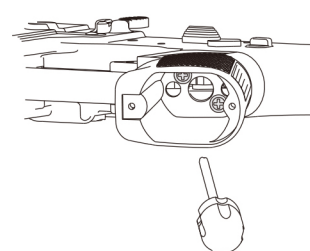

3 旋開握把內螺絲
Take out inner screw in the pistol grip.

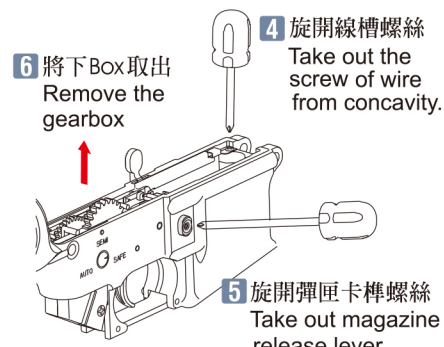

4 旋開線槽螺絲
Take out the screw of wire from concavity.

6 將下Box取出
Remove the gearbox

5 旋開彈匣卡榫螺絲
Take out magazine release lever.

9 各部零件說明 Description

■ ICS-27 CQB Folding stock

*每一款槍型基本配備不同依實際出貨為主。圖片僅供參考。
The components/accessories for each model may have kind of differences depending on the actual goods. Images are only for reference.

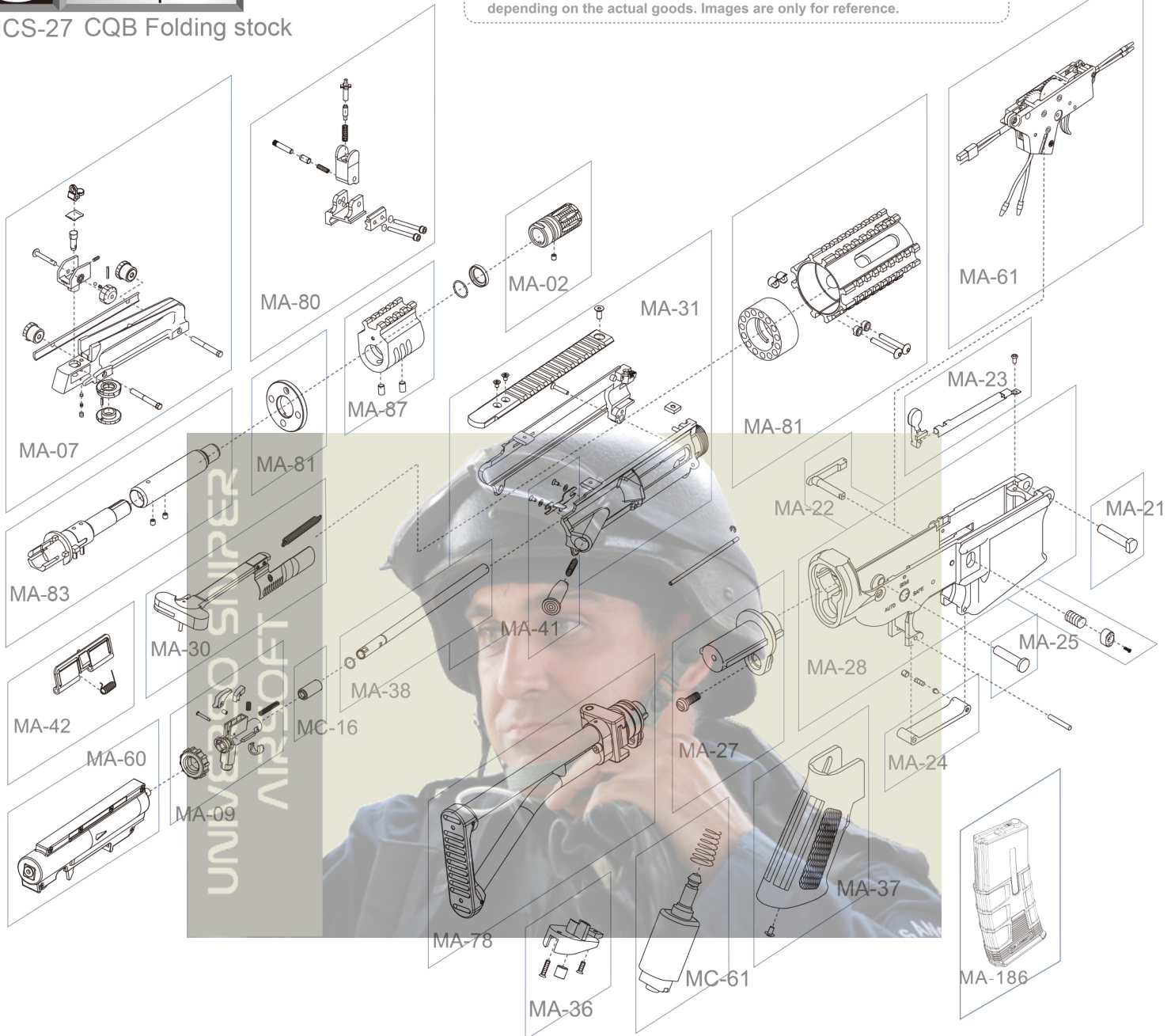

Patents acquired: R.O.C. M244431 / US7077117B1 / R.O.C. D159178 / USD706880S / R.O.C. M320468 / EM002246579-0001

WARNING 警告 電槍使用之注意事項 Maintenance

1. 請勿使用回收及劣質的 BB 彈，以減少槍管損耗與避免卡彈的情形發生。
Do not use recycle or low quality BB pellets to reduce the barrel damage and prevent from jams.
 2. 如發現有卡彈的情形，應立即停止射擊，如卡彈後再勉強射擊，則會增加齒輪損耗。請使用內附通槍條，將卡彈清除後才可繼續使用。若完成通槍基本故障排除後仍無法使用時，請回原採購店家或專業經銷商尋求維修服務。
When a BB pellet is jammed, cease fire immediately. Firing under jam may cause damage on gears. Please use the cleaning rod that came with your airsoft gun to push it into the barrel by moving down gently until the jammed BB pellet comes out. If the jam still cannot be solved, please contact your original purchase retailer or ask for professional agent for repair service.
 3. 使用前請先確定您的電池已充滿電，當使用中發覺電池即將用盡或射擊速度降低時，應立即更換電池。
Note: No need to remove the barrel when eliminating jam.
 4. 請定期使用通槍條清潔槍管，以保持槍支射擊時的準確性及減少卡彈的情形發生。
Please make sure the battery is fully charged before using. When the battery is run out or firing speed is decreasing, new battery has to be replaced immediately.
 5. 請勿經常空槍射擊，以減少BOX及齒輪不必要的損耗。
Please use cleaning rod periodically to clean the barrel to ensure the firing precision and reduce jam.
 5. Do not dry fire the airsoft gun at any time to reduce damage to the gearbox.
- 使用前請務必詳閱此說明書限18歲以上使用
Always read through this manual before operation.
User restricted to 18 years of age or older.



WWW.ICSBBS.COM