

OWNER'S MANUAL

WARNING! READ ALL INSTRUCTIONS AND SAFETY RULES COMPLETELY BEFORE USING THIS AIR SPORTS GUN. REMEMBER, " *SAFETY BEGINS WITH YOU* ".



KP8 COMPACT

SEMIAUTOMATIC AIR PISTOL

FOR AGE 18 AND OLDER

Consumer Warning

Be advised that this product may be mistaken for a firearm by law enforcement officers or others; Brandishing or displaying the product in public may cause confusion and may be a crime; Altering the coloration or markings required by state or federal law or regulations so as to make the product look more like a firearm is dangerous and may be a crime.



KP8 COMPACT *Air Sports Gun*

SEMI -AUTOMATIC AIR PISTOL

TABLE OF CONTENTS

- MESSAGE FROM KWA
- PRECAUTION
- SAFETY RULES
- WARRANTY
- OPERATIONS I
 - [1] CHARGING GAS
- OPERATIONS II
 - [2] LOADING BB'S
 - [3] LOADING MAGAZINE
 - [4] COCKING
- OPERATIONS III
 - [5] DECOCKING LEVER
 - [6] SHOOTING
- OPERATIONS IV
 - [7] OPEN SLIDE
 - [8] AFTER SHOOTING
- HOP-UP MECHANISM
- DISASSEMBLY
- PARTS LIST

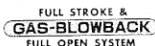

MESSAGE FROM KWA

KWA WOULD LIKE TO THANK YOU FOR YOUR PURCHASE OF THE AIR SPORTS GUNS. WE TAKE PRIDE IN PRODUCING QUALITY AIR SPORTS GUNS INCORPORATING ALL OF THE BEST FEATURES. ALL AIR SPORTS GUNS ARE TO BE OPERATED UNDER SAFETY GUIDELINES AS REAL FIREARMS AND IT IS YOUR RESPONSIBILITY TO USE THEM IN A SAFE MANNER AT ALL TIMES. KWA, AND IT'S AGENTS ARE NOT RESPONSIBLE FOR CARELESS, ABUSIVE, IMPROPER, NEGLIGENT AND CRIMINAL USE OF ITS PRODUCTS.

PRECAUTION

AIR SPORTS GUNS ARE DESIGNED FOR PERSONS OF AGE 18 OR OLDER FOR SPORTING PURPOSE ONLY AND TO BE OPERATED UNDER THE U.S. FIREARMS SAFETY CODES. THE EFFECTIVE SHOOTING RANGE IS APPROXIMATELY 160 FEET AND CAN BE AFFECTED BY SURROUNDING CONDITIONS, SUCH AS TEMPERATURE, WIND, ETC. IT IS STRONGLY RECOMMENDED TO USE THE AIR SPORTS GUN IN A SAFE DESIGNATED SHOOTING RANGE OR AREA AND TO TREAT ALL AIR SPORTS GUNS AS REAL FIREARMS. AIR SPORTS GUNS CAN BE DANGEROUS AND CAN CAUSE SERIOUS INJURY, IT IS THE USER'S RESPONSIBILITY TO HANDLE AIR SPORTS GUNS IN A SAFE MANNER. BE SURE TO TREAT ALL AIR SPORTS GUNS AS IF THEY WERE LOADED AND NEVER POINT AT ANYONE OR OBJECTS THAT YOU DO NOT INTEND TO SHOOT. ONLY AIM YOUR AIR SPORTS GUN IN A SAFE DIRECTION. U.S. FEDERAL LAW REQUIRES A MINIMUM 6MM ORANGE MARKING ON ANY FIREARM REPLICAS AND BY REMOVING THE ORANGE TIP, YOU ARE VIOLATING THE LAW AND IT CAN ENDANGER YOURSELF AND OTHERS.

THE AIR SPORTS GUNS ARE NOT TOYS, ALTHOUGH THEY FIRE 6MM PLASTIC BB'S AT RELATIVELY LOW VELOCITY, THERE ARE STILL HIGH RISKS FOR PERSONAL INJURY IF PROPER PROTECTIVE GEAR IS NOT WORN. REMEMBER, THE AIR SPORTS GUNS RESEMBLE REAL FIREARMS IN APPEARANCE, SIZE AND SOME FUNCTIONAL RESPECTS, THEREFORE, IT IS RECOMMENDED THAT YOU SHOULD NEVER CARRY OR DISPLAY THE AIR SPORTS GUN IN PUBLIC AREAS. ANY CRIMES COMMITTED WITH AN AIR SPORTS GUN WILL BE PROSECUTED AS IF A REAL FIREARM WERE USED. BE SURE NOT TO POINT THE AIR SPORTS GUNS AT ANY LAW ENFORCEMENT OFFICERS OR ANY OTHER ARMED PERSONS, DOING SO, MAY PUT YOURSELF IN A VERY DANGEROUS SITUATION. **REMEMBER, AIR SPORTS GUNS ARE NOT TOYS.**

WARNING! DO NOT ALTER YOUR AIR SPORTS GUN. BY DOING SO, MAY MAKE IT UNSAFE, AND VOID THE WARRANTY, AND AFFECT THE RELIABILITY OF THE

SAFETY RULES



ALL USERS MUST WEAR SHOOTING OR SAFETY GLASSES AT ALL TIMES.

- ◆ READ THE **OWNER'S** MANUAL BEFORE HANDLING AND LOADING THE GUN
- ◆ TREAT ALL AIR SPORTS GUNS AS IF THEY WERE LOADED AT ALL TIMES
- ◆ NEVER POINT AT ANYONE OR OBJECTS YOU DO NOT INTEND TO SHOOT
- ◆ ALWAYS POINT MUZZLE IN A SAFE DIRECTION
- ◆ MAKE SURE **YOUR** SHOOTING DIRECTION IS FREE OF OBSTACLES BEFORE YOU SHOOT
- ◆ DO NOT LOAD ANY AIR SPORTS GUN UNTIL YOU ARE READY TO FIRE
- ◆ ALWAYS KEEP THE SAFETY ON AND NEVER PLACE YOUR FINGER ON THE TRIGGER UNTIL YOU ARE READY TO FIRE
- ◆ ALWAYS EXAMINE AND UNLOAD THE GUN WHEN NOT IN USE. STORE IT IN A SAFE MANNER AND KEEP AWAY FROM CHILDREN
- ◆ DO NOT PEEP AT THE MUZZLE
- ◆ NEVER SHOOT AT ANY ROCKS, WATER OR ANY HARD SURFACES AS THEY MAY CAUSE THE BB'S TO RICOCHET
- ◆ ALWAYS USE THE PROPER 6MM CALIBER BB'S AND NEVER REUSE BB'S
- ◆ NEVER JUMP, CLIMB OR CROSS OBSTACLES WITH A LOADED AIR SPORTS GUN. ALWAYS UNLOAD THE GUN FIRST
- ◆ NEVER LEAVE A LOADED WEAPON UNATTENDED. AIR SPORTS GUNS ARE CERTAINLY NO EXCEPTION TO THIS RULE
- ◆ ACCIDENTS USUALLY RESULT FROM NEGLIGENCE OF BASIC SAFETY RULES

CHOKING HAZARD! AIRSOFT BB'S CAN BE A CHOKING HAZARD. ALWAYS RETRIEVE BB'S AFTER SHOOTING AND KEEP AWAY FROM CHILDREN.

WARRANTY

WE OFFER A 30 DAY WARRANTY FOR MECHANICAL OR ELECTRICAL FACTORY DEFECTS. WARRANTY BECOMES VOID IF DAMAGE IS CAUSED BY USER'S ABUSE, MISUSE, ALTERATION OR MODIFICATION OF THE GUNS OR MAGAZINE IN ANY FORM, INCLUDING BUT NOT LIMITED TO REMOVAL OF ORANGE MARKING AND USE OF IMPROPER SIZE AND/OR LOW GRADE BB'S. WATER, DUST AND CONTAMINANT DAMAGES ALSO VOID THE WARRANTY. WARRANTY DOES NOT COVER BB'S, TARGETS, GAS CANISTERS OR ACCESSORIES OF ANY KIND. PLEASE CONTACT OUR CUSTOMER SERVICE DEPARTMENT TO OBTAIN RMA NO. AND SHIPPING INSTRUCTIONS BEFORE RETURNING ANY PRODUCTS. ALL ITEMS RETURNED FOR REPAIR MUST BE ACCOMPANIED BY A SALES RECEIPT. WARRANTY DOES NOT COVER HANDLING AND SHIPPING CHARGES OF RETURNED ITEMS COMING FROM AND GOING TO CUSTOMERS.

OPERATION - I

[1] CHARGING GAS

- (1) RELEASE MAGAZINE BY PRESSING MAGAZINE CATCH.

CAUTION! AVOID MAGAZINE TO DROP FREELY ON HARD SURFACE; IT MAY DAMAGE THE MAGAZINE.

- (2) PUSH THE GAS CANISTER NOZZLE INTO THE CHARGING VALVE. MAKE SURE THE CANISTER IS IN A VERTICAL POSITION WHEN CHARGING.
- (3) CHARGE MAGAZINE UNTIL GAS OVERFLOWS FROM CHARGING VALVE. (APPROXIMATELY 5-10 SECONDS)

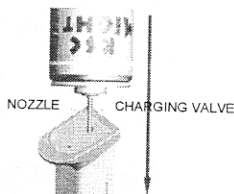
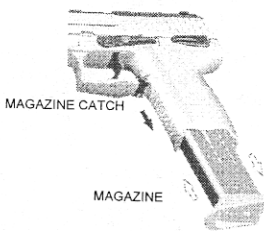

WARNING!

- * CHECK CANISTER FOR ANY CRACKS OR LEAKS BEFORE USING
- * DO NOT EXPOSE CANISTER TO TEMPERATURE OVER 40 °C
- * DO NOT LEAVE CANISTER DIRECTLY OVER FIRE
- * DO NOT BOIL CANISTER
- * KEEP CANISTER AWAY FROM DIRECT SUNLIGHT
- * DO NOT LEAVE CANISTERS IN VEHICLES

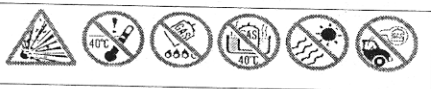

NOTES: IT IS NORMAL THAT YOU MAY EXPERIENCE MINOR LEAKING FROM CHARGING VALVE DURING CHARGING, DUE TO HIGH PRESSURE BUILT UP INSIDE MAGAZINE. IT IS RECOMMENDED TO KEEP GAS RELEASE VALVE SLIGHTLY OILED. IDEAL TEMPERATURE FOR SHOOTING IS ROOM TEMPERATURE.

CAUTIONS: YOU MAY EXPERIENCE A DELAY ACTION IF SURROUNDING TEMPERATURE DROPS BELOW 68 °F. REMEMBER, DO NOT EXPOSE MAGAZINE DIRECTLY UNDER THE SUN OR INCINERATE THE MAGAZINE, IT MAY CAUSE BURSTING. IT IS STRONGLY RECOMMENDED TO EMPTY GAS FROM MAGAZINE AFTER SHOOTING. BE SURE TO AVOID DIRECT GAS CONTACT WITH EYES OR SKIN WHEN GAS IS BEING RELEASED, IT MAY CAUSE FROSTBITE.

OPERATION - II

[2] LOADING BB'S

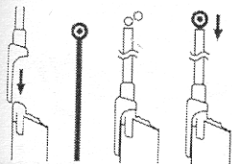

- 1- PLACE LOADER PIPE ONTO LOADER FUNNEL
- 2- PLACE LOADER FUNNEL ON TOP OF MAGAZINE LIP
- 3- POUR BB'S ONTO LOADER PIPE. (DO NOT EXCEED 26 BB'S PER-LOADING)
- 4- USE LOADER ROD TO PUSH BB'S DOWN INTO MAGAZINE
- 5- MAKE SURE TO HAVE A 3MM CLEARANCE BETWEEN BB'S AND TOP LIP OF MAGAZINE

CHECK FOR 3MM CLEARANCE AFTER LOADING BB'S



NOTE: ALWAYS USE KWA ULTRA PREMIUM BB 0.2 ~ 0.25G. USING ONLY KWA'S ULTRA PREMIUM BB'S CAN GIVE THE AIR SPORTS GUN ITS BEST PERFORMANCE. USING IMPROPER AND LOW GRADE BB'S MAY DAMAGE THE GUN.

CAUTION: ALWAYS KEEP "SAFETY" ON WHEN LOADING BB'S AND KEEP FINGERS AWAY FROM TRIGGER UNTIL YOU ARE READY TO SHOOT.

[3] **LOADING MAGAZINE**



- 1- PLACE MAGAZINE BACK INTO MAGAZINE WELL
- 2- PUSH UP MAGAZINE UNTIL IT CLICKS INTO LOCKED POSITION.
- 3- PULL MAGAZINE DOWN TO ASSURE THAT IT HAS BEEN LOCKED IN PLACE.

NOTE: OVERLOADING BB'S IN THE MAGAZINE MAY CAUSE JAMMING AND DAMAGE THE GUN WHEN LOADING. MAKE SURE TO CHECK FOR 3MM CLEARANCE BETWEEN FOLLOWER AND MAGAZINE LIP..

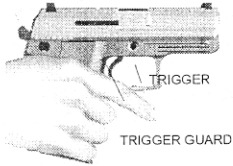

SAFETY CAUTION: ALWAYS KEEP FINGER OFF THE TRIGGER UNTIL READY TO FIRE. MAKE SURE THE MUZZLE IS POINTING IN A SAFE DIRECTION.

NOTE: FOR ABSOLUTE ASSURANCE AGAINST ACCIDENTAL DISCHARGE DUE TO INADVERTENT TRIGGER PULL, KEEP THE MANUAL SAFETY ENGAGED "ON" DURING LOADING OR UNLOADING.

[4] **COCKING**

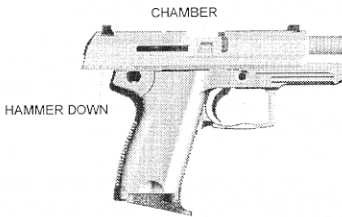

PULL SLIDE TO THE REARMOST POSITION AND RELEASE THE SLIDE. THIS WILL AUTOMATICALLY LOAD THE FIRST BB'S INTO THE CHAMBER. HAMMER WILL BE IN COCKED POSITION. MAKE SURE NOT TO SKIP THIS PROCEDURE. SKIPPING THIS WILL CAUSE A MISFIRE ON THE FIRST PULL OF THE TRIGGER.

SLIDE WILL STAY OPENED WHEN LAST BB'S IS FIRED AND EJECTED

OPERATION - III

[5] **SAFETY & DECOCKING LEVER**

PUSH SAFETY LEVER UPWARD TO ALIGN LETTER "S" WITH WHITE BAR; SAFETY IS "ON". PUSH LEVER DOWNWARD TO ALIGN LETTER "F" WITH WHITE BAR; SAFETY IS "OFF" (READY TO FIRE)

HAMMER DECOCKING:
TO DECOCK HAMMER, PUSH LEVER DOWNWARD AND HAMMER IS SAFELY DECOCKED WITHOUT FIRING. **WARNING!** AFTER DECOCKING HAMMER, YOU CAN STILL SHOOT WITH DOUBLE ACTION MODE IF THE SAFETY IS NOT ENGAGED.

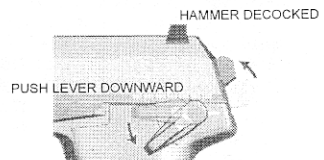
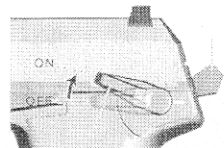

CAUTION! MAKE SURE TO HAVE SAFETY ON AT ALL TIMES WHEN NOT IN A SHOOTING POSITION.

[6] SHOOTING

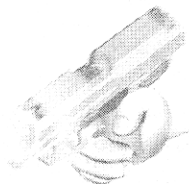

RELEASE SAFETY AND PULL ON TRIGGER. THE BLOW BACK ACTION WILL LOAD THE FOLLOWING BB'S AUTOMATICALLY AS THE SLIDE CYCLES BACK AND FORTH.

CAUTION: ALWAYS WEAR EYE PROTECTION WHEN SHOOTING. BB'S MAY BOUNCE OFF OF HARD SURFACES. MAKE SURE YOUR SHOOTING DIRECTION IS CLEAR OF OBSTACLES BEFORE YOU SHOOT.



GRASP PISTOL IN YOUR HAND FIRMLY. A TWO HAND HOLD WITH ONE HAND WRAPPED AROUND THE OTHER WILL HELP IN CONTROLLING THE PISTOL.

WARNING: NEVER SHOOT GUN IN A HORIZONTAL OR UPSIDE DOWN POSITION.

DOUBLE ACTION MODE:

AFTER CHAMBERING THE FIRST BB BY PULLING THE SLIDE TO THE REAR AND RELEASING IT, THE PISTOL IS READY TO SHOOT AND IS IN SINGLE ACTION MODE. PUSHING LEVER DOWN WILL DECOCK THE HAMMER.

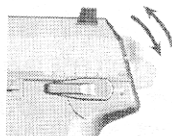

WARNING: IT IS RECOMMENDED TO WEAR EYE PROTECTION AT ALL TIMES. BB'S MAY BOUNCE OFF HARD SURFACES (RICOCHET). ALWAYS POINT GUN IN A SAFE DIRECTION.

OPERATION - IV

[7] OPEN SLIDE

AFTER THE LAST SHOT HAS BEEN FIRED AND EJECTED, THE SLIDE WILL REMAIN OPENED. REMOVE MAGAZINE AND RELOAD MAGAZINE WITH BB'S. LOAD MAGAZINE INTO PISTOL AND RELEASE THE SLIDE STOP. SLIDE WILL LOAD THE FIRST BB INTO CHAMBER.

NOTE: IT IS IMPORTANT TO TREAT YOUR GUN AS THOUGH IT IS LOADED, EVEN IF THE SLIDE REMAINS OPEN.

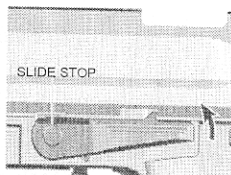

[8] AFTER SHOOTING

REMOVE MAGAZINE FIRST AND VISUALLY INSPECT THE OPEN CHAMBER TO CHECK WHETHER THE MAGAZINE WELL AND CHAMBER ARE CLEAR OF BB'S. WHEN BOTH MAGAZINE AND CHAMBER ARE CLEAR, ENGAGE SAFETY SWITCH.

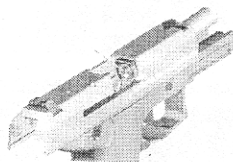

HOP-UP MECHANISM



HOP UP SYSTEM

"HOP UP" SYSTEM IS ONE OF THE STANDARD FEATURES THAT **KWA** GAS BLOW BACK AIR SPORTS GUNS HAVE. THE DESIGN OF HOP UP SYSTEM IS TO PLACE A BALL BEARING BETWEEN CHAMBER WALLS. BY ADDING OR REDUCING PRESSURE ON THE BALL BEARING, IT CONTROLS BACKSPIN OF THE BB AND GIVES IT GREATER STABILITY WHEN IT TRAVELS IN THE AIR, AND ALSO MAKES IT FLY FURTHER WITH GREATER ACCURACY. THE HOP UP SYSTEM DOES NOT ADD POWER TO THE GUN, IT IMPROVES STABILITY AND ACCURACY. (IT IS RECOMMENDED BY **KWA** THAT 0.2 - 0.25g BB'S, RATHER THAN 0.11g, ARE USED WITH THE HOP UP SYSTEM)



HOP UP SYSTEM ADJUSTMENT

BEFORE MAKING ANY ADJUSTMENTS, MAKE SURE YOU HAVE SUFFICIENT GAS PRESSURE INSIDE MAGAZINE. CHAMBER SHOULD BE SLIGHTLY OILED. YOU WILL REQUIRE AT LEAST 65 FEET CLEARANCE WHEN MAKING THE ADJUSTMENT.

1 TEST FIRE GUN FOR 10 - 20 ROUNDS AND OBSERVE THE BB TRAVELING PATTERN.

2 OPEN SLIDE, PLACE ADJUSTING TOOL INTO SLOTTED CHAMBER RING. TURN ADJUSTING RING 1/4 INCH AT A TIME.

3 TURN RING COUNTER CLOCKWISE IF BB'S GO DOWNWARD. TURN RING CLOCKWISE IF BB'S GO UPWARD.

4 ADJUST → TEST FIRE → ADJUST
REPEAT THE PROCEDURES UNTIL YOU FIND THE PROPER TRAJECTORY

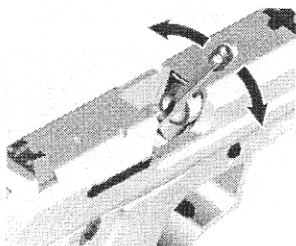
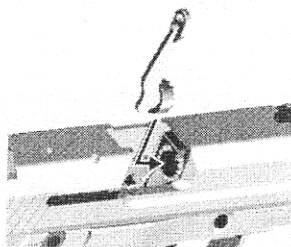











KP8 COMPACT *Air Sports Gun*

FOR AGE 18 AND OLDER

SEMI -AUTOMATIC AIR PISTOL

★ ADJUSTMENT POINT

HOP UP EFFECTIVENESS	BB TRAJECTORY PATTERN		ADJUSTMENTS
NOT EFFECTIVE		BB DROPS FREELY	 TURN KNOB TO LEFT
SLIGHTLY		BB TRAVELS AT SHORT TRAJECTORY PATH	 TURN KNOB SLIGHTLY TO LEFT
PROPERLY		BB TRAVELS DISTANCE AT FLAT TRAJECTORY PATH	 NO ADJUSTMENT MADE
OVERLY		BB TRAVELS FLAT IN SHORT DISTANCE, THEN GOES UP IN CURVE AND DROPS FREELY	 TURN KNOB SLIGHTLY TO RIGHT
EXTREMELY EFFECTIVE		BB TRAVELS AT UNSTABLE SPEED AND IRREGULAR PATH	 TURN KNOB TO RIGHT

★ HOP UP ONE POINT CLINIC

PHENOMENON	POSSIBLE CAUSE	SOLUTIONS
HOP UP OVER-ADJUSTED	HOP OVERLY EFFECTIVE BB TOO LIGHT	ADJUST RING TO RIGHT USE KWA ULTRA PREMIUM BB 0.2~0.25G BB
HOP UP SCATTER	HOP EFFICIENCY TOO WEAK BB	TURN ADJUSTMENT RING TO LEFT USE KWA ULTRA PREMIUM BB 0.2~0.25G BB
CAN NOT START HOP UP	RUBBER CHAMBER REDUCED BY OIL IN RUBBER CHAMBER BB DO NOT TURN TO RUBBER CHAMBER UNDERSIZE BB HOP NOT TAKING EFFECT	EXCHANGE FOR NEW PART FRICTION USE COTTON SWAB TO WIPE OUT OIL USE KWA ULTRA PREMIUM BB 0.2 ~ 0.25G USE KWA ULTRA PREMIUM BB 0.2 ~ 0.25G ADJUST RING TO LEFT
CAN NOT ADJUST HOP UP	RUBBER CHAMBER REDUCED BY FRICTION FRICTION OR DAMAGE RELATED PARTS (ACCESSORIES) LOOSENESS OF INNER BARREL HOP OVER EFFECTIVE	EXCHANGE FOR NEW PART EXCHANGE FOR NEW PART INSERT TIGHTLY INTO RUBBER CHAMBER ADJUST RING TO RIGHT
BBS DO NOT EXIT BARREL	RUBBER CHAMBER REDUCED BY FRICTION STAINS INSIDE THE GUN BODY	EXCHANGE FOR NEW PARTS CLEANING INNER BARREL WITH COTTON SWAB
BULLETS OVER LOADED	WRONG SIZE BB HOP OVERLY EFFECTIVE STAIN IN RUBBER CHAMBER	USE KWA ULTRA PREMIUM BB 0.2 ~ 0.25G ADJUST RING TO RIGHT CLEAN WITH COTTON SWAB
HOP UP EFFECT WEAKENED BY ITSELF	LOW GAS PRESSURE/ MAGAZINE GETS TOO COLD USING TOO MUCH OIL DURING MAINTENANCE	RETURN MAGAZINE AND GAS TO ROOM TEMPERATURE SHOOT TO BLOW OFF OIL INSIDE RUBBER CHAMBER AND PISTON, THEN CLEAN INNER BARREL

DISASSEMBLY

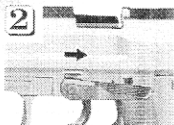

RECOIL SPRING & GUIDE

IT IS NOT RECOMMENDED TO DISASSEMBLE THE GUN UNLESS YOU HAVE A BB JAMMED INSIDE OF BARREL OR FOR MAINTENANCE PURPOSES ONLY. REMOVE MAGAZINE FROM GUN

- 1- REMOVE MAGAZINE
- 2- CHECK AND CLEAR CHAMBER FROM ANY BB'S
- 3- ALIGN CUT OUT SLOT ON SLIDE WITH FRONT END OF SLIDE STOP
- 4- REMOVE SLIDE STOP BY PULLING OUT SLIDE STOP FROM LEFT SIDE OF FRAME
- 5- PULL SLIDE FORWARD AWAY FROM FRAME
- 6- REMOVE GUIDE ROD AND SPRING
- 7- SLIDE BARREL OUT FROM BOTTOM OF SLIDE

REASSEMBLY:

- PLACE BARREL INTO SLIDE FROM BOTTOM
- INSTALL RECOIL SPRING AND GUIDE ROD INTO POSITION
- PUSH THE SLIDE ONTO THE FRAME RAILS AND ALIGN CUT-OUT SLOT WITH SLIDE STOP HOLE
- INSTALL SLIDE STOP
- PULL SLIDE TO REARMOST POSITION AND RELEASE

NOTE: AFTER ASSEMBLY IS COMPLETED, CYCLE THE SLIDE BACK AND FORTH TO INSURE PROPER ASSEMBLY.

GENERAL MAINTENANCE

USE ONLY 100% SILICONE OIL RECOMMENDED BY, AND AVAILABLE AT, THE AIR SOFT DEALER WHERE YOU PURCHASED YOUR KWA PRODUCTS. ANY OTHER TYPE OF LUBRICANT MAY DAMAGE THE PRODUCTS. LIGHTLY LUBRICATE FRAME RAILS, RECOIL SPRING AND MOVING PARTS. LUBRICATING SEALS AND O-RING IS ESSENTIAL, UNLOAD BBS FROM MAGAZINE AND MAKE SURE THE MAGAZINE IS FREE OF GAS BEFORE YOU LUBRICATE CHARGING VALVE AND RELEASE VALVE OF THE MAGAZINE. GREEN GAS IS LIQUID PROPELLANT WHICH TENDS TO DRY OUT THE SEALS AND O-RINGS. WITH LUBRICATING SILICONE OIL, IT WILL EXTEND THE LIFE OF THE SEAL AND O-RING AND PREVENT GAS LEAKS.

PARTS LIST

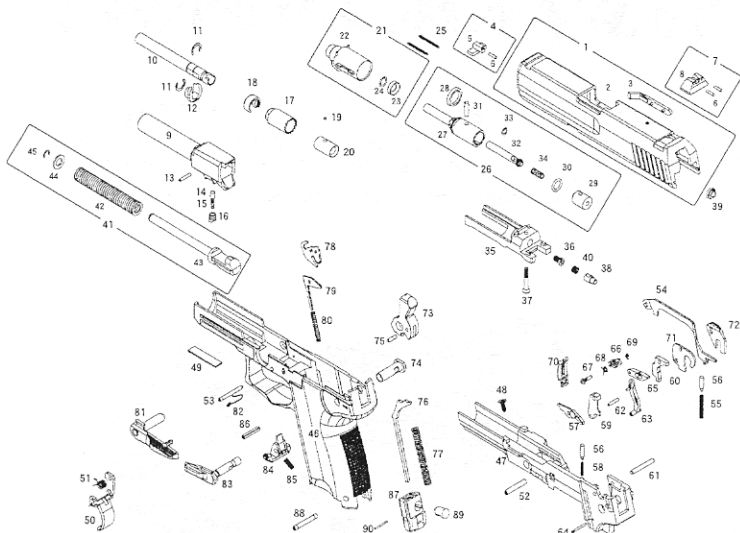

KP8compact COMMON PARTS

- | | | | |
|----|-------------------------------|----|------------------------------|
| 1 | SLIDE ASSEMBLY | 52 | TRIGGER PIN SLEEVE |
| 2 | SLIDE | 53 | TRIGGER PIN |
| 3 | EXTRACTOR | 54 | TRIGGER TRANSFER BAR |
| 4 | FRONT SIGHT ASSEMBLY | 55 | TRANSFER BAR SPRING "LONG" |
| 5 | FRONT SIGHT | 56 | TRANSFER BAR PLUNGER X 2 |
| 6 | SIGHT INSERTS X 1 | 57 | DECOCKING BAR |
| 7 | REAR SIGHT ASSEMBLY | 58 | DECOCKING BAR SPRING "SHORT" |
| 8 | REAR SIGHT | 59 | LEFT SEAR |
| 9 | OUTTER BARREL | 60 | RIGHT SEAR |
| 10 | INNER BARREL | 61 | SERA PIN |
| 11 | INNER BARREL RETAINING RING | 62 | LEFT SEAR STOP PIN |
| 12 | INNER BARREL SLEEVE | 63 | IMPACT BLOCK STRUCT |
| 13 | INNER BARREL PIN | 64 | STRUT PIN "NOT SHOWN" |
| 14 | INNER BARREL ELEVATOR PLUNGER | 65 | IMPACT BLOCK EXTENSION |
| 15 | ELEVATOR SPRING | 66 | IMPACT BLOCK |
| 16 | ELEVATOR CAP | 67 | IMPACT BLOCK PIN |
| 17 | HOP-UP ADJUSTMENT CYLINDER | 68 | IMPACT BLOCK SPRING |
| 18 | BARREL GRIP | 69 | IMPACT BLOCK ECLIP |
| 19 | HOP-UP BALL | 70 | SEAR SPRING |
| 20 | BARREL CHAMBER SEAL | 71 | DISCONNECTOR |
| 21 | GAS CHAMBER ASSEMBLY | 72 | DECOCKING LEVER RETAINER |
| 22 | CYLINDER | 73 | HAMMER |
| 23 | CYLINDER RING | 74 | HAMMER SLEEVE |
| 24 | CYLINDER O-RING | 75 | HAMMER STRUT PIN |
| 25 | RETURN SPRING X 2 | 76 | HAMMER STRUT |
| 26 | GAS PISTON ASSEMBLY | 77 | STRUT SPRING |
| 27 | OUTTER PISTON | 78 | DECOCKING PLATE |
| 28 | MAIN PISTON SEAL | 79 | DECOCKING PLATE BAR |
| 29 | EXTERNAL PISTON END | 80 | DECOCKING PLATE BAR SPRING |
| 30 | PISTON END O-RING | 81 | SLIDE STOP |
| 31 | PISTON END PIN | 82 | SLIDE STOP SPRING |
| 32 | INNER PISTON | 83 | DECOCKING & SAFETY LEVER |
| 33 | INNER PISTON O-RING | 84 | MAGAZINE CATCH |
| 34 | INNER PISTON SPRING | 85 | MAGAZINE CATCH SPRING |
| 35 | BREACH | 86 | MAGAZINE CATCH PIN |
| 36 | BREACH SCREW | 87 | MAIN SPRING BASE |
| 37 | CHAMBER BASE SCREW | 88 | MAIN SPRING PIN |
| 38 | FIRING PIN | | |
| 39 | FIRING PIN SLEEVE | | |
| 40 | FIRING PIN SPRING | | |
| 41 | RECOIL SPRING ASSEMBLY | | |
| 42 | RECOIL SPRING | | |
| 43 | RECOIL GUIDE | | |
| 44 | RECOIL GUIDE RING | | |
| 45 | RING E-CLIP | | |
| 46 | FRAME | | |
| 47 | INNER FRAME BASE | | |
| 48 | INNER FRAME SCREW | | |
| 49 | I.D. PLATE | | |
| 50 | TRIGGER | | |
| 51 | TRIGGER SPRING | | |

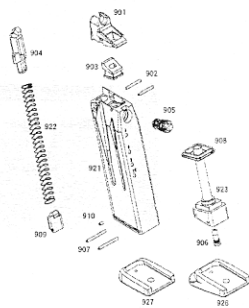

MAGAZINE

- | | |
|-----|----------------------------------|
| 901 | MAGAZINE LIP |
| 902 | MAGAZINE LIP PIN X 2 |
| 903 | MAGAZINE NOZZLE SEAL |
| 904 | FOLLOWER |
| 905 | MAGAZINE RELEASE VALVE |
| 906 | CHARGING VALVE |
| 907 | MAGAZINE BASE PIN X 2 |
| 908 | MAGAZINE BASE SEAL |
| 909 | MAGAZINE BASE LOCK |
| 910 | MAGAZINE BASE LOCK PIN |
| 921 | MAGAZINE BODY |
| 922 | MAGAZINE FOLLOWER SPRING |
| 923 | MAGAZINE FOLLOWER |
| 924 | EXPANSION TUBE |
| 926 | MAGAZINE BASE PLATE "PINKY REST" |
| 927 | MAGAZINE BASE PLATE "FLAT" |