

# KWA®

## OPERATOR'S MANUAL

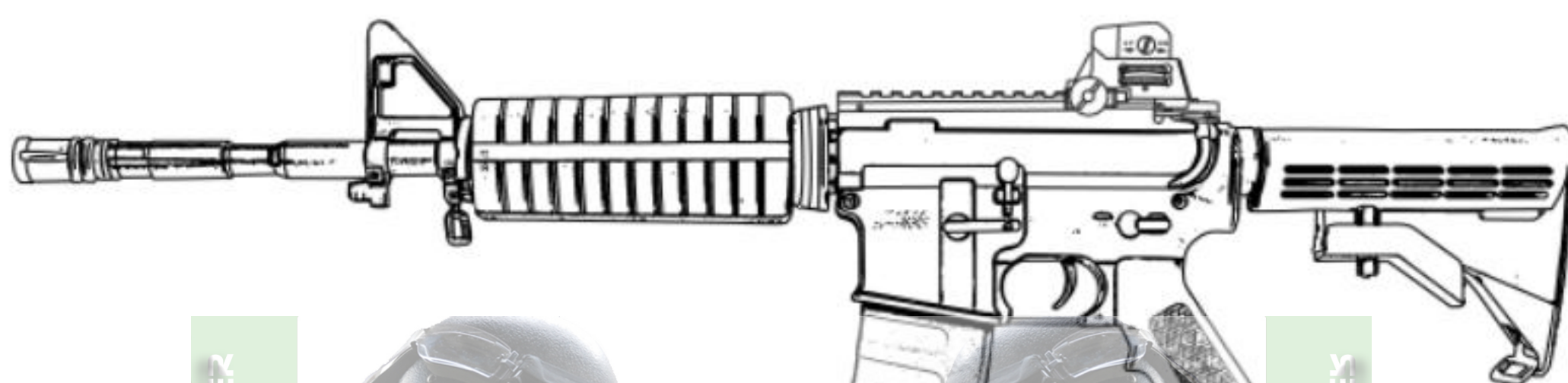

UNIVERSO SNIPER  
AIRSOFT



VIS201  
UNIVERSO SNIPER



## CQR SERIES

## TABLE OF CONTENTS

Use of this manual.....	2
Safety Guidelines .....	2-3
Specifications .....	4
Functions and Features .....	5
Package Contents .....	5
Break-in Period.....	5
Loading Magazine .....	6-7
Fire Selector Switch.....	8
Battery & Installation.....	9
Fuse.....	9
Hop-Up System .....	10
Front and Rear Sight Adjustment .....	11
Disassembly and Assembly Procedures .....	12
Cleaning and Lubrication.....	13
Troubleshooting .....	14
Operating Under Unusual Conditions.....	15
Diagram and Parts Lists .....	16-23





## USE OF THIS MANUAL

Before operating the Airsoft gun, read this manual in its entirety. Important safety topics and tips are discussed throughout all of the chapters. It's important that the operator know the principles of gun handling safety and operation prior to firing the Airsoft gun.

## SAFETY GUIDELINES



**WARNING! Failure to follow safety guidelines may result in serious injury.**

### Safety Distance

The effective shooting range is approximately 150 feet. BBs fired from this Airsoft gun may travel further than intended. Make certain that you have an adequate backstop.

### Eye Protection

Eye protection should be worn at all times when both shooting and maintaining your Airsoft gun. Protect your eyes from BBs under spring pressure while performing maintenance on your Airsoft gun.

### Assume Every Gun is Always Loaded

Until you are certain the chamber is empty, treat every gun as if it were loaded. Do not assume the chamber is empty based on your memory or someone else's words. Always remove the magazine and visually check to confirm the chamber is empty.

### Beware of Barrel Obstructions

Ensure the Airsoft gun barrel is free of obstructions before you fire the gun. Even the smallest obstruction such as lubrication or a stuck cleaning patch can cause a misfire or malfunction.

### Muzzle Control

Always keep the muzzle of the gun pointed in a safe direction. Never point the muzzle at a person or object that you do not intend to shoot.

### Keep Your Safety On

Keep the gun's safety on until your sights are aligned on your target and you are ready to fire.

### Keep Your Finger Off The Trigger

Keep your finger off the trigger and out of the trigger guard until your sights are aligned on your target and you are ready to fire.



**WARNING! Airsoft BBs can be a choking hazard. Keep them away from children.**



## SAFETY GUIDELINES

### Identify Your Target and Backstop

Before you pull the trigger, make certain of your target and what is beyond it. The Airsoft gun should never be fired at surfaces such as rocks, glass, water, or other hard surfaces where BBs are likely to ricochet in unpredictable directions.



**WARNING! Adult supervision is required for any person under the age of 18.**

### Failure To Fire

If the Airsoft gun fails to fire, misfires, or malfunctions, do not look into the gun barrel. BBs can become lodged into the chamber, and serious eye injury may occur.

### Maintain Your Gun Properly

Performing proper maintenance, as outlined in this manual, ensures that your Airsoft gun will be safe to shoot and will perform to its designed specifications for many years. Alterations, modifications or adjustments may damage your Airsoft gun, make it unsafe to shoot, and will void all warranty claims.

### Store Your Gun Safely

Always store the Airsoft gun in a safe place, and out of the reach of children. Always transport the Airsoft gun in a carrying case. Never display the Airsoft gun in a public place. Keep the safety engaged, and remove the magazine before storing the Airsoft gun.

**NOTE: IT IS YOUR RESPONSIBILITY TO TAKE EVERY REASONABLE PRECAUTION TO ENSURE THE SAFE STORAGE AND TRANSPORTATION OF YOUR AIRSOFT GUN.**

### Orange Tip

The orange tip on Airsoft guns helps Law Enforcement distinguish between the replica guns from their real firearm counterparts. Altering the coloration or markings required by state or Federal law so as to make the product look more like a firearm is dangerous and may be a crime. Operator assumes all risks and responsibility when doing so.

### Hazards of Being Mistaken for a Real Firearm

Airsoft guns have been mistaken by Police and Law Enforcement as real firearms. A confrontation with law enforcement while carrying an Airsoft gun can result in serious injury or even death. It is strongly advised to operate the Airsoft gun at a safe and legal location. In the event that you are approached by Law Enforcement personnel, you must comply with their instructions immediately to avoid an incident.

### Alcohol, Medications and Drugs

Do not handle or operate your Airsoft gun while under the influence of alcohol, medication, or drugs.

### Your Responsibility

Your Airsoft gun is well-engineered and manufactured to the highest standards. It was carefully inspected before it was packaged and shipped from our factory. Its safe use depends on you alone. You are the ultimate safety device. Like many other devices, your Airsoft gun is safe unless handled in an irresponsible or uneducated manner.



## SPECIFICATIONS

### CQR MOD1

- Overall Length (Retracted) = 77.47 cm (30.5")
- Overall Length (Extended) = 85.73 cm (33.75")
- Outer Barrel Length = 38.1 cm (15")
- Inner Barrel Length = 395 mm
- Inner Barrel Diameter = 6.05 mm
- Weight = 2.77 kg (6.16 lbs)
- Barrel Thread = 14 mm Negative
- Caliber = 6 mm
- Magazine Capacity = 120 rounds
- Rate of Fire = 20+ RPS
- Velocity = 104-107 MPS (340~350 FPS)
- Energy Output with 0.20g BB = 1.07 Joules
- Power Source = 9.6v NiMh, 7.4v or 11.1v 15c Li-po/Li-Fe

### Special Features:

- KWA 2GX Gearbox
- KWA 2G High Performance Bucking
- Fiber reinforced handguard with battery compartment
- Full metal alloy flat top receiver
- Polymer lower receiver
- Adjustable front and rear sights
- 6 position collapsible stock
- Semi and Full Auto selective fire
- Adjustable Hop-up

### CQR MOD2

- Overall Length (Retracted) = 67.31 cm (26.5")
- Overall Length (Extended) = 75.65 cm (29.75")
- Outer Barrel Length = 28.3 cm (11.14")
- Inner Barrel Length = 273 mm
- Inner Barrel Diameter = 6.05 mm
- Weight = 2.64 kg (5.81 lbs)
- Barrel Thread = 14 mm Negative
- Caliber = 6 mm
- Magazine Capacity = 120 rounds
- Rate of Fire = 20+ RPS
- Velocity = 104~107 MPS (340~350 FPS)
- Energy Output with 0.20g BB = 1.07 Joules
- Power Source = 9.6v NiMh, 7.4v or 11.1v 15c Li-po/Li-Fe

### Special Features:

- KWA 2GX Gearbox
- KWA 2G High Performance Bucking
- Fiber reinforced handguard with battery compartment
- Full metal alloy flat top receiver
- Polymer lower receiver
- Adjustable front and rear sights
- 6 position collapsible stock
- Semi and Full Auto selective fire
- Adjustable Hop-up



\*Individual test results may vary depending on brand of BBs, and chronograph used.



### FUNCTIONS AND FEATURES

The KWA CQR (Close Quarter Rifle) Series is designed for users who require a high performance AEG for close quarter use. The CQR series utilizes KWA's time proven 2GX gearbox design. With a track record of reliability and performance, the 2GX gearbox is the ideal choice to power the CQR series.

Due to velocity limits at indoor arenas, the CQR series is designed to fire at 330-350 FPS, maximizing safety during close quarter engagements. The lower receiver of a CQR series are constructed with fiber reinforced polymers to save weight. The upper receiver and barrel assemblies are made with proprietary metal alloys to minimize flex and maximize strength.

### PACKAGE CONTENTS

- 1 CQR MOD1/CQR MOD2 Airsoft Gun
- 2 Allen Wrenches (For cap screw removal)
- 1 Safety Cap
- 1 Sight Adjustment Tool
- 1 Cleaning Rod
- 1 120 round K120 Polymer Magazine
- 1 Owners Manual



### BREAK-IN PERIOD

Airsoft guns, like many other products require a “break-in” period to ensure optimal performance. This break-in period allows the spring, piston, gears and other moving parts to be seated and become more consistent in their movements. Every new KWA AEG spring is manufactured with more tension than is required. During this break-in period, the spring will settle and operate at the specified FPS range.

The KWA AEG break-in period requires a minimum of 2000 rounds. Initially, the AEG will require additional cleaning due to the expelling of excessive grease. After this period, the AEG will operate within factory specification. The accuracy of the brass inner barrel will improve with continued use.



## LOADING MAGAZINE

1. Release the magazine from the Airsoft gun by pressing the magazine release button.
2. Feed the BBs into the magazine through the magazine feed lip as shown.

**NOTE:** The use of a BB loader, such as the KWA High Performance BB Loader, can help make the loading process fast and easy.

### Loading safety tips:

- Switch the selector to safe
- Be sure the safety cap is on
- Keep your finger off the trigger at all times



**WARNING:** Always use high quality 6mm BBs, weighing 0.2g or higher. For best result use 0.25g KWA Perfect BBs. Never use recycled or low grade BBs to prevent damage to your gun.

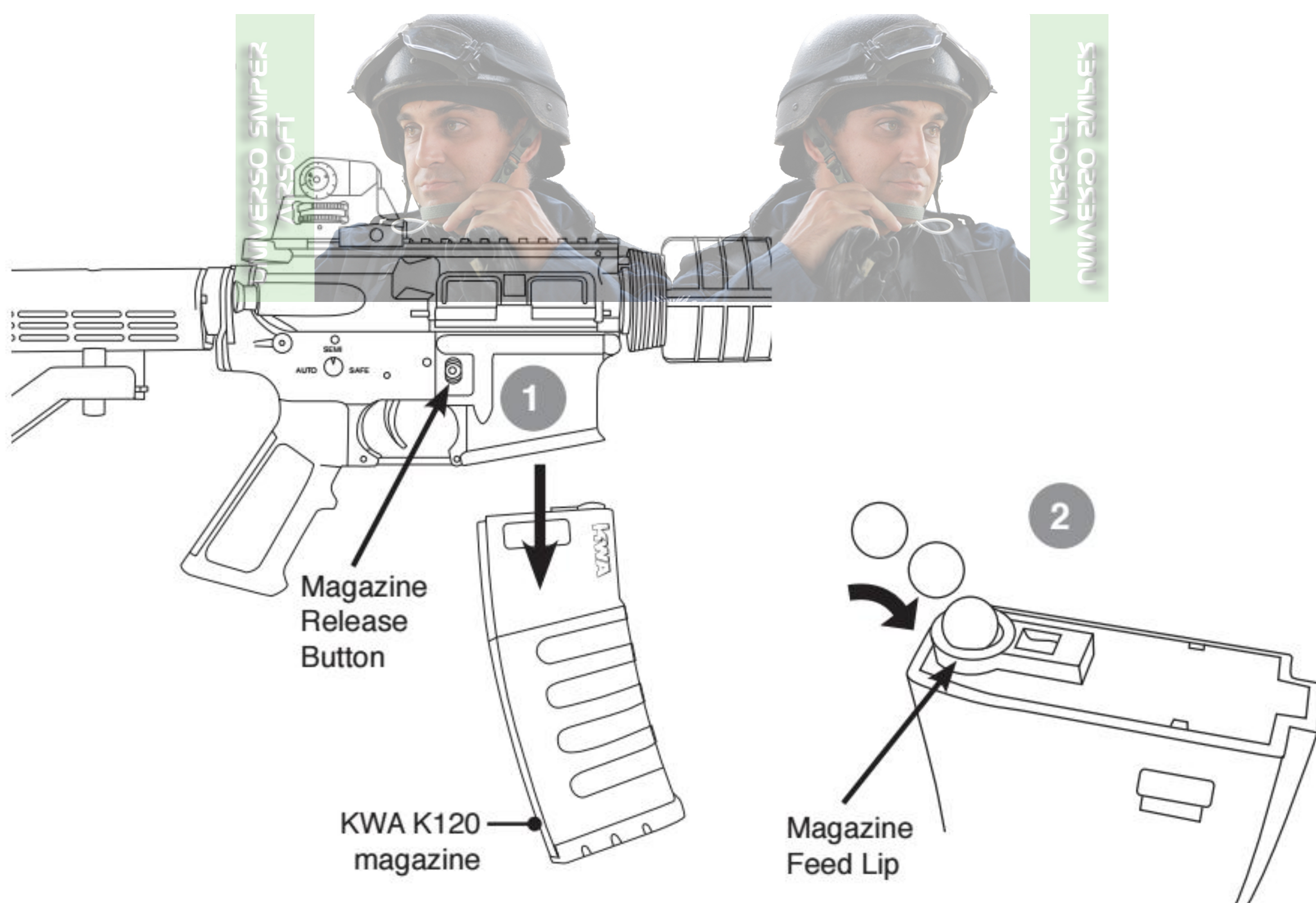

**WARNING:** KWA K120 magazine holds 120 rounds of BBs. DO NOT load more than 120 rounds into the magazine. Overloading will cause jamming and feeding issues.



## USING KWA HIGH PERFORMANCE BB LOADER

1. Release the magazine from the Airsoft gun by pressing the magazine release button.
2. Slide open the trap door on top of the BB loader. Fill the BB loader with BBs. \*Do Not Overfill.
3. Flip down the dust cover to reveal the loading nozzle.
4. Fit BB loader into the magazine feed lip.
5. Press on BB loader plunger to load BB into magazine.

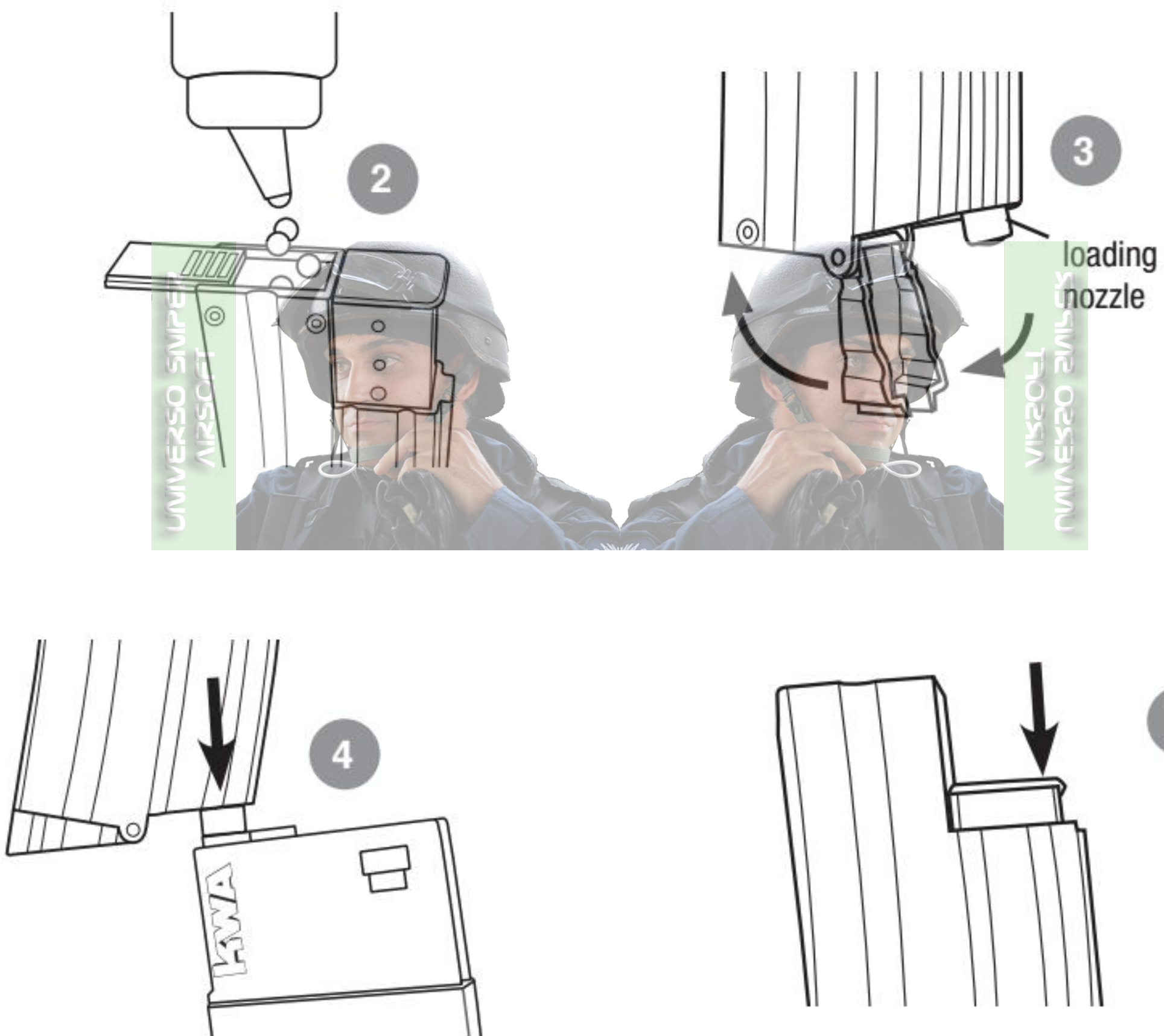

**WARNING:** Always use high quality 6mm BBs, weighing 0.2g or higher. For best result use 0.25g KWA Perfect BBs. Never use recycled or low grade BBs to prevent damage to your gun.



## FIRE SELECTOR SWITCH

### 1. Safe

In Safe mode the gun will not fire. For safety reasons, you should keep the switch in Safe mode at all times when you are not ready to fire.

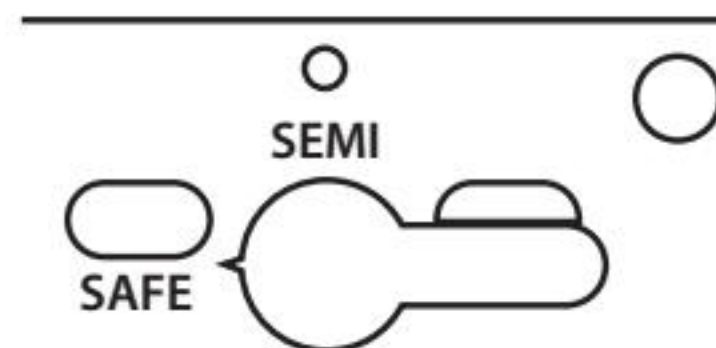

### 2. Semi-Auto

In Semi-Auto mode the gun will fire one shot for each time you squeeze the trigger.

UNIVERSO SNIPER  
AIRSOFT

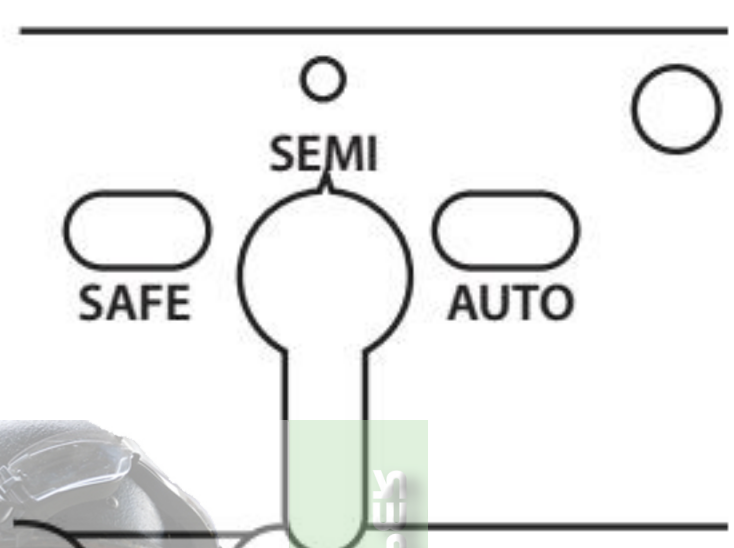

### 3. Full Auto

In Full Auto mode the gun will fire continuously as long as the trigger is depressed.

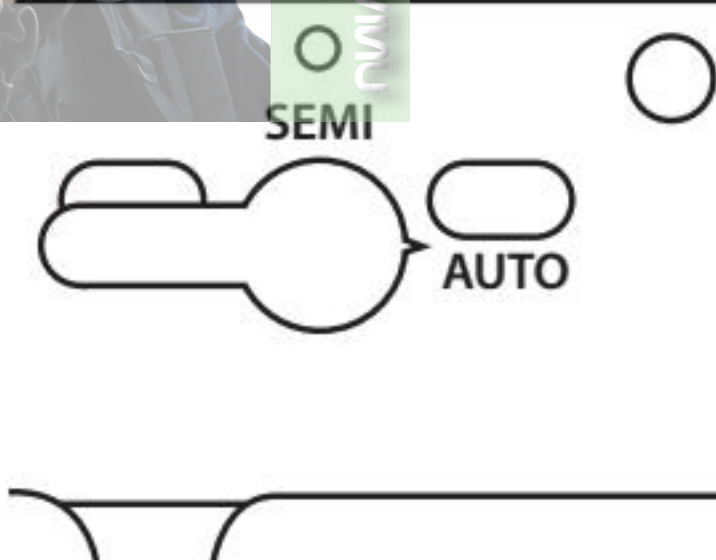

**WARNING:** Do not squeeze the trigger when switching the fire selector.



## BATTERY INSTALLATION

1. Set the fire selector to safe mode. Place the safety cap on the barrel end. Slide the retaining ring back and remove the lower part of the hand guard.
2. Place the battery into the lower half of the hand guard. Push the connector plugs together firmly until they click into place.
3. Replace the lower battery cover and slide the retaining ring back into place.

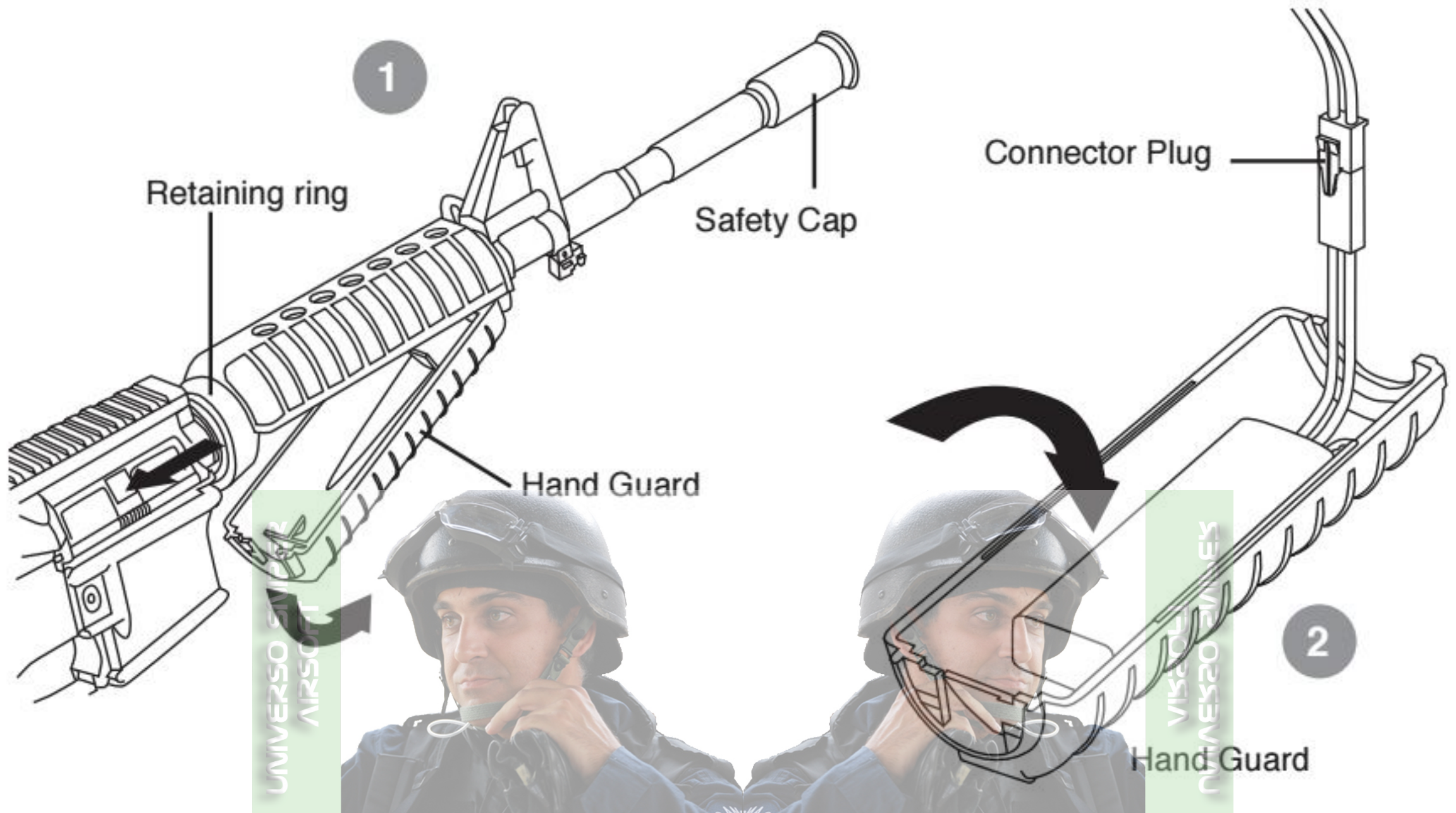

**WARNING:** Using any battery larger than an 11.1v 15c 1800mah Lipo battery can cause damage to the internals.

## FUSE

To replace the fuse, open the hand guard by following the same procedure as the battery installation. Open the fuse assembly and replace the fuse with a 20A glass fuse.

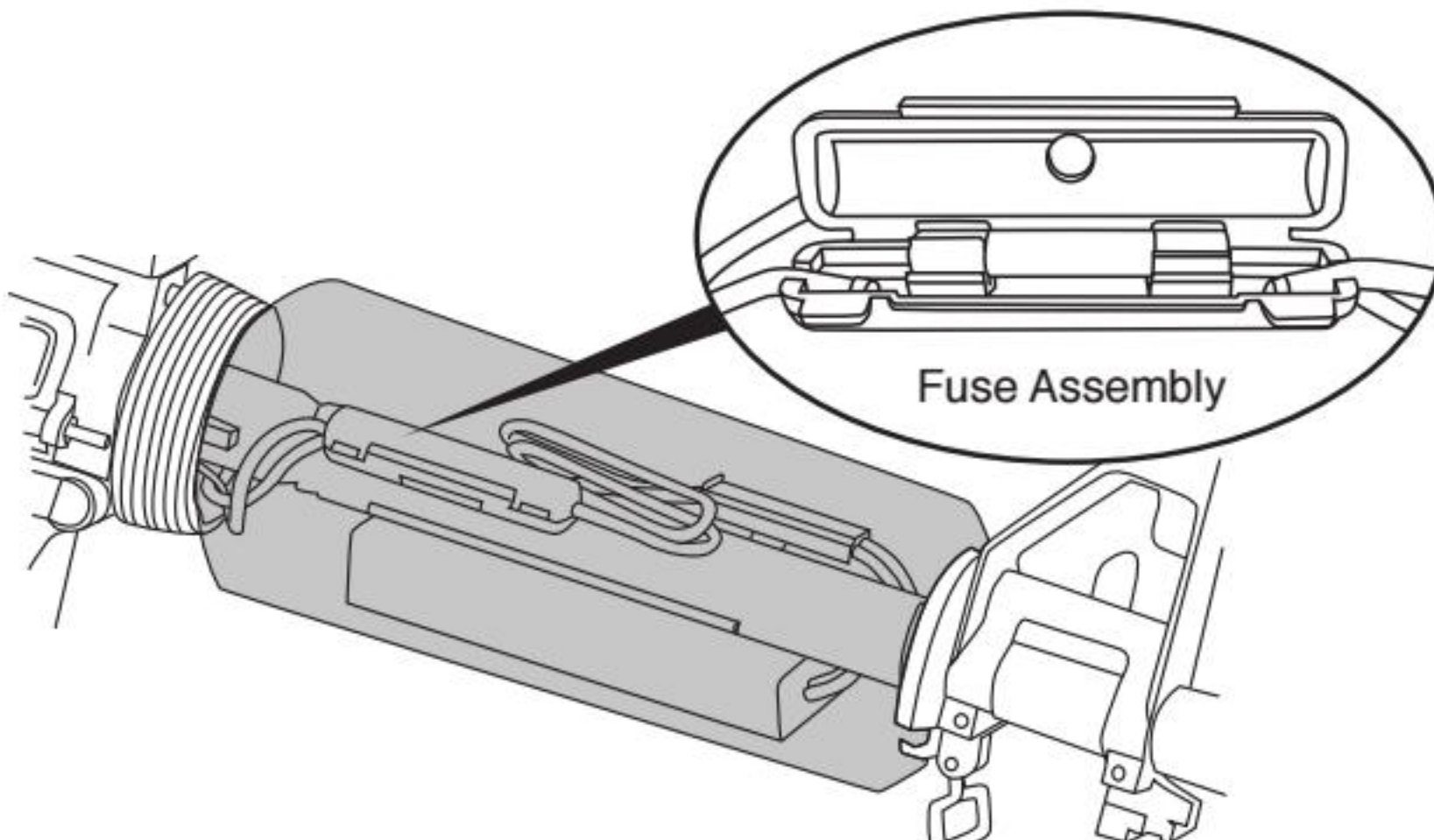



## HOP-UP SYSTEM

The Hop-Up device is one of KWA's standard features, giving Airsoft BBs greater stability, further travel and increased accuracy. Airsoft BBs are light-weight and can be affected by wind when fired. With the Hop-Up system, the trajectory of the Airsoft BBs can be adjusted according to the shooting environment or surroundings.

### HOP-UP ADJUSTMENT

- Pull the charging handle to the rear, the ejection port will exposing the Hop-Up adjustment dial. Pull and hold charging handle to the rear when adjusting Hop-Up.
- Turn the Hop-Up adjustment dial forward to increase hop-up. Turn the Hop-Up adjustment dial backward to decrease hop-up.
- Excessively turning of Hop-Up adjustment dial forward can cause Airsoft BBs to jam. Continued firing with a jammed barrel will cause damage to the gearbox.
- When jamming occurs, immediately stop shooting and turn the Hop-Up adjustment dial backward to decrease hop. Remove jammed Airsoft BBs.

Before removing jammed Airsoft BBs, be sure to return the hop-up adjustment dial to normal position. After removal of Airsoft BBs, test fire 2 – 3 rounds to check for clearance. Resume adjustment. KWA Airsoft guns are made with precision barrel, use only new, high quality Airsoft BBs. The use of recycled or low quality Airsoft BBs are the primary cause of jamming. In most cases, it can severely damage the gearbox and inner barrel.

**Excessive Hop** – Airsoft BB travels an upward trajectory path. Turn Hop-Up adjustment dial backward to decrease hop-up.

**Perfect Hop** – Airsoft BB travels long distance horizontally.

**Inefficient Hop** – Airsoft BB travels a downward trajectory path. Turn Hop-Up adjustment dial forward to increase hop.

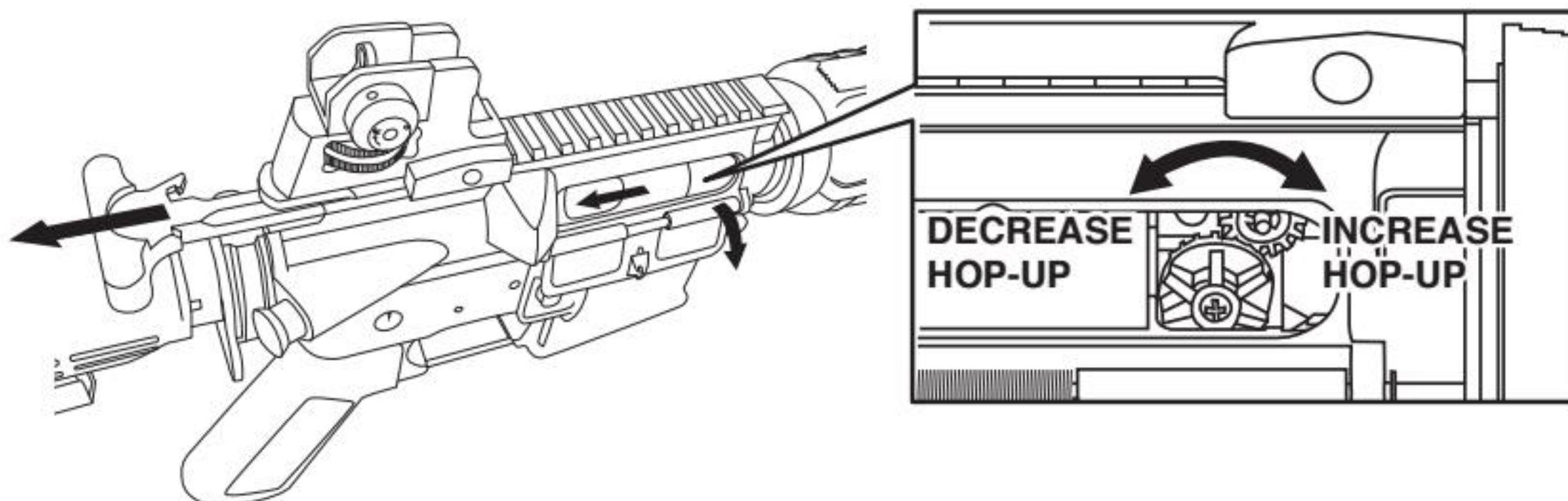



## FRONT AND REAR SIGHT ADJUSTMENT

### FRONT SIGHT ADJUSTMENT

- The front sight can be moved up and down when zeroing the rifle.
- Turn counter clockwise to lower the point of Impact
- Stop turning when a click sound is heard

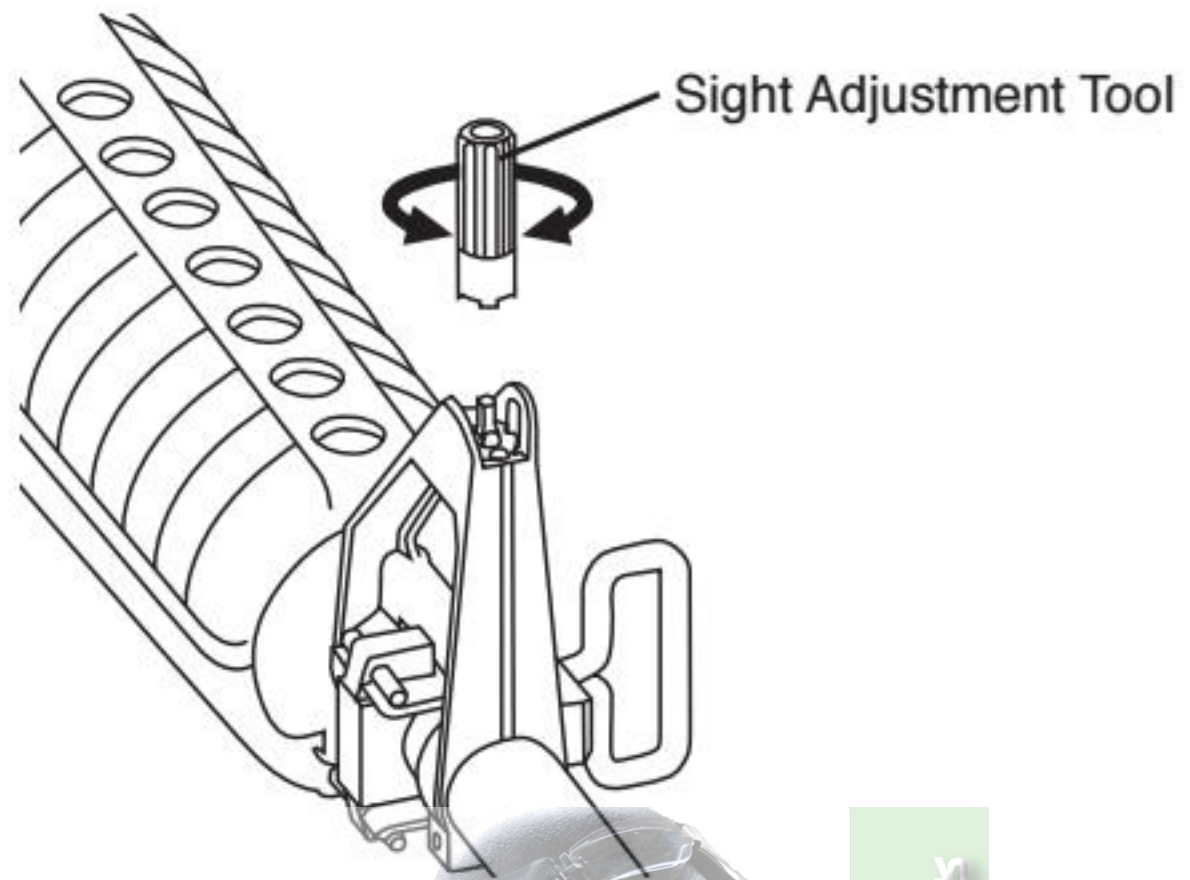

**WARNING!** If turned too far, the front sight will come off.

### REAR SIGHT ADJUSTMENT

- Flip the rear sight between general and precision aiming
- To adjust the horizontal point of impact, rotate the windage knob located on the rear of the sight
- To adjust the vertical point of impact, rotate the sight elevation knob located on the left and right side of the sight

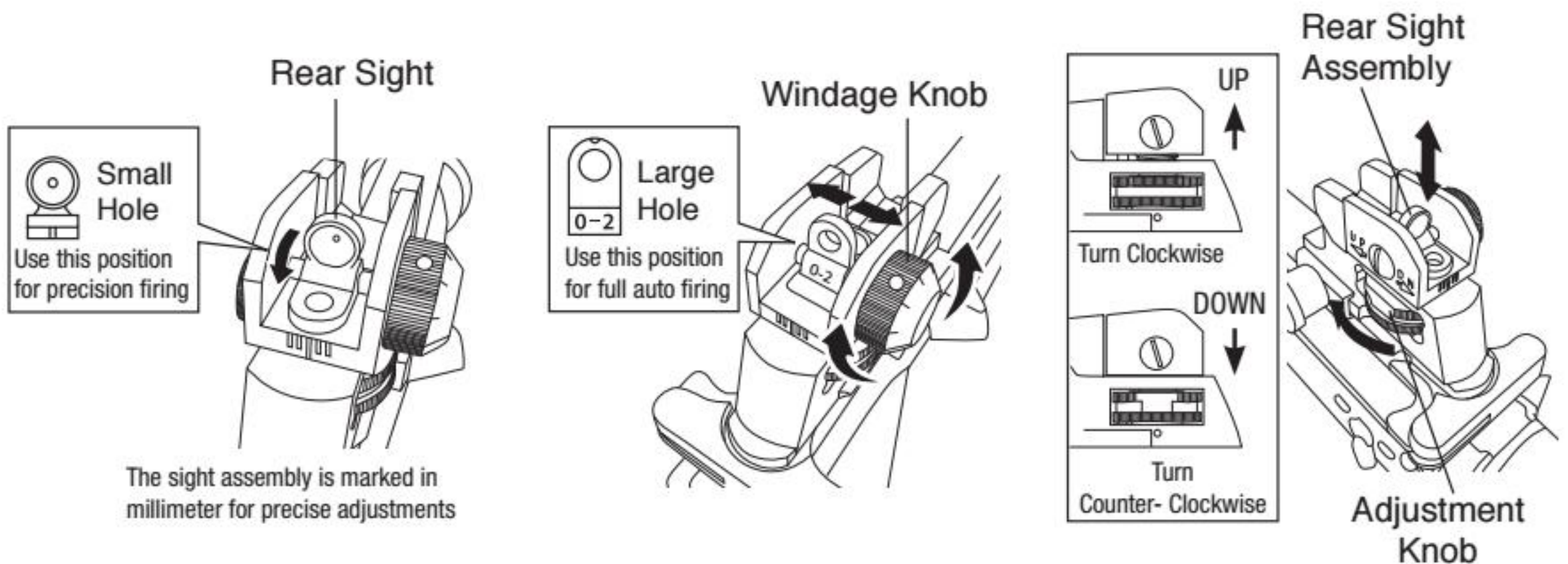



## DISASSEMBLY



**WARNING:** Before removing any parts, be sure the fire selector is set to “SAFE”. Always place safety cap on the barrel tip when servicing your gun.

**Note:** Before opening the receiver, the piston must be in the forward position.

1. Shoot in semi-automatic mode 2-3 times to clear the barrel and reset the piston.
2. Remove the Rear Pin only from lower receiver with the provided Allen wrenches.
3. Use 1 wrench to hold the cap screw and one to turn the set pin.
4. After removal of the cap screw, use the allen wrench to push the pin out.
5. Pull the Upper receiver up.
6. Slide out the inner barrel with Hop-Up assembly.

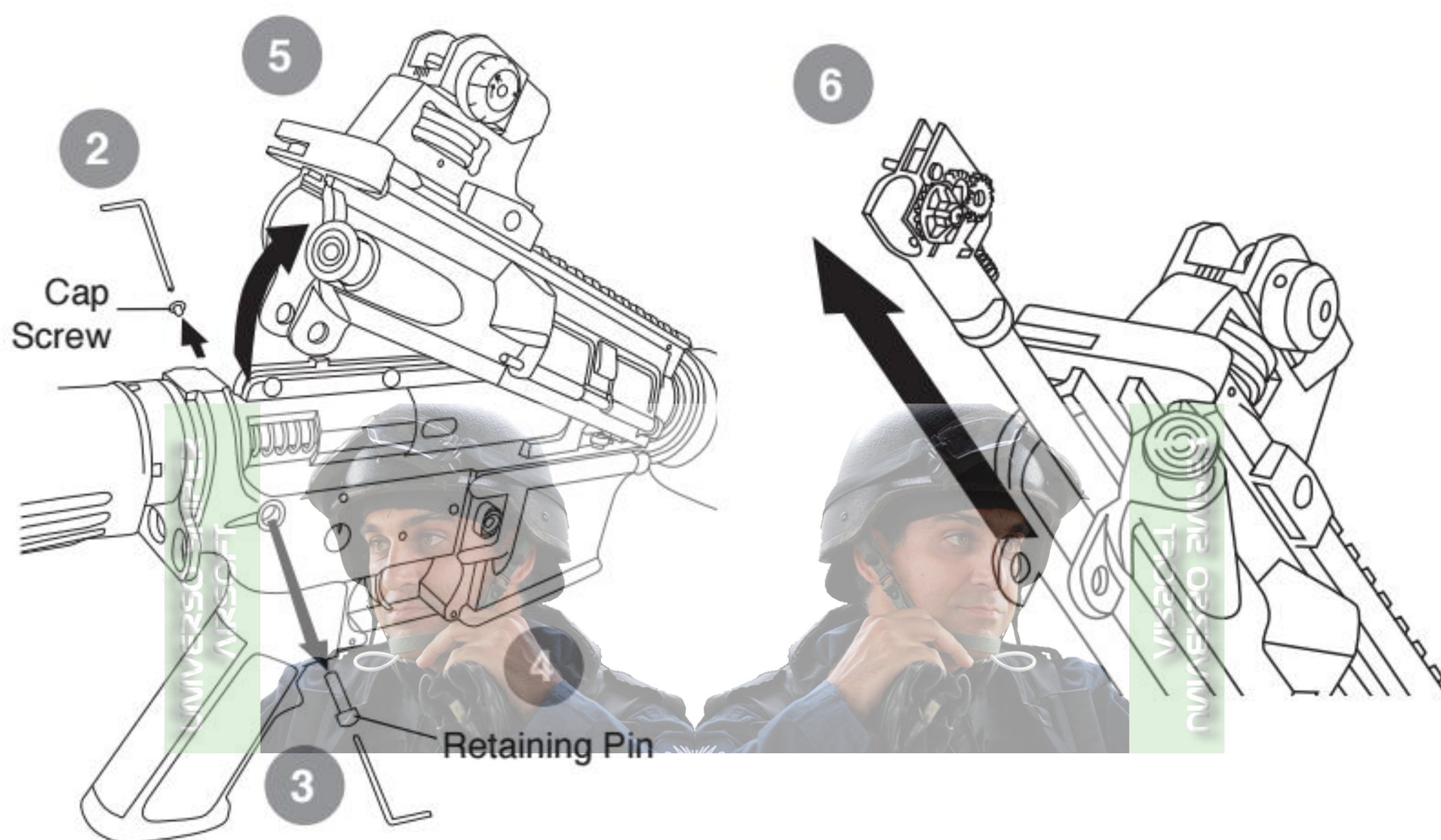

If the receiver does not open, repeat step 1 as necessary.

## ASSEMBLY

1. Insert the inner barrel and Hop-Up assembly into the upper receiver.
2. Secure the Hop-Up assembly into the upper receiver. Push down the upper receiver to close.
3. Align the pin holes. Insert Pin and use the allen wrench to tighten the cap screw.

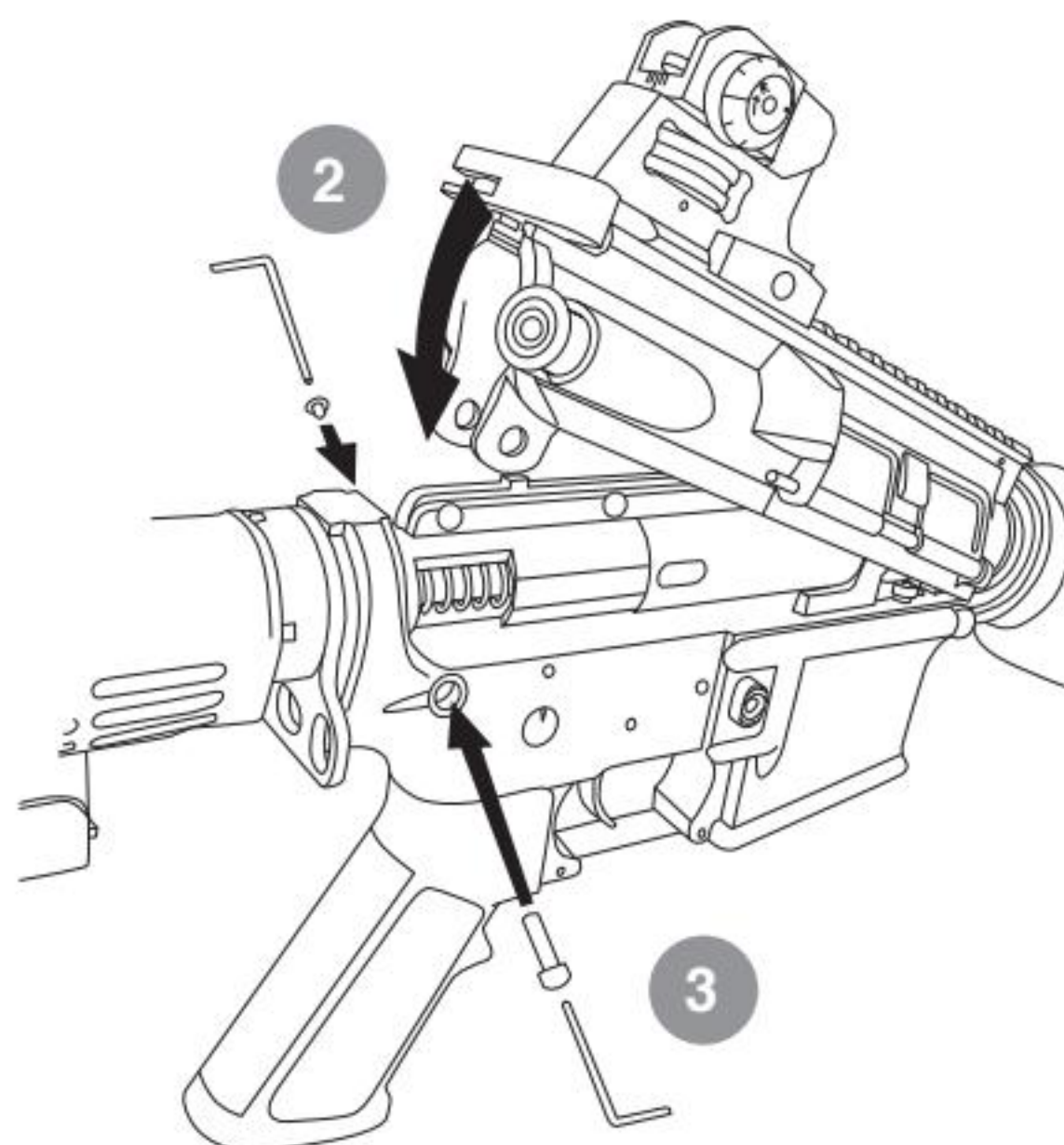



## CLEANING



**WARNING! Unload and clear the Airsoft gun before cleaning.**

### Cleaning Procedure

The Airsoft gun barrel should be cleaned after each shooting session. Regular cleaning prevents the effects of BB residue buildup that can hinder performance or jam the gun.

1. Ensure that the safety is engaged
2. Remove the magazine and clear the chamber of loaded BBs
3. Disable Hop-Up by dialing to the OFF position (see Hop-Up section)
4. Disassemble the receiver (see Disassembly section)
5. Steps to use cleaning rod:
  - a. Cut a piece of clean cotton cloth to 1 inch by 0.5 inch size. Insert one end of the cloth into the hole in the cleaning rod (adjust the length of cloth for smooth entry into the barrel)
  - b. Wind the cloth around the cleaning rod
  - c. Insert the cleaning rod into the inner barrel, and push the rod through.
  - d. Remove the cleaning rod and check the cotton cloth for dirt. Repeat steps a. through c. when necessary.

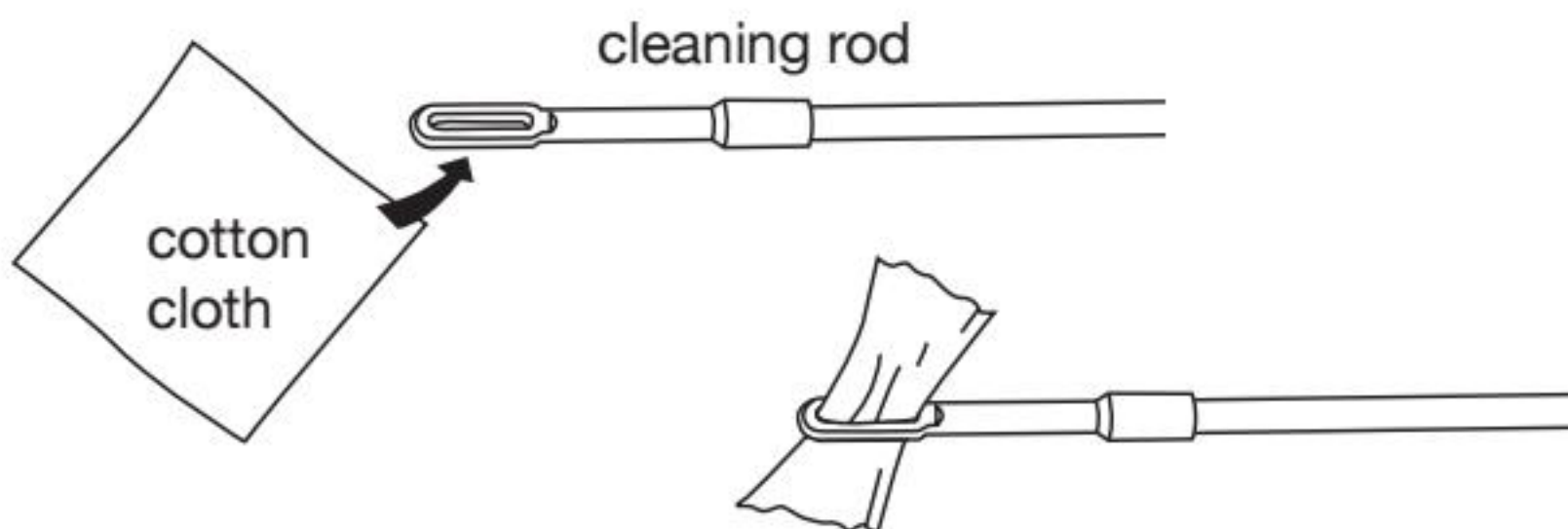

**WARNING! DO NOT use spray silicone oil as a cleaning solution for the inner barrel.**



## BASIC TROUBLESHOOTING FOR RIFLE

SYMPTOMS	CAUSE	SOLUTIONS
Air Soft gun is not firing	Selector set to Safe Mode	Select Semi-Auto or Full-Auto Mode
	Dead battery	Replace or Charge battery
	Burned out fuse	Replace with a new fuse
	Motor damaged or bad connection	Return gun for professional care
	Pinched wiring	Return gun for professional care
Motor is running but not firing	Internal failure	Return gun for professional care
Motor or Battery is hot after short use	Pinched wiring	Return gun for professional care
	Motor damaged or bad connection	Return gun for professional care
Semi-Auto feature not functioning properly	Incorrect timing	Set selector to full-auto mode. Dry fire 10-20 rounds before returning it to semi-auto mode
Semi-Auto feature not functioning at all	Internal failure	Return gun for professional care
Firing cycle slows down	Weak battery	Recharge battery
High pitch or grinding noise	Gear may be damaged or Motor level not adjusted	Return gun for professional care
BB travels upward	Excessive hop	Turn hop adjustment dial backward
BB travels downward	Insufficient hop	Turn hop adjustment dial forward
BB double feeding or rolling out of the barrel	Excessive oil in chamber	Fire 200 rounds to eliminate excessive oil
	Hop-Up unit is contaminated	Clean Hop-Up unit with supplied cleaning rod
	Hop-Up unit may be damaged	Return gun for professional care
Hop-Up unit can't be adjusted	Damaged adjustment dial or internal parts	Return gun for professional care
Inner barrel is jammed	Use of recycled or low quality BBs	Use KWA Perfect BBs or other high quality BBs
	Inner barrel is contaminated	Clean inner barrel with supplied cleaning rod
	Inner barrel is damaged	Return gun for professional care
Hi-cap magazine not feeding	Magazine has not been wound.	Wind wheel underneath magazine
	BBs are lodged inside the magazine	Shake or tap magazine to unclog the BBs
	Internal failure	Return gun for professional care



## OPERATING UNDER UNUSUAL CONDITIONS

Unusual conditions are defined as any condition requiring special maintenance. Perform maintenance outlined for the climate similar to your operational area

### **Extreme Cold:**

Operating an Airsoft gas gun in extremely cold temperatures is not recommended. Cold temperature will cause the Hop-Up Bucking to harden, reducing its effectiveness or cause the gearbox shell to fracture during operation, rendering the gun inoperable.

### **Extreme Heat:**

Do not keep Airsoft gun and batteries under direct sunlight for long periods of time.

### **Dust or Sand:**

Dust or sand can get into a gun and cause malfunctions and/or excessive wear. Keep the gun covered whenever possible. Use lubricant sparingly, as lube naturally attracts dirt and other particles. After use in a dusty area, always field strip the gun (refer to Disassembly Section) and clean any areas you can reach with a soft, lint-free cloth.

### **Heavy Rain:**

Keep the gun out of the rain and water. This will prevent electrical failure and fluid build-up inside the mechbox. Dry gun completely with clean cloth and clean inner barrel if necessary.

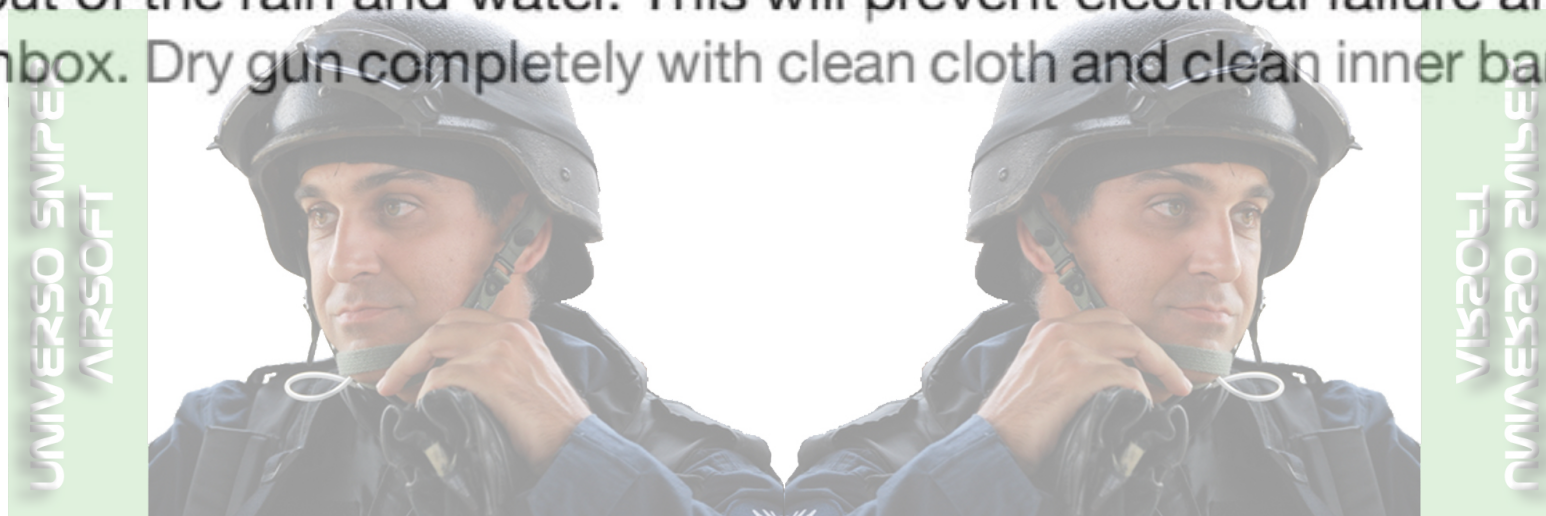







CQR MOD1 DIAGRAM

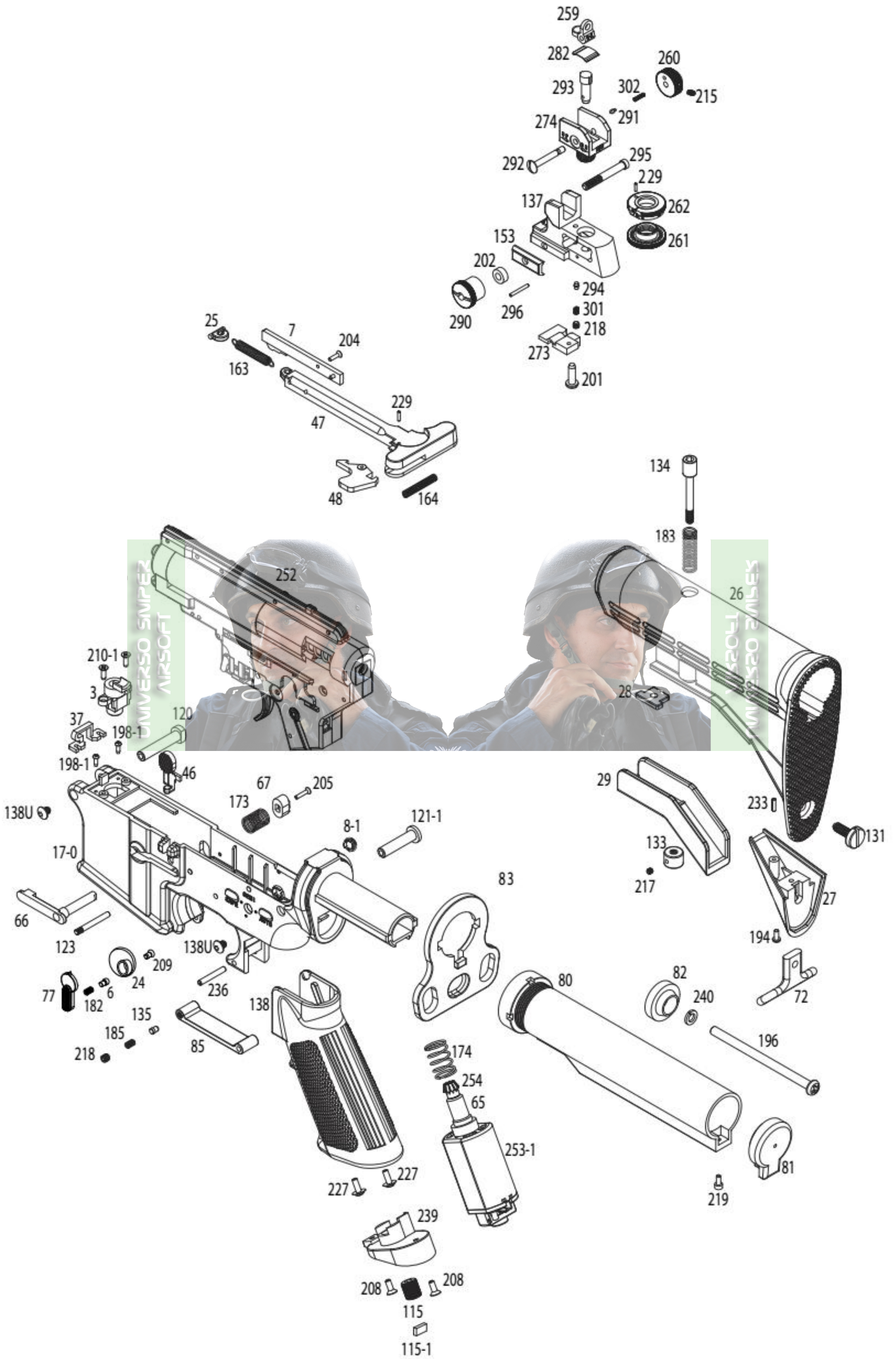



## CQR MOD1 PARTS LIST

Parts #	Description	Parts #	Description	Parts #	Description
CQR MOD1-1-1	Forward Assist Button	CQR MOD1-125	Hop-Up Bar Pin	CQR MOD1-237	Barrel Base Pin
CQR MOD1-2	Barrel Clamp	CQR MOD1-126	Inner Barrel	CQR MOD1-239	Motor Base Plate
CQR MOD1-3	BB Ramp	CQR MOD1-127	Hop-Up Chamber Spacer	CQR MOD1-240	Bolt Washer
CQR MOD1-5	Hop-Up Chamber	CQR MOD1-128	Ejection Port Cover Pin	CQR MOD1-242	Pin Retaining Ring
CQR MOD1-6	Selector Lever Plunger	CQR MOD1-131	Swivel Screw	CQR MOD1-243	Hop-Up Spindle Clamp
CQR MOD1-7	Bolt Plate Carrier	CQR MOD1-133	Stock Lever Retainer	CQR MOD1-244	Barrel Nut Lock
CQR MOD1-8-1	Selector Cover	CQR MOD1-134	Stock Lever Pin	CQR MOD1-249-1	Fuse
CQR MOD1-13	Hop-Up Adjustment Wheel	CQR MOD1-135	Trigger Guard Lock Pin	CQR MOD1-250	Power Supply Wire
CQR MOD1-14	Hop-Up Spindle (Large)	CQR MOD1-137	Rear Sight Base	CQR MOD1-252	2GX Gearbox
CQR MOD1-15	Hop-Up Spindle (Small)	CQR MOD1-138	Grip	CQR MOD1-253-1	Motor
CQR MOD1-16	Hop-Up Bar	CQR MOD1-138U	Receiver Pin Screws	CQR MOD1-254	Pinion Gear
CQR MOD1-17	Lower Receiver	CQR MOD1-142	Top Rail Pin	CQR MOD1-257	Lower Handguard
CQR MOD1-19	Ejection Port Cover Lock Plunger	CQR MOD1-153	Rear Sight Clamp Jaw	CQR MOD1-258	Upper Handguard
CQR MOD1-24	Selector Plate	CQR MOD1-158	Hop-Up Cylinder	CQR MOD1-259	Rear Sight Aperture
CQR MOD1-25	Charging Handle Spring Hook	CQR MOD1-159	Hop-Up Bucking	CQR MOD1-260	Windage Knob
CQR MOD1-26	Retracting Stock	CQR MOD1-161	Forward Assist Button Spring	CQR MOD1-261	Elevation Knob Dial Base
CQR MOD1-27	Swivel Cover	CQR MOD1-162	Chamber Block Spring	CQR MOD1-262	Elevation Knob Dial
CQR MOD1-28	Stock Latch Spacer	CQR MOD1-163	Charging Handle Spring	CQR MOD1-263	Inner Barrel Spacer
CQR MOD1-29	Stock Lever	CQR MOD1-164	Charging Handle Latch Spring	CQR MOD1-265	Barrel Assembly Block
CQR MOD1-35	Upper Receiver (Left)	CQR MOD1-165	Flash Hider Spring	CQR MOD1-266	Top Rail
CQR MOD1-36	Upper Receiver (Right)	CQR MOD1-171	Hop-Up Bar Spring	CQR MOD1-267	Delta Ring
CQR MOD1-37	Wire Holder	CQR MOD1-173	Magazine Catch Spring	CQR MOD1-269	Barrel Nut
CQR MOD1-46	Bolt Catch	CQR MOD1-174	Motor Tension Spring	CQR MOD1-273	Rear Sight Base Cover
CQR MOD1-47	Charging Handle	CQR MOD1-175	Ejection Port Cover Spring	CQR MOD1-274	Rear Sight Elevation Base
CQR MOD1-48	Charging Handle Latch	CQR MOD1-176	Ejection Port Cover Lock Spring	CQR MOD1-275	Front Sight Post
CQR MOD1-49	Flash Hider	CQR MOD1-182	Selector Spring	CQR MOD1-276	Front Sight Housing Base
CQR MOD1-65	Motor Spring Base	CQR MOD1-183	Stock Bolt Spring	CQR MOD1-282	Rear Sight Plate Spring
CQR MOD1-66	Magazine Catch	CQR MOD1-185	Trigger Guard Plunger Spring	CQR MOD1-284	Handguard End Cap
CQR MOD1-67	Magazine Catch Button	CQR MOD1-193	Ejection Port Cover Screw	CQR MOD1-285	Inner Barrel Spacer Pin
CQR MOD1-68	Ejection Port Cover	CQR MOD1-194	Swivel Cover Screw	CQR MOD1-286	Outer Barrel-Rear Section
CQR MOD1-69	Ejection Port Cover Lock	CQR MOD1-196	Stock Bolt	CQR MOD1-286-1	Outer Barrel Extension-Front
CQR MOD1-72	Stock Swivel	CQR MOD1-198	Front Swivel Roll Pin	CQR MOD1-287	Gas Tube
CQR MOD1-77	Selector	CQR MOD1-198-1	Wire Clamp Screws	CQR MOD1-290	Rear Sight Knob
CQR MOD1-80	Buffer Tube	CQR MOD1-201	Rear Sight Base Lock Screw	CQR MOD1-291	Windage Knob Plunger
CQR MOD1-81	Buffer Tube Cap	CQR MOD1-202	Rear Sight Knob Spacer	CQR MOD1-292	Rear Sight Windage Screw
CQR MOD1-82	Buffer Tube Retainer	CQR MOD1-203	Barrel Assembly Block Screw	CQR MOD1-293	Rear Sight Elevation Bar
CQR MOD1-83	Receiver End Plate	CQR MOD1-204	Bolt Plate Carrier Screw	CQR MOD1-294	Rear Sight Elevation Plunger
CQR MOD1-85	Trigger Guard	CQR MOD1-205	Magazine Catch Screw	CQR MOD1-295	Rear Sight Bolt
CQR MOD1-88	Rail Retaining Block	CQR MOD1-208	Motor Plate Screws	CQR MOD1-296	2x16mm Roll Pin
CQR MOD1-89	Top Rail Bridge	CQR MOD1-209	Selector Screw	CQR MOD1-297	Front Sight Plunger
CQR MOD1-91	Swivel Front	CQR MOD1-210-1	BB Ramp Screws	CQR MOD1-298	Front Sight Housing Roll Pin
CQR MOD1-101	Bolt Plate	CQR MOD1-215	Windage Knob Set Screw	CQR MOD1-299-4	Barrel Base Washer
CQR MOD1-106	Dust Cover Retainer	CQR MOD1-217	1.5mm Set Screw	CQR MOD1-300	Delta Ring Lock Spring
CQR MOD1-110	Fuse Terminal	CQR MOD1-218	2mm Set Screw	CQR MOD1-301	Rear Sight Elevation Spring
CQR MOD1-114	Flash Hider Washer	CQR MOD1-219	Buffer Tube Screw	CQR MOD1-302	Windage Knob Spring
CQR MOD1-115	Motor Adjustment Screw	CQR MOD1-226	Hop-Up Wheel Screw	CQR MOD1-303	Front Sight Spring
CQR MOD1-115-1	Motor Adjustment Screw Retainer	CQR MOD1-227	Grip Screw		
CQR MOD1-120	Takedown Pin-Front	CQR MOD1-229	1.5x6mm Roll Pin		
CQR MOD1-121-1	Takedown Pin-Rear	CQR MOD1-231	Gas Tube Pin		
CQR MOD1-123	Gear Box Set Pin	CQR MOD1-233	Swivel Cover Pin		
		CQR MOD1-236	Trigger Guard Roll Pin		



# CQR MOD2 DIAGRAM

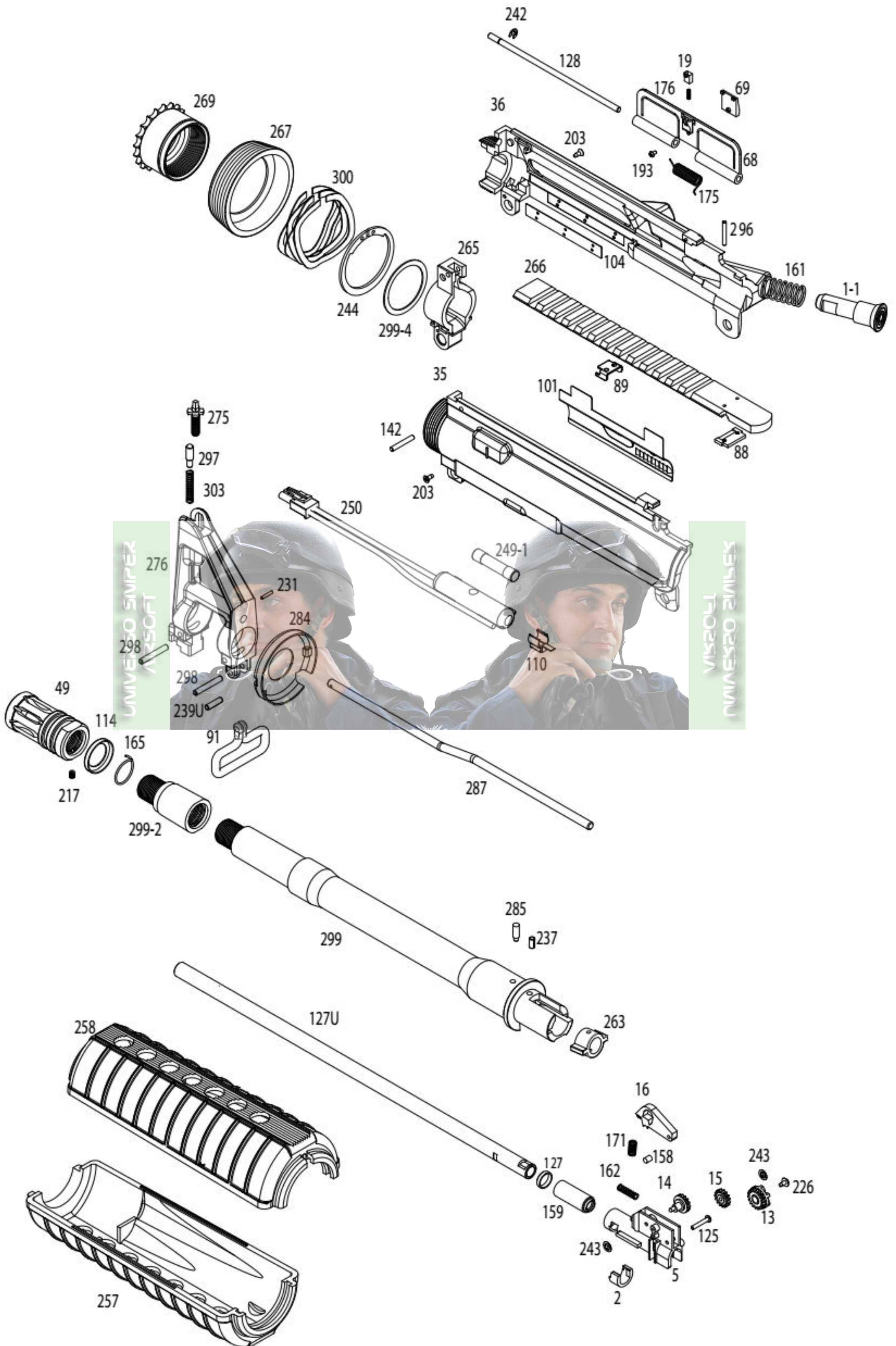







CQR MOD2 PARTS LIST

Parts #	Description	Parts #	Description	Parts #	Description
CQR MOD2-1-1	Forward Assist Button	CQR MOD2-121-1	Takedown Pin-Rear	CQR MOD2-231	Gas Tube Pin
CQR MOD2-2	Barrel Clamp	CQR MOD2-123	Gear Box Set Pin	CQR MOD2-233	Swivel Cover Pin
CQR MOD2-3	BB Ramp	CQR MOD2-125	Hop Up Bar Pin	CQR MOD2-236	Trigger Guard Roll Pin
CQR MOD2-5	Hop-Up Chamber	CQR MOD2-127U	Inner Barrel	CQR MOD2-237	Barrel Base Pin
CQR MOD2-6	Selector Lever Plunger	CQR MOD2-127	Hop Up Chamber Spacer	CQR MOD2-239	Motor Base Plate
CQR MOD2-7	Bolt Plate Carrier	CQR MOD2-128	Ejection Port Cover Pin	CQR MOD2-239U	Front Swivel Roll Pin
CQR MOD2-8-1	Selector Cover	CQR MOD2-131	Swivel Screw	CQR MOD2-240	Bolt Washer
CQR MOD2-13	Hop Up Adjustment Wheel	CQR MOD2-133	Stock Lever Retainer	CQR MOD2-242	Pin Retaining Ring
CQR MOD2-14	Hop Up Spindle (Large)	CQR MOD2-134	Stock Lever Pin	CQR MOD2-243	Hop Up Spindle Clamp
CQR MOD2-15	Hop Up Spindle (Small)	CQR MOD2-135	Trigger Guard Lock Pin	CQR MOD2-244	Barrel Nut Lock
CQR MOD2-16	Hop Up Bar	CQR MOD2-137	Rear Sight Base	CQR MOD2-249-1	Fuse
CQR MOD2-17	Lower Receiver	CQR MOD2-138	Grip	CQR MOD2-250	Power Supply Wire
CQR MOD2-19	Ejection Port Cover Lock Plunger	CQR MOD2-138U	Receiver Pin Screws	CQR MOD2-252	2GX Gearbox
CQR MOD2-24	Selector Plate	CQR MOD2-142	Top Rail Pin	CQR MOD2-253-1	Motor
CQR MOD2-25	Charging Handle Spring Hook	CQR MOD2-153	Rear Sight Clamp Jaw	CQR MOD2-254	Pinion Gear
CQR MOD2-26	Retracting Stock	CQR MOD2-158	Hop Up Cylinder	CQR MOD2-257	Lower Handguard
CQR MOD2-27	Swivel Cover	CQR MOD2-159	Hop Up Bucking	CQR MOD2-258	Upper Handguard
CQR MOD2-28	Stock Latch Spacer	CQR MOD2-161	Forward Assist Button Spring	CQR MOD2-259	Rear Sight Aperture
CQR MOD2-29	Stock Lever	CQR MOD2-162	Chamber Block Spring	CQR MOD2-260	Windage Knob
CQR MOD2-35	Upper Receiver (Left)	CQR MOD2-163	Charging Handle Spring	CQR MOD2-261	Elevation Knob Dial Base
CQR MOD2-36	Upper Receiver (Right)	CQR MOD2-164	Charging Handle Latch Spring	CQR MOD2-262	Elevation Knob Dial
CQR MOD2-37	Wire Holder	CQR MOD2-165	Flash Hider Spring	CQR MOD2-263	Inner Barrel Spacer
CQR MOD2-46	Bolt Catch	CQR MOD2-171	Hop Up Bar Spring	CQR MOD2-265	Barrel Assembly Block
CQR MOD2-47	Charging Handle	CQR MOD2-173	Magazine Catch Spring	CQR MOD2-266	Top Rail
CQR MOD2-48	Charging Handle Latch	CQR MOD2-174	Motor Tension Spring	CQR MOD2-267	Delta Ring
CQR MOD2-49	Flash Hider	CQR MOD2-175	Ejection Port Cover Spring	CQR MOD2-269	Barrel Nut
CQR MOD2-65	Motor Spring Base	CQR MOD2-176	Ejection Port Cover Lock Spring	CQR MOD2-273	Rear Sight Cover Base
CQR MOD2-66	Magazine Catch	CQR MOD2-182	Selector Spring	CQR MOD2-274	Rear Sight Elevation Base
CQR MOD2-67	Magazine Catch Button	CQR MOD2-183	Stock Bolt Spring	CQR MOD2-275	Front Sight Post
CQR MOD2-68	Ejection Port Cover	CQR MOD2-185	Trigger Guard Plunger Spring	CQR MOD2-276	Front Sight Housing Base
CQR MOD2-69	Ejection Port Cover Lock	CQR MOD2-193	Ejection Port Cover Screw	CQR MOD2-282	Rear Sight Plate Spring
CQR MOD2-72	Stock Swivel	CQR MOD2-194	Swivel Cover Screw	CQR MOD2-284	Handguard End Cap
CQR MOD2-77	Selector	CQR MOD2-196	Stock Bolt	CQR MOD2-285	Inner Barrel Spacer Pin
CQR MOD2-80	Buffer Tube	CQR MOD2-198-1	Wire Clamp Screws	CQR MOD2-287	Gas Tube
CQR MOD2-81	Buffer Tube Cap	CQR MOD2-201	Rear Sight Base Lock Screw	CQR MOD2-290	Rear Sight Knob
CQR MOD2-82	Buffer Tube Retainer	CQR MOD2-202	Rear Sight Knob Spacer	CQR MOD2-291	Windage Knob Plunger
CQR MOD2-83	Receiver End Plate	CQR MOD2-203	Barrel Assembly Block Screw	CQR MOD2-292	Rear Sight Windage Screw
CQR MOD2-85	Trigger Guard	CQR MOD2-204	Bolt Plate Carrier Screw	CQR MOD2-293	Rear Sight Elevation Bar
CQR MOD2-88	Rail Retaining Block	CQR MOD2-205	Magazine Catch Screw	CQR MOD2-294	Rear Sight Elevation Plunger
CQR MOD2-89	Top Rail Bridge	CQR MOD2-208	Motor Plate Screws	CQR MOD2-295	Rear Sight Bolt
CQR MOD2-91	Swivel Front	CQR MOD2-209	Selector Screw	CQR MOD2-296	2x16mm Roll Pin
CQR MOD2-101	Bolt Plate	CQR MOD2-210-1	BB Ramp Screws	CQR MOD2-297	Front Sight Plunger
CQR MOD2-104	Dust Cover Retainer	CQR MOD2-215	Windage Knob Set Screw	CQR MOD2-298	Front Sight Housing Roll Pin
CQR MOD2-110	Fuse Terminal	CQR MOD2-217	1.5mm Set Screw	CQR MOD2-299	Outer Barrel-Rear Section
CQR MOD2-114	Flash Hider Washer	CQR MOD2-218	2mm Set Screw	CQR MOD2-299-2	Outer Barrel Extension-Front
CQR MOD2-115	Motor Adjustment Screw	CQR MOD2-219	Buffer Tube Screw	CQR MOD2-299-4	Barrel Base Washer
CQR MOD2-115-1	Motor Adjustment Screw Retainer	CQR MOD2-226	Hop Up Wheel Screw	CQR MOD2-300	Delta Ring Lock Spring
CQR MOD2-120	Takedown Pin-Front	CQR MOD2-227	Grip Screw X 2	CQR MOD2-301	Rear Sight Elevation Spring
		CQR MOD2-229	1.5x6mm Roll Pin	CQR MOD2-302	Windage Knob Spring
				CQR MOD2-303	Front Sight Spring







# CQR SERIES MAGAZINE DIAGRAM AND PARTS LIST

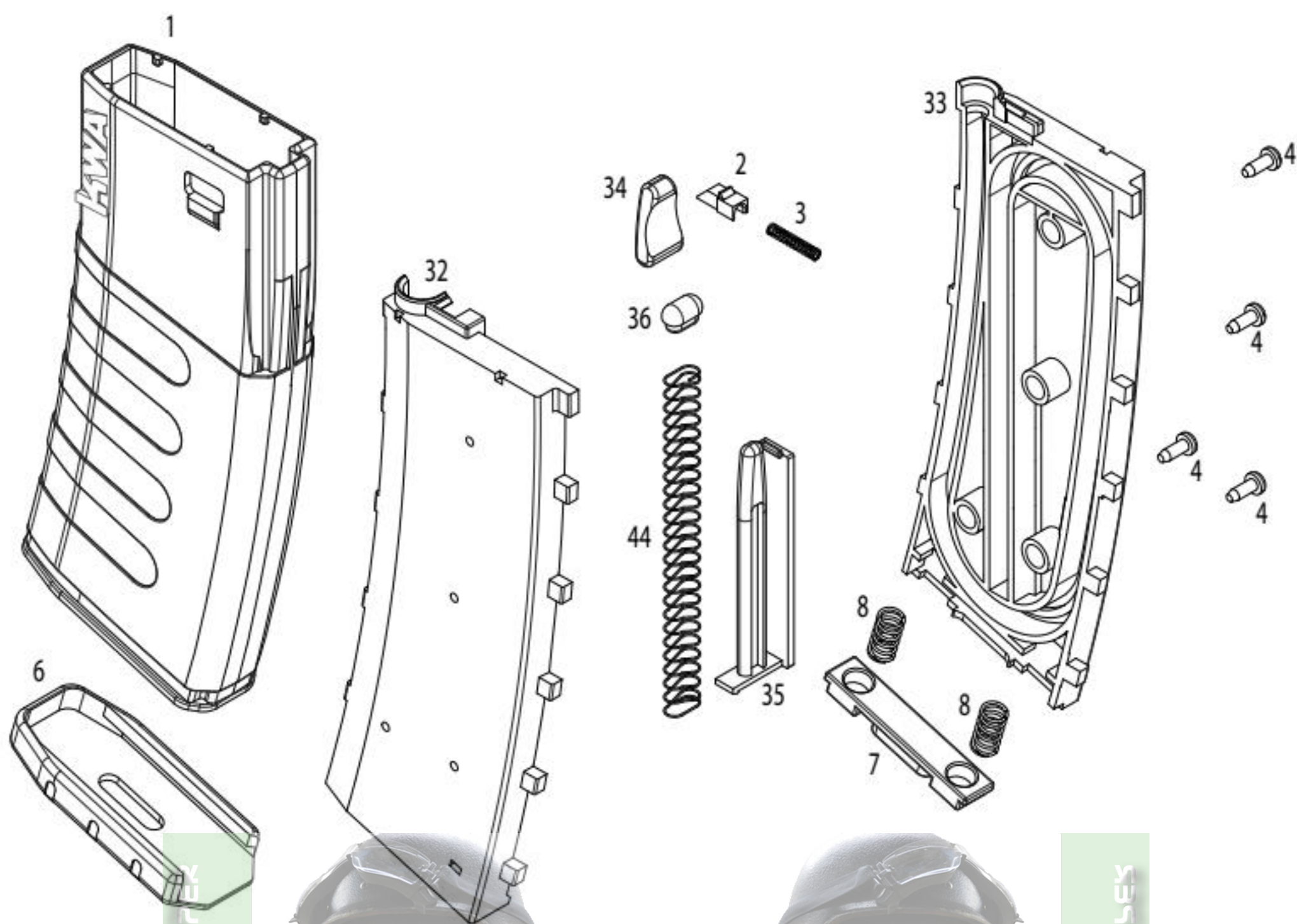

UNIVERSO SMIR EK  
AIRSOFT

UNIVERSO SMIR EK  
AIRSOFT

Parts #	Description
CQR-MG1	MAGAZINE BODY
CQR-MG2	MAGAZINE BB STOP
CQR-MG3	MAGAZINE BB STOP SRPING
CQR-MG4	MAGAZINE HOUSING SCREW
CQR-MG6	MAGAZINE BASE PLATE
CQR-MG7	MAGAZINE BASE PLATE STOP
CQR-MG8	MAGAZINE BASE PLATE SPRINGS

Parts #	Description
CQR-MG32	MAGAZINE HOUSING (LEFT PANEL)
CQR-MG33	MAGAZINE HOUSING (RIGHT PANEL)
CQR-MG34	MAGAZINE FOLLOWER
CQR-MG35	MAGAZINE FOLLOWER GUIDE
CQR-MG36	MAGAZINE FOLLOWER LINK
CQR-MG44	MAGAZINE FOLLOWER SPRING

**KWA Performance Industries, Inc.**

Copyright © April, 2012 KWA Performance Industries, Inc. All Rights Reserved.