

# KWA®

## OPERATOR'S MANUAL



# KM4 COMMANDO

## TABLE OF CONTENTS

Use of this manual.....	2
Safety Guidelines .....	2-3
Specifications .....	4
Package Contents .....	4
Break-in Period.....	4
Loading Magazine .....	5-6
Fire Selector Switch.....	7
Battery & Installation.....	8
Fuse.....	8
Hop-Up System.....	9
Front and Rear Sight Adjustment .....	10
Disassembly and Assembly Procedures .....	11
Cleaning and Lubrication.....	12
Troubleshooting .....	13
Operating Under Unusual Conditions.....	14
Diagram and Parts Lists .....	15-19



## USE OF THIS MANUAL

Before operating the Airsoft gun, read this manual in its entirety. Important safety topics and tips are discussed throughout all of the chapters. It's important that the operator know the principles of gun handling safety and operation prior to firing the Airsoft gun.

## SAFETY GUIDELINES



**WARNING! Failure to follow safety guidelines may result in serious injury.**

### Safety Distance

The effective shooting range is approximately 150 feet. BBs fired from this Airsoft gun may travel further than intended. Make certain that you have an adequate backstop.

### Eye Protection

Eye protection should be worn at all times when both shooting and maintaining your Airsoft gun. Protect your eyes from BBs under spring pressure while performing maintenance on your Airsoft gun.

### Assume Every Gun is Always Loaded

Until you are certain the chamber is empty, treat every gun as if it were loaded. Do not assume the chamber is empty based on your memory or someone else's words. Always remove the magazine and visually check to confirm the chamber is empty.

### Beware of Barrel Obstructions

Ensure the Airsoft gun barrel is free of obstructions before you fire the gun. Even the smallest obstruction such as lubrication or a stuck cleaning patch can cause a misfire or malfunction.

### Muzzle Control

Always keep the muzzle of the gun pointed in a safe direction. Never point the muzzle at a person or object that you do not intend to shoot.

### Keep Your Safety On

Keep the gun's safety on until your sights are aligned on your target and you are ready to fire.

### Keep Your Finger Off The Trigger

Keep your finger off the trigger and out of the trigger guard until your sights are aligned on your target and you are ready to fire.



**WARNING! Airsoft BBs can be a choking hazard. Keep them away from children.**

### SAFETY GUIDELINES

#### Identify Your Target and Backstop

Before you pull the trigger, make certain of your target and what is beyond it. The Airsoft gun should never be fired at surfaces such as rocks, glass, water, or other hard surfaces where BBs are likely to ricochet in unpredictable directions.



**WARNING! Adult supervision is required for any person under the age of 18.**

#### Failure To Fire

If the Airsoft gun fails to fire, misfires, or malfunctions, do not look into the gun barrel. BBs can become lodged into the chamber, and serious eye injury may occur.

#### Maintain Your Gun Properly

Performing proper maintenance, as outlined in this manual, ensures that your Airsoft gun will be safe to shoot and will perform to its designed specifications for many years. Alterations, modifications or adjustments may damage your Airsoft gun, make it unsafe to shoot, and will void all warranty claims.

#### Store Your Gun Safely

Always store the Airsoft gun in a safe place, and out of the reach of children. Always transport the Airsoft gun in a carrying case. Never display the Airsoft gun in a public place. Keep the safety engaged, and remove the magazine before storing the Airsoft gun.

**NOTE: IT IS YOUR RESPONSIBILITY TO TAKE EVERY REASONABLE PRECAUTION TO ENSURE THE SAFE STORAGE AND TRANSPORTATION OF YOUR AIRSOFT GUN.**

#### Orange Tip

The orange tip on Airsoft guns helps Law Enforcement distinguish between the replica guns from their real firearm counterparts. Altering the coloration or markings required by state or Federal law so as to make the product look more like a firearm is dangerous and may be a crime. Operator assumes all risks and responsibility when doing so.

#### Hazards of Being Mistaken for a Real Firearm

Airsoft guns have been mistaken by Police and Law Enforcement as real firearms. A confrontation with law enforcement while carrying an Airsoft gun can result in serious injury or even death. It is strongly advised to operate the Airsoft gun at a safe and legal location. In the event that you are approached by Law Enforcement personnel, you must comply with their instructions immediately to avoid an incident.

#### Alcohol, Medications and Drugs

Do not handle or operate your Airsoft gun while under the influence of alcohol, medication or drugs.

#### Your Responsibility

Your Airsoft gun is well-engineered and manufactured to the highest standards. It was carefully inspected before it was packaged and shipped from our factory. Its safe use depends on you alone. You are the ultimate safety device. Like many other devices, your Airsoft gun is safe unless handled in an irresponsible or uneducated manner.

## SPECIFICATIONS

- Overall Length (Retracted) = 70 cm [27.5"]
- Overall Length (Extended) = 78.5 cm [31"]
- Outer Barrel Length = 283 mm [11.14"]
- Inner Barrel Length = 273 mm
- Inner Barrel Diameter = 6.05 mm
- Weight = 2.89 kg [6.37 lbs]
- Barrel Thread = -14 mm
- Caliber = 6 mm
- Magazine Capacity = 120 rounds
- Rate of Fire = 20+ RPS
- Velocity = 100-107 MPS [330-350 FPS]
- Energy Output with 0.20g BB = 1.14 Joules
- Power Source = 9.6v NiMh, 7.4v or 11.1v 15c Li-po/Li-Fe

## Special Features

- KWA 2GX gearbox
- KWA 2G high performance bucking
- Full metal alloy flat top upper receiver
- Full metal alloy lower receiver
- Adjustable front and rear sight
- Removable rear sight
- 6 position collapsible stock with integrated battery compartment
- Semi and full auto selective fire
- Adjustable hop-up

\*Individual test results may vary depending on brand of BBs, and chronograph used.

## PACKAGE CONTENTS

- 1 KM4 COMMANDO Airsoft Gun
- 2 Allen Wrenches (For cap screw removal)
- 1 Safety Cap
- 1 Sight Adjustment Tool
- 1 Cleaning Rod
- 1 K120 Magazine
- 1 Owners Manual

## BREAK-IN PERIOD

Airsoft guns, like many other products require a "break-in" period to ensure optimal performance. This break-in period allows the spring, piston, gears and other moving parts to be seated and become more consistent in their movements. Every new KWA AEG spring is manufactured with more tension than is required. During this break-in period, the spring will settle and operate at the specified FPS range.

The KWA AEG break-in period requires a minimum of 2000 rounds. Initially, the AEG will require additional cleaning due to the expelling of excessive grease. After this period, the AEG will operate within factory specification. The accuracy of the brass inner barrel will improve with continued use.

## LOADING MAGAZINE

1. Release the magazine from the Airsoft gun by pressing the magazine release button.
2. Feed the BBs into the magazine through the magazine feed lip as shown.

**NOTE:** The use of a BB loader, such as the KWA High Performance BB Loader, can help make the loading process easier and faster.

### Loading safety tips:

- Switch the selector to safe
- Be sure the safety cap is on
- Keep your finger off the trigger at all times



**WARNING:** Always use high quality 6mm BBs, weight 0.2g or higher. For best result use 0.25g KWA Perfect BBs. Never use recycled or low grade BBs to prevent damage to your gun.

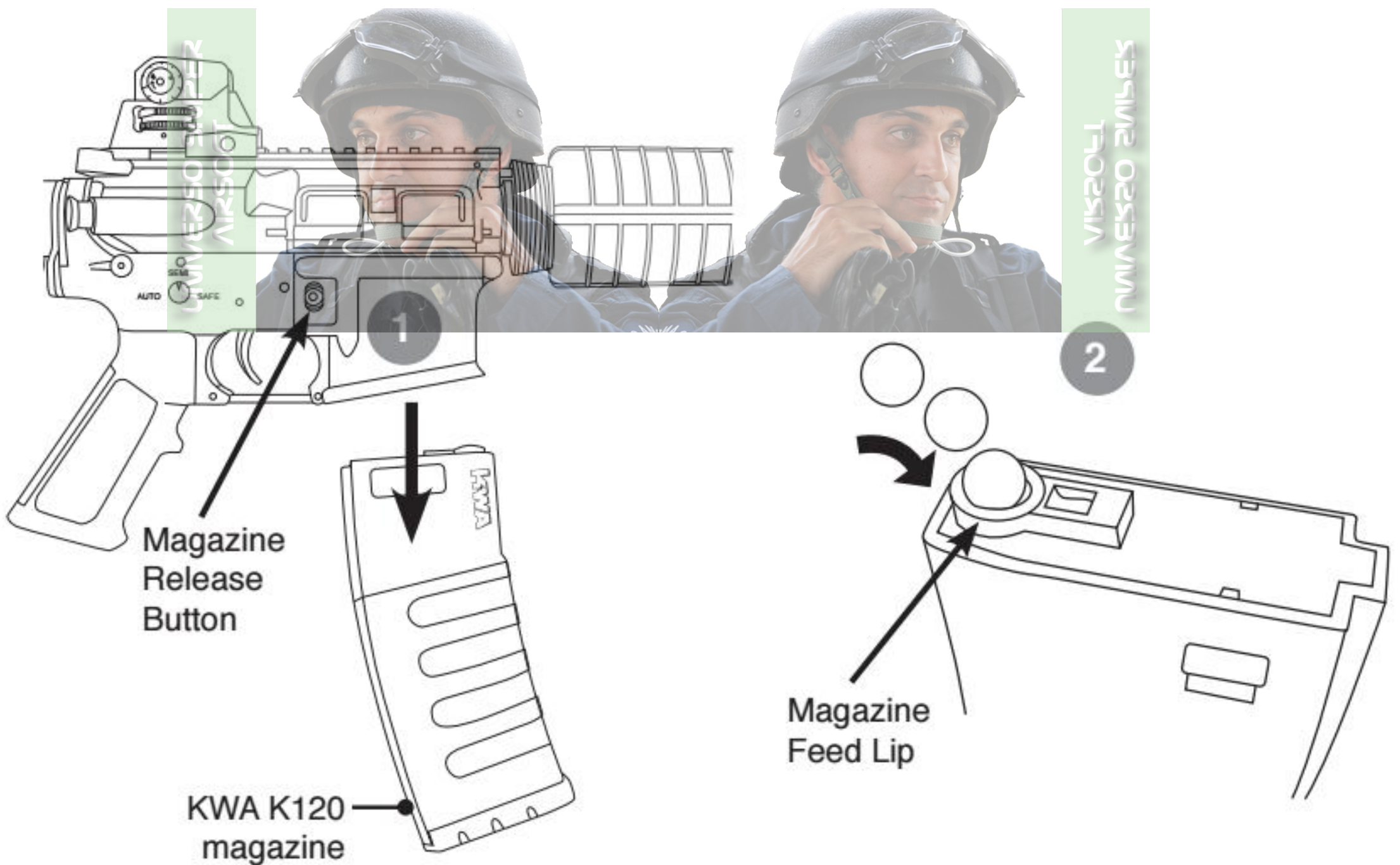

**WARNING:** KWA K120 magazine holds 120 rounds of BBs. DO NOT load more than 120 rounds into the magazine. Overloading will cause jamming and feeding issue.

## USING KWA HIGH PERFORMANCE BB LOADER (Purchase Separately)

1. Release the magazine from the Airsoft gun by pressing the magazine release button.
2. Slide open the trap door on top of the BB loader. Fill the BB loader with BBs. \*Do Not Overfill.
3. Flip down the dust cover to reveal the loading nozzle.
4. Fit BB loader into the magazine feed lip.
5. Press on BB loader plunger to load BB into magazine.

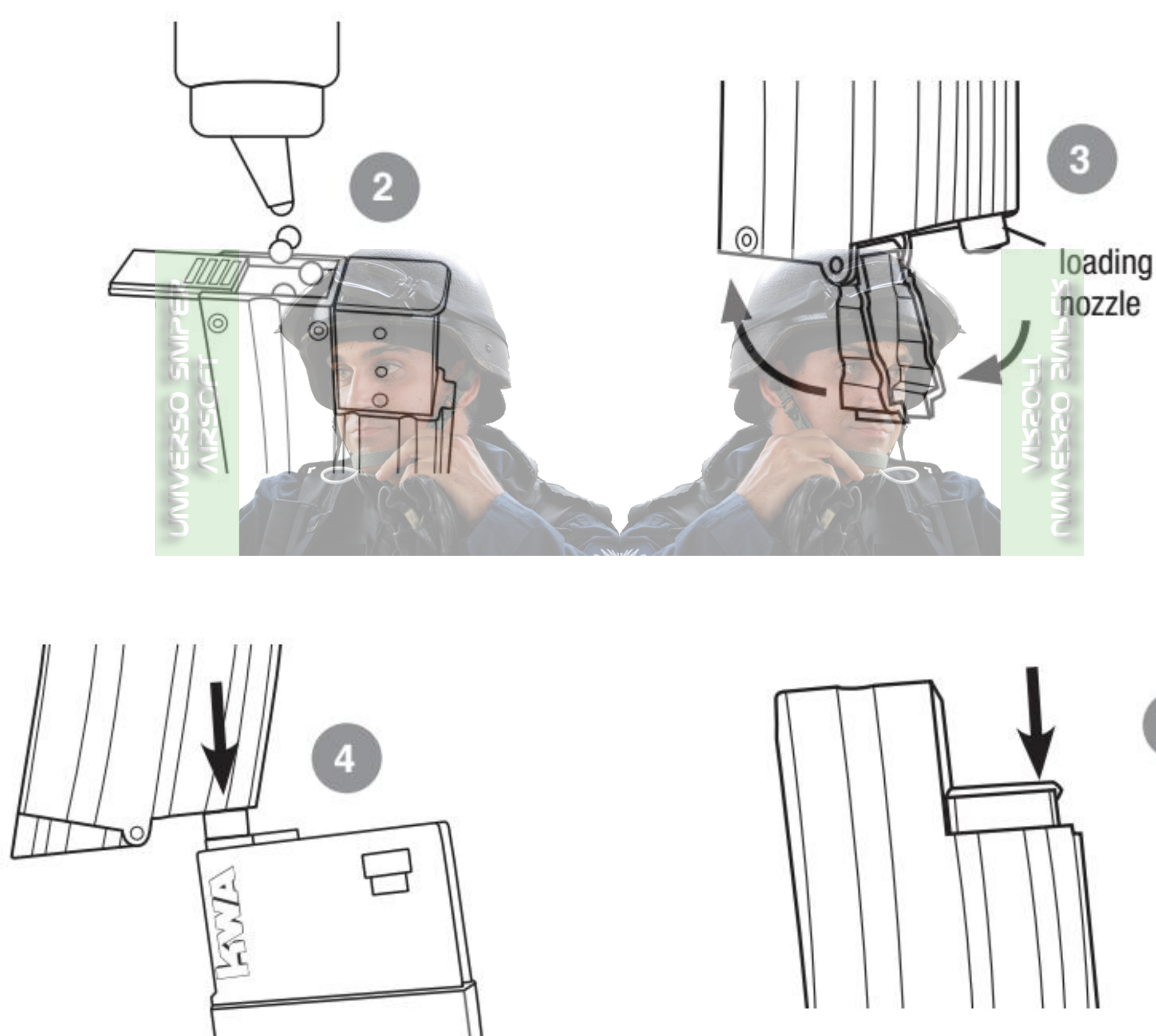

**WARNING:** Always use high quality 6mm BBs, weight 0.2g or higher. For best result use 0.25g KWA Perfect BBs. Never use recycled or low grade BBs to prevent damage to your gun.

## FIRE SELECTOR SWITCH

### 1. Safe

In Safe mode the gun will not fire. For safety reason, you should keep the switch in Safe mode at all times when you are not ready to fire.

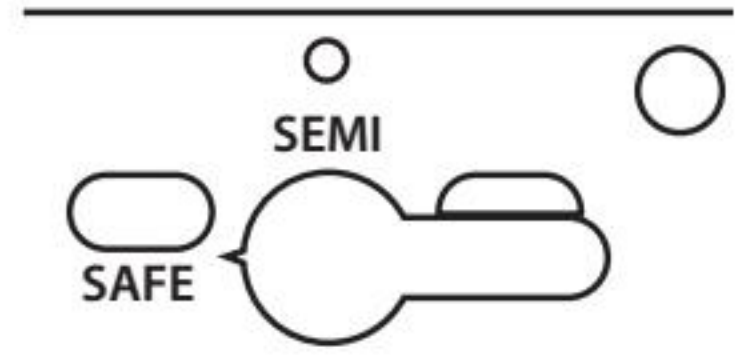

### 2. Semi-Auto

In Semi-Auto mode the gun will fire one shot for each time you pull the trigger.

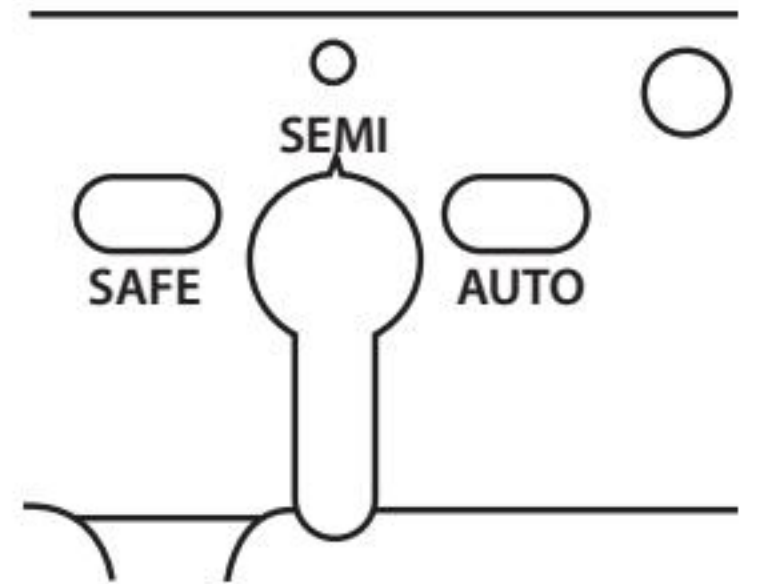

### 3. Full Auto

In this Full Auto mode the gun will fire continuously as long as the trigger is depressed.

UNIVERSO SNIPER  
AIRSOFT



UNIVERSO SNIPER  
AIRSOFT

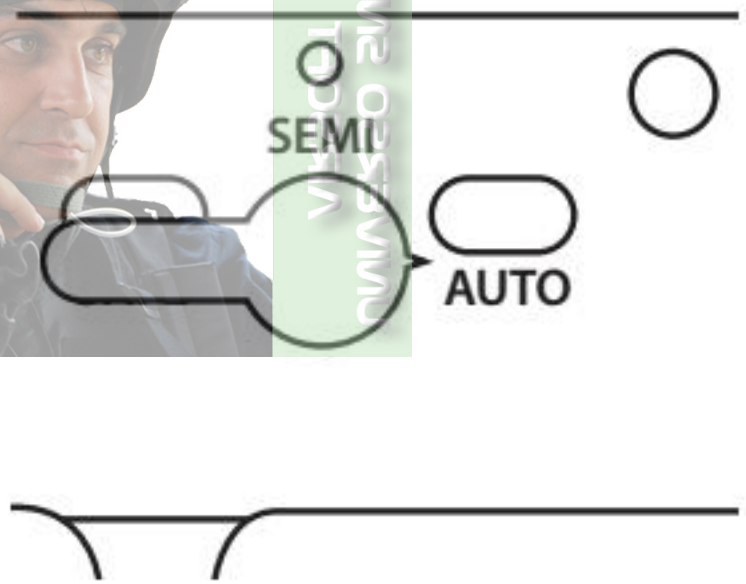

**WARNING:** Do not pull the trigger when switching the fire selector.

## FUSE

To replace the fuse, remove the butt stock cover and replace fuse with up to 20A glass fuse.

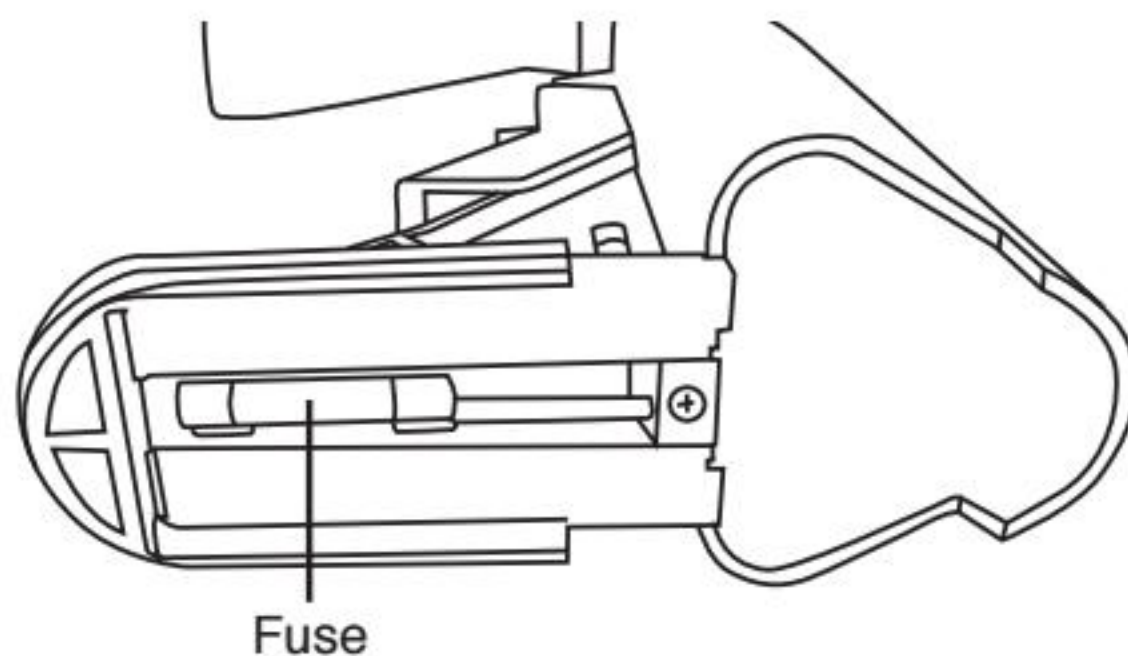



## BATTERY INSTALLATION



**WARNING:** Stock must be fully collapsed before opening the stock cover. Do not remove the stock completely from the gun, doing so will disconnect the terminal inside

1. Set fire selector to safe mode. Slightly pull the stock cover release tabs to remove the cover.
- 2a. Two types of battery can be used, nunchuck battery and small Lipo pack battery. When using a nunchuck battery, place the battery into the stock. Push the connector plugs together firmly until they click into place.
- 2b. When using a small Lipo pack battery, place the battery into the stock cover. Push the connector plugs together firmly until they click into place. \*Make sure the small Lipo pack battery size is no larger than 4"H x 1.25"W x 0.62"D
3. Close the butt stock cover.

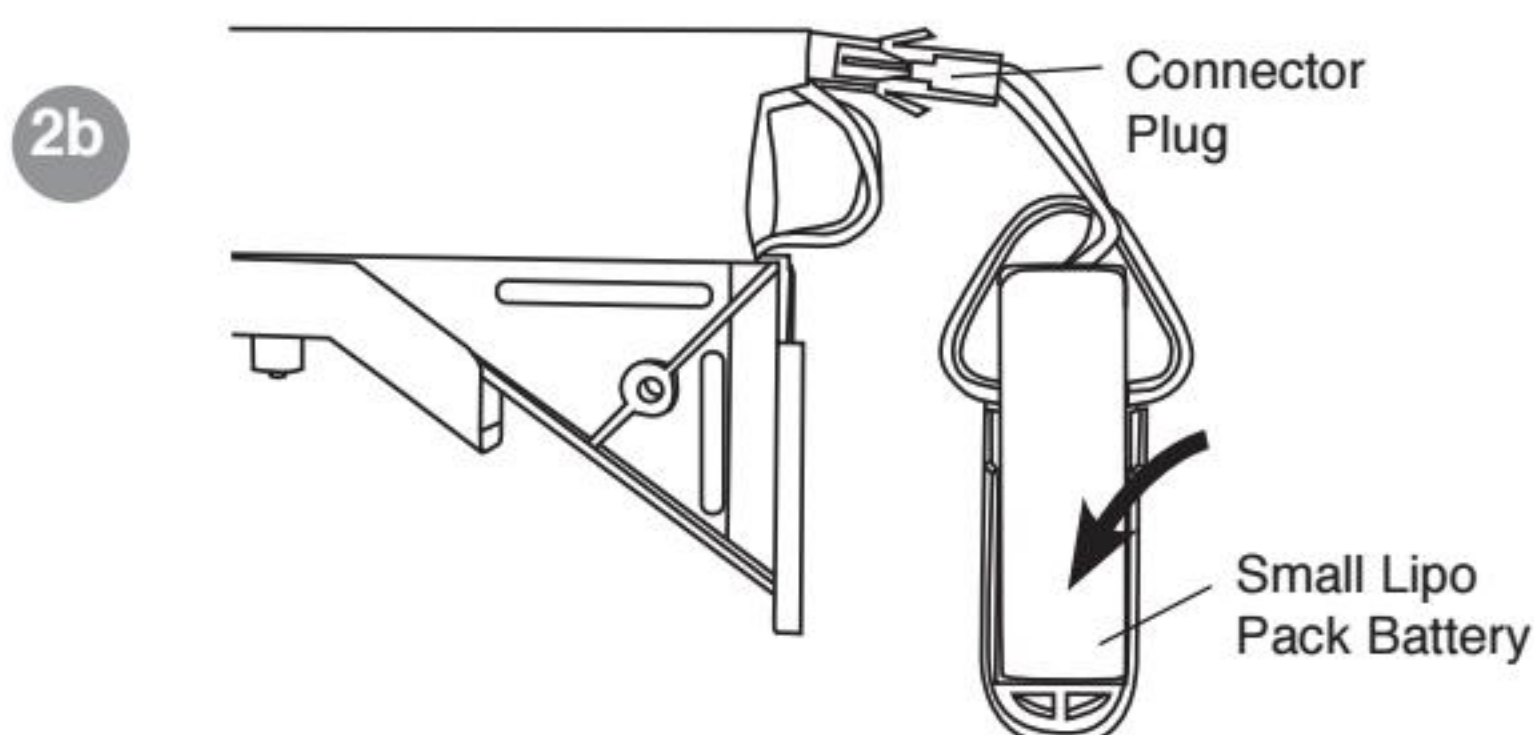
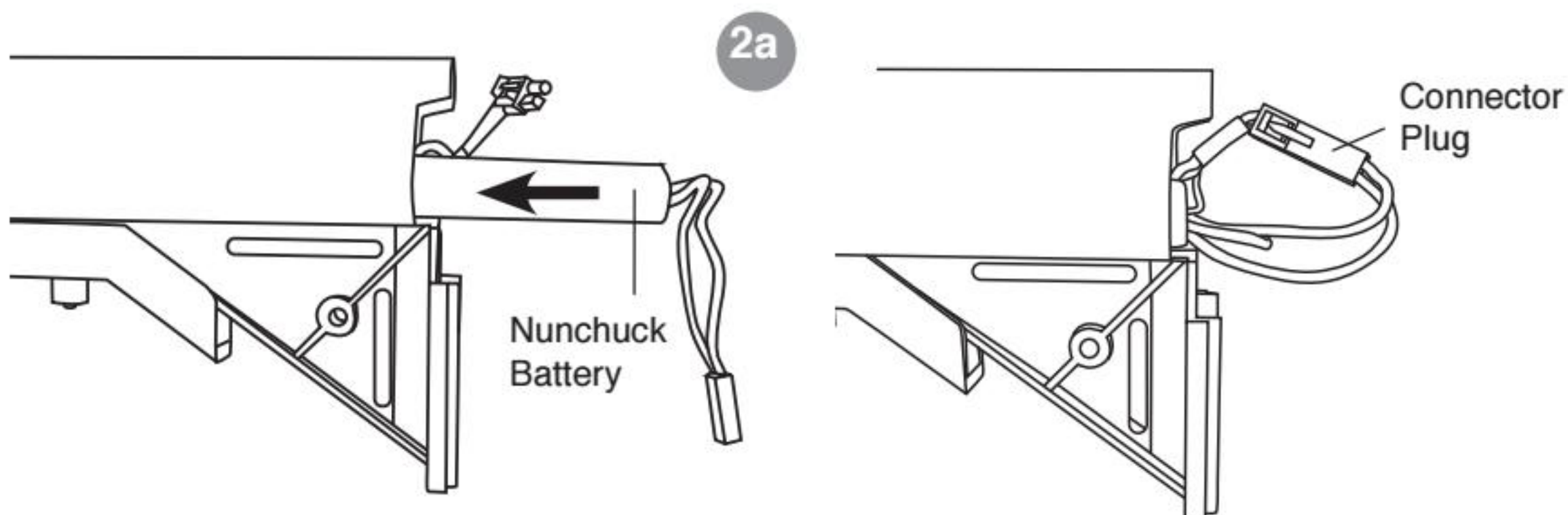
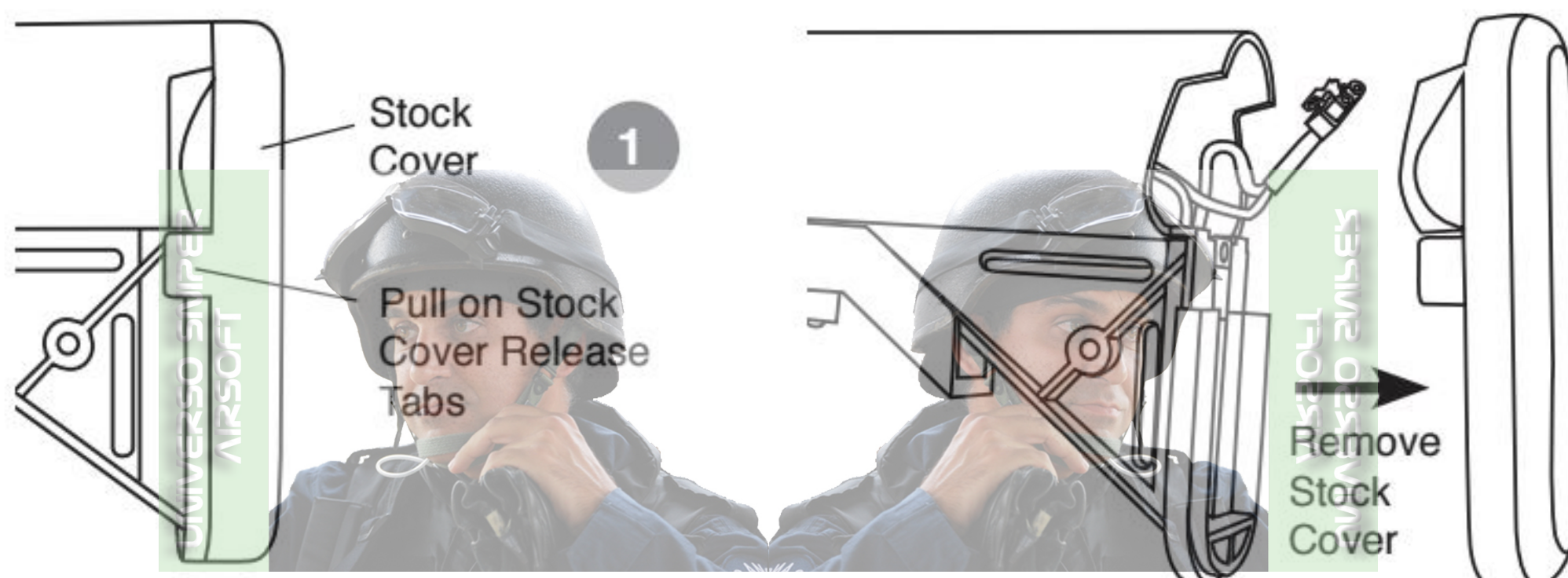

### HOP-UP SYSTEM

The Hop-Up device is one of KWA's standard features, giving Airsoft BBs greater stability, further travel and increased accuracy. Airsoft BBs are light-weight and can be affected by wind when fired. With the Hop-Up system, the trajectory of the Airsoft BBs can be adjusted according to the shooting environment or surroundings.

### HOP-UP ADJUSTMENT

- Pull the charging handle to the rear, the ejection port will open and Hop-Up adjustment dial is revealed. Pull and hold charging handle to the rear when adjusting Hop-Up.
- Turn the Hop-Up adjustment dial forward to increase hop-up. Turn the Hop-Up adjustment dial backward to decrease hop-up.
- Excessively turning of Hop-Up adjustment dial forward can cause Airsoft BBs to jam. Continued firing with a jammed barrel will cause damage to the gearbox.
- When jamming occurs, immediately stop shooting and turn the Hop-Up adjustment dial backward to decrease hop. Remove jammed Airsoft BBs.

Before removing jammed Airsoft BBs, be sure to return the hop-up adjustment dial to normal position. After removal of Airsoft BBs, test fire 2 – 3 rounds to check for clearance. Resume adjustment. KWA Airsoft guns are made with precision barrel, use only new, quality Airsoft BBs. The use of recycled or low quality Airsoft BBs are the primary cause of jamming. In most cases, it can severely damage the gearbox and inner barrel.

**Excessive Hop** – Airsoft BB travels an upward trajectory path. Turn Hop-Up adjustment dial backward to decrease hop-up.

**Perfect Hop** – Airsoft BB travels long distance horizontally.

**Inefficient Hop** – Airsoft BB travels a downward trajectory path. Turn Hop-Up adjustment dial forward to increase hop.

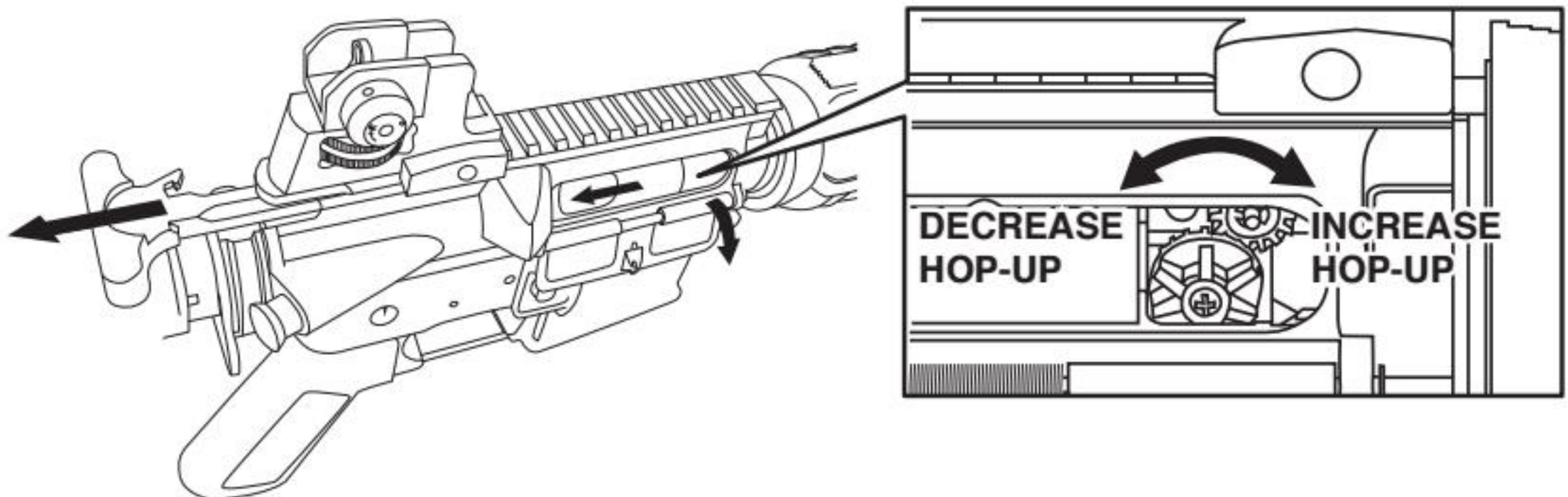

## FRONT AND REAR SIGHT ADJUSTMENT

### FRONT SIGHT ADJUSTMENT

- The front sight can be moved up and down when zeroing rear sight
- Turn counter clockwise to lower the point of Impact
- Stop turning when a click sound is heard

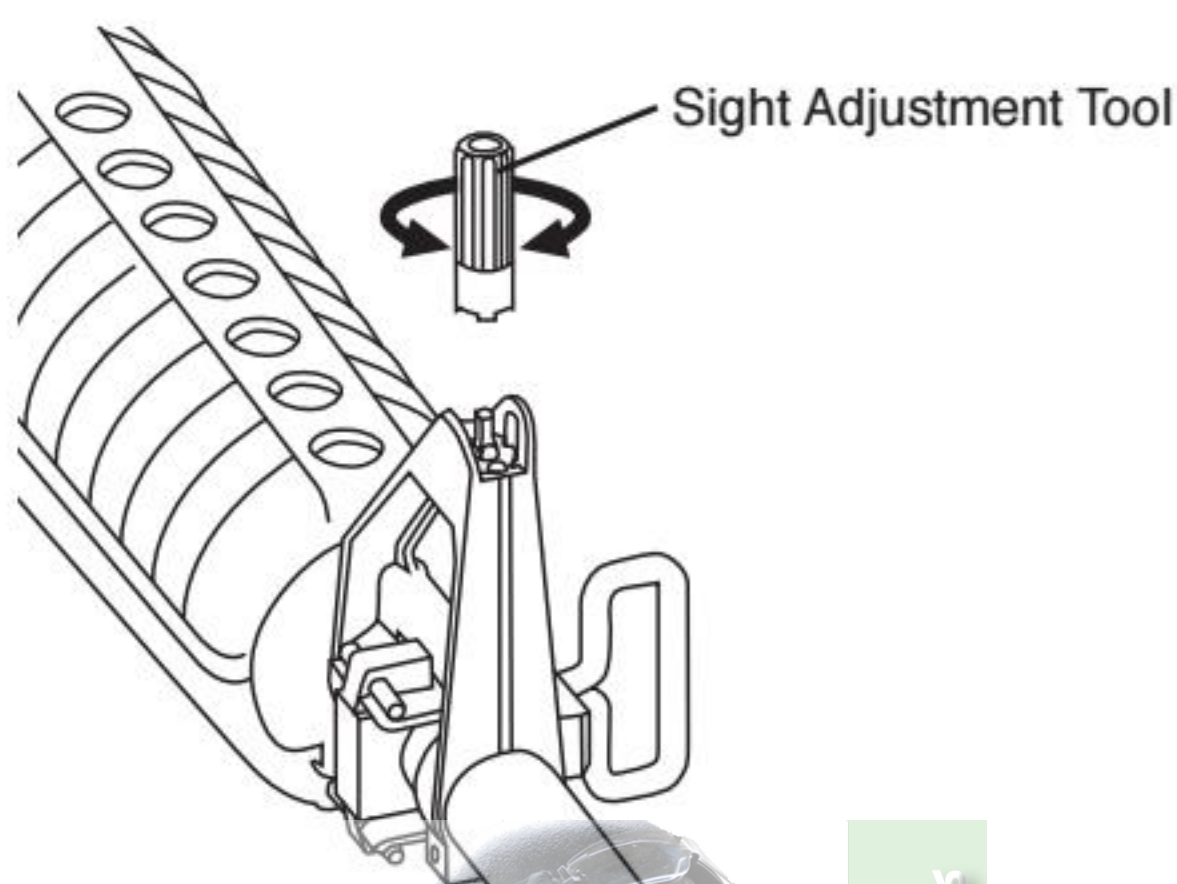

**WARNING!** If turned too far, the front sight will come off.

### REAR SIGHT ADJUSTMENT

- Flip the rear sight between general and precise aiming
- To adjust the horizontal point of impact, rotate the windage knob located on the rear of the sight
- To adjust the vertical point of impact, rotate the sight elevation knob located on the left and right side of the sight

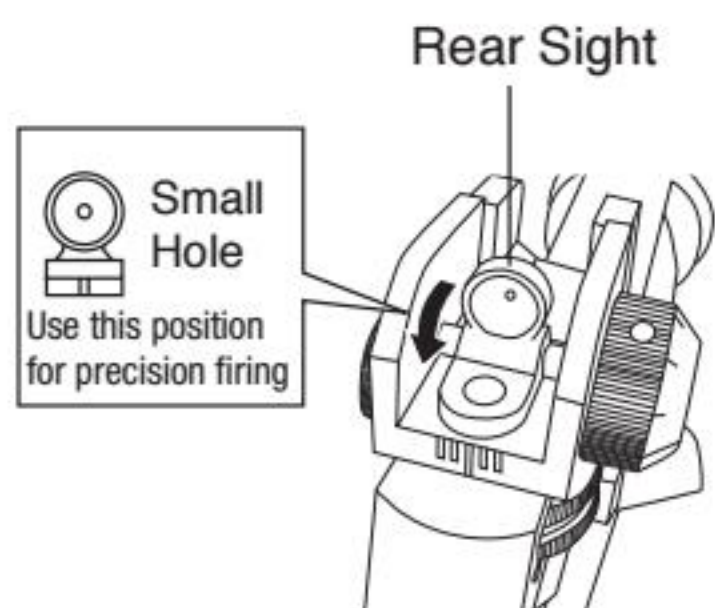

The sight assembly is marked in millimeter for precise adjustments

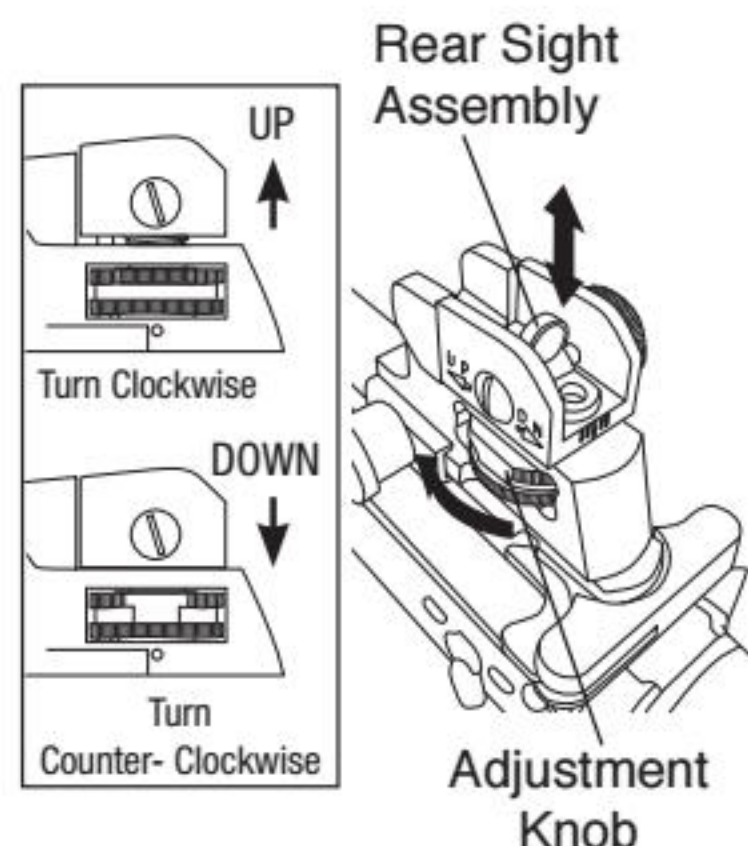
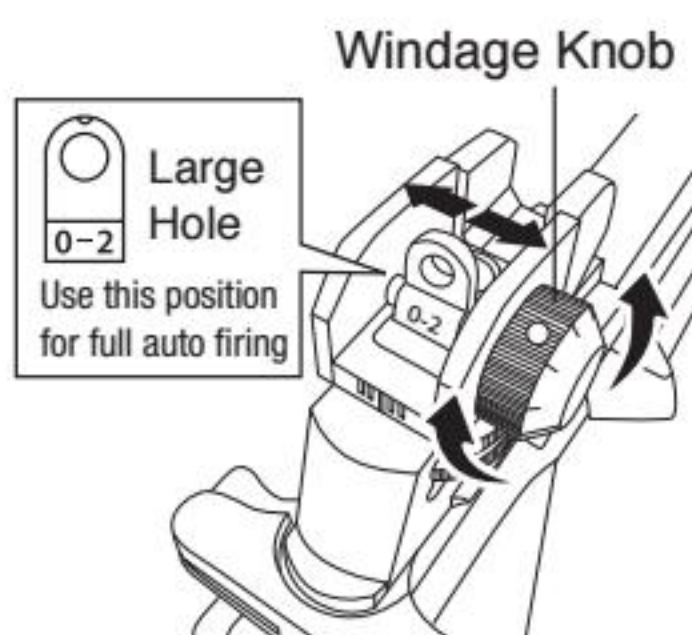

## DISASSEMBLY



**WARNING:** Before removing any parts, be sure the fire selector is set to "SAFE". Always place safety cap on the barrel tip when servicing your gun.

**Note:** Before opening the receiver, the piston must be in the forward position.

1. Shoot in semi-automatic mode 2-3 times to clear the barrel and reset the piston.
2. Remove the Rear Pin only from lower receiver with the provided Allen wrenches.
3. Use 1 wrench to hold the cap screw and one to turn the set pin.
4. After removal of the cap screw, use the allen wrench to push the pin out.
5. Pull the Upper receiver up.
6. Slide out the inner barrel with Hop-Up assembly.

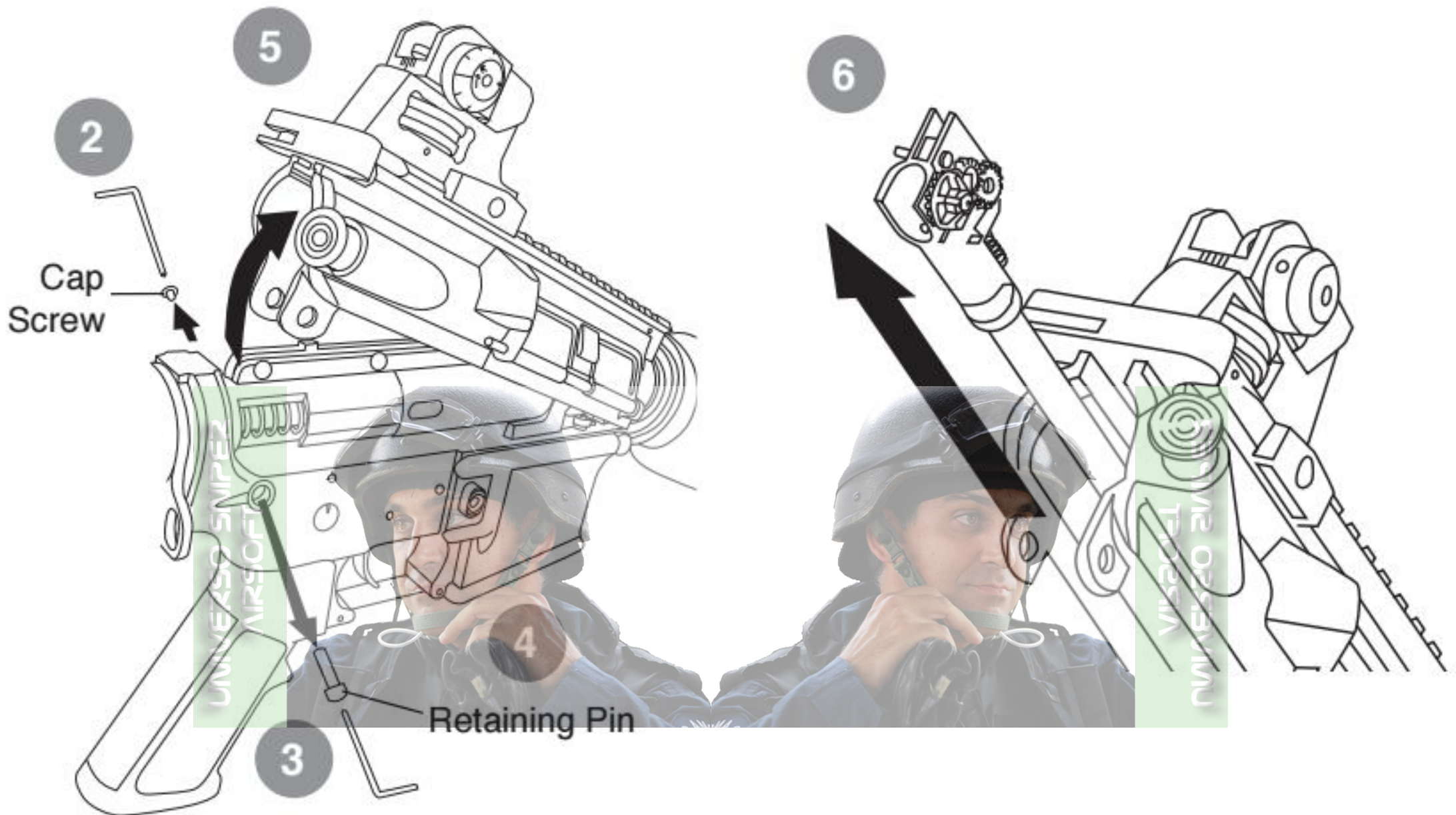

**If the receiver does not open, repeat step 1 as necessary.**

## ASSEMBLY

1. Insert the inner barrel and Hop-Up assembly into the upper receiver.
2. Secure the Hop-Up assembly into the upper receiver. Push down the upper receiver to close.
3. Align the pin holes. Insert Pin and use the allen wrench to tighten the cap screw.

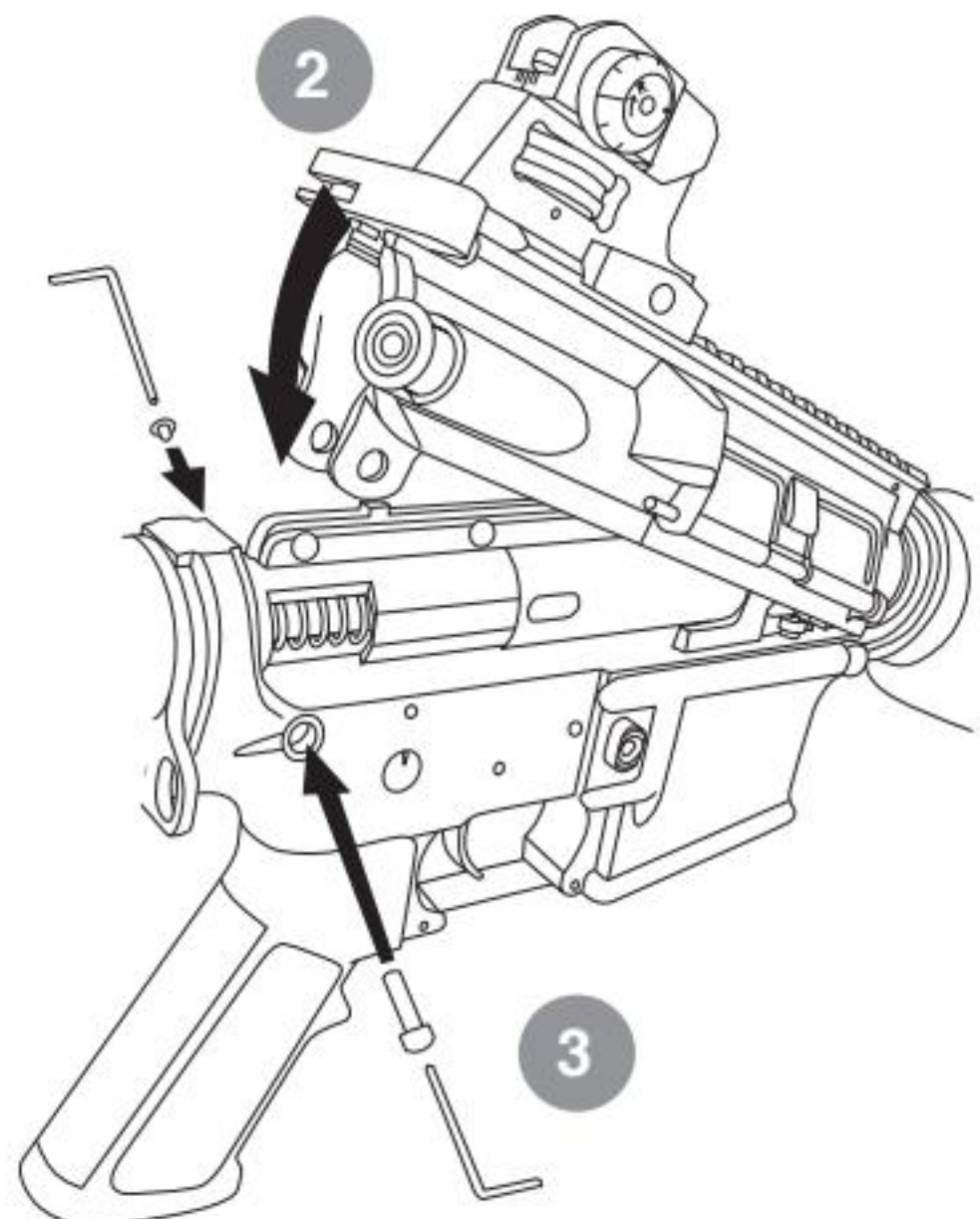

## CLEANING



**WARNING! Unload and clear the Airsoft gun before cleaning.**

### Cleaning Procedure

The Airsoft gun barrel should be cleaned after each shooting session. Regular cleaning prevents the effects of BB residue buildup that can hinder performance or jam the gun.

1. Ensure that the safety is engaged
2. Remove the magazine and clear the chamber of loaded BBs
3. Disable Hop-Up by dialing to the OFF position (see Hop-Up section)
4. Disassemble the receiver (see Disassembly section)
5. Steps to use cleaning rod:
  - a. Cut a piece of clean cotton cloth to 1 inch by 0.5 inch size. Insert one end of the cloth into the hole in the cleaning rod (adjust the length of cloth for smooth entry into the barrel)
  - b. Wind the cloth around the cleaning rod
  - c. Insert the cleaning rod into the inner barrel, and push the rod through.
  - d. Remove the cleaning rod and check the cotton cloth for dirt. Repeat steps a. through c. when necessary.

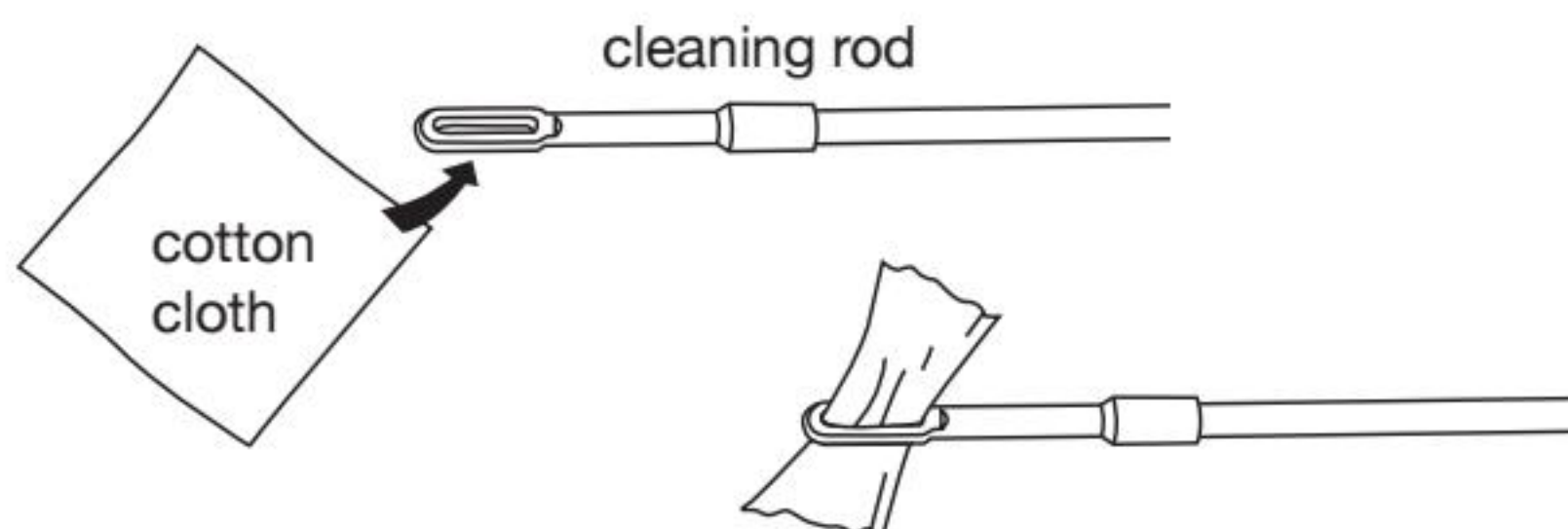

**WARNING! DO NOT use spray silicone oil as a cleaning solution for the inner barrel.**

**BASIC TROUBLESHOOTING FOR RIFLE**

SYMPTOMS	CAUSE	SOLUTIONS
Air Soft gun is not firing	Selector set to Safe Mode	Select Semi-Auto or Full-Auto Mode
	Dead battery	Replace or Charge battery
	Burned out fuse	Replace with a new fuse
	Motor damaged or bad connection	Return gun for professional care
	Pinched wiring	Return gun for professional care
Motor is running but not firing	Internal failure	Return gun for professional care
Motor or Battery is hot after short use	Pinched wiring	Return gun for professional care
	Motor damaged or bad connection	Return gun for professional care
Semi-Auto feature not functioning properly	Incorrect timing	Set selector to full-auto mode. Dry fire 10-20 rounds before returning it to semi-auto mode
Semi-Auto feature not functioning at all	Internal failure	Return gun for professional care
Firing cycle slows down	Weak battery	Recharge battery
High pitch or grinding noise	Gear may be damaged or Motor level not adjusted	Return gun for professional care
BB travels upward	Excessive hop	Turn hop adjustment dial backward
BB travels downward	Insufficient hop	Turn hop adjustment dial forward
BB double feeding or rolling out of the barrel	Excessive oil in chamber	Fire 200 rounds to eliminate excessive oil
	Hop-Up unit is contaminated	Clean Hop-Up unit with supplied cleaning rod
	Hop-Up unit may be damaged	Return gun for professional care
Hop-Up unit can't be adjusted	Damaged adjustment dial or internal parts	Return gun for professional care
Inner barrel is jammed	Use of recycled or low quality BBs	Use KWA Perfect BBs or other high quality BBs
	Inner barrel is contaminated	Clean inner barrel with supplied cleaning rod
	Inner barrel is damaged	Return gun for professional care
Hi-cap magazine not feeding	Magazine has not been wound.	Wind wheel underneath magazine
	BBs are lodged inside the magazine	Shake or tap magazine to unclog the BBs
	Internal failure	Return gun for professional care

## OPERATING UNDER UNUSUAL CONDITIONS

Unusual conditions are defined as any condition requiring special maintenance. Perform maintenance outlined for the climate similar to your operational area

### **Extreme Cold:**

Operating an Airsoft gas gun in extremely cold temperatures is not recommended. Cold temperature will cause the Hop-Up Bucking to harden, reducing its effectiveness or cause the gearbox shell to fracture during operation, rendering the gun inoperable.

### **Extreme Heat:**

Do not keep Airsoft gun and batteries under direct sunlight for long periods of time.

### **Dust or Sand:**

Dust or sand can get into a gun and cause malfunctions and/or excessive wear. Keep the gun covered whenever possible. Use lubricant sparingly, as lube naturally attracts dirt and other particles. After use in a dusty area, always field strip the gun (refer to Disassembly Section) and clean any areas you can reach with a soft, lint-free cloth.

### **Heavy Rain:**

Keep the gun out of the rain and water. This will prevent electrical failure and fluid build-up inside the mechbox. Dry gun completely with clean cloth and clean inner barrel if necessary.

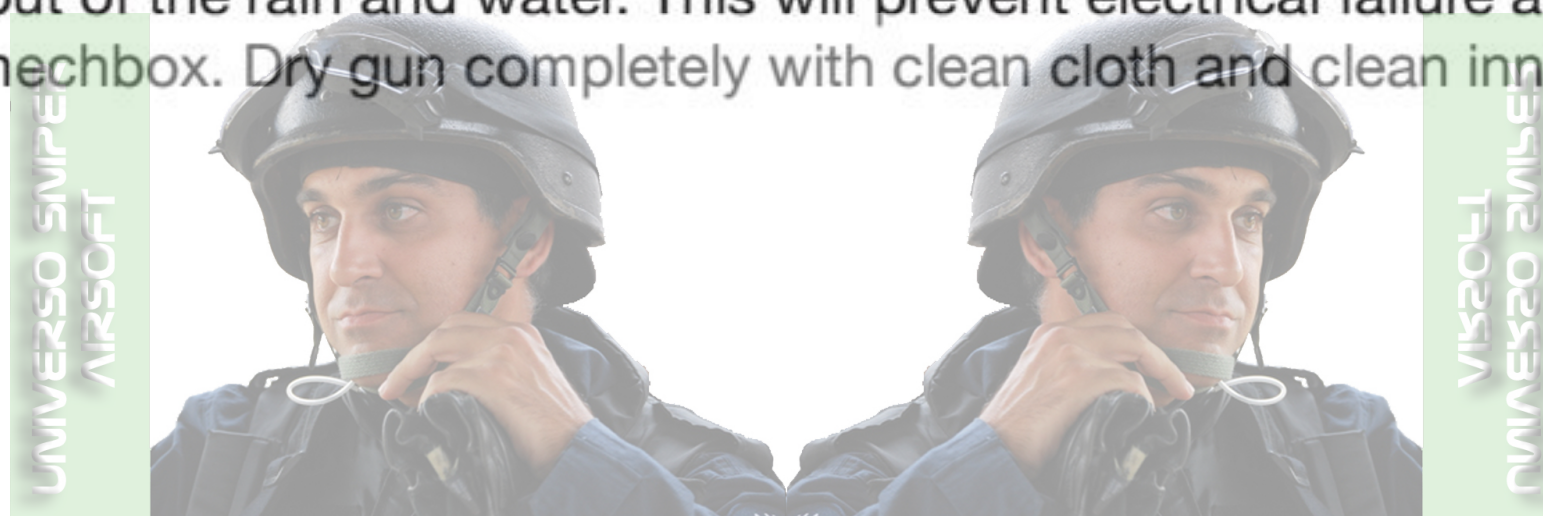

PARTS DIAGRAM

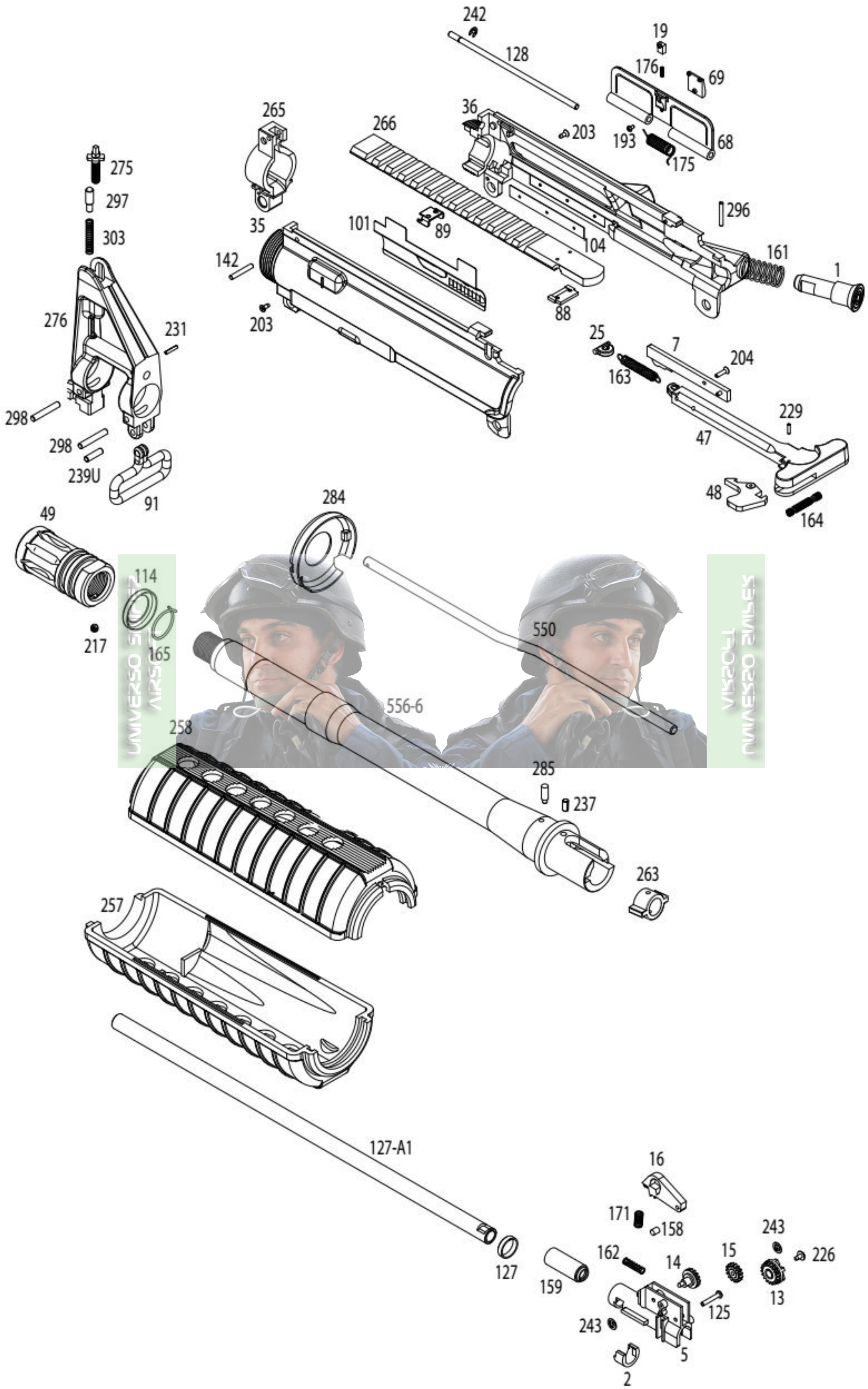



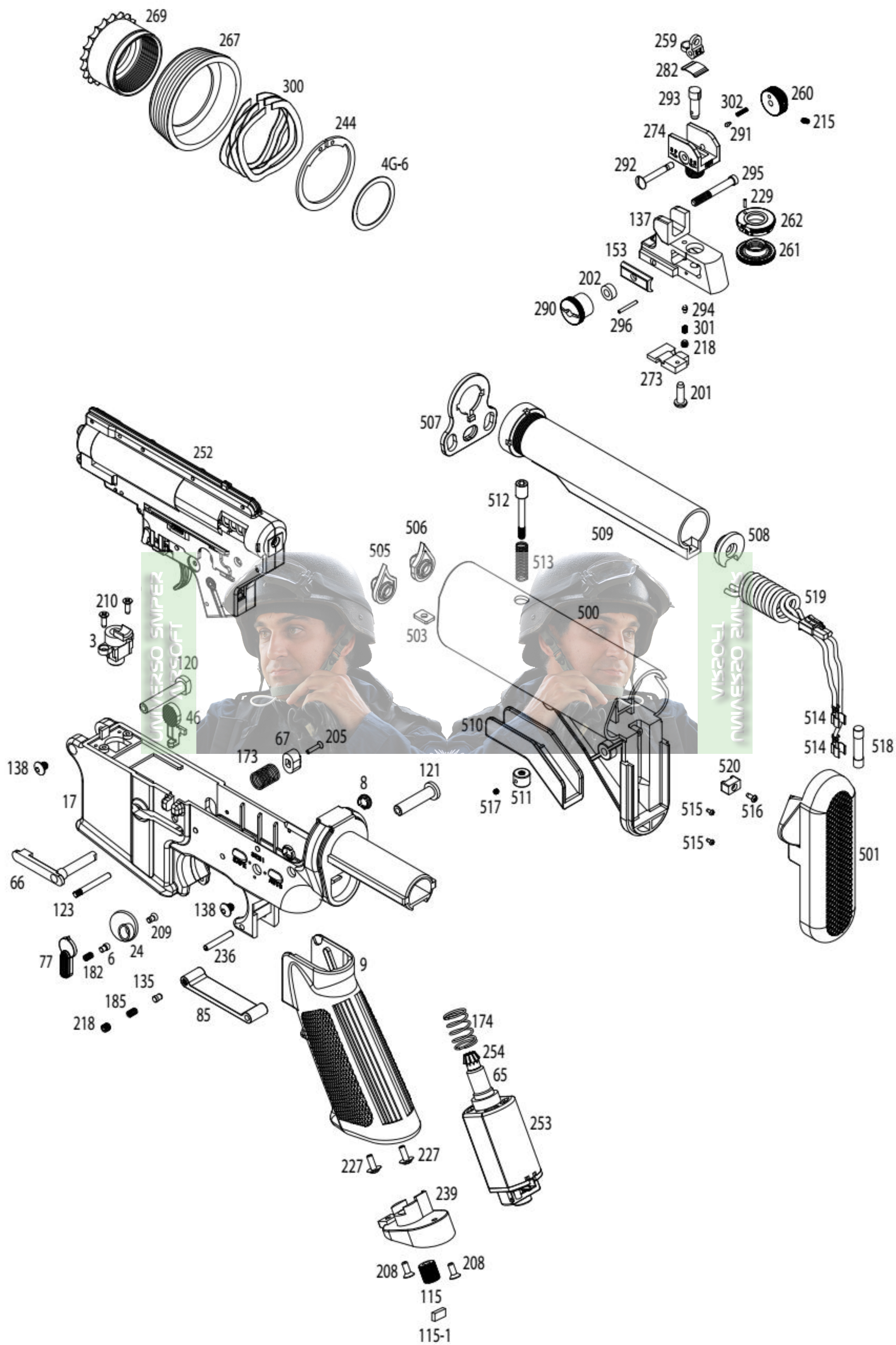

## PARTS LIST

Parts #	Description	Parts #	Description	Parts #	Description
COMMANDO-1	Forward Assist Button	COMMANDO-138	Receiver Pin Screws	COMMANDO-262	Elevation Knob Dial
COMMANDO-2	Barrel Clamp	COMMANDO-142	Top Rail Pin	COMMANDO-263	Inner Barrel Spacer
COMMANDO-3	BB Ramp	COMMANDO-153	Rear Sight Clamp Jaw	COMMANDO-265	Barrel Assembly Block
COMMANDO-4G-6	Barrel Base Washer	COMMANDO-158	Hop-Up Nub	COMMANDO-266	Top Rail
COMMANDO-5	Hop-Up Chamber	COMMANDO-159	Hop-Up Bucking	COMMANDO-267	Delta Ring
COMMANDO-6	Selector Detente	COMMANDO-161	Forward Assist Button Spring	COMMANDO-269	Barrel Nut
COMMANDO-7	Bolt Plate Carrier	COMMANDO-162	Chamber Spring	COMMANDO-273	Rear Sight Base Cover
COMMANDO-8	Selector Cover	COMMANDO-163	Charging Handle Spring	COMMANDO-274	Rear Sight Housing Base
COMMANDO-9	Grip	COMMANDO-164	Charging Handle Latch Spring	COMMANDO-275	Front Sight
COMMANDO-13	Hop-Up Adjustment Wheel	COMMANDO-165	Flash Hider Spring	COMMANDO-276	Front Sight Housing Base
COMMANDO-14	Hop-Up Spindle (Small)	COMMANDO-171	Hop-Up Bar Spring	COMMANDO-282	Rear Sight Plate Spring
COMMANDO-15	Hop-Up Spindle (Large)	COMMANDO-173	Magazine Catch Spring	COMMANDO-284	Hand Guard End Cap
COMMANDO-16	Hop-Up Bar	COMMANDO-174	Motor Tension Spring	COMMANDO-285	Inner Barrel Spacer Pin
COMMANDO-17	Lower Receiver	COMMANDO-175	Ejection Port Cover Spring	COMMANDO-290	Rear Sight Knob
COMMANDO-19	Ejection Port Cover Lock Plunger	COMMANDO-176	Ejection Port Cover Lock Spring	COMMANDO-291	Windage Knob Plunger
COMMANDO-24	Selector Plate	COMMANDO-182	Selector Spring	COMMANDO-292	Rear Sight Windage Screw
COMMANDO-25	Charging Handle Spring Hook	COMMANDO-185	Trigger Guard Plunger Spring	COMMANDO-293	Elevation Bar
COMMANDO-35	Upper Receiver (Left)	COMMANDO-193	Ejection Port Cover Screw	COMMANDO-294	Rear Sight Elevation Plunger
COMMANDO-36	Upper Receiver (Right)	COMMANDO-201	Carry Handle Lock Screws	COMMANDO-295	Rear Sight Bolt
COMMANDO-46	Bolt Catch	COMMANDO-202	Carry Handle Knob Spacers	COMMANDO-296	Forward Assist Pin
COMMANDO-47	Charging Handle	COMMANDO-203	Screw M2X5	COMMANDO-297	Front Sight Plunger
COMMANDO-48	Charging Handle Latch	COMMANDO-204	Bolt Plate Carrier Screw	COMMANDO-298	Front Sight Housing Pins
COMMANDO-49	Flash Hider	COMMANDO-205	Magazine Catch Screw	COMMANDO-300	Delta Ring Lock Spring
COMMANDO-65	Motor Spring Base	COMMANDO-208	Motor Plate Screws	COMMANDO-301	Rear Sight Elevation Spring
COMMANDO-66	Magazine Catch	COMMANDO-209	Selector Screw	COMMANDO-302	Windage Knob Spring
COMMANDO-67	Magazine Catch Button	COMMANDO-210	BB Ramp Screws	COMMANDO-303	Front Sight Spring
COMMANDO-68	Ejection Port Cover	COMMANDO-215	Windage Knob Set Screw	COMMANDO-500	Crane Stock
COMMANDO-69	Ejection Port Cover Lock	COMMANDO-217	Screw M3X3 SC	COMMANDO-501	Butt Plate
COMMANDO-77	Selector	COMMANDO-218	Screw M3X8 SC	COMMANDO-503	Stock Lever Spacer
COMMANDO-85	Trigger Guard	COMMANDO-226	Hop-Up Wheel Screw	COMMANDO-505	Crane Stock Cover (Left)
COMMANDO-88	Rail Retaining Block	COMMANDO-227	Grip Screws	COMMANDO-506	Crane Stock Cover (Right)
COMMANDO-89	Top Rail Bridge	COMMANDO-229	Charging Handle Latch Pins	COMMANDO-507	Sling Swivel
COMMANDO-91	Swivel Front	COMMANDO-231	Gas Tube Pin	COMMANDO-508	Buffer Tube Retainer
COMMANDO-101	Bolt Plate	COMMANDO-236	SP 3X20 Roll Pin	COMMANDO-509	Stock Buffer Tube
COMMANDO-104	Dust Cover Retainer	COMMANDO-237	Barrel Base Pins	COMMANDO-510	Stock Lever
COMMANDO-114	Flash Hider Washer	COMMANDO-239	Motor Base Plate	COMMANDO-511	Stock Lever Nut
COMMANDO-115	Motor Adjustment Screw	COMMANDO-239U	Front Swivel Pin	COMMANDO-512	Stock Lever Bolt
COMMANDO-115-1	Motor Adjustment Screw Retainer	COMMANDO-242	Pin Retaining Ring	COMMANDO-513	Stock Lever Spring
COMMANDO-120	Take Down Pin (Front)	COMMANDO-243	Hop-Up Spindle Rings	COMMANDO-514	Fuse Terminals
COMMANDO-121	Take Down Pin (Rear)	COMMANDO-244	Locking Clamp	COMMANDO-515	Fuse Terminal Screws
COMMANDO-123	Gearbox Set Pin	COMMANDO-252	Gear Box	COMMANDO-516	Crane Wire Harness Screw
COMMANDO-125	Hop-Up Bar Pin	COMMANDO-253	Motor	COMMANDO-517	Stock Lever Nut Screw
COMMANDO-127	Hop-Up Chamber Spacer	COMMANDO-254	Pinion Gear	COMMANDO-518	Fuse
COMMANDO-127-A1	Inner Barrel	COMMANDO-257	Lower Hand Guard	COMMANDO-519	Crane Wire Harness
COMMANDO-128	Ejection Port Cover Pin	COMMANDO-258	Top Hand Guard	COMMANDO-520	Crane Wire Harness Clamp
COMMANDO-135	Trigger Guard Lock Pin	COMMANDO-259	Rear Sight	COMMANDO-550	Gas Tube
COMMANDO-137	Rear Sight Base	COMMANDO-260	Windage Knob	COMMANDO-556-6	Outer Barrel
		COMMANDO-261	Elevation Knob Dial Base		

# KWA 2GX TYPE II GEARBOX DIAGRAM AND PARTS LIST

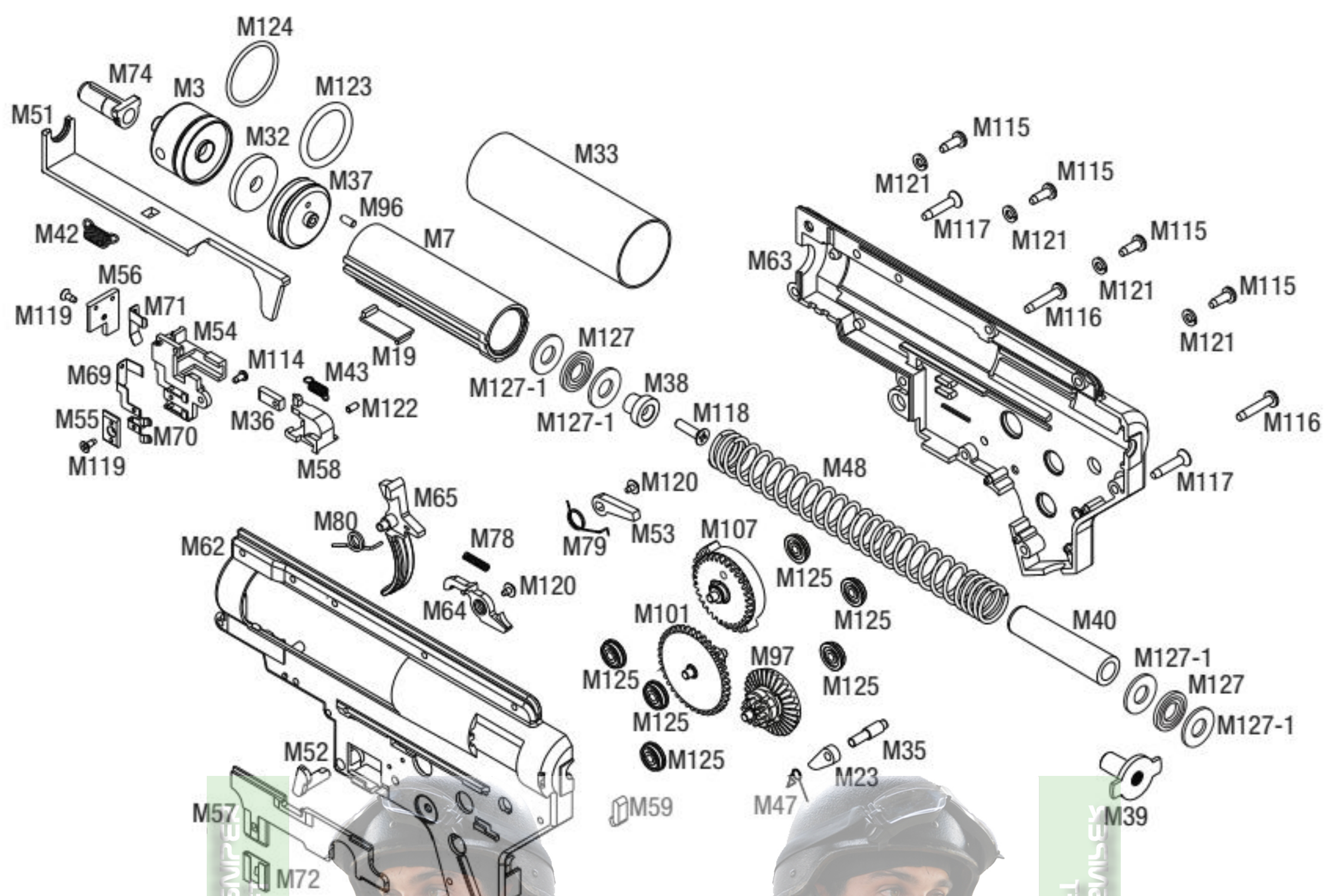

Parts #	Description	Parts #	Description	Parts #	Description
2GX.V2-M3	Gearbox Cylinder Head	2GX.V2-M55	Gearbox Power Bridge Plate	2GX.V2-M107	Gearbox Sector Gear
2GX.V2-M7	Gearbox Piston	2GX.V2-M56	Gearbox Switch Bridge Plate		Gearbox Wire Harness Base Screw
2GX.V2-M19	Gearbox Piston Metal Plate	2GX.V2-M57	Gearbox Selector Plate	2GX.V2-M114	Gearbox Mechbox Screw
2GX.V2-M23	Anti-Reverse Latch	2GX.V2-M58	Gearbox Trigger Switch Block	2GX.V2-M115	Gearbox Mechbox Screw
2GX.V2-M32	Gearbox Cylinder Head Buffer	2GX.V2-M59	Gearbox Wire Retainer	2GX.V2-M116	Gearbox Mechbox Screw
2GX.V2-M33	Gearbox Cylinder	2GX.V2-M62	Gearbox Mechbox Shell (Left)	2GX.V2-M117	Gearbox Mechbox Screw
2GX.V2-M35	Anti-Reverse Latch Axis	2GX.V2-M63	Gearbox Mechbox Shell (Right)	2GX.V2-M118	Gearbox Piston Head Screw
2GX.V2-M36	Gearbox Trigger Switch Contact Plate	2GX.V2-M64	Gearbox Cut-off Lever	2GX.V2-M119	Gearbox Wire Harness Base Screw
2GX.V2-M37	Gearbox Piston Head	2GX.V2-M65	Gearbox Trigger	2GX.V2-M120	Gearbox Cut-off Lever Screw
2GX.V2-M38	Gearbox Piston Head End Cap	2GX.V2-M69	Gearbox Trigger Switch Brush / Power Out	2GX.V2-M121	Gearbox Mechbox Screw Locking Washer
2GX.V2-M39	Gearbox Spring Guide End Cap	2GX.V2-M70	Gearbox Power Cut-off Brush	2GX.V2-M122	Gearbox Trigger Switch Pin
2GX.V2-M40	Gearbox Spring Guide Rod	2GX.V2-M71	Gearbox Trigger Switch Brush / Power In	2GX.V2-M123	Gearbox Piston Head O-Ring
2GX.V2-M42	Gearbox Tappet Plate Spring	2GX.V2-M72	Gearbox Selector Plate Contact	2GX.V2-M124	Gearbox Cylinder Head O-Ring
2GX.V2-M43	Gearbox Trigger Switch Return Spring	2GX.V2-M74	Gearbox Air Nozzle	2GX.V2-M125	Gearbox 9mm Bearing Bushing
2GX.V2-M47	Gearbox Anti-Reversale Latch Spring	2GX.V2-M78	Gearbox Cut-off Lever Spring	2GX.V2-M127	Gearbox Piston Grooved Washer
2GX.V2-M48	Gearbox Main Spring, M120	2GX.V2-M79	Gearbox Safety Lever Spring	2GX.V2-M127-1	Gearbox Spring Guide Flat Washer
2GX.V2-M51	Gearbox Tappet Plate	2GX.V2-M80	Gearbox Trigger Spring		
2GX.V2-M52	Gearbox Safety Lever Base	2GX.V2-M96	Gearbox Piston Head Set Screw		
2GX.V2-M53	Gearbox Safety Lever	2GX.V2-M97	Gearbox Bevel Gear		
2GX.V2-M54	Gearbox Wire Harness Base	2GX.V2-M101	Gearbox Spur Gear		

# KWA K-120 MAGAZINE DIAGRAM AND PARTS LIST

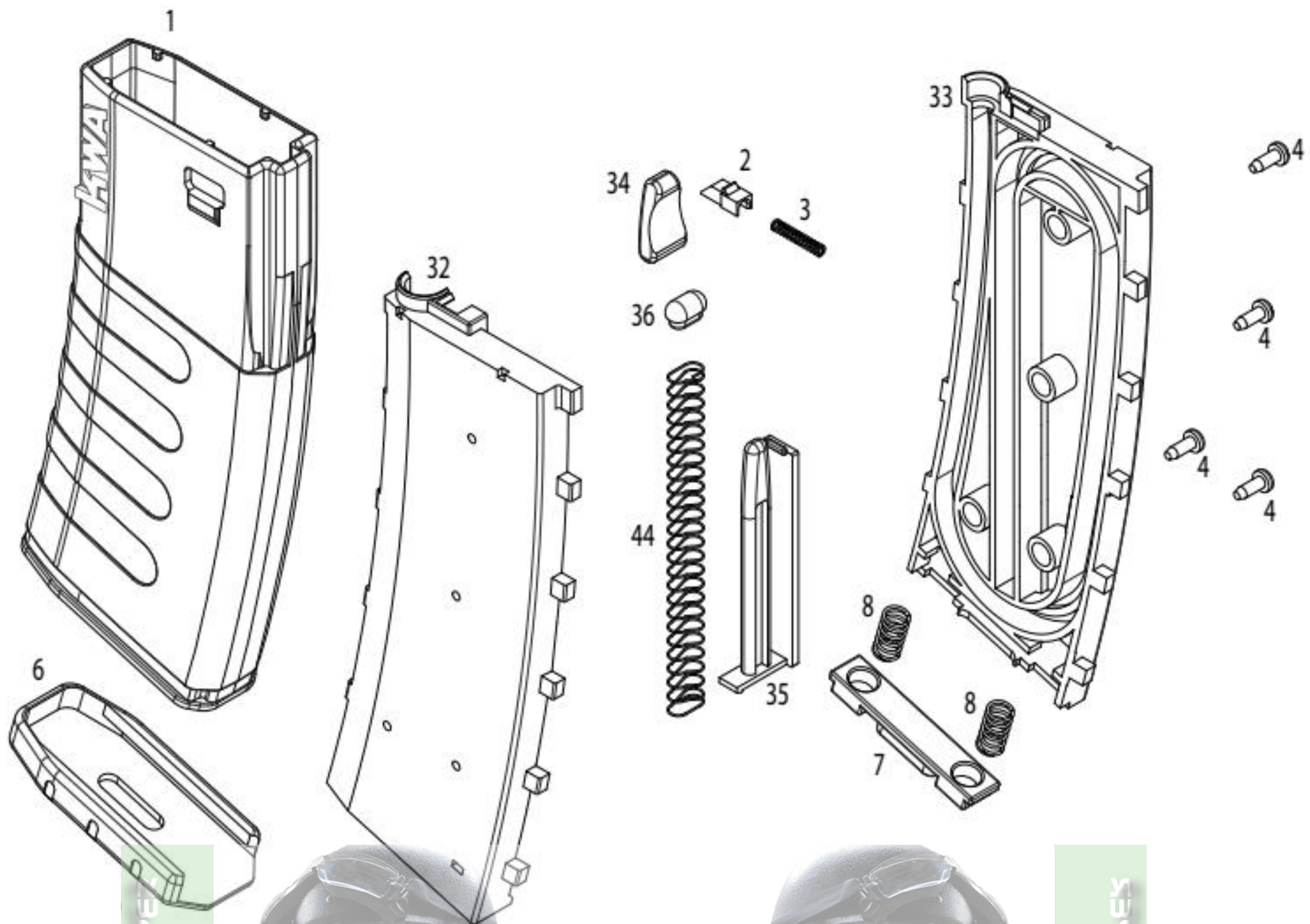

Parts #	Description
KWA K-120-MG1	MAGAZINE BODY
KWA K-120-MG2	MAGAZINE BB STOP
KWA K-120-MG3	MAGAZINE BB STOP SPRING
KWA K-120-MG4	MAGAZINE HOUSING SCREW
KWA K-120-MG6	MAGAZINE BASE PLATE
KWA K-120-MG7	MAGAZINE BASE PLATE STOP
KWA K-120-MG8	MAGAZINE BASE PLATE SPRINGS

Parts #	Description
KWA K-120-MG32	MAGAZINE HOUSING (LEFT PANEL)
KWA K-120-MG33	MAGAZINE HOUSING (RIGHT PANEL)
KWA K-120-MG34	MAGAZINE FOLLOWER
KWA K-120-MG35	MAGAZINE FOLLOWER GUIDE
KWA K-120-MG36	MAGAZINE FOLLOWER LINK
KWA K-120-MG44	MAGAZINE FOLLOWER SPRING

**KWA Performance Industries, Inc.**

Copyright © July, 2012 KWA Performance Industries, Inc. All Rights Reserved.