

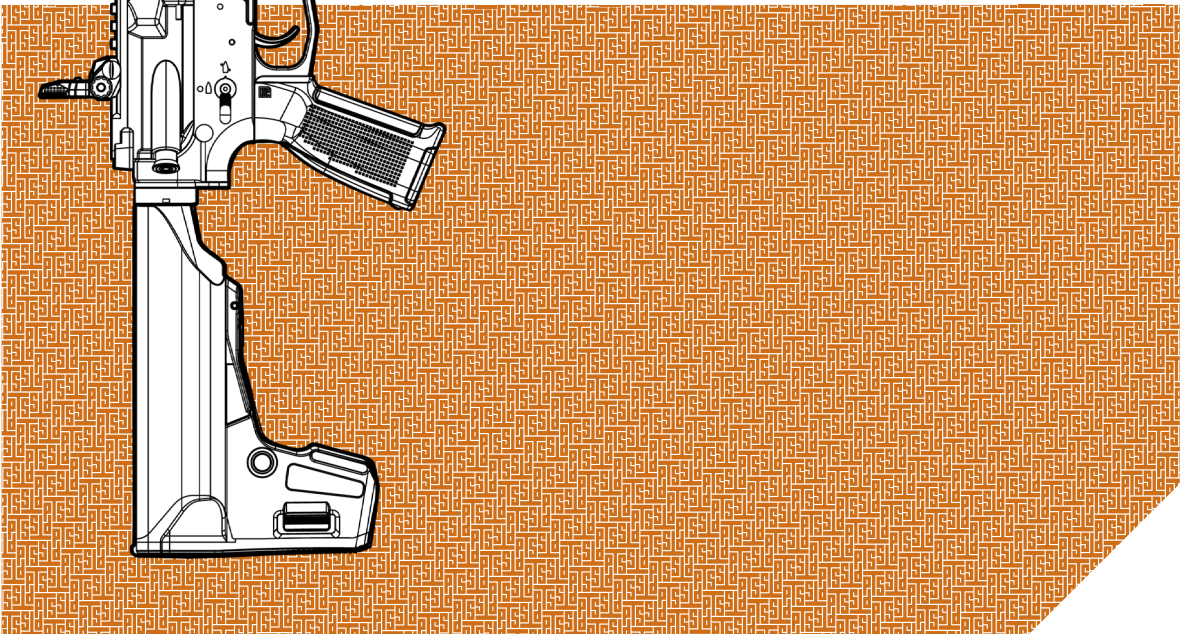

**PROFESSIONAL
TRAINING &
SIMULATION**

**PTS CENTURION ARMS
CM4 ERG
INSTRUCTION MANUAL**



CORE FEATURES

- Electric Recoil Gun System
- Electrical auto cut-off with last round fired.
- Realistic construction and field stripping.
- Functional bolt catch and release for firing system reactivation.
- Semi Auto and Full Auto select fire modes.
- Adjustable hop-up system.
- Integrated EP Series Flip-up Front and Rear Back-up Sights, Stock and Grip.
- CNC machined aluminum construction.
- Picatinny rail mounting system.
- 10.75" Length Barrel.
- 10" C4 Rail
- Simulated recoil.
- EPM ERG with adjustable 30 or 120 round capacity.

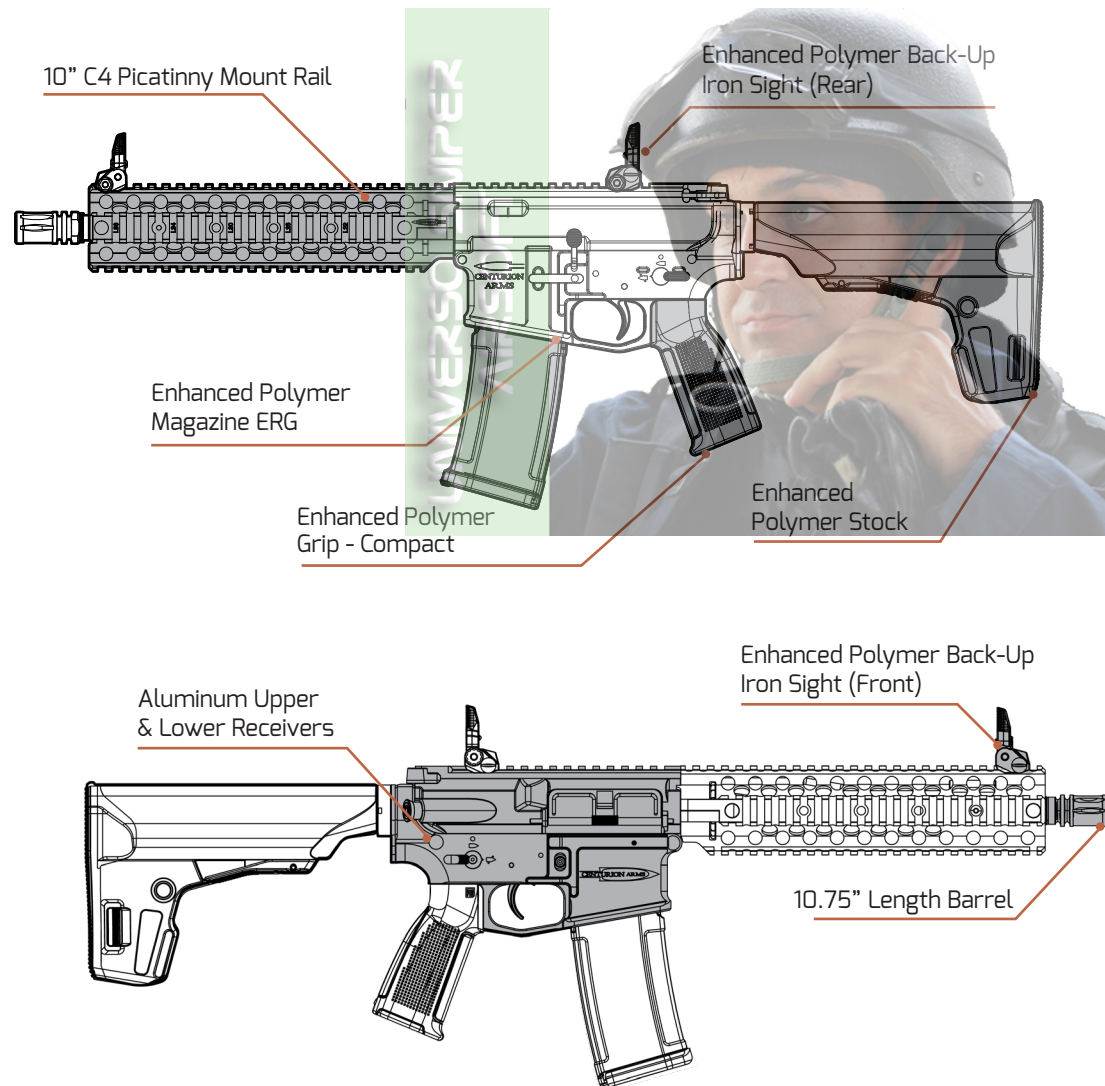

SAFETY INSTRUCTIONS AND HANDLING

You should be fully familiar with the proper and safe handling of your airsoft gun. The basic principles of gun safety require you to always apply the following rules when handling airsoft guns:

- Always treat an airsoft gun as if it were loaded.
- Always set the safety selector on an airsoft gun to "SAFE" when loading it so that there can be no risk of an unintentional discharge.
- Keep your finger off the trigger and outside the trigger guard until you are ready to shoot.
- Always keep the muzzle pointed in a safe direction.
- Never aim your airsoft gun at persons, animals or property. To avoid ricochets, never fire at smooth, hard surfaces or water.
- Before you discharge your airsoft gun, make sure that the target and surrounding area is safe. Always be aware of your target's foreground and background.
- Proper eye protection should always be worn when firing an airsoft gun.
- Always store your airsoft gun in a safe place, in an unloaded condition and out of reach from children.
- This airsoft gun (along with its operating instructions) may only be handed over to persons who have reached the age of 18 (or older) and who are fully familiar with the handling of it.
- Modifications and/or repairs to the airsoft gun should only be completed by authorized agencies or by a skilled gunsmith.
- Never leave a loaded airsoft gun unattended.
- Only an unloaded airsoft gun is to be handed over to another person.

CAUTION

- You must be 18 years or older to purchase this airsoft gun.
- Any alteration or conversion done to this airsoft product that leads to a different classification of the airsoft gun/weapon in regards to the applicable firearms legislation may render it illegal. If these circumstances occur, the manufacturer's warranty becomes immediately null and void.

WARNING

- Do not brandish or display this airsoft product in public - it may confuse people and may be a crime in your area. Police and others may view it as a firearm and they may react under that assumption.
- Do not change the coloration and markings to make it look like a real firearm. That is dangerous and may be a crime.
- Observe safe firearm handling practices at all times. Failure to do so may result in serious bodily injury or death.
- PTS is not responsible for injury, death or property damage resulting from faulty installation, misuse, illegal use, or modification of this product.
- PTS products feature design modification and/or material construction that renders them incompatible with real firearms.
- DO NOT attempt to install, modify, or otherwise adapt PTS products for use on real firearms, as damage to the weapon and/or serious personal injury may occur.

BASIC GUN SAFETY TIPS

- Always treat the Airsoft gun as if it is loaded regardless of its actual loaded condition.
- Keep the Airsoft gun pointed in a safe direction.
- Keep your finger straight, off the trigger and outside the trigger guard until you've made the decision to shoot.
- Always be sure of your target, what is between you and the target, and what is beyond the target.
- Do not store the Airsoft gun with a loaded magazine.
- Handle the Airsoft gun responsibly.

FIRE CONTROL SETTINGS

SAFE FIRE
SAFE FIRE AUTO
SAFE FIRE AUTO

SAFE Gun cannot be fired.

FIRE Gun will fire once per trigger pull.

AUTO Gun will fire automatically as the trigger is pulled.

SWITCHING MAGAZINE CAPACITY

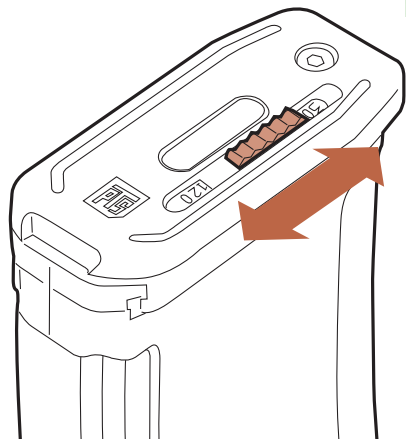

To change the magazine capacity, flick the switch at the base of the magazine (EPM-ERG) to either a capacity of 30 rounds or 120 rounds, as indicated on the face of the magazine baseplate.



INSERTING THE MAGAZINE

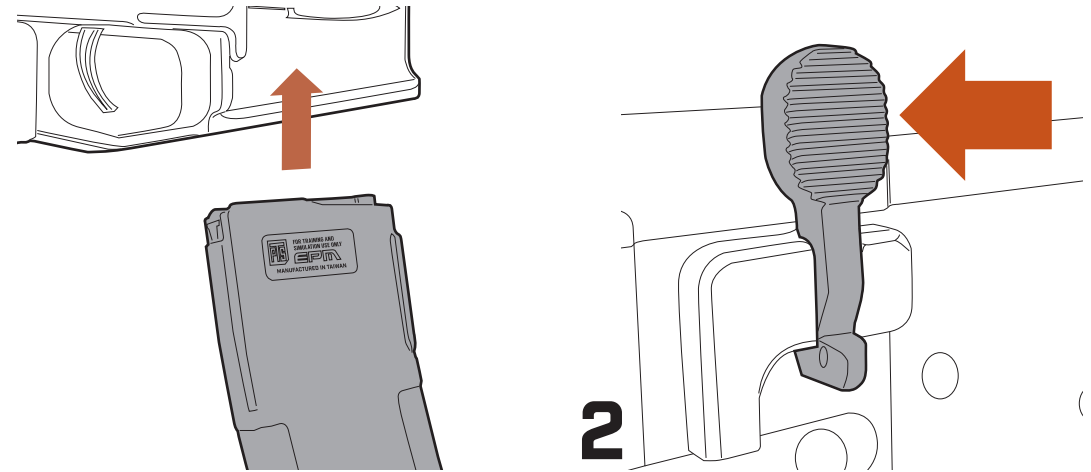

1 Insert the magazine into the magazine well of the lower receiver. When the magazine is fully seated, the magazine catch will lock the magazine in place.

2 If no bb's are present in the nozzle chamber, press the bolt release button on the left side of the receiver.

RELEASING THE MAGAZINE

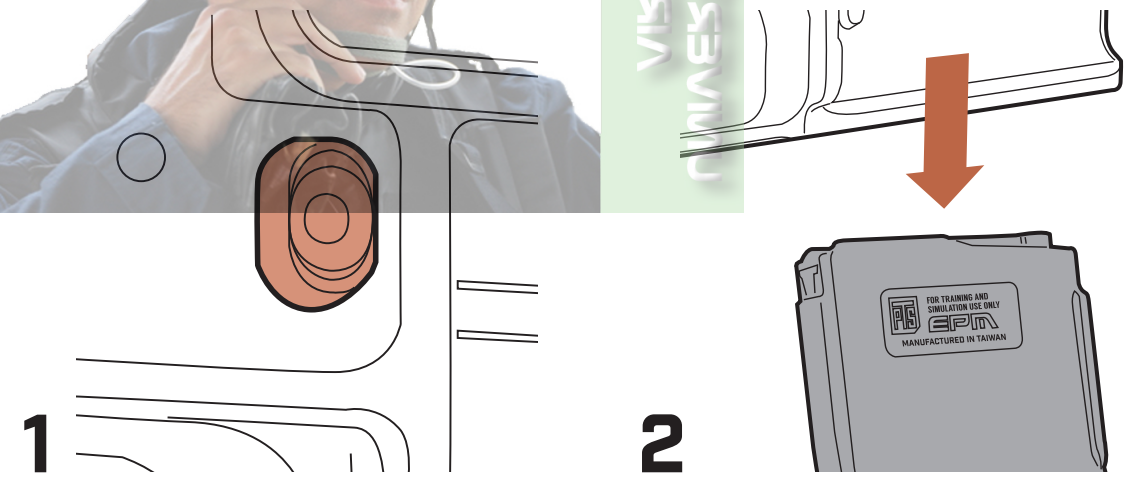

1 To release the magazine, depress the magazine release button found on the right side of the receiver.

2 Once button is depressed, the magazine can then be removed from the magazine well of the receiver.

LOADING THE MAGAZINE

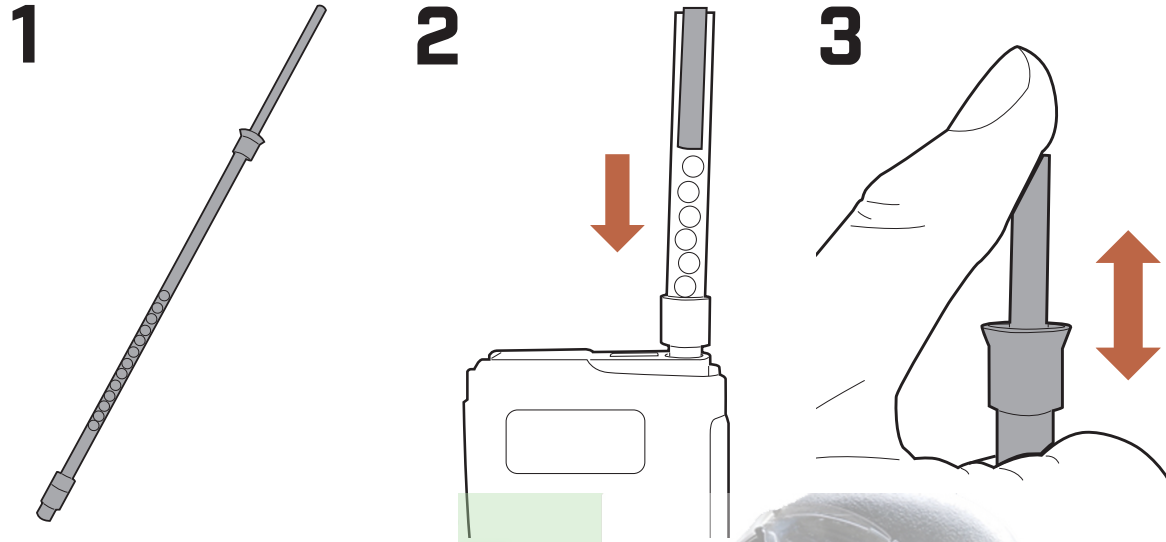

1 Insert the BBs into the BB loader that is provided with the gun inside the packaging.

2 Once loaded with BBs, attach the BB loader into the feedlip of the magazine.

3 To push the BBs down into the magazine, pump the top-end of the loader until the magazine is loaded.

HOP-UP SYSTEM

ACCESSING THE HOP-UP SYSTEM

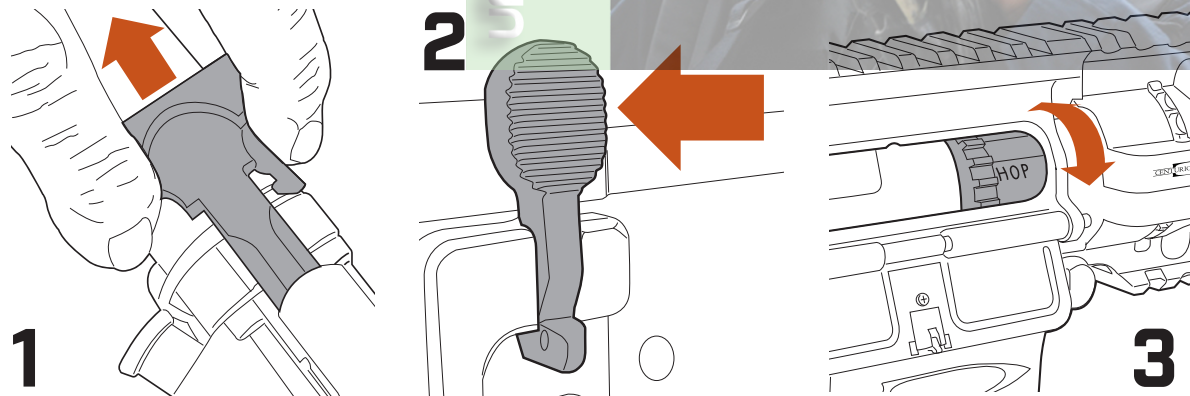

1 To open the chamber of the C4 gun, pull back on the charging handle.

2 Whilst keeping the charging handle pulled back, depress the base of the bolt release button.

3 The hop-up unit is now accessible and can be adjusted for optimal performance.

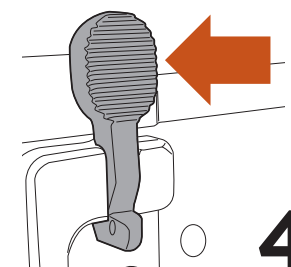

4 Depress the base of the bolt release button again to free the bolt back to its ready position.

ADJUSTING THE HOP-UP SYSTEM



WARNING



Do not release the bolt with the wrench still in the chamber. It can damage the hop-up device and chamber components.

Do not over torque the hop-up adjustment wrench. Doing so may damage the hop-up cylinder.

When test firing, please aim and fire the gun at a safe location.

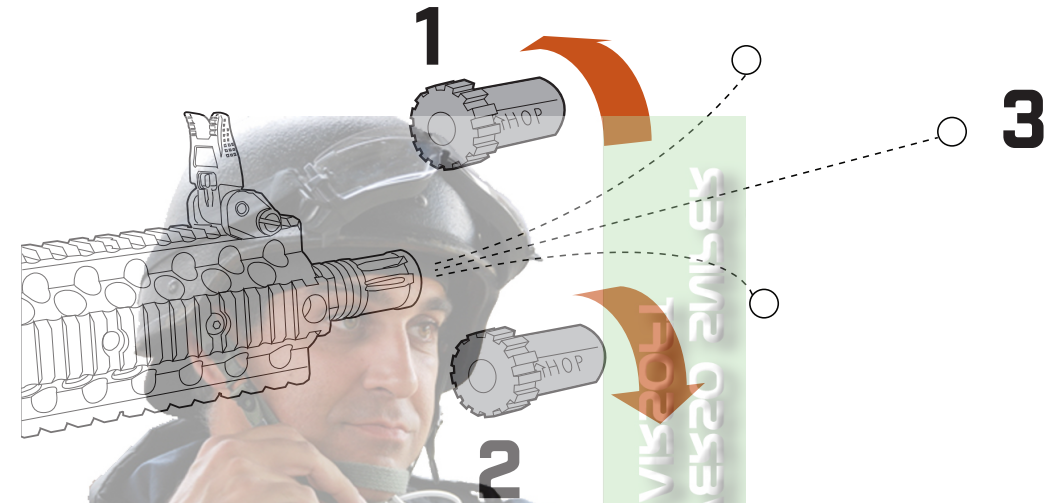

1 Rotate the hop-up unit's dial counter-clockwise (if the gun is pointed downrange) to increase the topspin of the BB pellet, thus decreasing the elevation of the projectile.

2 Rotate the hop-up unit's dial clockwise (if the gun is pointed downrange) to increase the backspin of the BB pellet, thus increasing the elevation of the projectile.

3 The ideal setting would be achieved when the rounds fired maintain a relatively flat trajectory so adjust accordingly. Keep in mind, settings may vary in relation to the different weights of BB used.

ENHANCED POLYMER FRONT BACK UP SIGHT

ENGAGING THE BACK UP SIGHT

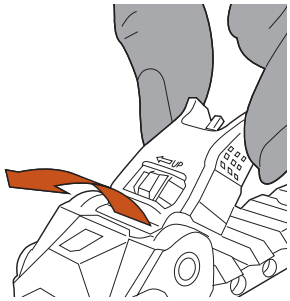

To engage the EPBUIS Front Sight upright, simply lift the sight by the textural plains on the sides to the ready position.

ADJUSTING SIGHT FOR ELEVATION

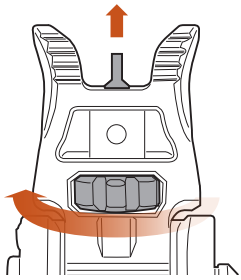

The front sight features the ability to adjust the sight post according to the elevation. Rotate the dial clockwise to raise and counter-clockwise to depress the post.

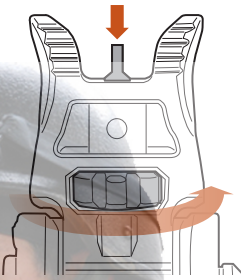

ENHANCED POLYMER REAR BACK UP SIGHT

ENGAGING THE BACK UP SIGHT

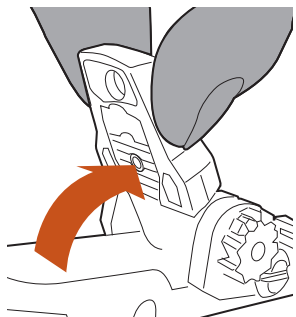

To engage the EPBUIS Rear Sight upright, simply lift the sight by the textural plains on the sides to the ready position.

ADJUSTING SIGHT TO WIND

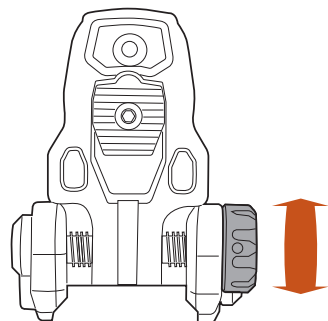

To adjust to the wind, rotate the adjustment dial that can be found on the right side of the sight accordingly.

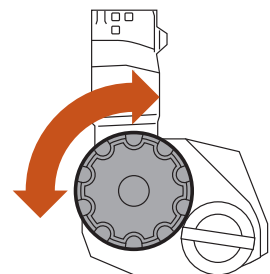

ADJUSTING SIGHT TO WIND

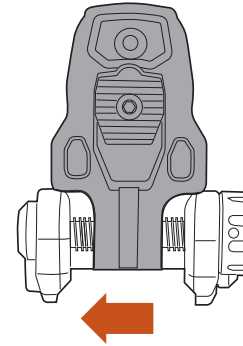

Rotate the adjustment dial counter-clockwise (CCW) to shift the sight to the left.

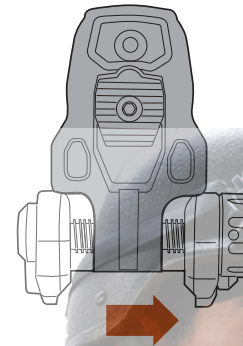
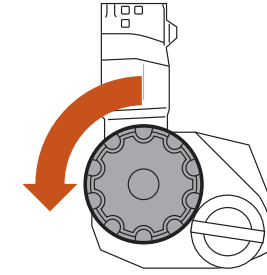

Rotate the adjustment dial clockwise (CW) to shift the sight to the right.

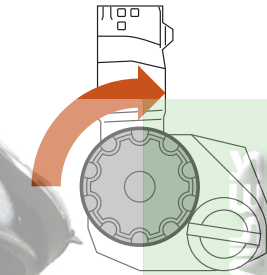

ENHANCED POLYMER REAR BACK UP SIGHT

ENGAGING THE BACK UP SIGHT

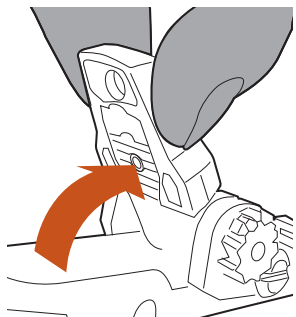

To engage the EPBUIS Rear Sight upright, simply lift the sight by the textural plains on the sides to the ready position.

ADJUSTING SIGHT TO WIND

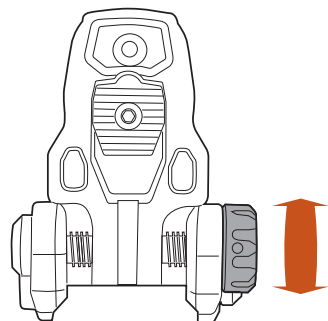

To adjust to the wind, rotate the adjustment dial that can be found on the right side of the sight accordingly.

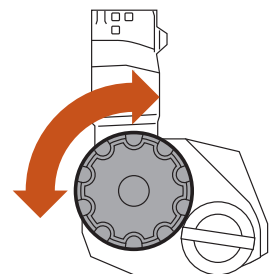

ADJUSTING SIGHT TO ELEVATION

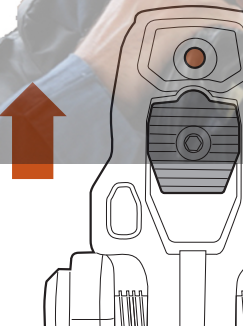

The sight features a dual-plane flip aperture plate, to switch between small and large apertures. Simply raise the aperture plate to switch to a small aperture for greater accuracy at longer distances.

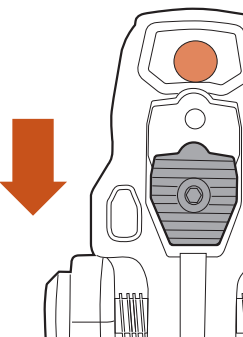

To switch to the larger aperture, engage the aperture plate downwards for quicker target acquisition in close quarter situations.



ENHANCED POLYMER STOCK

ADJUSTING THE ENHANCED POLYMER STOCK

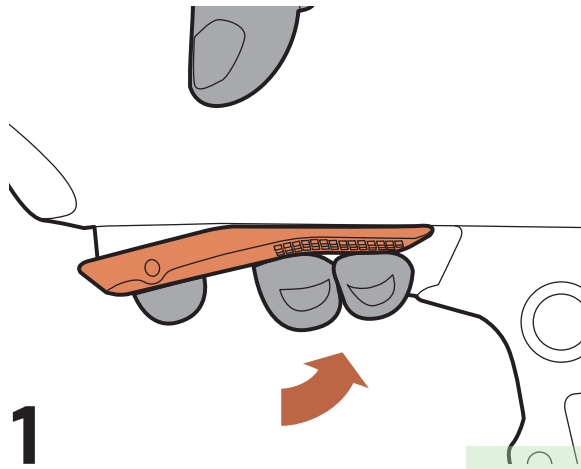

1

To enable the stock to be adjusted, depress the Stock Extension Lever at the underbelly of the stock.

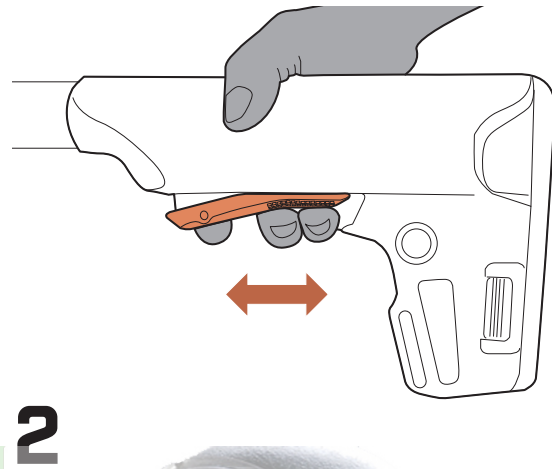

2

Whilst keeping the lever depressed, slide the stock towards or away from the receiver for the desired length of pull.

ATTACHING / DETACHING THE ENHANCED POLYMER STOCK

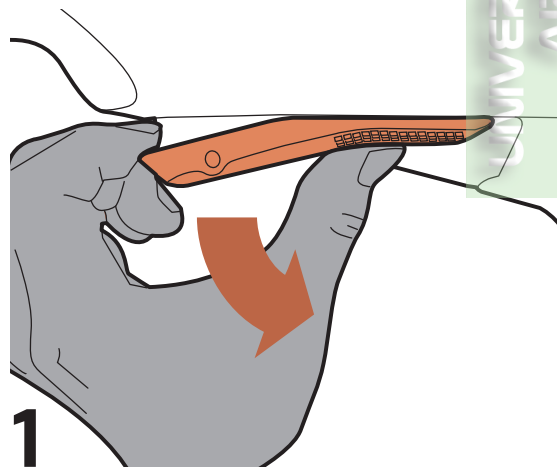

1

To attach/detach the stock, depress the Stock Extension Lever. Whilst using your thumb to keep the lever depressed, use your fingers to pull the front-end down.

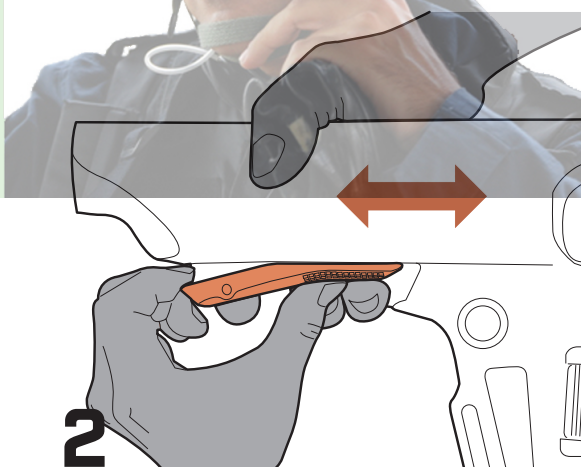

2

Keeping the lever depressed and the front-end pulled down, slide the stock in/out along the buffer tube to attach/detach.

BATTERY INSTALLATION

The battery that powers the PTS Centurion Arms C4 ERG can be contained within the C4's EPS stock.

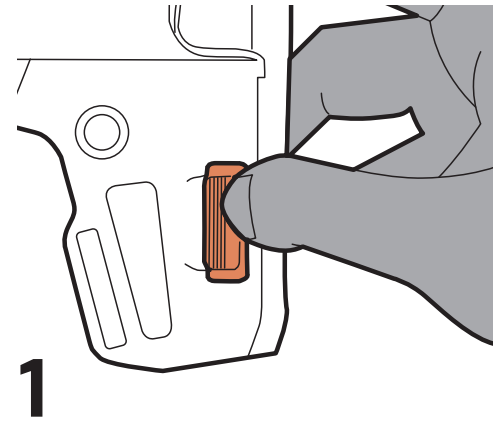

1

To access the battery compartment within the stock, depress both buttons on either side of the stock.

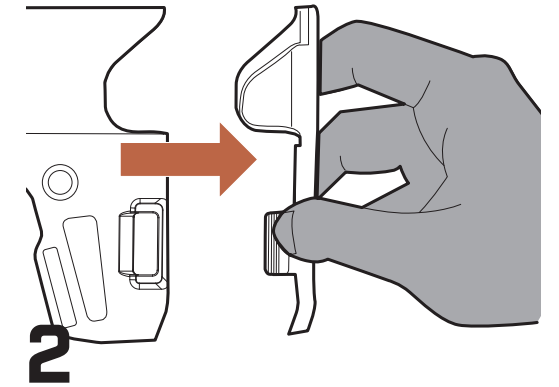

2

Keeping both buttons depressed, pull the buttplate away from the stock.

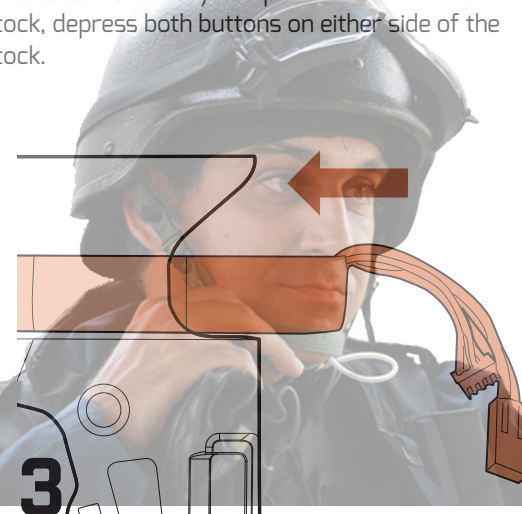

3

Once the compartment is open, insert the battery inside the stock.

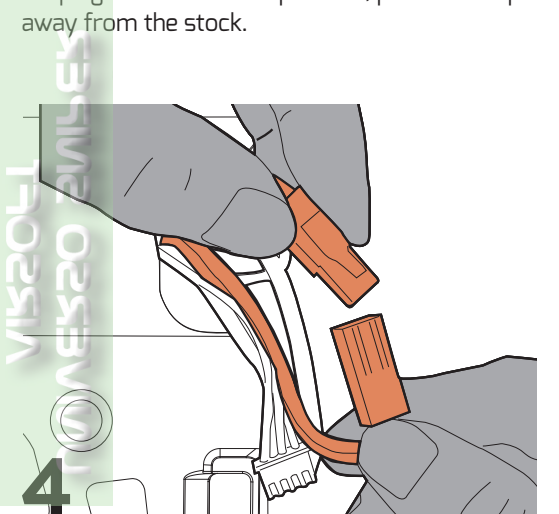

4

Then attach the male plug from the ERG system into the female connector from the battery.

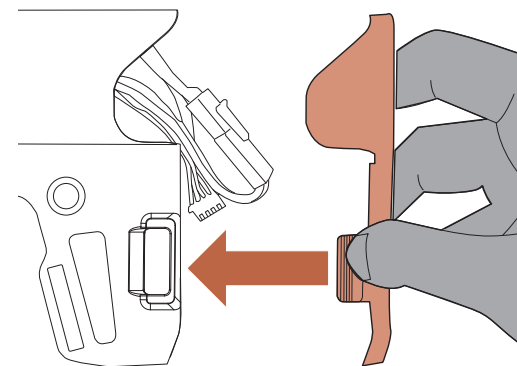

5

Once the battery is plugged in, re-attach the buttplate back into the stock.

AUTO CUT-OFF FEATURE

The PTS Centurion Arms C4 ERG has an electrical auto cut-off designed to replicate how a real AR-15 stops firing after the last round is fired.



The PTS Centurion Arms C4 ERG has an electrical auto cut-off designed to replicate how a real AR-15 stops firing after the last round is fired.

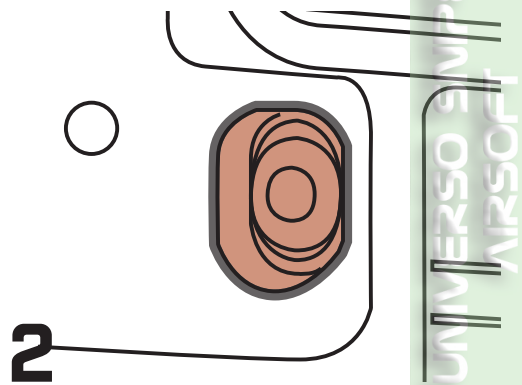

To reactivate the gun, first depress the magazine release on the right side of the receiver.

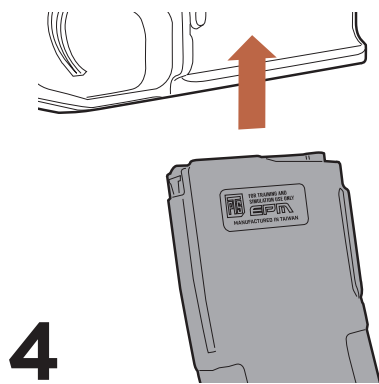

Insert a loaded EPM (ERG).



Then remove the empty Enhanced Polymer Magazine (ERG).

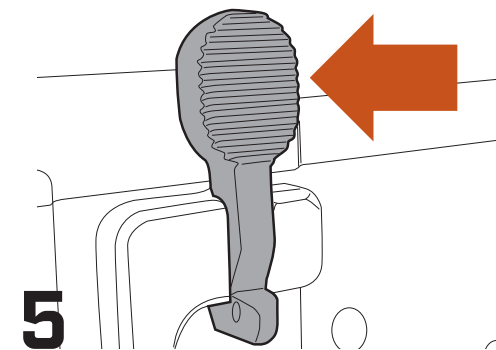

Once the loaded magazine is inserted, depress the bolt release on the left side of the receiver. The firing action is reactivated.

CLEANING THE BARREL

Occasional barrel cleaning of the PTS Mega Arms MML MATEN .308 GBBR is highly recommended to ensure optimal performance.

- Ensure the safety is engaged.
- Remove the magazine and clear the chamber of loaded BBs.
- Disable the hop-up by rotating the hop-up unit ring to the OFF position (see Hop-Up adjustment section).
- Separate the upper and lower receiver (see Disassembly section).
- Using a 1" x 0.5" cotton cloth strip, insert one end of the cloth into the hole in the cleaning rod and wind the cloth around the rod.
- Gently insert the cleaning rod through the front of the inner barrel to clean the barrel's bore. Push the rod all the way through and out the rear of the upper receiver. Repeat as necessary.
- It is NOT recommended to use any cleaning solutions nor silicone oil sprays to clean the inner barrel. A dry cloth strip should suffice.

DISASSEMBLY

- Remove the magazine.
- Pull back and release the charging handle to reset the hammer. Note: The bolt must be forward in the "FIRING" position.
- Set the safety selector to SAFE.

REMOVING THE BOLT CARRIER GROUP

- Push the Rear Takedown Pin as far as it will go from the left side of the receiver (the pin is captured and will not come out completely).
- Pivot the Upper Receiver open.
- Push in the Pivot Pin at the front of the Lower Receiver as far as it will go from the left side of the receiver.
- Separate the Upper Receiver from the Lower Receiver.
- Remove the Bolt Carrier and charging handle to the rear.

Reverse disassembly actions to reassemble the Centurion Arms CM4 ERG.

CLEANING THE RECEIVER COMPONENTS

- Use a clean cotton cloth to wipe down the surface of the charging handle and bolt carrier assembly.
- Use a clean cotton cloth to clean inside the upper receiver and magazine well.
- Clean the remainder of the Airsoft gun with cotton-tipped swabs, or general purpose cleaning cloths.
- Place a small amount of silicone oil* on:
 - The length of the charging handle
 - The rails and cylinder of the bolt carrier
 - The hammer roller
 - The magazine seals and o-rings. Unload BBs from the magazine. Make sure the magazine is free of gas before lubricating the magazine's charging valve and release valve.

* There are various different brands and types of silicone oil lubricant on the retail market for various different end uses, however we recommend using only silicone oil lubricant manufactured specifically for airsoft ERG purposes. Never use WD-40 or other types lubricants as that may damage the components.

EXPLODED VIEW

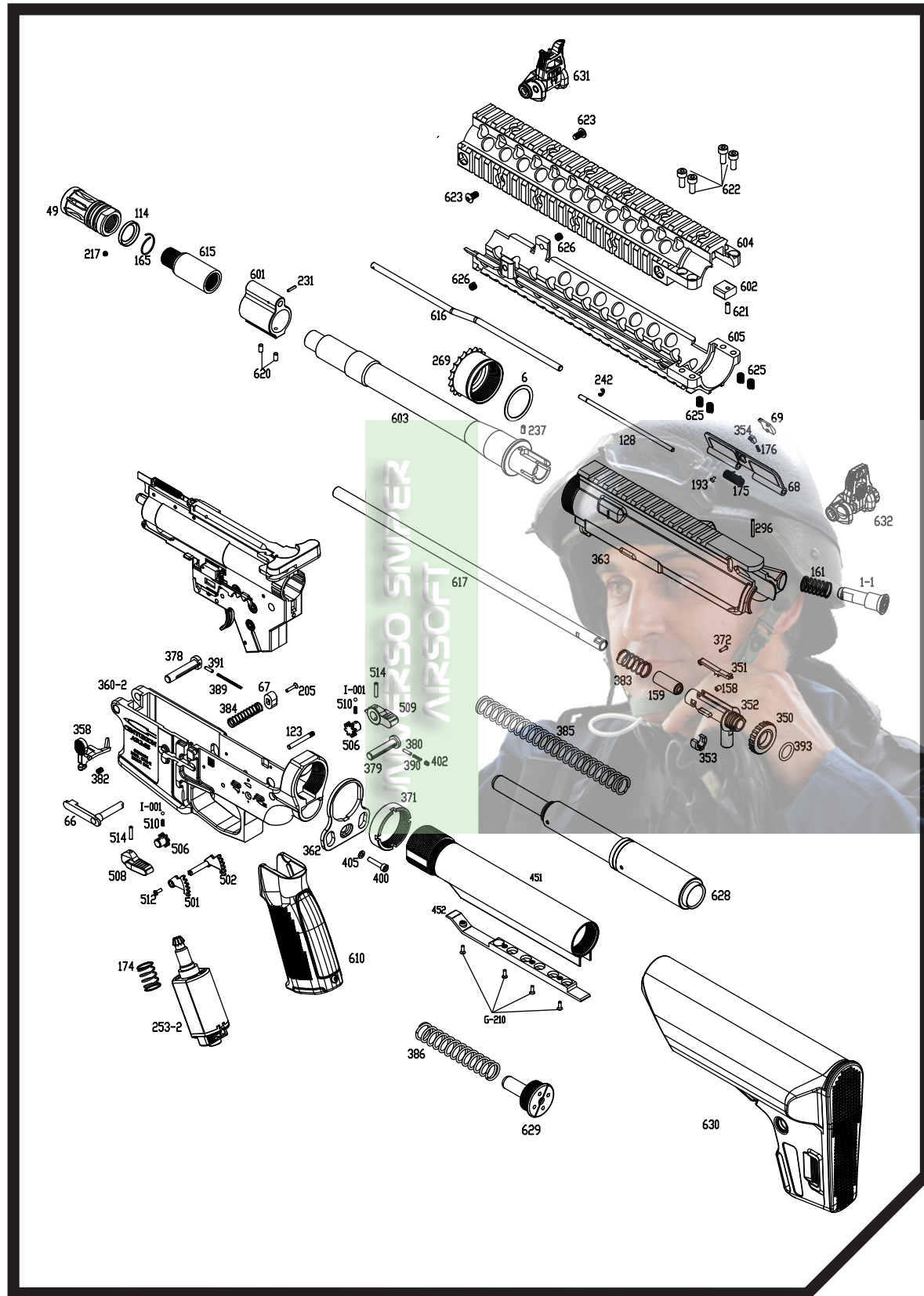

- | | | |
|-----------------------------|------------------------------|-------------------------------|
| 1-1 Assist Knob | 351 Hop Cushion Holder | 406 Bearing Plate |
| 6 Barrel Lock Ling Plate | 352 Hop Chamber | 407 Bearing Washer |
| 40 Cleaning Hed1 | 353 Inner Barrel Lock | 440 Inner Barrel |
| 41 Cleaning Hed2 | 354 Port Cover Lock | 451 Stock Buffer Base |
| 42 Cleaning Hed3 | 357 Recoil Weight Washer | 452 Buffer Tuber Under |
| 49 Compensator | 358 Bolt Catch | 463 Fuse |
| 65 Motor Shaft Guide | 360-2 Lower Frame | 464 Fuse Case |
| 66 Mg.Catch | 362 Stock Plate | 501 RM4 Slecter Link Gear |
| 67 Mg.Catch Button | 363 Upper Frame | 502 RM4 Slecter Link Gear |
| 68 Port Cover | 371 Buffer Lock Ring | 506 Slecter Gear |
| 69 Port Cover Cap | 372 Hop Chamber Pin | 508 RM4 Slecter Lever L |
| 114 Compensator Collar | 373 Piston SP Guide | 509 RM4 Slecter Lever R |
| 115 Motor Push Screw | 374 Recoil Weight F | 510 Slecter Gear SP |
| 115-1 Motor Push Screw Pipe | 375 Recoil Weight SP Guide | 512 Screw(M2x6) |
| 123 Gear Box SetPin | 376 Washer Holder | 514 Screw(M2x10) |
| 128 Port Cover SetPin | 378 Frame Lock Pin F | 601 Gas Block |
| 139 Lower Fream Pin | 379 Frame Lock Pin R | 602 C4 Rail 10 Inch Pipe Base |
| 141 Lower Fream Pin | 380 Frame Lock Pin Stopper | 603 O.B.Barrel |
| 158 Hop Cushion Parts | 381 Recoil Weight R | 604 C4 Rail 10 Inch Upper |
| 159 Rubber Chamber | 382 Bolt Catch SP | 605 C4 Rail 10 Inch Lower |
| 161 Assist Knob SP | 383 Hop Chamber SP | 610 EGP-C Grip Assy |
| 165 Compensator SP | 384 Mg Catch SP | 615 Barrel Adupter |
| 174 Motor Set SP | 385 Piston SP | 616 C4 Rail 10 Inch Pipe |
| 175 Port Cover SP | 386 Recoil Weight SP | 617 Inner Barrel |
| 176 Prot Cover Lock SP | 389 Frame lock Pin F SP | 620 Screw(G-004) |
| 193 Screw(M1.6x3) | 390 Frame lock Pin F SP | 621 Screw(G-006) |
| 205 Hex Screw(G-105) | 391 Frame Lock Pin Stopper-F | 622 Screw(G-602) |
| 217 Hex Screw(G-012) | 392 Recoil Weight Cushion | 623 Screw(M4x10) |
| 227-1 Washer Screw | 393 O-Ring(φ2-φ11) | 625 Helical Insert(M4X7) |
| 231 Spring Pin | 394 O-Ring(φ2-φ23) | 626 Helical Insert(M4X4) |
| 237 Spring Pin | 396 Spring Pin(φ2.5x18) | 628 Recoil Weight Assy |
| 242 E Ring | 397 Spring Pin(φ2.5x22) | 629 Buffer End Assy |
| 247 Switch Life Extender | 399 Hex Screw(M2.5x4) | 630 EPS Stock Assy |
| 253-3 Motor | 400 Hex Screw(M3x16) | 631 Front Sight Assy |
| 254 Pinion Gear | 401 Steel Ball | 632 Rear Sight Assy |
| 255 Front Sight Wrench | 402 Hex Screw(M2.5x4) | |
| 269 Barrel Lock Ring | 404 Screw(M3x12) | |
| 296 Spring Pin(φ2x16) | 405 Spring Washer | |
| 350 Hop Adjust Dial | | |

Universe Simper
AIRSOFT



The left page features a central image of a man in a dark blue tactical uniform and helmet. He is looking to his right. The image is mirrored across the page. A vertical green bar with the text "Universe Simper AIRSOFT" is positioned to the left of the image. The page is filled with horizontal lines for writing, with a diagonal cut at the bottom right corner.

VISUALI
TOSIVI



The right page features a central image of a man in a dark blue tactical uniform and helmet. He is looking to his left. The image is mirrored across the page. A vertical green bar with the text "VISUALI TOSIVI" is positioned to the right of the image. The page is filled with horizontal lines for writing, with a diagonal cut at the bottom right corner.



PROFESSIONAL TRAINING & SIMULATION

As the worldwide exclusive licensee of a wide variety of airsoft products and brands, PTS prides itself in helping create the most authentic experience possible - both on and off the battlefield. Nothing else handles like PTS because nothing else is made like PTS, guaranteed. Each and every brand in the PTS family must pass rigorous testing requirements. And it's only the most realistic, precision engineered and innovatively designed that make the cut. In the end, you can be assured that the PTS family of brands offers a singular opportunity to own one of the finest, most trusted, field-tested brands ever assembled. Welcome to the PTS experience.



WARNING!

User restricted to 18 years of age or older.

You must read through this instruction Manual before operating this airsoft gun.

Always wear proper eye and face protection.

Obey all your local laws and regulations regarding ownership and usage of airsoft guns.

Misuse or careless use may result in serious injury or other consequences.

MADE IN TAIWAN

www.ptssyndicate.com
sales@ptssyndicate.com

Centurion Arms® logo and related brand names are trademarks of Centurion Arms, LLC. in the United States and/or other countries and are used for airsoft replicas under exclusive worldwide license by PTS Syndicate, Ltd. www.ptssyndicate.com