

Special thanks KSK(Kommando Spezialkräfte) Prague , Czech Republic for providing these pictures



SERIES  
**SRF5**  
6MM Cal. AIRSOFT RIFLE



**INSTRUCTION MANUAL**

MADE IN TAIWAN

UNIVERSO SNIPER  
AIRSOFT



Model:GE-TM



Dealer



星虹玩具有限公司  
STAR RAINBOW TOYS CO.,LTD

Address : Room D2. No. 36, Alley 82, Lane 422, Minzu Rd., Lujhou City ,  
Taipei County 247 ,Taiwan (R.O.C.)  
TEL:886-2-82853848  
FAX:886-2-28484622  
E-mail:src@starrainbow.com.tw  
Web:www.starrainbow.com.tw

# SERIES SR5

6MM Cal. AIRSOFT RIFLE



## SAFETY INFORMATION



When using airsoft guns eye protection is required (goggles or mask)

Never place your finger on the trigger until you are ready to fire the gun. Always put the gun in safe mode when not in use. Treat every gun as if it is loaded.



Please keep away from children



!?

Please select a safe place to fire your airsoft gun. Always know your state and local laws concerning airsoft gun use.



BBs may remain in the barrel after magazine removal. To avoid injury, never look directly into the barrel and ensure the gun is always pointed in a safe direction.



Do not aim or shoot at humans, animals, buildings, or vehicles.



Disassembly or modification of this product may result in damage to your Airsoft gun, loss of warranty, and/or serious injury.



Please use a firearm case or bag when transporting your airsoft gun.



## SR5 SERIES MODELS



SR5-KA4  
GE-0541TM



SR5-PDW  
GE-0542TM



SR5-SD4  
GE-0537TM



SR5-AS  
GE-0531TM



SR5-AF  
GE-0534TM



SR5-SD5  
GE-0538TM



SR5-A4  
GE-0532TM



SR5-A5  
GE-0535TM



SR5-SDF  
GE-0539TM



SR5-AU  
GE-0533TM



SR5-SDU  
GE-0536TM



SR5-SD6  
GE-0540TM

# SERIES SA5

6MM Cal. AIRSOFT RIFLE

## SA5 Series Parts Description

FULL METAL SUBMACHINE GUN



# Installing the Battery

(SD Handguard type)

FULL STEEL SUBMACHINE GUN

STEP 1



Please use a fully charged 2 stick SRC 8.4v Battery.

STEP 3



1. Insert the battery into the Handguard.  
2. Connect the battery leads.

STEP 2



1. Rotate the Silencer counter clockwise.  
2. Remove the Silencer to expose battery compartment.

STEP 4

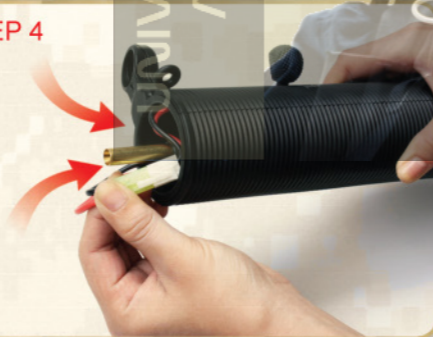

Tuck all wires into the Handguard gently.

**WARNING** 1. Remove the battery from device when not in use.  
2. Please use high-quality, CE approved batteries.

FULL STEEL SUBMACHINE GUN

STEP 5



Reinstall the Silencer.



Complete installation

## ACCOMMODATING SRC BATTERY PRODUCT

**BT-22**  
HP 2/3A 9.6V  
1600mA Ni-MH



**BT-17**  
HP 2/3A 8.4V  
1200mA Ni-MH



**BT-18**  
HP 2/3A 9.6V  
1200mA Ni-MH



**BT-07**  
7.4V  
1100mA Lithium-Polymer



**BT-08**  
11.1V  
1100mA Lithium-Polymer



# Installing the Battery

(PDW Upper Receiver type)

FULL STEEL SUBMACHINE GUN

FULL STEEL SUBMACHINE GUN



Please use a fully charged one stick SRC 8.4v battery.



Remove the foregrip locking pin.



Remove the foregrip.



STEP 6  
1. Let the battery lead passes through the hole.  
2. Connect the battery leads.



STEP 7  
Reinstall the fore grip.



STEP 8  
Reinstall the locking pin



Remove the locking pins



Remove the butt cap .



STEP 5  
Insert the battery into the upper receiver.  
(Please note the wire, when you insert the battery)



Reinstall the butt cap.



Reinstall the locking pins



**Installing the Battery ( Fixed Stock type )**  
FULL METAL SUBMACHINE GUN

STEP 1

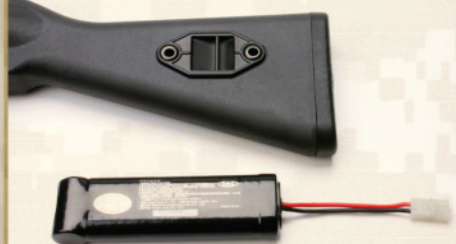

Please use a fully charged SRC 8.4v Battery.

STEP 3

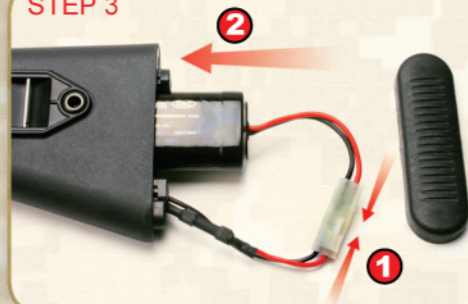

1. Connect the battery leads.  
2. Insert the battery into the stock.

STEP 2



1. Push cover downward.  
2. Remove cover to expose battery compartment.

STEP 4



Tuck all wires into the stock. Follow step 2 in reverse to install the battery compartment cover.

**Installing the Battery ( HandGuard type )**  
FULL METAL SUBMACHINE GUN

STEP 1



Please use a fully charged SRC 8.4v Battery. Remove the forward Lock Pin from the handguard.

STEP 2



1. Carefully pull the handguard downwards.  
2. Slide the handguard forward and remove from the gun.

STEP 3

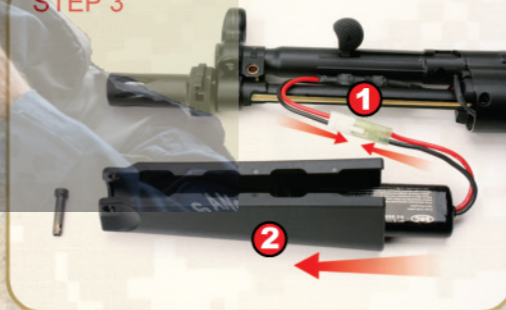

1. Connect the battery leads.  
2. Insert the battery into the handguard.

STEP 4

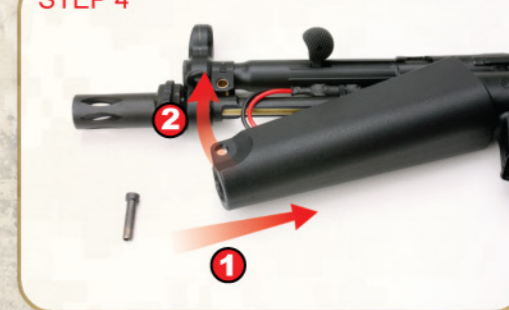

Reinstall the handguard.

**WARNING**

1. Remove the battery from device when not in use.
2. Please use high-quality, CE approved batteries.



**Installing the Battery ( Hand Guard type )**  
FULL METAL SUBMACHINE GUN



STEP 5



Insert the locking pin.

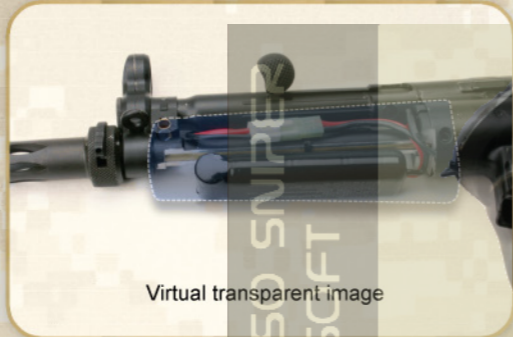

Virtual transparent image

Install complete

FULL METAL SUBMACHINE GUN  
**Loading the Magazine**

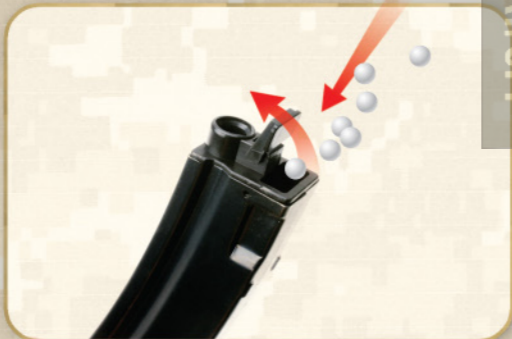

Open the BB well cover and fill with BBs

**WARNING**

Use SRC Precision BBs only. The use of low-quality BBs may cause damage to your airsoft gun.

**Loading the Magazine**  
FULL METAL SUBMACHINE GUN



Rotate the wheel on the bottom of the magazine until you hear the clicking sound change.



Insert the Magazine until you hear it click into place. The gun is now ready to fire.

FULL METAL SUBMACHINE GUN

**Shooting Modes**



Safe mode



Semi mode



Auto mode

**WARNING**

- Always keep finger off the trigger until you are ready to fire. Make sure the muzzle is pointing in a safe direction.
- Keep the selector on safe mode until you are ready to shoot.



# Hop- up Adjustment

FULL METAL SUBMACHINE GUN

FULL METAL SUBMACHINE GUN



**Wrong** Hop-Up set to high  
(slide the Hop-Up lever towards NORMAL)

Best position **Right**

**Wrong** Hop-Up set to low  
(slide the Hop-Up lever towards HOP)



To reduce the Hop-Up setting slide the Hop-Up lever towards the NORMAL setting.



To increase the Hop-Up setting slide the Hop-Up lever towards the HOP setting.

## WARNING

- Always keep finger off the trigger until you are ready to fire. Make sure the muzzle is pointing in a safe direction.
- Keep the selector on safe mode until you are ready to shoot.

FULL METAL SUBMACHINE GUN

FULL METAL SUBMACHINE GUN

# Rear Sight Adjustment

## WARNING

Use SRC Precision BBs only. The use of low-quality BBs may cause damage to your airsoft gun.

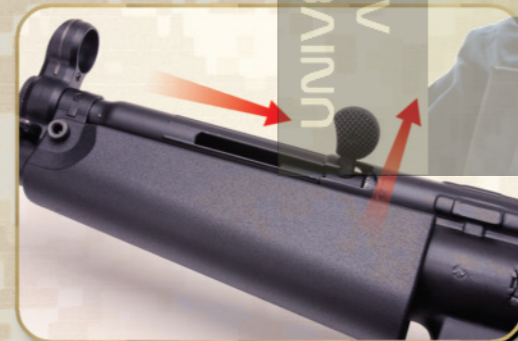

To set Hop-up, pull the charging handle to the rear, exposing the Hop Up lever.

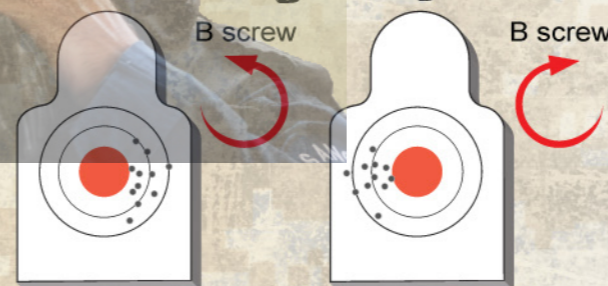

If BBs hit to the right of the target, turn Screw B to the left.

If BBs hit to the left of the target, turn Screw B to the right.



loosen the sight clamp screw.



Turn the adjustment screw to move the rear sight left or right.

**SCREW B**





**Problem one: AEG does not function**

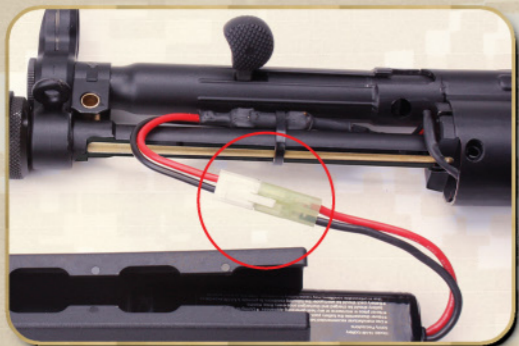

**1** Please check the connectors

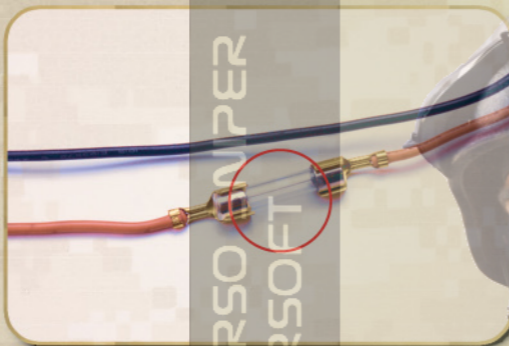

**2** Please check the fuse

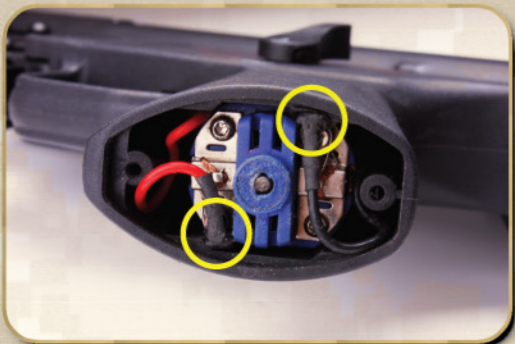

**3** Please check the motor wiring connections.

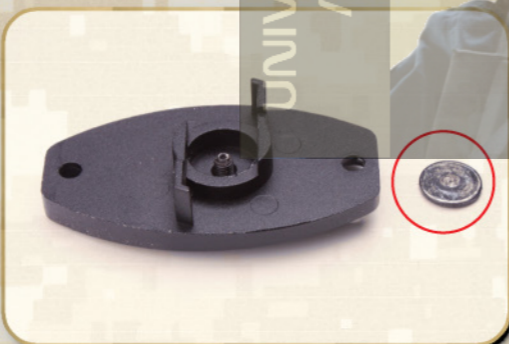

When removing the motor cover be careful not to lose the spacer.

6MM CAL. AIRSOFT RIFLE

**Problem Two: Clearing Jammed BBs**



**1** Remove the magazine.



**2** Turn off the Hop up by sliding the hop-up lever all the way to NORMAL. Use the correct end of the cleaning rod.



**3** Insert the Cleaning rod into the Barrel to remove the jammed BBs..



**4** Use Airsoft Safe Silicone to lubricate the hop up chamber. Use silicone lubricant sparingly..

# SERIES SR5

6MM Cal. AIRSOFT RIFLE

## SR5 SERIES SCHEMATIC

FULL METAL SUBMACHINE GUN

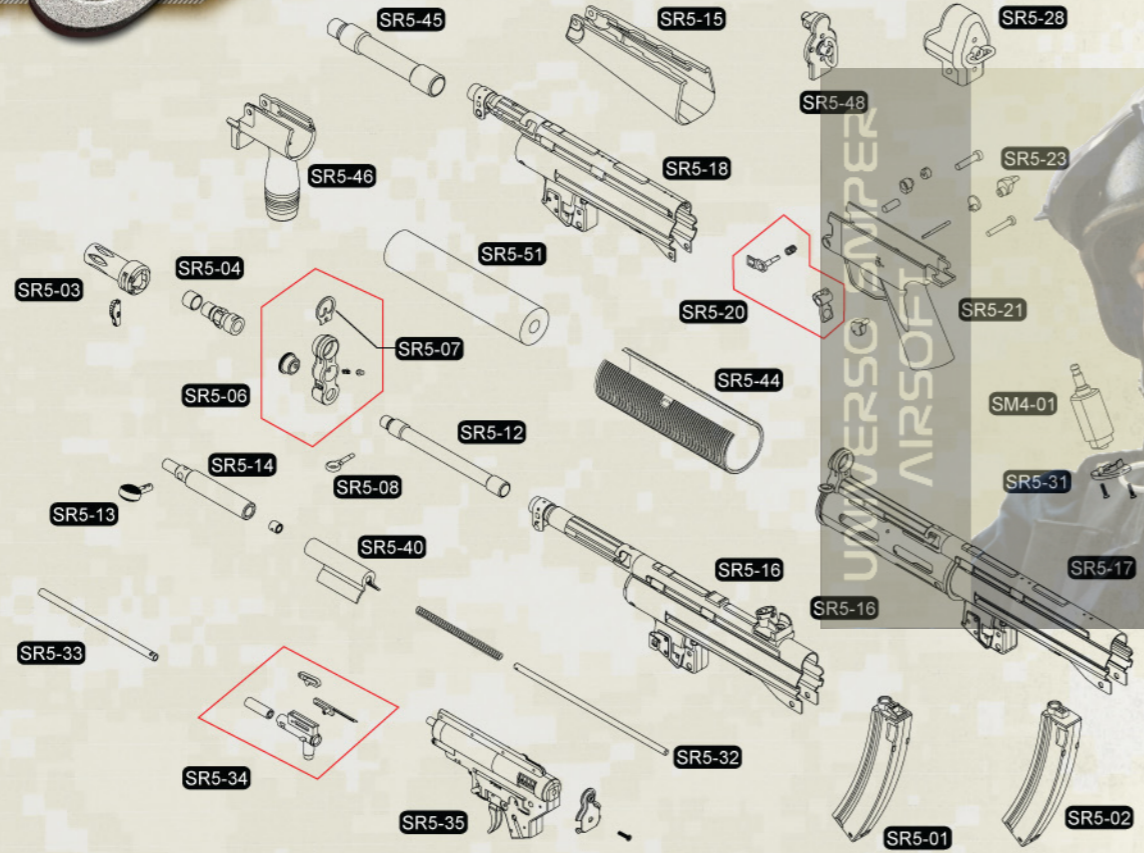

### CAL.6MM AIRSOFT RIFLE

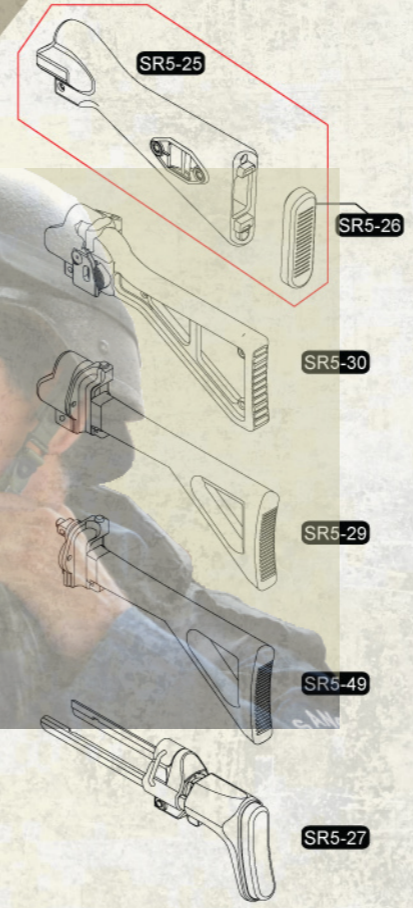

## SR5 SERIES GEAR BOX SCHEMATIC

