

FULL METAL TITAN CO2 REVOLVER

6mm AIRSOFT Ver.
GEL BALL Ver.



- ⚠️ 12 Gram CO2 Cartridge Only
- ⚠️ For Your Safety, Keep Hands And Face Away From Escaping CO2 Gas
- ⚠️ Always Point The Pistol's Muzzle At A Safe Direction
- ⚠️ **WARNING**

1. Do not change, alter, remove, or obliterate any colorations or markings on this gun. The colorations and markings of this product are designed to comply with the laws and regulations of state, federal, and nation.

2. This product could be mistaken as a firearm easily by law enforcement officers or others. Anyone who changes, alters, removes, or obliterate any colorations or markings are supposed to meet the state or federal laws and regulations. In any way that makes this product look like a real firearm is a crime.

Displaying and exposing of this product in any "public places" may cause confusion or even be considered as a crime. The term of "public place" means any areas that opened to the public, including streets, sidewalks, bridges, alleys, plazas, parks, driveways, front yards, parking lots or even automobiles. Buildings that serve food and drink, or provide entertainment, and the doorways and entrances to buildings or dwellings are parts of public places as well. Any person who uses this product in the means of bully, insult, threat or deterrent to cause either physical or mental trauma of another is considered illegal and could result in sentence of imprisonment.

Titan Revolver Series



TITAN 2.5" S



TITAN 2.5" B



TITAN 4" S



TITAN 4" B



TITAN 6" S



TITAN 6" B

6 INCHES SERIES UPPER/LOWER RAIL INSTALLATION



1 Knock out the spring pin of the REAR SIGHT from the right side.



2 Unscrew out the slotted screw on the REAR SIGHT.



3 Remove REAR SIGHT.



4 Slide the UPPER RAIL from the rear part.



5 Lock the screw.



6 Put the REAR SIGHT back on and lock.



7 Knock in the spring pin of the REAR SIGHT then finished.



8 Slide the DOWN RAIL in.



9 Lock the screw.

TITAN 6mm/ GEL CO2 REVOLVER 6" / 4" / 2.5" INCH SERIES EXPLORED VIEW

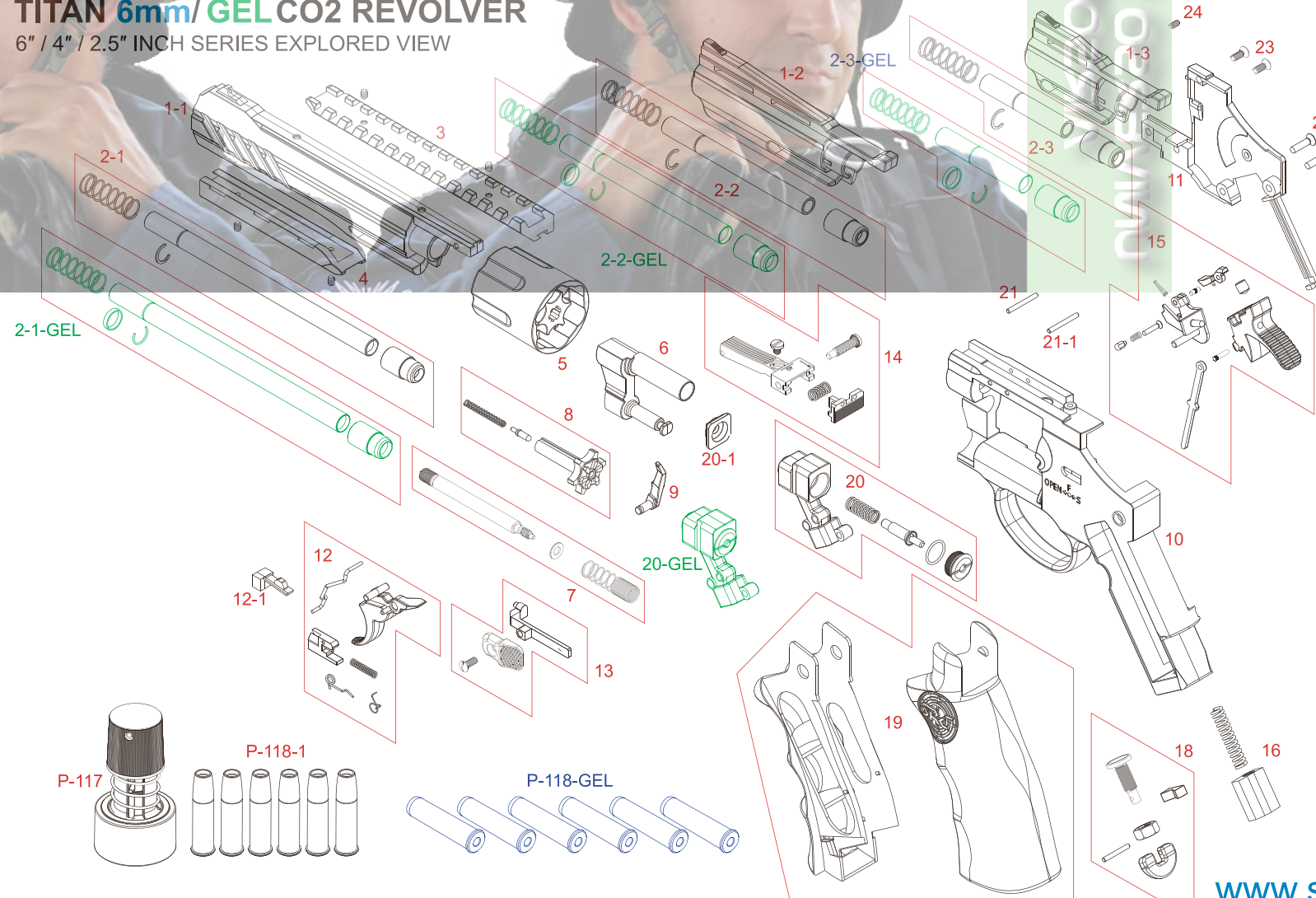

| | |
|---------|----------------------------|
| 1-1 | OUTER BARREL (TITAN 6") |
| 1-2 | OUTER BARREL (TITAN 4") |
| 1-3 | OUTER BARREL (TITAN 2.5") |
| 2-1 | INNER BARREL (6mm 6") |
| 2-2 | INNER BARREL (6mm 4") |
| 2-3 | INNER BARREL (6mm 2.5") |
| 3 | UPPER RAIL (TITAN 6" ONLY) |
| 4 | DOWN RAIL (TITAN 6" ONLY) |
| 5 | CYLINDER |
| 6 | CRANE |
| 7 | EXTRACTOR ROD SET |
| 8 | EXTRACTOR |
| 9 | HAND |
| 10 | FRAME |
| 11 | SIDE PLATE |
| 12 | TRIGGER |
| 12-1 | CYLINDER HOLDER |
| 13 | CYLINDER RELEASE / SAFETY |
| 14 | REAR SIGHT |
| 15 | HAMMER |
| 16 | HAMMER SPRING |
| 18 | PUNCTURE SCREW |
| 19 | GRIP |
| 20 | CO2 CHAMBER (6mm) |
| 20-GEL | CO2 CHAMBER (Gel) |
| 20-1 | SEALING RUBBER |
| 21 | PIN |
| 21-1 | PIN |
| 22 | SCREW X2 |
| 23 | SCREW X2 |
| 24 | SCREW X1 |
| P-117 | BB LOADER |
| P-118-1 | BULLET X 6 (6mm) |



1 PULL UP THE GRIP COVER.



2 LOAD THE CO2 CARTRIDGE



3 TURN THE BOTTOM LOCK CLOCKWISE TO ACTIVATE.



4 LOAD BB / GEL INTO THE TOP OF BULLETS.



5 PUT SIX BULLETS IN THE BB LOADER.



6 PUSH AND TURN THE RELEASE AXLE CLOCKWISE TO LOCK THE BULLETS.



7 PUSH THE SAFETY / CYLINDER RELEASE FORWARD AND PUSH THE CYLINDER OUT FROM THE FRAME.



8 INSERT BB LOADER INTO THE CYLINDER AND RELEASE IT.



9 PUT THE CYLINDER BACK.