

SD36



UNIVERSO SNIPER
LOS ANGELES



GEN II

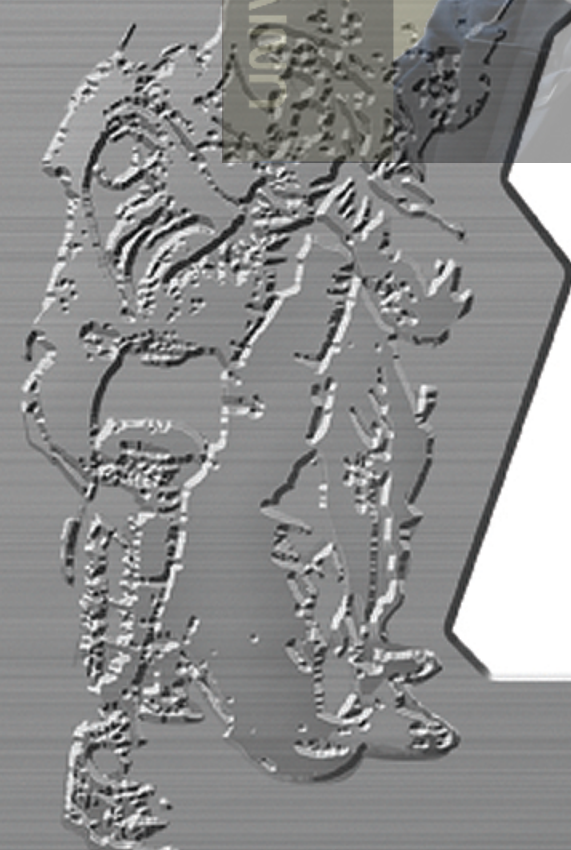

INSTRUCTION
MANUAL

WARNING

- This product is an airsoft airgun. It is to be purchased by person(s) age eighteen (18) years or older. Adult/parental supervision required when used by any persons under the age of eighteen.
- Be responsible, check with your local law enforcement on airsoft airgun regulations.
- Please read the operation manual and fully understand the safe handling of your airsoft airgun before use.
- Pay special attention to your surrounding area when using your airsoft airgun. Do not carry your airsoft airgun in public, in open view, or concealed. Transport your airsoft airgun, unloaded, in locked gun carrier/case. Do not brandish, point, or shoot at other people, animal, or private properties. Such actions may be perceived by others (including law enforcement officers) as a threat and prompt to react, accordingly.
- U.S. Federal regulation requires the orange marking. Do not remove, alter or impair marking. All warranty void if marking(s) are tampered with.
- Enjoy your airsoft airgun in firearm safety/handling training, movie and theatrical production applications, and regulated airsoft sports at at participating playing fields and shooting ranges. Ask your airsoft dealer for details.
- Store your airsoft airgun unloaded, remove batteries, discharge of any gas or spring tension, in a safe and locked location, out of the reach of children.

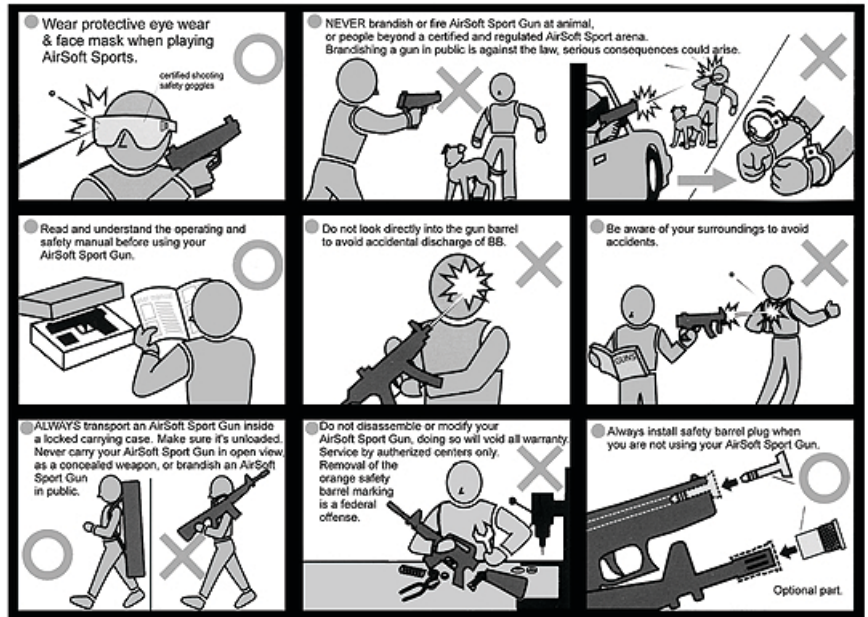

WARNING	
18 Years or older	<ul style="list-style-type: none"> • Operation of this air gun is for training purposes only, at legal training facilities. Users will follow all applicable air gun laws and regulations. Sales and usage restricted to persons 18 years of age or older.
Injury Caution	<ul style="list-style-type: none"> • Plastic BB's can reach 50 to 60 meters, and up to 300 fps. Careless shooting and mis-handling may result in severe eye damage and/or other injuries. Always wear eye and body protection. Never point or shoot at people or animals.
Please read manual!	<ul style="list-style-type: none"> • Always follow safe handling and precautions listed in the manual. Understand fully all operations of this air gun. Use this air gun with full recognition of it's caution warnings. Use within full compliance of State and local laws.
CHOKING HAZARD Keep away from small children. Contact your Dealer for a replacement manual.	

Component Names

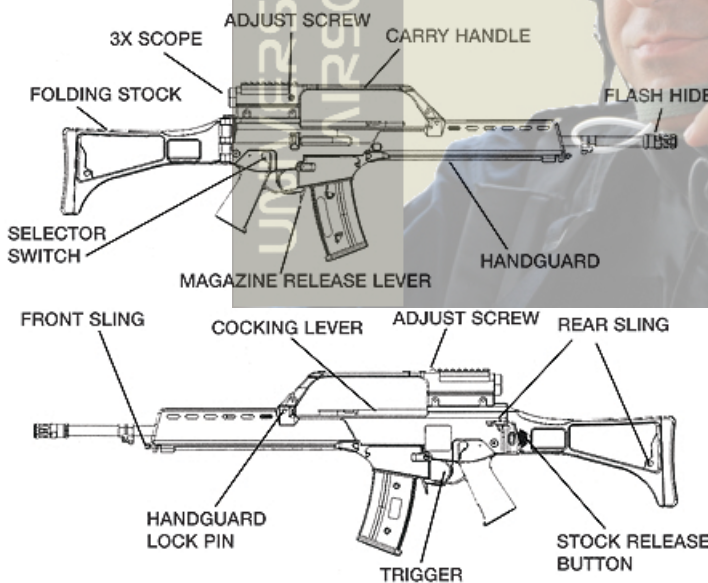

1 Selector Switch/Safety Setting

Safety Setting

- On: The trigger cannot be pulled
- SEMI auto (single shot) Fires one shot, each time the trigger is pulled.
- FULL Automatic Fires continuous while the trigger remains pulled.

WARNING
 Pulling the trigger with the selector switch being set to safe may cause damage!

WARNING
 Never operate the selector switch while pulling the trigger! It may cause damage!

2 Installing Battery

Remove the magazine and direct the muzzle toward a safe direction, and always set the selector lever to the Safety position.

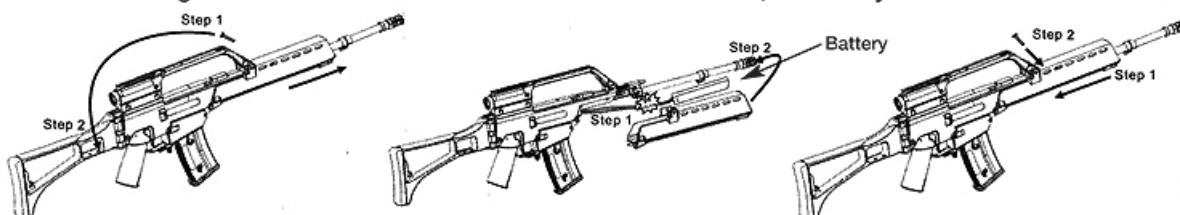

- Remove handguard lock pin, place in stock to prevent losing.
- Remove the handguard.
- Put the battery into the handguard and connect the battery connectors.
- Replace the handguard.
- Replace the handguard lock pin.

Charge the Battery Pack when current is low. Use only the specified battery charger. Battery mAh Capacity / Charger Output = Charging Time. Do not over-charge battery.

3 How to Use Magazine

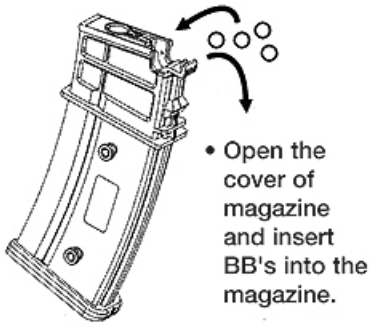

- Open the cover of magazine and insert BB's into the magazine.

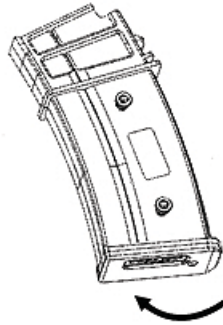

- Turn the gear at the bottom until the "click" changes to a "clack".

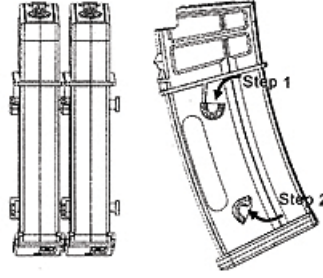

- Two magazines can be connected together using the clips on the side of the magazine.

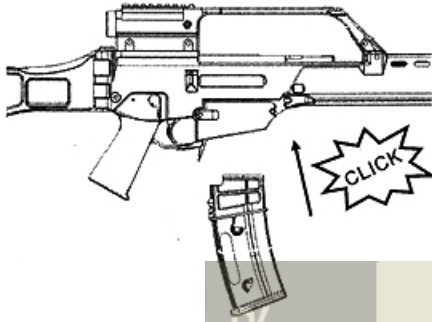

- Insert the magazine as picture shows until the "click" sound is heard.

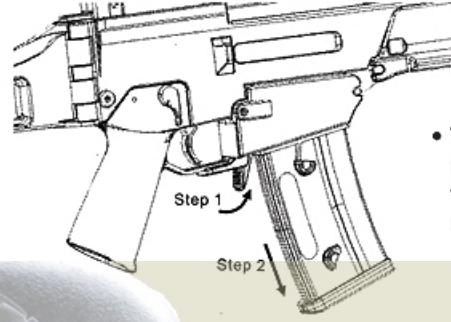

- To remove the magazine, press the magazine release button.

4 Variable Hop Up System

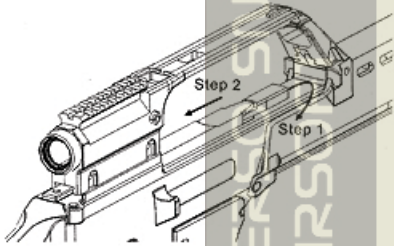

- Pull and hold back the charging handle.

WARNING

Because a precision tight bore barrel is installed. Using dirty or recycled BBs will cause a jam and damage the gearbox. Do not Recycle BBs!

Hop Up Adjustment

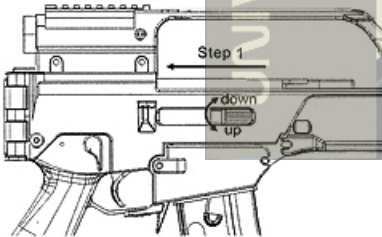

- Locate the Hop Up Adjustment Dial, on the right side of the receiver.
- Slide the Hop Up Adjustment Dial to desired position.
- Shoot a few rounds, exam the trajectory and make further adjustments, as needed.

CAUTION

Never hold the gun sideways as the BB will curve right or left.

- Recommended BB's:  .20g, .23g and .25g, for best performance.

○ Too much Hop Up

○ Best

○ Not enough Hop Up

- The best position is when the bullets fly horizontally and the longest flying distance is obtained



5 Setting the Sight

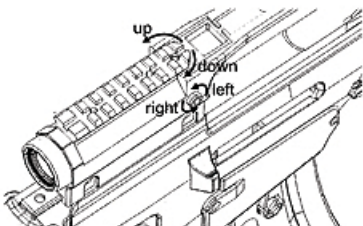

- Adjust the sight vertically by turning the elevation adjusting knob up or down.

- Adjust the sight horizontally by turning the windage adjusting knob left or right.

6 Folding Stock

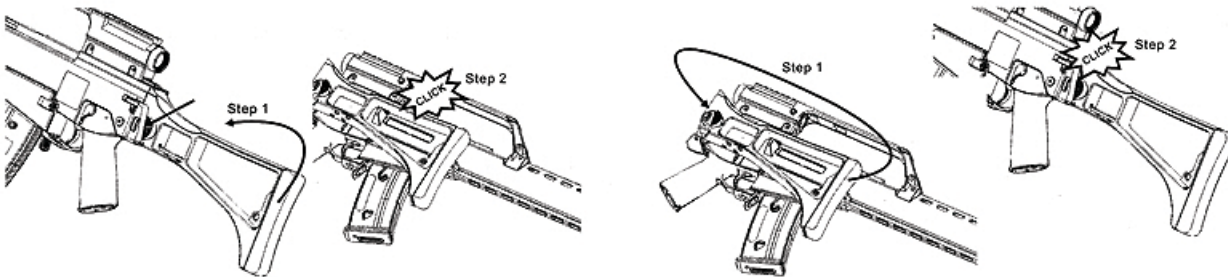

To Fold:

- Press stock release button to release folding stock.
- Fold stock and lock into position.

To Unfold:

- Pull stock from folded position.
- Unfold stock and lock into position.

7 Maintenance and Removing Clogged BB's

1. Drop a few drops of silicone oil into BB entrance. Insert BB's into the magazine and fire equivalent of 1 or 2 magazines.
2. To complete the cleaning, use the cleaning rod (with cotton) as shown below, to remove excess oil.

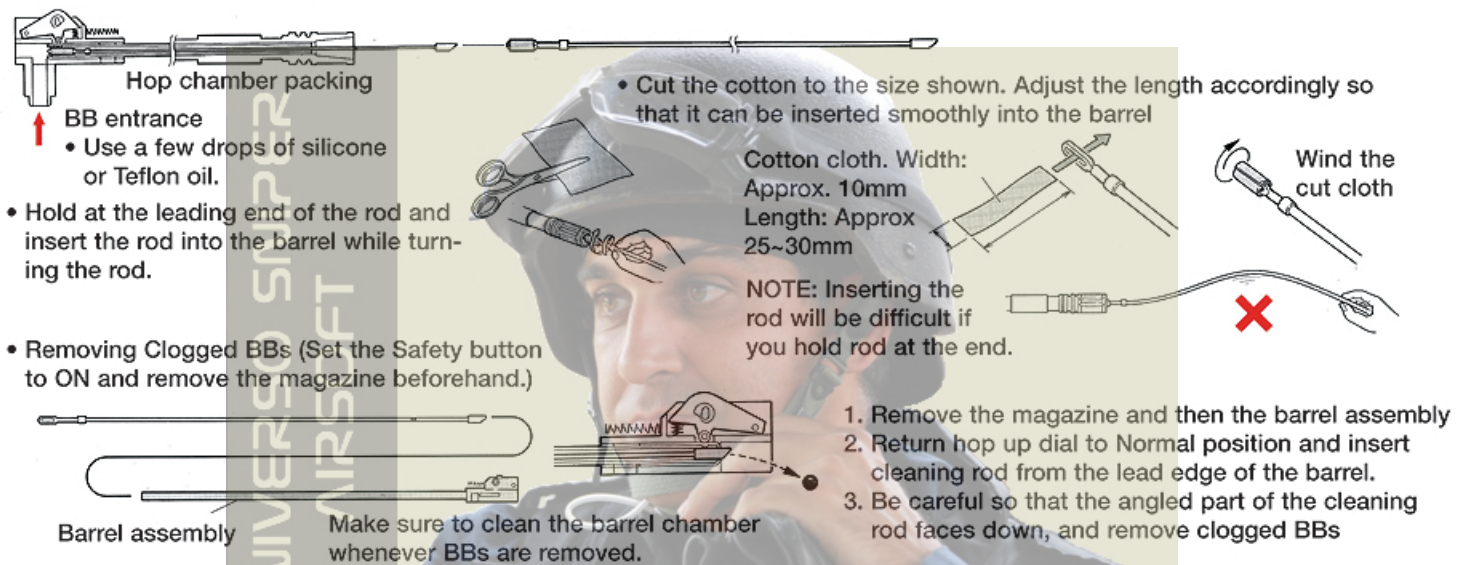

Troubleshooting

SYMPTOM	CAUSE	ACTION
No operation at all	Selector lever set to SAFE	Set the selector lever to AUTO or SEMI
	Battery is not charged	Charge the battery
	Battery connector is disconnected	Connect the connector
	Expired motor life (50,000)	Replace the motor
	FUSE is blown out	Replace the FUSE
Motor is revolving but gun doesn't work	Faulty Gear	Purchase the replacement gear from the dealer
	Bullets are clogged in the chamber	Using the cleaning rod to remove the bullet
	Bullets are clogged in the magazine	Shake the magazine
Malfunction of SEMI auto	Deviation in gear timing	Set to SEMI after firing 2~3 sec in Full AUTO
	Faulty gear lever	Purchase the replacement parts from the dealer
Malfunction of FULL auto	Deviation in gear timing	Set to SAFE first then set to Full auto again
	Faulty gear lever	Purchase the replacement parts from the dealer
Firing circle slow	Insufficient battery power	Charge the battery
Shooting distance short	HOP UP system doesn't working	Adjust HOP UP
	Faulty BB bullets	Please use only high quality precision BB's
	Faulty O-ring	Purchase the replacement parts from the dealer
Loud, Grinding or Other	Gearbox problem	Discontinue use & contact TeamSD Service Center

