

3M

PELTOR™ ComTac XPI MT20H682*

The Sound Solution



PELTOR™

A)



B)

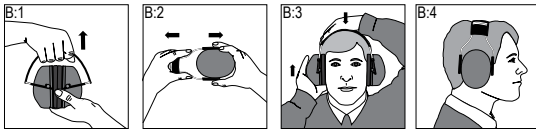

C)



D)



E)

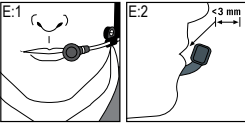

F)

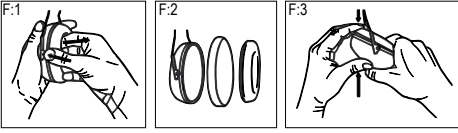

G)

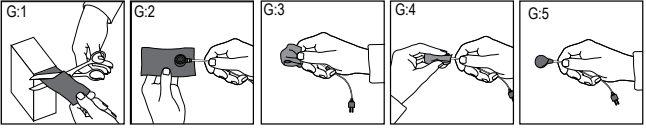

3M™ PELTOR™ Comtac XPI

3M™ PELTOR™ Comtac XPI is a headset with level-dependent function for ambient listening and input for external equipment. Differences in available features may appear on specific models. Read these instructions carefully before use and save for future reference.

1 COMPONENTS

- A:1 Foldable Headband (stainless steel sheet, leather)
- A:2 Two-point fasteners (POM)
- A:3 Cup
- A:4 Battery lid
- A:5 [+] button
- A:6 [-] button
- A:7 Speech microphone input (J22) (only specific models)
- A:8 Ear cushion (PVC foil, PUR foam)
- A:9 Microphone for level-dependent function for ambient listening
- A:10 Cup supporting arm (Stainless steel)
- A:11 Neckband (stainless steel, TPO)
- A:12 Speech microphone (TPE, PC) (only specific models)
- A:13 External input cable (PUR) (only specific models)

2 FITTING AND ADJUSTMENT

Note! Brush aside hair around your ears so the ear cushions (A:8) fit snugly.

2:1 Foldable headband (Fig. B)

- (B:1) Open the headband
- (B:2) Slide out the cups and tilt the top of the cup out, as the cable must be on the outside of the headband.
- (B:3) Adjust the height of the cups by sliding them up or down while holding the headband in place.
- (B:4) The headband should be positioned across the top of your head.

When storing a headset with foldable headband, slide the cups in before folding the headband. Leave about 4 mm (1/8 in) of the headband wire visible. Check that the ear cushions are not creased and that they lie flat against one another.

2:2 Neckband (Fig. C)

- (C:1) Place the cups in position over the ears
- (C:2) Keep the headset in position and place the head strap on top of your head and lock it tight in position.
- (C:3) The head strap should be positioned across the top of your head.

2:3 Helmet attachment (Fig. D)

- (D:1) Attach the helmet attachment by sliding it onto the spline on the side of the helmet. Adjust the position forwards or backwards.
- (D:3) Ventilation mode. Avoid placing the cups against the helmet as this prevents ventilation (D:4).

Note! Do not store the helmet with the helmet attachment in ventilation mode. This causes stress on the helmet attachment.

2:4 Work mode

To switch the unit from ventilation mode (D:3) to work mode (D:2), press the cup supporting arms inwards until you hear a click on both sides. Make sure that the cups and the band wire do not press on the edge of the helmet, when in work mode, as this can cause noise leakage.

Note! When the helmet is not in use, make sure that the cups are left in work mode. This will decrease the stress on the helmet attachment.

2:5 Speech microphone (Fig. E)

For maximum noise cancelling, the speech microphone should be positioned close to your mouth (<3 mm).

3 USAGE/FUNCTIONS

3:1 Inserting batteries

Remove the battery compartment lids and insert the batteries (2xAAA). The battery polarity must correspond to the marking in the battery compartment. The lids must be pressed all the way down for the sealing to work. Low battery level is indicated by a ghost voice message "low battery", repeatedly.

3:2 Switching the headset on and off

Press and hold the [+] or [-] button for two seconds to switch the headset on or off. The current setting is always saved when the headset is switched off. The headset is automatically powered off after two hours of no active functions. This is indicated by a ghost voice message the last minute before the headset switches off.

3:3 Volume

The volume setting adjusts the level-dependent function for ambient sound. It is adjustable in 4 levels and a silence mode. Silence mode is confirmed by a voice message. The volume is limited to 82 dB(A).

3:4 Menu

Press and hold the [+] and [-] button for one second for the menu. To step through the menu, press the [-] button briefly. The menu steps are listed below as 3:5-3:14. At each menu step the [+] button is used to change the setting and, if available, step through the available settings. A ghost voice message confirms each menu step, followed by the current setting. Also changes are confirmed by a ghost voice message. After a few seconds of no activity, the menu returns to volume mode. By pressing the [+] and [-], the volume setting can be instantly reached at any stage of the menu.

3:5 Equalizer

The Equalizer adjusts the tone for the level-dependent function for ambient listening. It is adjustable in four levels: Low, Normal, High and Extra High.

3:6 Factory reset

Resets all menu settings to the factory default values. This setting needs to be confirmed by pressing the [+] when the ghost voice says "confirm factory reset".

3:7 Advanced settings

The advance settings menu includes the additional settings described in 3:8-3:14. The advance settings menu steps are added to the normal menu steps when activated. It is automatically de-activated when returning from the menu.

3:8 Release time

The release time setting adjusts the time before the limiter for the level-dependent function opens after activation. It is adjustable in two levels: Fast and Slow.

3:9 Balance

The balance setting adjusts the volume balance between the right and the left ear. It is adjustable in 7 levels: Center, Right/1, Right/2, Max right, Max left, Left/2, Left/1.

3:10 External input sensitivity

The external input sensitivity setting adjusts the attenuation of the input signal applied on the headset cable input (A:13). It is adjustable in three levels: Low - Medium - High. Setting Low means the gain of the input signal applied on the external input is low, while setting high means High gain of the signal.

3:11 Warning signals

The warning signal setting disables/enables the warning signals "low battery" and "automatic power off". When set off, none of these warning signals will be heard.

3:12 Automatic power off

The automatic power off setting disables/enables the automatic power off function.

3:13 External input

The standard connector is type J11. Also other type of connectors exists. The J11 connector is available with different wiring configurations. For information on wiring on your specific headset, please refer to product data sheet or consult your dealer.

3:14 External microphone jack

The external microphone jack can be used for attaching an external microphone, for example a boom microphone. The polarity is: top pole is ground (-) and bottom pole is (+). For models with foldable headband, this jack is placed on the front side of the left cup whilst on neckband models; it is placed on the back side of the left cup.

4 IMPORTANT USER INFORMATION

It is recommended that the wearer ensure that:

- The headset is fitted, adjusted and maintained in accordance with the manufacturer's instructions.
- The headset is regularly inspected for serviceability.

Warning!

If the recommendations above are not adhered to, the function afforded by the headset will be severely impaired.

- This product may be adversely affected by certain chemical substances. Further information should be sought from the manufacturer.
- The headset, and in particular ear cushions, may deteriorate with use and should be examined at frequent intervals for damages such as cracking. Replace the ear cushions at least twice a year, see A:8.
- The fitting of hygiene covers to the cushions may affect the acoustic performance of the headset. Follow the manufacturer's recommendation for the appropriate hygiene kit, see 6.
- This headset is provided with level-dependent function. The wearer should check correct operation before use. If distortion or failure is detected, the wearer should refer to the manufacturer's advice for maintenance and replacement of the battery.
- This headset is provided with electrical audio input. The wearer should check correct operation before use. If distortion or failure is detected, the wearer should refer to the manufacturer's advice.
- Follow the advice in this manual on maintaining and replacing batteries.

Warning!

- Performance may deteriorate with battery usage. The typical period of continuous use that can be expected from the headset battery is 200 hours.
- The output of the level-dependent circuit of this headset may exceed the external sound level.
- The output of the electrical audio circuit of this headset may exceed the daily limit sound level.

5 MAINTENANCE

5:1 Replacing the ear cushions

(F:1) Slide your fingers under the edge of the ear cushion and pull straight out.

(F:2) Insert the new foam and ear cushion.

(F:3) Press until it snaps into place.

5.2 Cleaning

Remove the ear cushions and attenuation pads (Fig. F) if you have been wearing the headset for a long time or if moisture has gathered inside the cups. Clean the cups,

headband and ear cushions regularly with soap and warm water. Use a dampened cloth. Make sure the soap is known not to be harmful to the wearer. Do NOT immerse the hearing protector in water! Allow the headset to dry before you use it again. Alcohol free anti-bacteria wipes such as 3M 504 Respirator Cleaning Wipe can be used to maintain the hygiene of ear cushions, cups and headband. Do NOT clean with solvent based products such as alcohol and acetone or with waterless hand cleaners!

5:3 Use and storage conditions

Remove the batteries before storing the product. Do not store the hearing protector at temperatures above +55°C (for example on a dashboard, parcel shelf or window sill), or at temperatures below -40°C. Do not use the hearing protector at temperatures above +55°C, or below -40°C.

5:4 Microphone protection

To protect the boom speech microphone from humidity and dirt, use microphone protector HYM1000. For attaching the protector, see Fig G.

6 SPARE PARTS/ACCESSORIES

3M™ PELTOR™ HY68 SV Hygiene kit

Replaceable hygiene kit. Replace at least twice a year to ensure constant attenuation, hygiene and comfort.

3M™ PELTOR™ HY100A Single-use protectors

Single-use protector that is easy to fit to the ear cushions.

3M™ PELTOR™ HYM1000 Microphone protector

Moisture and wind-resistant tape that protects the speech microphone.

3M™ PELTOR™ M60/2 Wind shield for ambient microphones

Effective protection against wind noise. One pair per package.

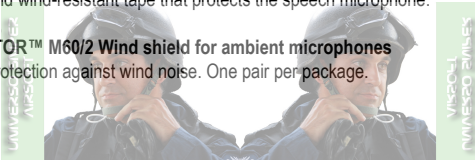



3M

3M Svenska AB

Box 2341

SE-331 02 Värnamo

Sweden

Phone: +46 (0) 370 65 65 65

Fax: +46 (0) 370 65 65 99

Email: peltorcommunications@mmm.com

Internet: www.3M.EU/CommunicationSolutions

FP3754 Rev. a

Please recycle. Printed in Sweden.

© 3M 2014. All rights reserved.